

**ADDISON CIRCLE
 OFFICE BUILDING**
 ADDISON
 TEXAS

HUITT-ZOLLARS, INC.
 3131 McKinney Ave., Suite 600
 Dallas, TX 75204 214-871-3111

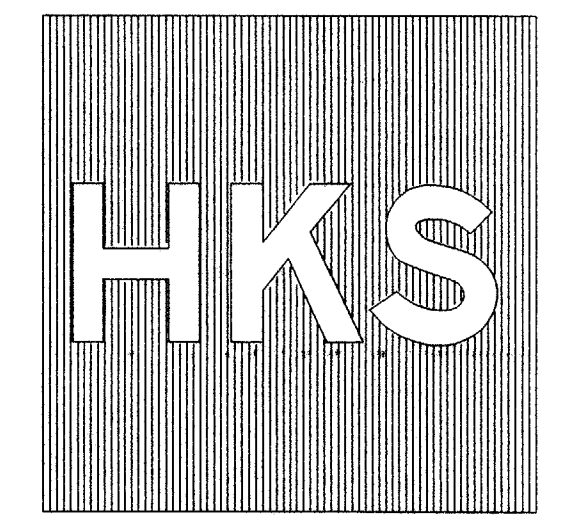

HKS Inc., Architects-Engineers-Planners
 700 N. Pearl, Suite 1100, LB 307
 Dallas, Texas 75201-7485 (214) 969-2599

Job No: 5494
 ISSUED FOR CONSTRUCTION

15 OCT. 1997

RECORD DRAWING
 12/4/98
 SHIFTED INLET
 LOCATION 1/16/98

Revisors:
 Date:
 Sheet Title:
DRAINAGE PLAN
 Sheet No:
C6

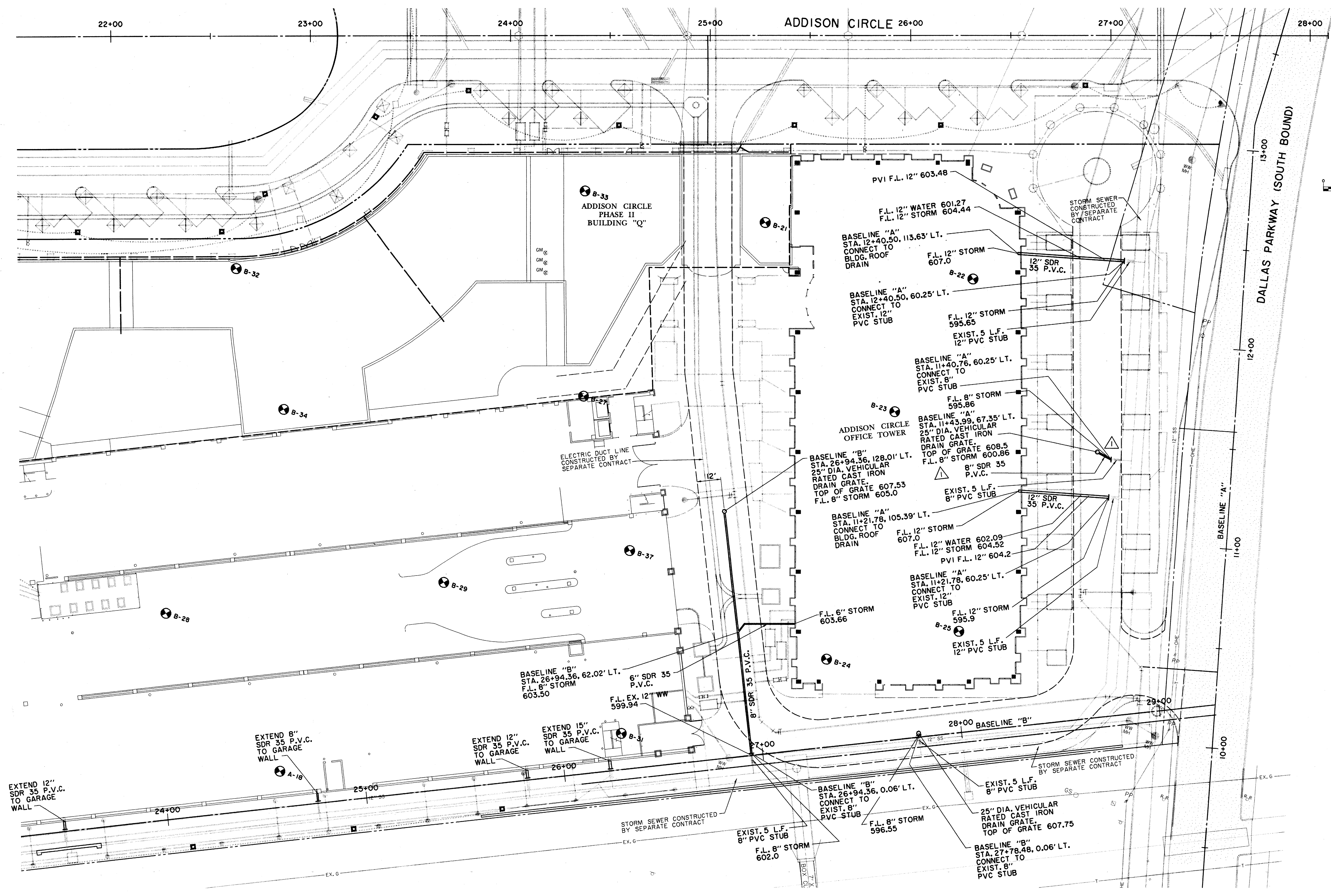
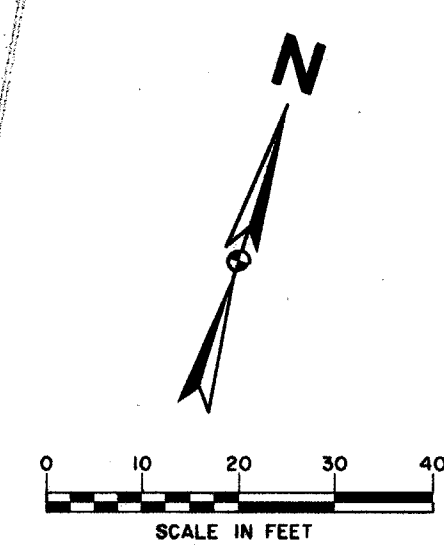

RECORD DRAWING:
 THIS DRAWING HAS BEEN MODIFIED FROM THE ORIGINAL DESIGN DRAWINGS TO REFLECT THE FIELD CHANGES THAT OCCURRED DURING CONSTRUCTION WHICH WERE DOCUMENTED AND FURNISHED TO THE ENGINEER BY THE CONTRACTOR. BASED ON THIS INFORMATION AND THE ENGINEER'S OBSERVATION OF CERTAIN CONSTRUCTION ACTIVITIES, TO THE BEST OF THE ENGINEER'S KNOWLEDGE AND BELIEF, THE PROJECT IS CONSTRUCTED IN CONFORMANCE WITH THE PLANS AND SPECIFICATIONS AND WILL FUNCTION AS DESIGNED.

BENCHMARKS:
 BM#5
 "1" CUT AT NORTHWEST CORNER OF NORTH HDWL OF 7'x7' BOX CULVERT UNDER RAILROAD, 180' WEST OF DALLAS PARKWAY SOUTHBOUND, ELEV. 610.49
 BM#6
 "1" CUT AT CENTER FRONT OF 18" REC. INLET, SECOND INLET NORTH OF RAILROAD TRACKS ON THE WEST SIDE OF DALLAS PARKWAY SOUTHBOUND, ELEV. 605.67

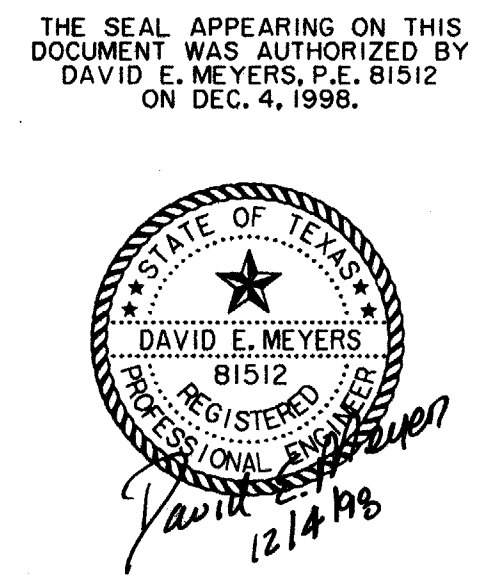

DATE PLOTTED: 10/15/97
 PLOT SCALE: 1"=40'-0"
 PLOT DATE: 10/15/97
 PLOT TIME: 10:15 AM
 PLOT BY: JMM
 PLOT FROM: C:\WORK\ADDISON\ADDISON.DWG
 PLOT TO: C:\WORK\ADDISON\ADDISON.PLOT
 PLOT SIZE: 11x17
 PLOT ORIENT: L
 PLOT SHEETS: 1 OF 1
 PLOT SHEET NO: 6
 PLOT SHEET TITLE: DRAINAGE PLAN
 PLOT SHEET NO. OF SHEETS: 6
 PLOT SHEET TITLE: DRAINAGE PLAN