

**ADDISON CIRCLE OFFICE BUILDING**  
 TEXAS  
 ADDISON

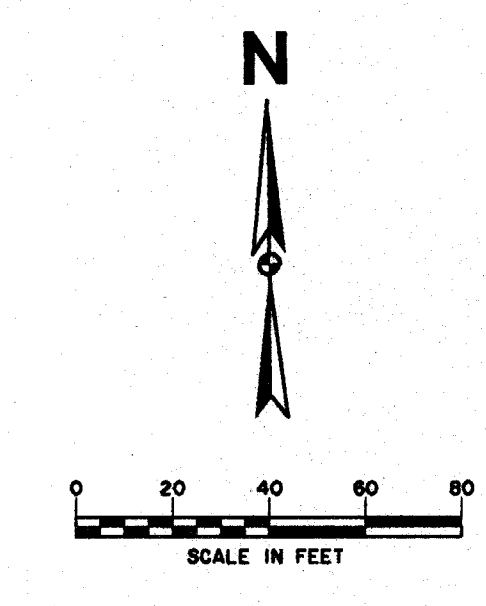
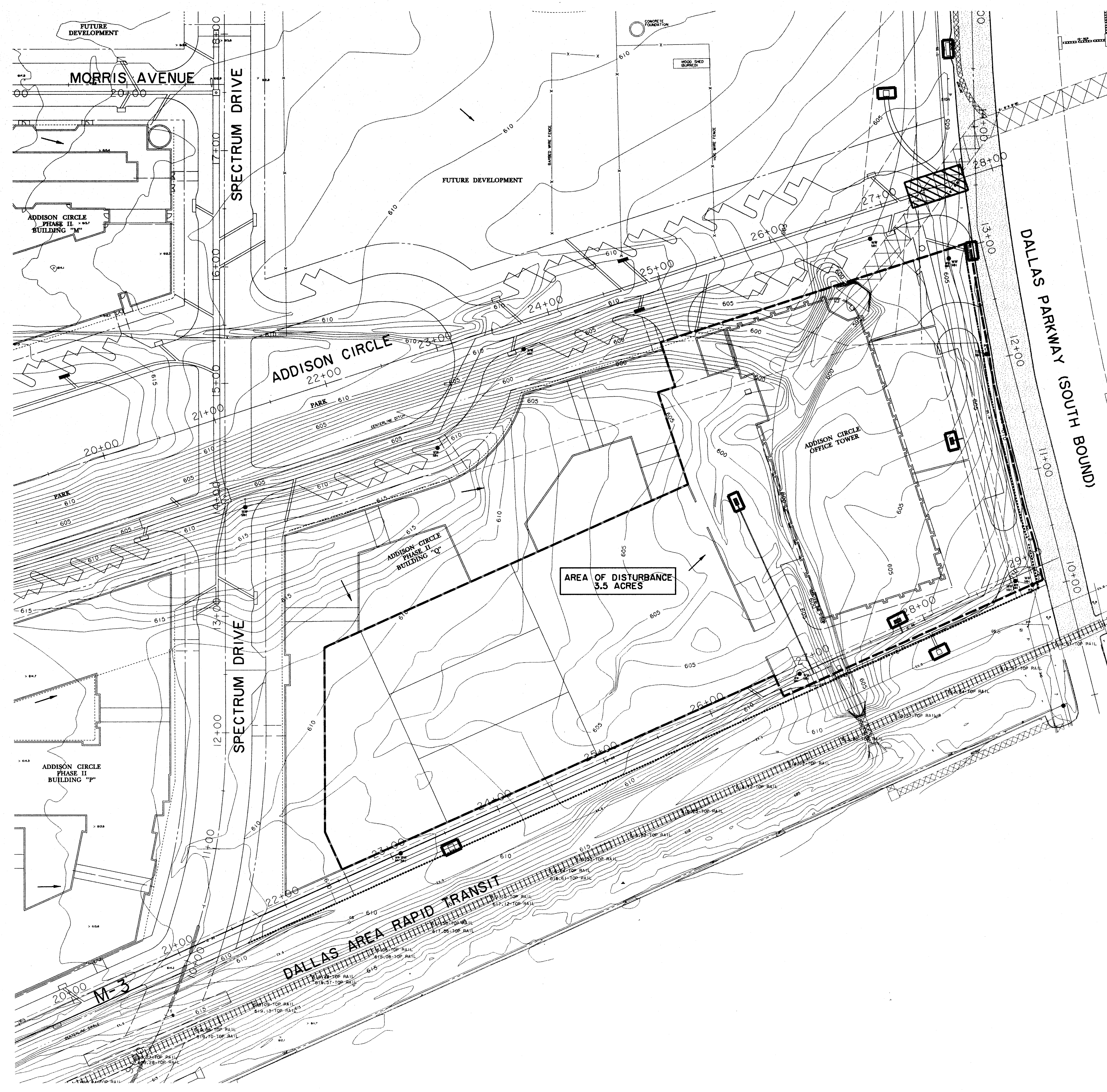

- NOTES:**
- SEE DRAINAGE AREA MAP FOR DRAINAGE AREAS AND RUNOFF CALCULATIONS.
  - SEE GRADING PLAN FOR DETAILED LOT GRADING.
  - STABILIZED CONSTRUCTION ENTRANCES WILL BE REQUIRED UNTIL ADDISON CIRCLE IS CONSTRUCTED.
  - CONCURRENT CONSTRUCTION OF APARTMENT DEVELOPMENT AND PUBLIC INFRASTRUCTURE WITHIN AND ADJACENT TO THIS PROJECT MAY REQUIRE MODIFICATION OF EROSION CONTROL MEASURES. CONTRACTOR SHALL COORDINATE WITH PUBLIC CONTRACTOR FOR A PRACTICAL AND USEFUL SYSTEM TO CONTROL EROSION AND SILTATION FROM BOTH PROJECTS.
  - TEMPORARY STRAW BALE DIKES WILL BE REQUIRED AROUND ALL AREA DRAINS WITHIN BUILDING COURTYARDS.

- LEGEND:**
- ..... SILT FENCE
  - INLET PROTECTION
  - - - - - EXISTING CONTOURS
  - - - - - DIRECTION OF RUNOFF
  - - - - - LIMITS OF DISTURBANCE
  - ▨ STABILIZED CONSTRUCTION ENTRANCE/EXIT

**PROBERTS & SHAMBAUGH, INC.**  
 Consulting Engineers  
 401 E. Ross Ave., Suite 2000  
 Dallas, Texas 75201-7485  
 (214) 969-5599

**HUETT-ZOLLARS, INC.**  
 Consulting Engineers  
 3131 McKinney Ave., Suite 400  
 Dallas, TX 75204 214-871-3111

**HKS**

HKS Inc., Architects-Engineers-Planners  
 700 W. Pearl, Suite 1100, LB 307  
 Dallas, Texas 75201-7485 (214) 969-5599

Job No: 5494  
 ISSUED FOR 100%  
 DESIGN  
 DEVELOPMENT  
 NOT FOR  
 CONSTRUCTION  
 26 JUNE 1997

Revisions:  
 Date:  
 Sheet Title:  
**POLLUTION CONTROL PLAN**  
 Sheet No:  
**C8**  
 © 1997  
 HKS Inc.

File:  
 1 5494-1-TS  
 2  
 3  
 4  
 5

Plot date:  
 20 JUN 97