

**LEGEND**

- 613 — EXIST CONTOUR
- 612.38 — EXIST SPOT ELEVATION
- 611.22 — EXIST TOP OF CURB ELEVATION
- 611.22 — EXIST GUTTER ELEVATION
- 613 — PROPOSED CONTOUR
- TC 636.00 — PROP TOP OF CURB ELEVATION
- G 637.50 — PROP GUTTER ELEVATION
- S 636.37 — PROP SPOT ELEVATION
- — — — — PROP DRAINAGE DIVIDE

**CITY B.M. #9**  
 12" CUT ON CONC BASE OF LIGHT BASE, CENTERLINE OF EXCEL ROAD, 50'± WEST OF ADDISON ROAD. ELEV. 463.82

**B.M. #1**  
 4" CUT ON CONC SW WEST SIDE OF ADDISON ROAD, 40'± NORTH OF SOUTHWEST CORNER ON ADDISON RD. ELEV. 643.02

**B.M. #2**  
 12" CUT BY FH ON TOP OF RETAINING WALL, 5' LEFT SIDE OF CURB AT FIRST PI OF CURB. ELEV. 639.38

**B.M. #3**  
 12" CUT BY FH ON TOP OF RETAINING WALL, 5' LEFT SIDE OF WESTROVE. ELEV. 638.82

**B.M. #4**  
 12" CUT ON CONC BASE OF LS ON NORTH SIDE OF DRIVEWAY AT NORTH ENTRY #16479 AT DALLAS PKWY, OFF SOUTHWEST SIDE OF TOLLWAY. ELEV. 638.92

**B.M. #5**  
 12" CUT TO NOSE MEDIAN AT CENTERLINE OF WEST SIDE EXCEL, SOUTH BOUND SERVICE ROAD OF TOLLWAY. ELEV. 637.44

**DRAINAGE CRITERIA TABLE**

DRAINAGE AREA (ACRES)	C	I <sub>100</sub> (IN/HR)	O <sub>20</sub> (C.F.S.)
II	0.90	8.6	170.43
III	17.2	0.90	8.6
IV	5.7	0.90	8.6
V	3.5	0.90	8.6
TOTAL	35.5		272.31

TC IS BASED ON TIME TO DRAIN FROM FARTHEST POINT IN WATERSHED.  
 TC IS 11 MINUTES FOR AREA X.

**DRAINAGE AREA MAP**

**STM. SWR. CURVE DATA**

C-1	C-2	C-3
Δ = 29°55'28"	Δ = 32°44'11"	Δ = 89°58'07"
R = 67.12	R = 67.07	R = 60.00
T = 17.95	T = 19.68	T = 58.97
L = 35.08	L = 38.28	L = 94.22

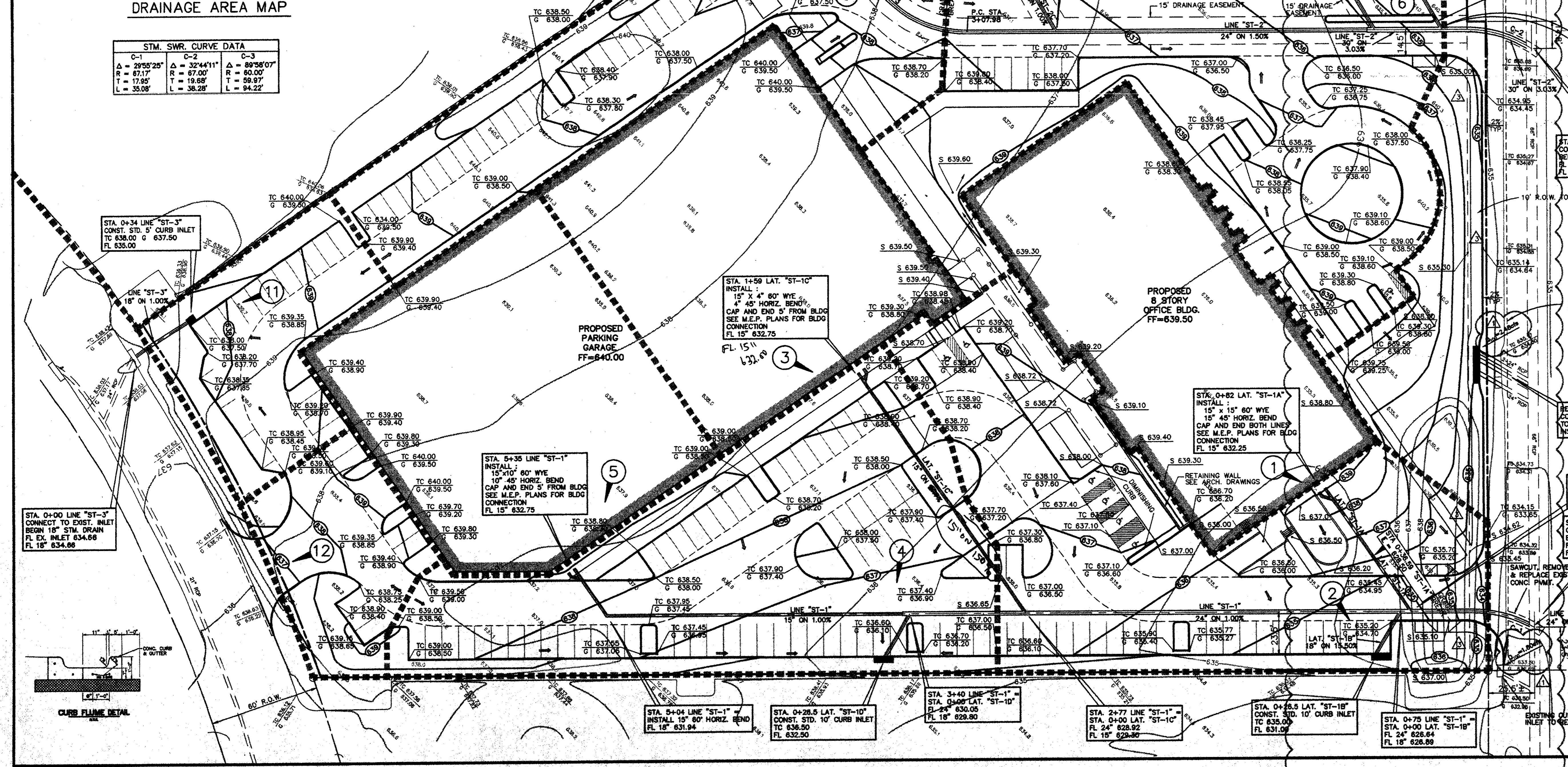

**PAVING AND DRAINAGE GENERAL NOTES**

- ALL WORK, UNLESS OTHERWISE NOTED, SHALL CONFORM TO THE STANDARD SPECIFICATIONS FOR PUBLIC WORKS CONSTRUCTION, ISSUED BY THE NORTH CENTRAL TEXAS COUNCIL OF GOVERNMENTS, TOWN OF ADDISON, AND THE CITY OF DALLAS STANDARD CONSTRUCTION SPECIFICATIONS.
- UNLESS OTHERWISE NOTED, ALL CONCRETE SHALL BE CLASS "A" (3000 PSI). NO FLY ASH WILL BE ALLOWED IN ON-SITE CONCRETE PAVEMENT.
- THE HORIZONTAL AND VERTICAL LOCATIONS OF EXISTING SUBSURFACE UTILITIES HAVE BEEN DETERMINED FROM DATA RECORDED BY OTHERS. CONTRACTOR SHALL VERIFY THAT NECESSARY CROSSING CLEARANCES BETWEEN EXISTING AND PROPOSED UTILITIES EXIST PRIOR TO CONSTRUCTION OF ANY SUCH CROSSING. IT WILL BE THE RESPONSIBILITY OF THE CONTRACTOR TO PROTECT ALL PUBLIC UTILITIES IN THE CONSTRUCTION OF THIS PROJECT.
- CONTRACTOR SHALL MAINTAIN ONE SET OF "RECORD DRAWINGS" ON SITE WHICH WILL BE SUBMITTED TO OWNER OR ENGINEER UPON COMPLETION OF THE PROJECT. RECORD DRAWINGS SHALL INDICATE THE LOCATION OF ALL SUBTERRANEAN UTILITY IMPROVEMENTS, AND INDICATE TIES TO ALL MANHOLES, CULVERTS, INLETS, JUNCTION BOXES, ETC.
- THE CONTRACTOR IS RESPONSIBLE FOR COMPLIANCE WITH ALL FEDERAL, STATE AND LOCAL REGULATIONS REGARDING TRENCH SAFETY.
- STORM DRAIN LINES MAY BE OF THE FOLLOWING MATERIALS:
  - RCP C-76, CLASS III
  - ADP N-12
  - HANCOCK H-0
 INSTALLED IN ACCORDANCE WITH MANUFACTURER'S SPECIFICATIONS.
- BARRICADE AND PROJECT SIGNS SHALL CONFORM TO "STATE DEPARTMENT OF HIGHWAYS AND PUBLIC TRANSPORTATION BARRICADE AND CONSTRUCTION STANDARDS."
- PRIOR TO COMMENCEMENT OF CONSTRUCTION, BONDS AND THREE-WAY CONTRACTS SHALL BE SUBMITTED TO THE CITY AS REQUIRED.
- USE OF FLY ASH OR ANY CHEMICAL AD MIXTURE IN CONCRETE WILL REQUIRE PRIOR APPROVAL FROM THE DIRECTOR OF PUBLIC WORKS AND WILL BE SUBJECT TO SPECIAL MONITORING AND INSPECTION OF THE WORK AS PROVIDED IN SPECIAL PROVISION TO THE STANDARD SPECIFICATIONS ENTITLED ELY ASH AD MIXTURE TO CONCRETE.
- DURING THE CONSTRUCTION OF THESE IMPROVEMENTS, ANY INTERPRETATION OF THE STANDARD SPECIFICATIONS FOR PUBLIC WORKS CONSTRUCTION AND ANY MATTER WHICH REQUIRES THE APPROVAL OF THE OWNER, MUST BE APPROVED BY THE DIRECTOR OF PUBLIC WORKS OR HIS DESIGNEE BEFORE ANY CONSTRUCTION COMMENCES. ASSUMPTIONS ABOUT WHAT THESE DECISIONS MIGHT BE WHICH ARE MADE DURING THE BIDDING PHASE WILL HAVE NO BEARING ON THE DECISION.
- CONSTRUCTION OF STREETS, ALLEYS, SIDEWALKS, DRIVEWAYS AND STORM DRAINAGE FACILITIES IN THE PUBLIC RIGHT-OF-WAY MUST BE CONSTRUCTED IN CONFORMANCE WITH THE TOWN OF ADDISON AND THE CITY OF DALLAS CONSTRUCTION DETAILS, FILE 251D-1.
- ALL CONCRETE FOR PAVEMENT, WITHIN THE PUBLIC RIGHT-OF-WAY, SHOULD BE 4000 PSI, IF MACHINE FINISH AND 4500 PSI IF HAND FINISH. CONCRETE PAVEMENT THICKNESS SHALL BE 10" (8" IF SUBGRADE IS TREATED WITH LIME).
- CONTRACTOR TO INSTALL ALL IRRIGATION SLEEVES AND LANDSCAPE DRAINS PRIOR TO PLACEMENT OF CONCRETE PAVEMENT. IRRIGATION DRAINS ARE TO BE CONNECTED TO THE SITE STORM DRAIN SYSTEM IN ACCORDANCE WITH MANUFACTURER'S SPECIFICATIONS. SEE LANDSCAPE ARCHITECT DRAWINGS FOR LOCATION AND SIZE OF IRRIGATING SLEEVES AND LANDSCAPE DRAINS.

**DRAINAGE CRITERIA TABLE**

DRAINAGE AREA (ACRES)	C	I <sub>100</sub> (IN/HR)	O <sub>20</sub> (C.F.S.)	COMMENTS
1	0.64	0.90	8.6	4.95 BLDG ROOF DRAINS
2	0.80	0.90	8.6	4.84 10' CURB INLET
3	0.82	0.90	8.6	4.80 GARAGE ROOF DRAINS
4	0.88	0.90	8.6	5.81 10' CURB INLET
5	0.82	0.90	8.6	4.80 GARAGE ROOF DRAINS
6	0.89	0.90	8.6	6.89 10' CURB INLET
7	0.82	0.90	8.6	8.35 LATERAL TO AREA I
8	0.85	0.90	8.6	5.03 LATERAL TO AREA II
9	0.82	0.90	8.6	4.80 10' CURB INLET
10	2.37	0.85	8.6	17.32 10' CURB INLET
11	0.27	0.90	8.6	2.09 5' CURB INLET
12	0.20	0.90	8.6	1.55 TO WESTROVE DR.

This seal indicates only that I have reviewed the consultant's work and coordinated it with the overall project.

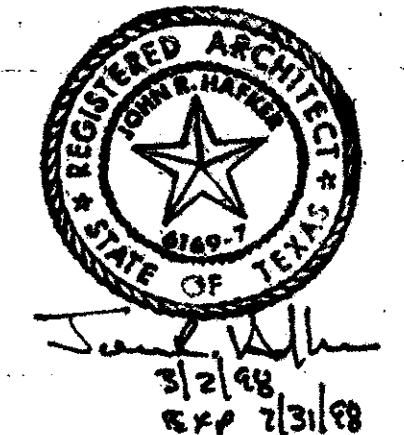

**OMNIPLAN**  
 CITYPLACE CENTER EAST • DALLAS, TX 75204  
 COPYRIGHT © ALL RIGHTS RESERVED • 1997

ONE HANOVER PARK  
 OFFICE BUILDING  
 ADDISON, TEXAS

INTERVEST COMPANIES  
 DEVELOPER

WILCOX SERVICES, INC.  
 PROJECT MANAGER

PACHECO KOCH Consulting Engineers, Inc. 9401 LBJ Freeway, Suite 300 Dallas, Texas 75243 (214) 236-3031  
 Civil Engineering - Land Surveying

**GRADING & DRAINAGE PLAN**  
**ONE HANOVER PARK**  
**N. DALLAS TOLLWAY AT EXCEL PARKWAY**  
**DALLAS COUNTY**  
**TOWN OF ADDISON, TEXAS**

DESIGN	DRAWN	DATE	SCALE	NOTES	FILE	NO.
SAM	TDH	8/26/97	1"=30'		311T	6213

PK NO: 1767-97.178 DWG NO: 1767-16

GRADING & DRAINAGE PLAN  
 9716.00  
 EARLY ISSUE 9.5.97

C2.0