

No.	Sta.	Lt.	Rt.	SIZE	DESCRIPTION
1	71+75	2'		12"	Elm
2	71+81	14'		4"	Twin Ash
3	71+85	14'		4"	Ash
4	72+04	19'		12"	Elm
5	72+05	12'		4"	Ash
6	72+34	19'		6"	Elm
7	72+39	13'		6"	Ash
8	72+43	5'		6"	Ash
9	72+45	11'		6"	Ash
10	72+46	17'		6"	Elm
11	72+53	18'		6"	Elm
12	72+76	18'		6"	Locust
13	72+80	20'		8"	Elm
14	73+58	7'		6"	Elm
15	73+58	12'		12"	Elm
16	74+50	30'		20"	Pecan
17	77+54	27'		18"	Pecan

For Additional Information See D.W.U. Tree Specs.

For Park Dept. Easement: Council Resolution # 842083 June 20, 1984 From Station 71+25 (Sheet 6) To Station 100+46.83 (Sheet 8)

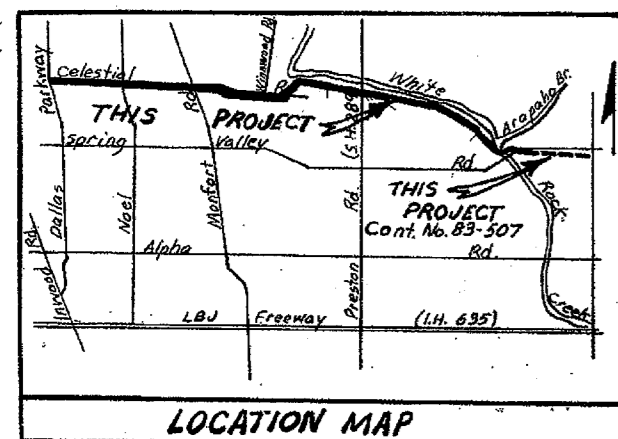

WATER MAP 8-25-W

Sani. Sev. Map F-2

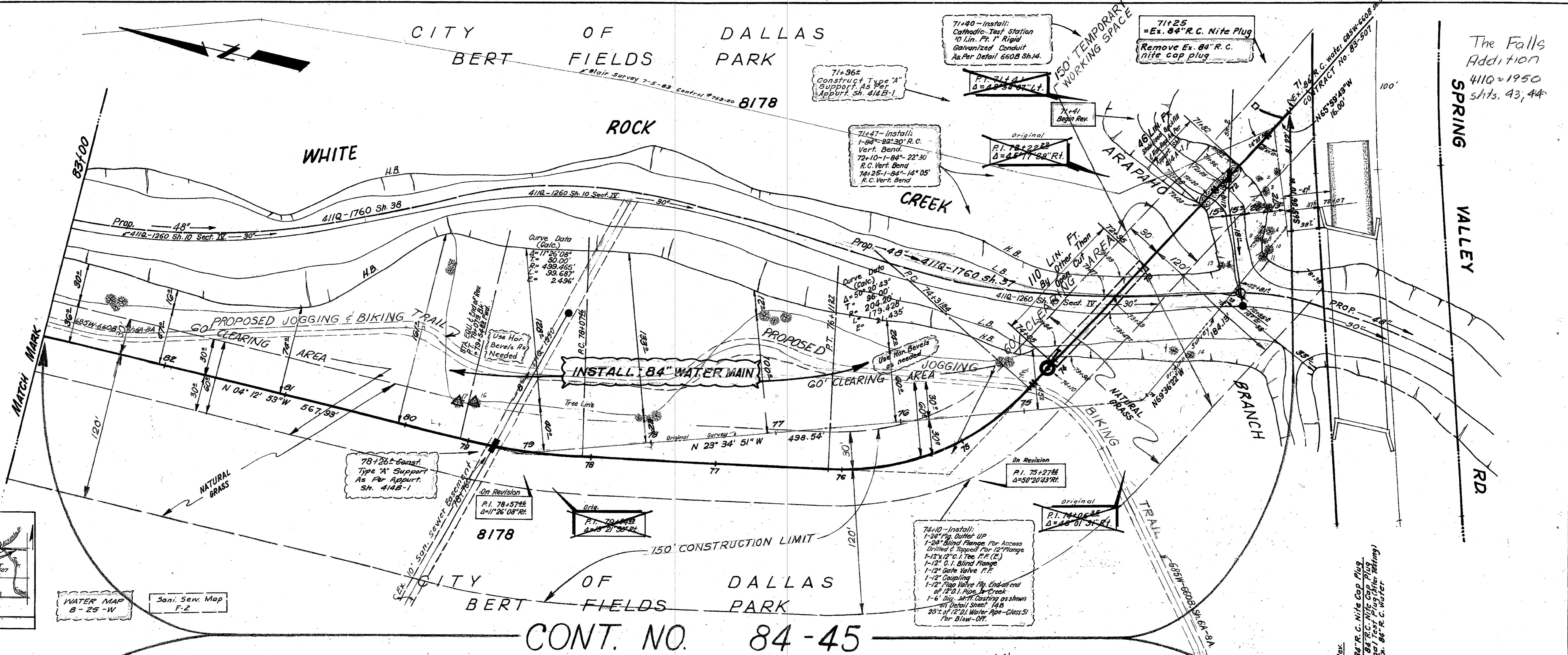

CONT. NO. 84-45

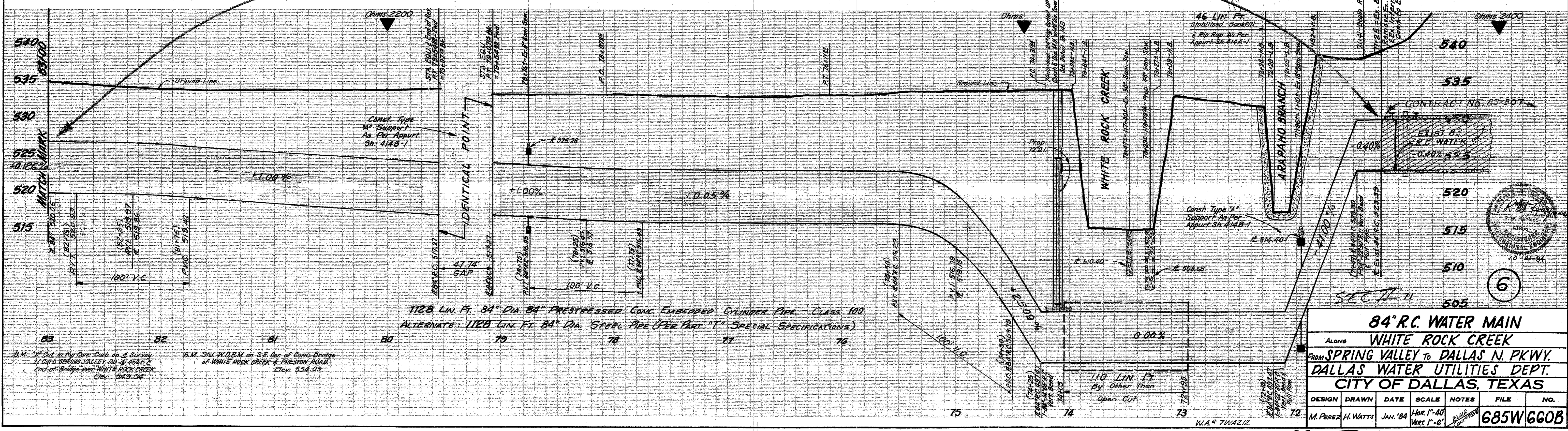

84" R.C. WATER MAIN					
ALONG WHITE ROCK CREEK					
FROM SPRING VALLEY TO DALLAS N. PKWY.					
DALLAS WATER UTILITIES DEPT.					
CITY OF DALLAS, TEXAS					
DESIGN	DRAWN	DATE	SCALE	NOTES	FILE NO.
M. PEREZ	H. WATTS	JAN. '84	HOR. 1"=40'	VERT. 1"=6'	685W660B

SEC. VIII