

15000 Preston Associates
30' Esm't. For Maintaining Water Main or Mains
or Appurtenances.
Map 82038 Block 8174 Lot 1
Vol. 82038 Pg. 8172
C.O. Date:

First Federal Savings & Loan of Waco July 9, 1985
30' Esm't. For Maintaining Water Main or Mains
or Appurtenances.
Map 127143 Blocks 8165 & 8173
Vol. Pg.
C.O. Date:

A.S.C. Versailles-Dallas Inc.
30' Esm't. For Maintaining Water Main or Mains
or Appurtenances.
Map 824 Block 8164
Vol. 82157 Pg. 2545
C.O. Date:

WHITE 8173
Jefferson Oaks Ph II
411Q 1960 SH. 121A-123

TREE LIST											
No.	Station	LT	RT	Spec	Description	No.	Station	LT	RT	Spec	Description
1	118497	41	42	6"	Hickory	48	120428	41	42	6"	Ash
2	117680	42	43	6"	Hickory	49	120429	41	42	6"	Ash
3	117526	43	44	6"	Hickory	50	120430	41	42	6"	Ash
4	117443	44	45	6"	Hickory	51	120431	41	42	6"	Ash
5	117550	45	46	6"	Hickory	52	120432	41	42	6"	Ash
6	117570	46	47	6"	Hickory	53	120433	41	42	6"	Ash
7	117570	47	48	6"	Hickory	54	120434	41	42	6"	Ash
8	117680	48	49	6"	Hickory	55	120435	41	42	6"	Ash
9	118498	49	50	6"	Hickory	56	120436	41	42	6"	Ash
10	118498	50	51	6"	Hickory	57	120437	41	42	6"	Ash
11	118498	51	52	6"	Hickory	58	120438	41	42	6"	Ash
12	118498	52	53	6"	Hickory	59	120439	41	42	6"	Ash
13	118498	53	54	6"	Hickory	60	120440	41	42	6"	Ash
14	118498	54	55	6"	Hickory	61	120441	41	42	6"	Ash
15	118498	55	56	6"	Hickory	62	120442	41	42	6"	Ash
16	118498	56	57	6"	Hickory	63	120443	41	42	6"	Ash
17	118498	57	58	6"	Hickory	64	120444	41	42	6"	Ash
18	118498	58	59	6"	Hickory	65	120445	41	42	6"	Ash
19	118498	59	60	6"	Hickory	66	120446	41	42	6"	Ash
20	118498	60	61	6"	Hickory	67	120447	41	42	6"	Ash
21	118498	61	62	6"	Hickory	68	120448	41	42	6"	Ash
22	118498	62	63	6"	Hickory	69	120449	41	42	6"	Ash
23	118498	63	64	6"	Hickory	70	120450	41	42	6"	Ash
24	118498	64	65	6"	Hickory	71	120451	41	42	6"	Ash
25	118498	65	66	6"	Hickory	72	120452	41	42	6"	Ash
26	118498	66	67	6"	Hickory	73	120453	41	42	6"	Ash
27	118498	67	68	6"	Hickory	74	120454	41	42	6"	Ash
28	118498	68	69	6"	Hickory	75	120455	41	42	6"	Ash
29	118498	69	70	6"	Hickory	76	120456	41	42	6"	Ash
30	118498	70	71	6"	Hickory	77	120457	41	42	6"	Ash
31	118498	71	72	6"	Hickory	78	120458	41	42	6"	Ash
32	118498	72	73	6"	Hickory	79	120459	41	42	6"	Ash
33	118498	73	74	6"	Hickory	80	120460	41	42	6"	Ash
34	118498	74	75	6"	Hickory	81	120461	41	42	6"	Ash
35	118498	75	76	6"	Hickory	82	120462	41	42	6"	Ash
36	118498	76	77	6"	Hickory	83	120463	41	42	6"	Ash
37	118498	77	78	6"	Hickory	84	120464	41	42	6"	Ash
38	118498	78	79	6"	Hickory	85	120465	41	42	6"	Ash
39	118498	79	80	6"	Hickory	86	120466	41	42	6"	Ash
40	118498	80	81	6"	Hickory	87	120467	41	42	6"	Ash
41	118498	81	82	6"	Hickory	88	120468	41	42	6"	Ash
42	118498	82	83	6"	Hickory	89	120469	41	42	6"	Ash
43	118498	83	84	6"	Hickory	90	120470	41	42	6"	Ash
44	118498	84	85	6"	Hickory	91	120471	41	42	6"	Ash
45	118498	85	86	6"	Hickory	92	120472	41	42	6"	Ash
46	118498	86	87	6"	Hickory	93	120473	41	42	6"	Ash
47	118498	87	88	6"	Hickory	94	120474	41	42	6"	Ash
48	118498	88	89	6"	Hickory	95	120475	41	42	6"	Ash
49	118498	89	90	6"	Hickory	96	120476	41	42	6"	Ash
50	118498	90	91	6"	Hickory	97	120477	41	42	6"	Ash
51	118498	91	92	6"	Hickory	98	120478	41	42	6"	Ash
52	118498	92	93	6"	Hickory	99	120479	41	42	6"	Ash
53	118498	93	94	6"	Hickory	100	120480	41	42	6"	Ash

TREE LIST											
No.	Station	LT	RT	Spec	Description	No.	Station	LT	RT	Spec	Description
1	117140	41	42	6"	Oak	48	120428	41	42	6"	Ash
2	117140	42	43	6"	Oak	49	120429	41	42	6"	Ash
3	117140	43	44	6"	Oak	50	120430	41	42	6"	Ash
4	117140	44	45	6"	Oak	51	120431	41	42	6"	Ash
5	117140	45	46	6"	Oak	52	120432	41	42	6"	Ash
6	117140	46	47	6"	Oak	53	120433	41	42	6"	Ash
7	117140	47	48	6"	Oak	54	120434	41	42	6"	Ash
8	117140	48	49	6"	Oak	55	120435	41	42	6"	Ash
9	117140	49	50	6"	Oak	56	120436	41	42	6"	Ash
10	117140	50	51	6"	Oak	57	120437	41	42	6"	Ash
11	117140	51	52	6"	Oak	58	120438	41	42	6"	Ash
12	117140	52	53	6"	Oak	59	120439	41	42	6"	Ash
13	117140	53	54	6"	Oak	60	120440	41	42	6"	Ash
14	117140	54	55	6"	Oak	61	120441	41	42	6"	Ash
15	117140	55	56	6"	Oak	62	120442	41	42	6"	Ash
16	117140	56	57	6"	Oak	63	120443	41	42	6"	Ash
17	117140	57	58	6"	Oak	64	120444	41	42	6"	Ash
18	117140	58	59	6"	Oak	65	120445	41	42	6"	Ash
19	117140	59	60	6"	Oak	66	120446	41	42	6"	Ash
20	117140	60	61	6"	Oak	67	120447	41	42	6"	Ash
21	117140	61	62	6"	Oak	68	120448	41	42	6"	Ash
22	117140	62	63	6"	Oak	69	120449	41	42	6"	Ash
23	117140	63	64	6"	Oak	70	120450	41	42	6"	Ash
24	117140	64	65	6"	Oak	71	120451	41	42	6"	Ash
25	117140	65	66	6"	Oak	72	120452	41	42	6"	Ash
26	117140	66	67	6"	Oak	73	120453	41	42	6"	Ash
27	117140	67	68	6"	Oak	74	120454	41	42	6"	Ash
28	117140	68	69	6"	Oak	75	120455	41	42	6"	Ash
29	117140	69	70	6"	Oak	76	120456	41	42	6"	Ash
30	117140	70	71	6"	Oak	77	120457	41	42	6"	Ash
31	117140	71	72	6"	Oak	78	120458	41	42	6"	Ash
32	117140	72	73	6"	Oak	79	120459	41	42	6"	Ash
33	117140	73	74	6"	Oak	80	120460	41	42	6"	Ash
34	117140	74	75	6"	Oak	81	120461	41	42	6"	Ash
35	117140	75	76	6"	Oak	82	120462	41	42	6"	Ash
36	117140	76	77	6"	Oak	83	120463	41	42	6"	Ash
37	117140	77	78	6"	Oak	84	120464	41	42	6"	Ash
38	117140	78	79	6"	Oak	85	120465	41	42	6"	Ash
39	117140	79	80	6"	Oak	86	120466	41	42	6"	Ash
40	117140	80	81	6"	Oak	87	120467	41	42	6"	Ash
41	117140	81	82	6"	Oak	88	120468	41	42	6"	Ash
42	117140	82	83	6"	Oak	89	120469	41	42	6"	Ash
43	117140	83	84	6"	Oak	90	120470	41	42	6"	Ash
44	117140	84	85	6"	Oak	91	120471	41	42	6"	Ash
45	117140	85	86	6"	Oak	92	120472	41	42	6"	Ash
46	117140	86	87	6"	Oak	93	120473	41	42	6"	Ash
47	117140	87	88	6"	Oak	94	120474	41	42	6"	Ash
48	117140	88	89	6"	Oak	95	120475	41	42	6"	Ash
49	117140	89	90	6"	Oak	96	120476	41	42	6"	Ash
50	117140	90	91	6"	Oak	97	120477	41	42	6"	Ash
51	117140	91	92	6"	Oak	98	120478	41	42	6"	Ash
52	117140	92	93	6"	Oak	99	120479	41	42	6"	Ash
53	117140	93	94	6"	Oak	100	120480	41	42	6"	Ash

TREE LEGEND
Trees Saved Along 60' Clearing Area
Sta. 115+00 to Sta. 128+00
Trees Saved Δ

No. 1-36" Oak	No. 183-36" Oak
No. 71-24" Oak	No. 188-18" Oak
No. 92-36" Walnut	No. 190-30" Oak
No. 145-16" Pecan	No. 205-15" Oak
No. 150-24" Oak	No. 214-12" Oak
No. 153-24" Elm	No. 225-15" Oak
No. 170-18" Oak	No. 257-15" Oak

For Additional Information See
D.W.U. Tree Specs.

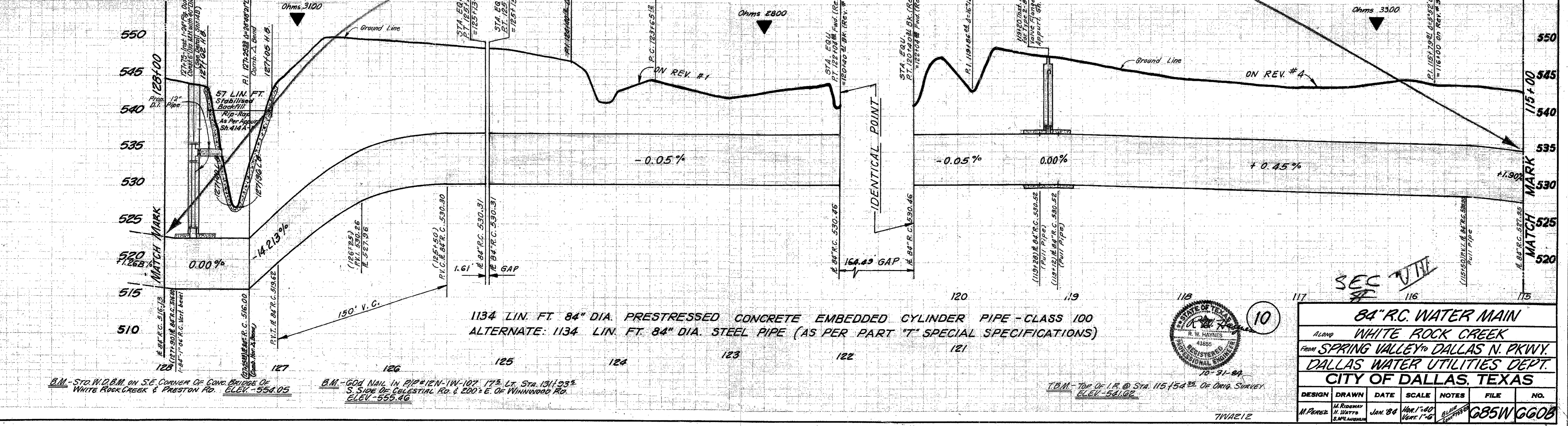

1134 LIN. FT. 84" DIA. PRESTRESSED CONCRETE EMBEDDED CYLINDER PIPE - CLASS 100
ALTERNATE: 1134 LIN. FT. 84" DIA. STEEL PIPE (AS PER PART 'T' SPECIAL SPECIFICATIONS)

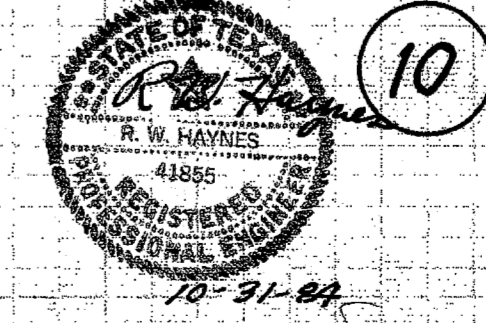

84" R.C. WATER MAIN					
ALONG WHITE ROCK CREEK					
FROM SPRING VALLEY TO DALLAS N. PKWY.					
DALLAS WATER UTILITIES DEPT.					
CITY OF DALLAS, TEXAS					
DESIGN	DRAWN	DATE	SCALE	NOTES	FILE NO.
M. Porez	M. Riddway	JAN. 84	1/4" = 1'-0"	SEE SHEET 10	G85W6608

7/11/82