

Landmark Partners, March 15, 1983
30' Easement for 8" Water Main
From Sta. 18+26.5 to Sta. 20+12.0
Abst. No. 1146 Blk. 1 of Quorum West
In The City of Addison
Contractor to Complete Construction/
Installation of 8" Water Main & Clean Up Area
(From Sta. 18+26.5 to Sta. 20+12.0) By Oct. 15, 1983
Temp. Working Space Granted.
SEE CONDITIONS Accompanying This
Easement.
C.D.:
Vol.: Pg.: Date:

McNeff-Palmer Properties Inc. March 15, 1983
30' Easement for 8" Water Main
From Sta. 20+12.0 to Sta. 22+12.0
Abst. No. 1146 Blk. 1 of Quorum West
In The City of Addison
Contractor to Complete Construction/
Installation of 8" Water Main & Clean Up Area
(From Sta. 20+12.0 to Sta. 22+12.0) By Nov. 20, 1983
Temp. Working Space Granted.
SEE CONDITIONS Accompanying
This Easement.
C.D.: 83142D
Vol.: 83217 Pg.: 1673 Date: 4-27-83

NOTE: Brace All Power Poles As Required.
Contractor Shall Contact Mr. D.E. Rich of
T.P. & L. Co. At (214) 387-0175, Two Days
Prior To Any Excavation Of This Project.
At Contractors Expense.

CITY OF ADDISON
VACANT LOT
Abst. 1146

LANDMARK

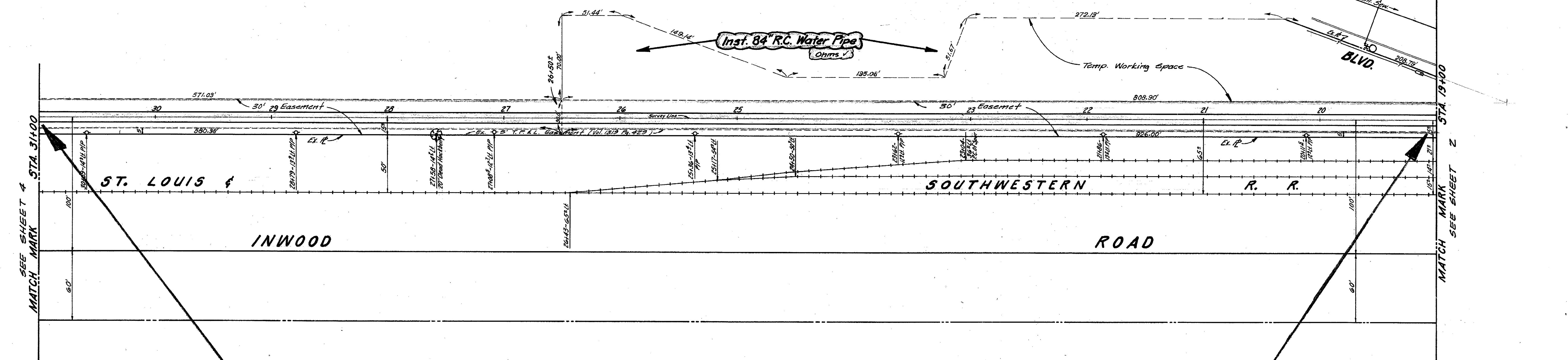

CITY OF ADDISON
Cont. # 83-139

NOTE: Bond All Joints See Detail Sht. 4-A

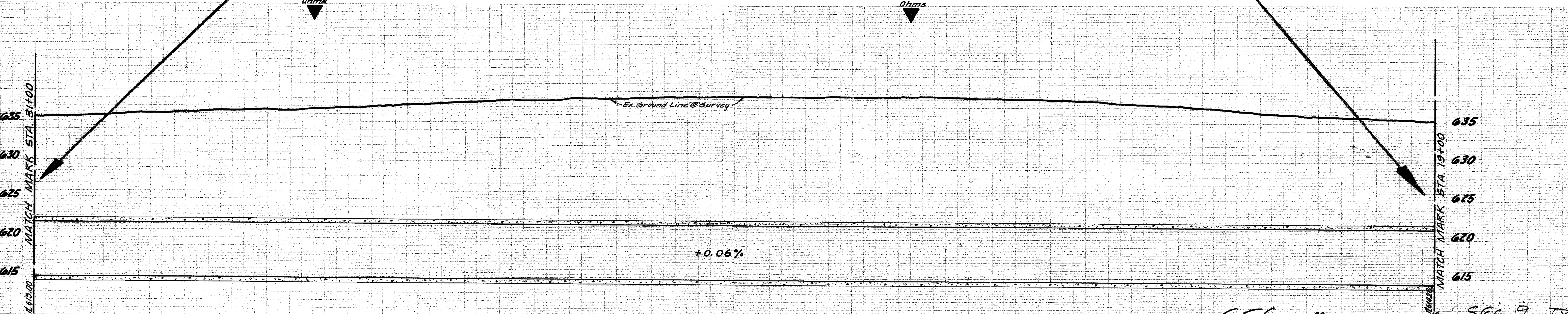

1200 Lin. Ft. 84" Dia. Prestressed Concrete Embedded Cylinder Pipe - Class 60

SEC 9 IX
SHEET 3

84" R.C. WATER MAIN
IN QUORUM AREA FR. DALLAS PARKWAY AT
CELESTIAL DR. TO BELTWOOD RESERVOIR
DALLAS WATER UTILITIES DEPARTMENT
CITY OF DALLAS, TEXAS

DESIGN	DRAWN	DATE	SCALE	NOTES	FILE	NO.
S. Regal	S. Perez	Feb. 1983	1"=40' Hor. 1"=6' Vert.	Smithman #640-15	685W	660C

T.B.M. "Cut on conc. curb center radius S.W. Cor. of Belt Line Rd. & Inwood Rd. west of St. Louis & Southwestern Railroad. Elev. 632.11 (Set 11-8-82).
B.M. "Cut in S.E. Cor. of Pump Pits Structure bet. Pump House & the Beltwood Pump Station. Elev. 630.02