

No.	Sta.	Lt.	Pt.	Size	Description
1	71+75	2'	12"	4"	Elm
2	71+81	17'	4"	4"	Twin Ash
3	71+93	14'	4"	4"	Ash
4	72+04	19'	10"	4"	Elm
5	72+05	12'	4"	4"	Ash
6	72+34	7'	6"	6"	Elm
7	72+39	13'	6"	6"	Ash
8	72+43	5'	6"	6"	Ash
9	72+45	11'	6"	6"	Ash
10	72+45	1'	6"	6"	Elm
11	72+53	1'	6"	6"	Elm
12	72+76	15'	6"	6"	Locust
13	72+80	20'	8"	8"	Elm
14	73+53	7'	6"	6"	Elm
15	73+53	6'	12"	12"	Elm
16	79+50	30'	20"	20"	Pecan
17	79+64	27'	18"	18"	Pecan

For Additional Information See D.W.U. Tree Specs.

For Park Dept. Easement: Council Resolution # 842083 June 20, 1984 From Station 71+25 (Sheet 6) To Station 100+46.83 (Sheet 8)

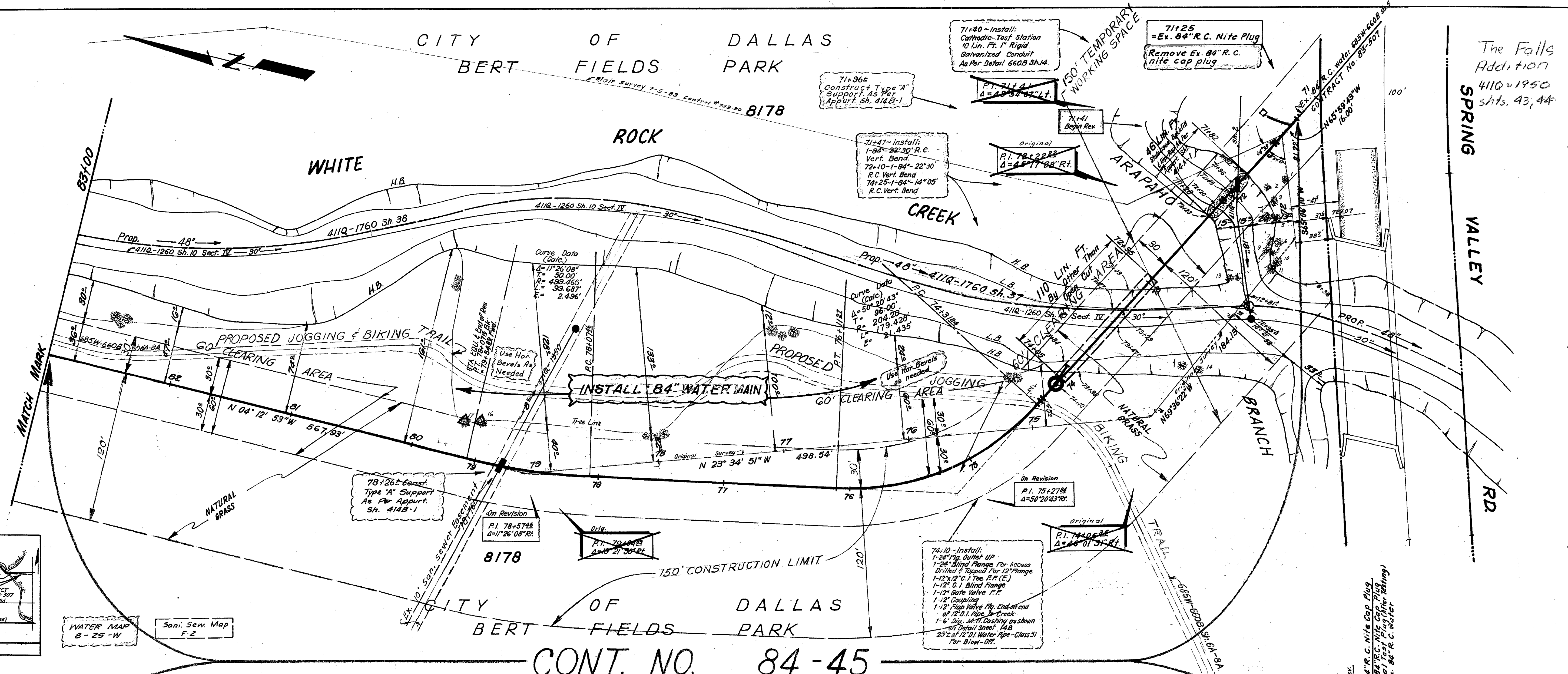
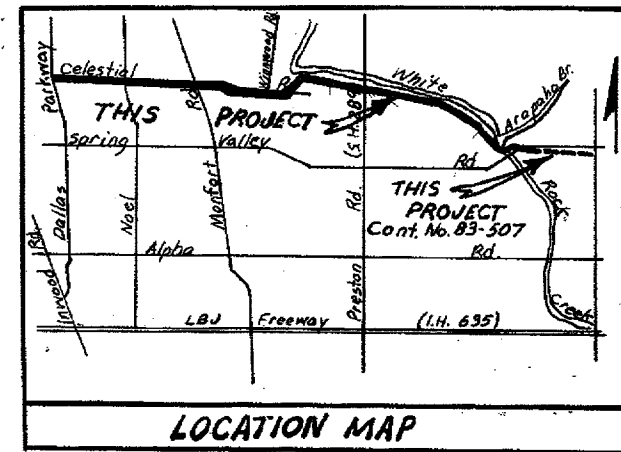

CONT. NO. 84-45

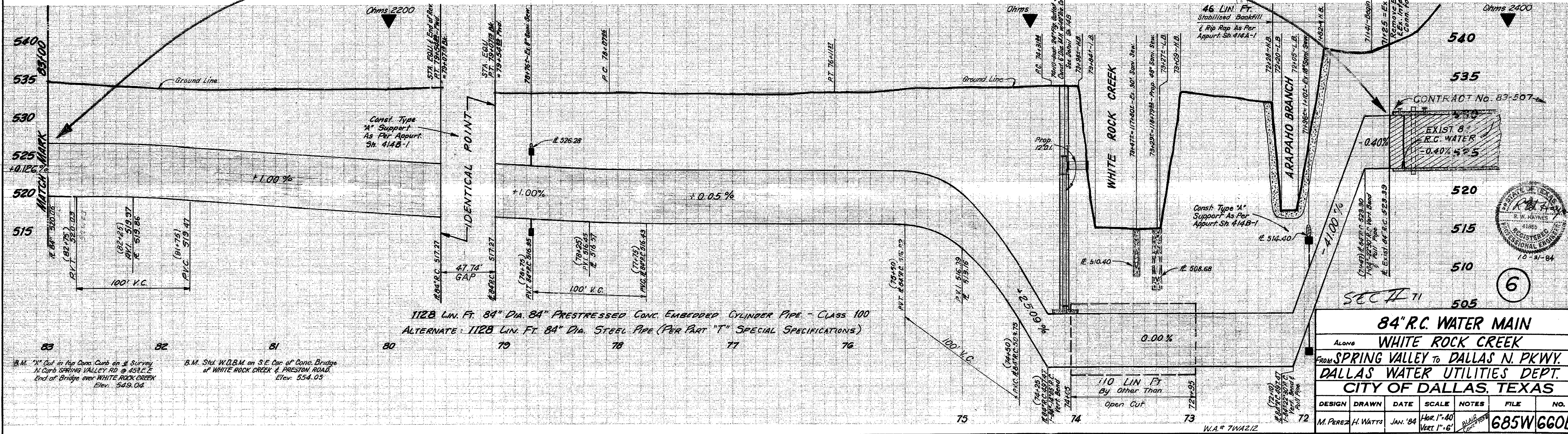

<b>84" R.C. WATER MAIN</b>					
Along <b>WHITE ROCK CREEK</b>					
From <b>SPRING VALLEY</b> To <b>DALLAS N. PKWY.</b>					
<b>DALLAS WATER UTILITIES DEPT.</b>					
<b>CITY OF DALLAS, TEXAS</b>					
DESIGN	DRAWN	DATE	SCALE	NOTES	FILE NO.
M. PEREZ	H. WATTS	JAN. '84	HOR. 1"=40'	VERT. 1"=8'	<b>685W660B</b>

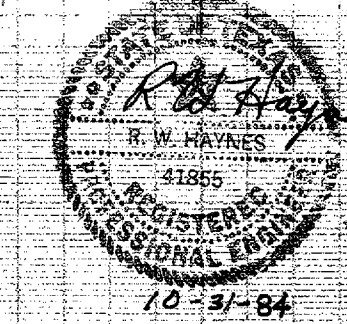

B.M. "X" Cut in Pavement Curb on S.E. Survey N. Curbs SPRING VALLEY RD @ 433 E.E. End of Bridge over WHITE ROCK CREEK Elev. 549.04

B.M. Std. W.D.B.M. on S.E. Cor. of Conc. Bridge of WHITE ROCK CREEK & PRESTON ROAD Elev. 554.05

The Falls Addition  
4110-1950  
sh. 43, 44

SEC. VIII