

GENERAL NOTES

- All water mains shall be ductile iron class 51 water pipe.
- Substitute all 6" and 8" water mains shall be PVC Class 200 water pipe except in all cases and in all cases secondary Thoroughfares as follows:
Note: PVC water pipe on services 1" and larger tapping saddles will be used.
- All water mains shall have a minimum cover below finished grades as follows: 6" & 8" - 48"
12" - 60"
Or as required to clear other utilities.
- All water services shall be 1" copper and located as shown.
- Due to soil resistivity readings of less than 2000 OHMS per C.C. all D.I. water pipe shall have 8 Mil. Thickness polyethylene tube wrap.

CITY OF DALLAS

CITY BIK. 8171

WINNWOOD ROAD

CITY BIK. 8173

CONTRACT No 64-96

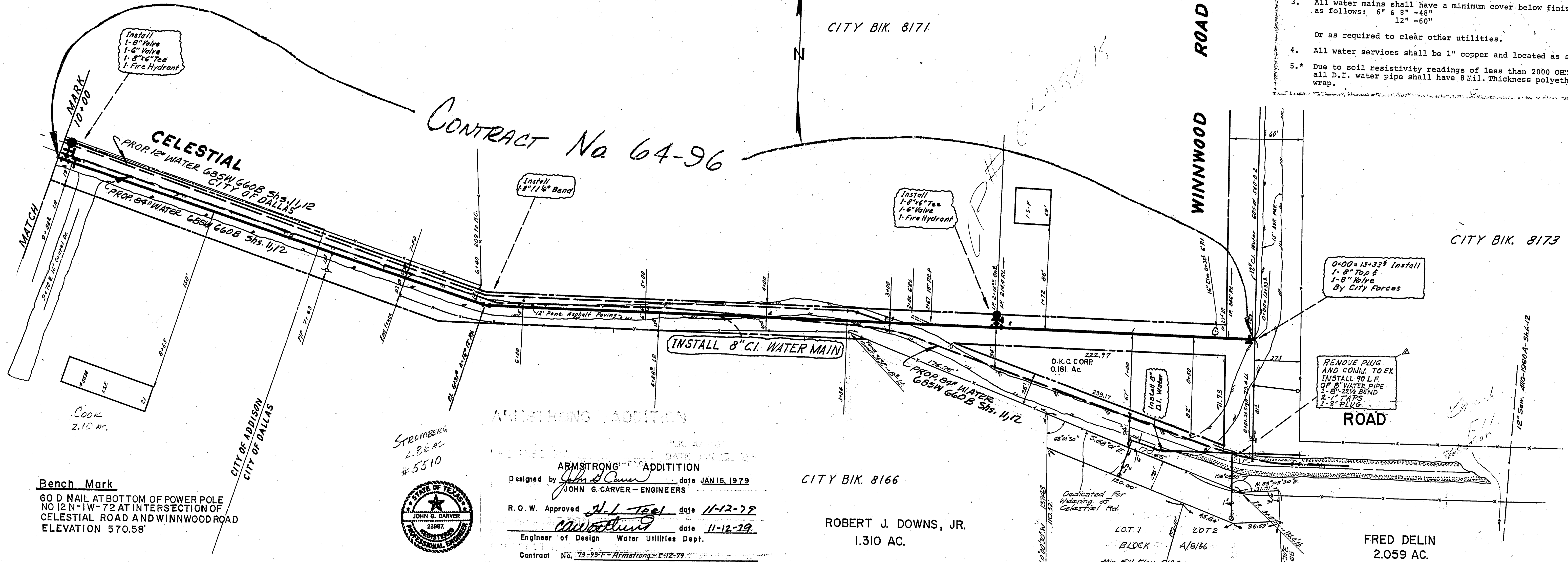

Bench Mark

60 D NAIL AT BOTTOM OF POWER POLE NO 12 N-1W-72 AT INTERSECTION OF CELESTIAL ROAD AND WINNWOOD ROAD ELEVATION 570.58'

STROMBERG
2.86 AC.
#5510

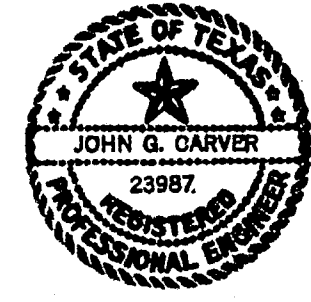

ARMSTRONG ADDITION
Designed by *John G. Carver* date JAN 15, 1979
JOHN G. CARVER - ENGINEERS
R.O.W. Approved *J.L. Teel* date 11-12-79
Carver date 11-12-79
Engineer of Design Water Utilities Dept.
Contract No. 79-93-P-Armstrong-2-12-79

CITY BIK. 8166

ROBERT J. DOWNS, JR.
1.310 AC.

FRED DELIN
2.059 AC.

Sta 10+00

610
605
600
595
590

590
585
580
575
570
565

B.M. RR Spike in 30' Elm N.W. Cor. Celestial Rd. & Winnwood Rd. Elev. = 572.27
B.M. 3/8" I.P. in 8" NB Tree W. Side Noel Rd. 140' S. of E. Celestial Rd. Elev. = 626.06

REVISED BY CARVER 27-DEC-1979

8" C.I. WATER MAIN
IN CELESTIAL ROAD
FROM WINNWOOD RD. TO NOEL RD.
DALLAS CITY WATERWORKS
CITY OF DALLAS, TEXAS

DESIGN	DRAWN	DATE	SCALE	NOTES	FILE	NO.
Campbell	Royers	Sept '83	H: 1" = 40' V: 1" = 6'	BOONE CONT. #4616	685W	5400