

Second Installment
 Village On The Parkway
 Vol. 79057, Pg. 1765
 Abstract No. 157

CRV.#	Δ	R	T	L
1	2°16'51"	1256.93'	25.02'	50.04'
2	9°26'42"	1256.93'	103.84'	207.20'
3	11°30'26"	1256.93'	126.05'	252.02'
4	2°21'21"	1216.93'	25.02'	50.04'
5	9°45'28"	1216.93'	103.83'	207.25'
6	11°22'26"	1216.93'	121.19'	241.58'

J. Pancoast Survey, Abstract No. 1146
 Allen Gleason Survey, Abstr. No. 157

Verde Valley
 Parkway Place Addition No. 1
 Vol. 70702 Pg. 1934
 BLOCK A/8170

- General Notes:**
- All water mains shall be ductile iron class 51 water pipe with polyethylene wrap on Pipe, Fittings, and Fire Hydrant Bases.
 - Alternate - All 6" and 8" water mains shall be PVC class 200 water pipe except in Fill Areas and Major and Secondary Thoroughfares as follows:
 For PVC Service Taps 1" and larger, Tapping Saddle shall be used.
 - All water mains shall have a minimum cover below finished grades as follows: 6" & 8" - 48"; 12" - 60"; or as required to clear other utilities.

- BENCH MARKS**
- Standard Water Dept. Bench Mark Center Inlet - Northwest Corner Bellline Road and Dallas Parkway. Elev.: 632.08
 - "4" in Top of Fire Hydrant Southeast Corner Bellline Rd. and Dallas Pkwy. Elev.: 632.31

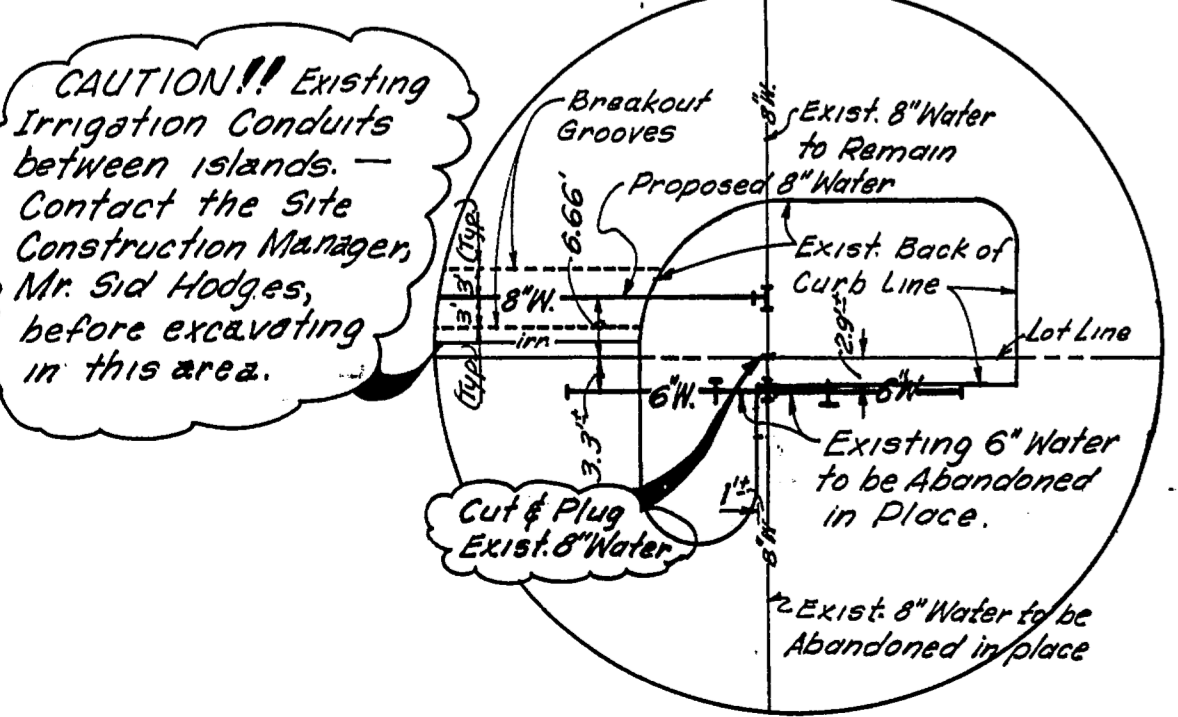

Detail A
 Scale: 1" = 20'

LOCATION: VILLAGE ON THE PARKWAY - PHASE I
 DESIGNED *Michael K. Gooding* DATE *March 08, 1981*
 ALBERT H. HALFF & ASSOCIATES, INC. ENGINEERS
 R.O.W. APPROVED: *Albert Halff* DATE: *6-1-81*
Cal West
 ENGINEER OF DESIGN - DALLAS WATER UTILITIES DEPT.
 CONTRACT No. 81-245-P-541mson Cont. Co. ~ May 23, 1981

WATER PLAN					
VILLAGE ON THE PARKWAY					
VILLAGE PARKWAY VENTURE					
CITY OF ADDISON, TEXAS					
DALLAS WATER UTILITIES, DEPT.					
DESIGN	DRAWN	DATE	SCALE	NOTES	FILE NO.
R.K.	J.L.	MAR 81	1"=40'	6898	411Q 1960