

CONTRACT NO. 63-84

BLK. 8173  
ABSTRACT No. 157

BLK. 8172  
ABSTRACT No. 157

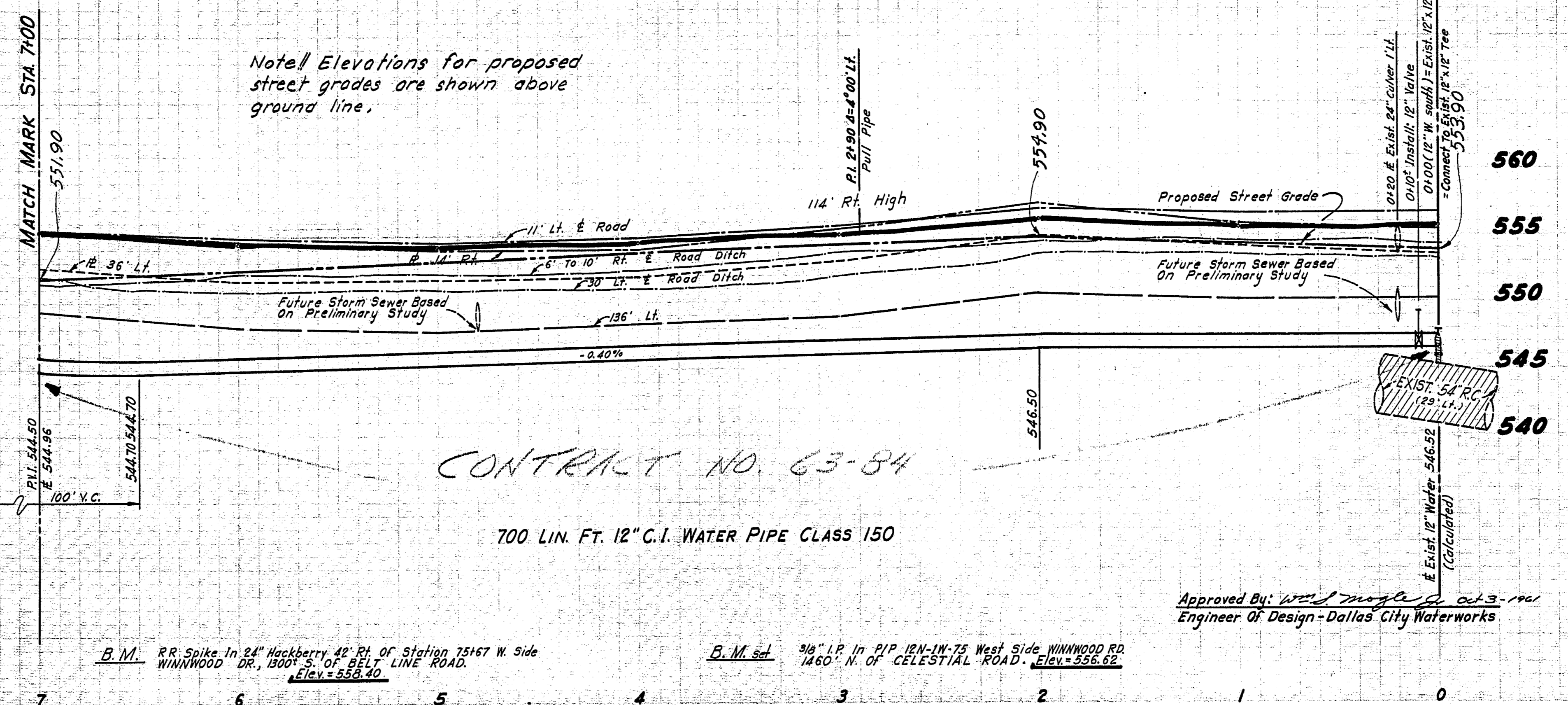

Note: Elevations for proposed street grades are shown above ground line.

CONTRACT NO. 63-84

700 LIN. FT. 12" C.I. WATER PIPE CLASS 150

Approved By: *[Signature]* Oct 3-1961  
Engineer of Design - Dallas City Waterworks

B.M. RR Spike in 24" Hackberry 42' Rt. of Station 75+67 W. Side WINNWOOD DR., 1300' S. OF BELT LINE ROAD. Elev = 558.40

B.M. set 3/8" I.P. in PIP 12N-1W-75 West Side WINNWOOD RD. 1460' N. OF CELESTIAL ROAD. Elev = 556.62

12" C.I. WATER MAIN						
IN WINNWOOD RD.						
FROM BELT LINE RD. TO CELESTIAL RD.						
DALLAS CITY WATERWORKS						
CITY OF DALLAS, TEXAS						
DESIGN	DRAWN	DATE	SCALE	NOTES	FILE	NO.
C.L. Moon Engrs	R.J.	July '61	H: 1"=40' V: 1"=6'	C.L. Moon	685-W-540-B	1