

Armstrong Add.
4110 1960A St. 11
685W 540D St. 1.

ABSTRACT No. 157

ABSTRACT No. 157
E 1-5-F

CONTRACT NO. 63-84
BLK.-8171

WINNWOOD

INSTALL: 12" C.I. WATER
(INGE ROAD No. 432)

ROAD

CELESTIAL ROAD NO. 63

Prop. 84" R.C. Water Pipe

STATION MARK
MATCH MARK
7+00

14+28 Install:
1-12" x 8" Cross
1-12" Valve
1-12" Plug (E.W.)
2-8" Plugs (E.W.)
Inst. 52' of
8" C.I. Water Pipe

13+70" Installation
3/4" Air Top Installation
As Per Appurt. Sht. 414D-11

1-5-F
BRICK
75'

ABSTRACT No. 157
E 1-5-F

Cont. No.
63-84

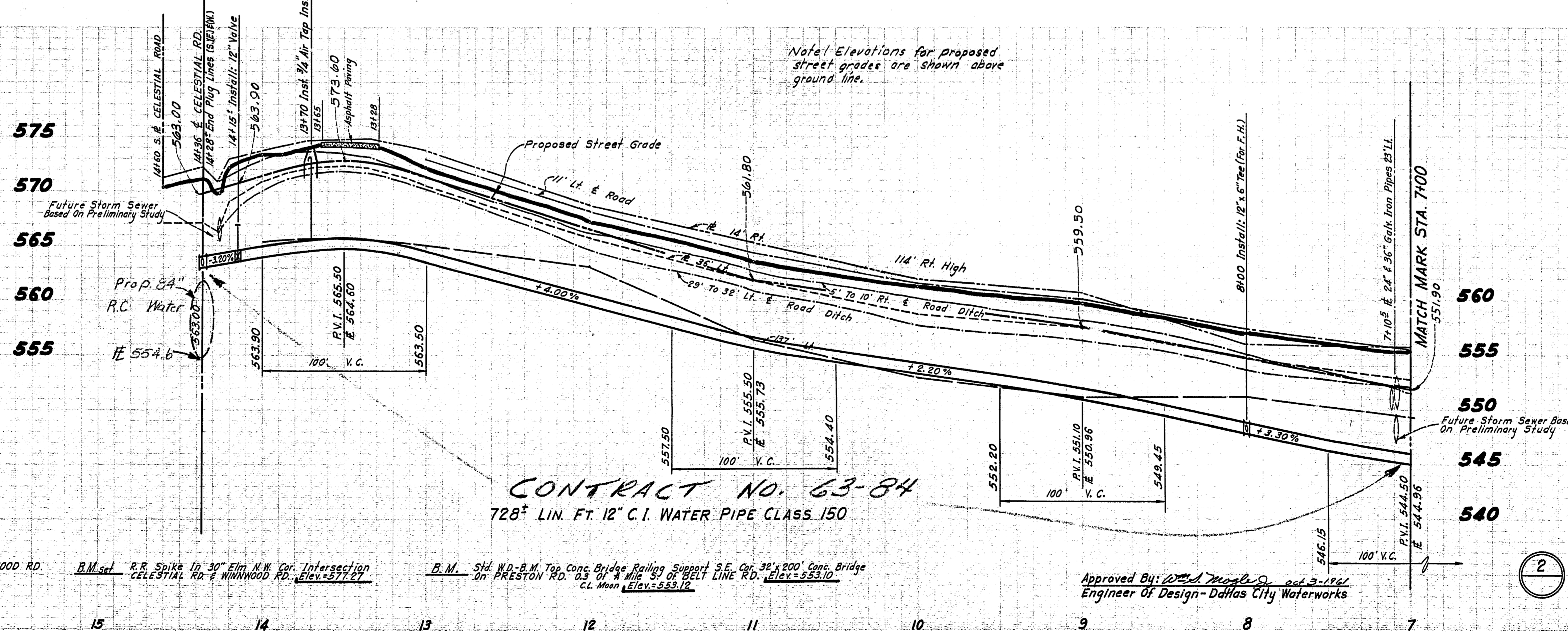

CONTRACT NO. 63-84
728' LIN. FT. 12" C.I. WATER PIPE CLASS 150

B.M. R.R. Spike In PIP # 12N-11-96 W. Side WINNWOOD RD.
600' S. OF CELESTIAL ROAD. Elev. = 559.59

B.M. S. 1 R.R. Spike In 30" Elm N.W. Cor. Intersection
CELESTIAL RD. & WINNWOOD RD. Elev. = 577.27

B.M. S. 1 S. 1/4 W.D. B.M. Top Conc. Bridge Railing Support S.E. Cor. 38' x 200' Conc. Bridge
On PRESTON RD. 0.3 OF A Mile S. OF BELT LINE RD. Elev. = 553.10
C.L. Moon Elev. = 553.12

Approved By: *[Signature]*
Engineer Of Design - Dallas City Waterworks

12" C.I. WATER MAIN						
IN WINNWOOD RD.						
FROM BELT LINE RD. TO CELESTIAL RD.						
DALLAS CITY WATERWORKS						
CITY OF DALLAS, TEXAS						
DESIGN	DRAWN	DATE	SCALE	NOTES	FILE	NO.
C.L. Moon Engrs	R.J.	July '61	H: 1" = 40' V: 1" = 6'	C.L. Moon	685-W540-B	