

NOTE:
AIRPORT SECURITY MUST BE MAINTAINED AT ALL TIMES. (NO OPEN GATES OR FENCES)

NOTE:
ALL EXISTING TAXIWAY LIGHTS & SIGN IN THE AREA OF NEW CONSTRUCTION SHALL BE RELOCATED PER ADDISON AIRPORT STANDARDS. COORDINATE WITH AIRPORT MANAGEMENT PRIOR TO DEMOLITION.

INSTALL 72LF OF 12" R.C.P. CULVERT UNDER NEW CONCRETE APPROACH WITH 12" TYPE B HEADWALL AT EACH END (REF CITY DALLAS STD 251D)

EX. STORM BOX INLET TOP=647.41

NEW FIRE HYDRANT BY R.O.W. PERMIT (SEE SHEET C102)

EXISTING 2-STORY OFFICE BUILDING TOP OF BLDG EL. 682.07' (15800 DOOLEY RD)

NEW GAS METER(S) (SEE SHEET C102 & MEP PLANS)

STA 0+27.5 - END LINE "B"
INSTALL 10' REC. INLET
TOP = 642.50'
F.L.(out) = 638.50'
N=1323.5000 E=1010.2500

STA 0+16 - END LINE "A"
INSTALL 6' REC. INLET
TOP = 644.50'
F.L.(out) = 642.43'
N=1141.2500 E=1010.2500

INSTALL 16 LF. OF 12" R.C.P. AT 0.011

STA 0+00 - LINE "B"
CONNECT 18" R.C.P. TO EXIST. 30" R.C.P. BY "R.O.W." PERMIT
F.L.(in) = 638.19' (FIELD VERIFY)
N=1329.4200 E=983.3709

STA 0+00 - LINE "A"
CONNECT 12" R.C.P. TO EX. CURB INLET BY "R.O.W." PERMIT
F.L.(in) = 642.25'
N=1141.2500 E=994.2497

NOTE:
ALL PUBLIC UTILITIES (WATER, SEWER, ELECTRIC, ETC.) SERVING THE EXISTING BUILDING TO BE REMOVED SHALL BE ABANDONED AT THE SERVICE POINT IN ACCORDANCE WITH CITY OF ADDISON STANDARDS

NOTE:
SEE SHEET C601 FOR STORM DRAIN PROFILES AND DETAILS

NOTE:
SEE SHEET C600 FOR GENERAL CIVIL NOTES

NOTE:
SEE SHEET C602 FOR SITING & PAVING DETAILS

PLAN LEGEND			
	= EX. DRAINAGE FLOW		= EXISTING FIRE HYDRANT
	= NEW DRAINAGE FLOW		= EX. WASTEWATER MANHOLE
	= EXISTING CONTOUR		= NEW FIRE HYDRANT
	= NEW GRADING CONTOUR		= NEW WW MANHOLE
	= NEW PAVING CONTOUR		= NEW WASTEWATER MAIN
	= EX. SPOT ELEVATION		= NEW WATER MAIN
	= EX. SPOT ELEVATION		= NEW WATER VALVE
	= NEW SPOT ELEVATION		= EXISTING WATER VALVE
	= EXISTING FENCE		= NEW WATER VALVE
	= DRAINAGE DIVIDE		= NEW STORM SEWER PIPE
	= EROSION CONTROL BARRIER		= NEW STORM SEWER MH
	= EXISTING TREE(S)		= EX. CURB INLET
	= EXISTING TREE(S)		= NEW STORM DRAIN INLET

BENCHMARKS				
MARK	DESCRIPTION	ELEV.	N	E
BM1	SQUARE CUT OF THE SOUTHWEST TOP OF CURB CORNER THE BACK SIDE PARKING LOT AT 15950 MIDWAY ROAD	637.75'		
CM1	"X" CUT ON CONCRETE, ALSO BEING THE SOUTHWEST PROPERTY CORNER OF LOT 1, BLOCK A	647.37'	1000.0000	1000.0000
CM2	NORTHWEST PROPERTY CORNER OF THE 0.528 ACRE TRACT, BEING A DISTANCE OF 515.80' NORTH OF THE SOUTHWEST PROPERTY CORNER OF LOT 1, BLK A		1515.8000	1000.0000

NOTE:
1. ALL TOPOGRAPHIC ELEVATIONS ARE BASED ON BENCHMARK "BM1".
2. NORTHERLY AND EASTERLY BEARINGS NOTED ABOVE ARE FOR HORIZONTAL CONTROL.

STORM DRAIN - LINE "A"	
LOCATION	DESCRIPTION
(A)	STA 0+00 LINE "A" CONNECT (BY PERMIT) 12" R.C.P. TO EXISTING CURB INLET F.L. (IN) = 642.25'
(B)	STA 0+16 END LINE "A" INSTALL: 1 - 6' REC. CURB INLET TOP ELEV. = 644.50' F.L. (OUT) = 642.43'

STORM DRAIN - LINE "B"	
LOCATION	DESCRIPTION
(A)	STA 0+00 LINE "B" CONNECT (BY PERMIT) 18" R.C.P. TO EXISTING 30" STORM DRAIN F.L. (IN) = 638.19' (FIELD VERIFY)
(B)	STA 0+27.50 END LINE "B" INSTALL: 1 - 10' REC. CURB INLET TOP ELEV. = 642.50' F.L. (OUT) = 638.50'

GENERAL PLAN NOTES

- SEE SHEET C600 FOR GENERAL CIVIL NOTES AND ONSITE UTILITY EASEMENT(S).
- SEE SHEET C601 FOR STORM DRAIN PROFILES.
- SEE SHEET C602 FOR SITING AND PAVING DETAILS.
- CONSTRUCTION ACTIVITY SHALL CONFORM TO ALL CITY OF ADDISON REQUIREMENTS. CONTRACTOR SHALL BE RESPONSIBLE TO OBTAIN ALL APPLICABLE PERMITS FOR THIS PROJECT.
- THE CONTRACTOR SHALL BE RESPONSIBLE TO VERIFY AND MARK THE LOCATION OF ALL UNDERGROUND UTILITIES PRIOR TO BEGINNING ANY CONSTRUCTION ACTIVITY.
- ALL WORK SHALL BE DONE TO THE LINES, GRADES, AND ELEVATIONS SHOWN ON THESE DRAWINGS. BASIC HORIZONTAL AND VERTICAL CONTROL POINTS, ESTABLISHED BY THE ENGINEER ARE SHOWN ON THESE PLANS. THESE POINTS SHALL BE USED AS DATUM FOR WORK UNDER THIS PROJECT. ALL ADDITIONAL SURVEY LAYOUT OR MEASUREMENT WORK SHALL BE PERFORMED BY THE CONTRACTOR AS A PART OF THE WORK UNDER THIS CONTRACT.
- ALL STORM SEWER PIPE AND WYES SHALL CONSIST OF REINFORCED CONCRETE PIPE (R.C.P.).
- ALL CURB INLETS, STORM SEWER MANHOLES, AND CONCRETE HEADWALLS SHALL BE SUPPLIED AND INSTALLED PER CITY OF DALLAS PUBLIC WORKS STANDARDS FILE 251D-1, AND SHALL INCLUDE ALL NECESSARY APPURTENANCES FOR A COMPLETE JOB.
- CONSTRUCTION ACTIVITY SHALL CONFORM TO ALL CITY OF ADDISON REQUIREMENTS. CONTRACTOR SHALL BE RESPONSIBLE TO OBTAIN ALL APPLICABLE PERMITS FOR THIS PROJECT, UNLESS OTHERWISE AGREED.

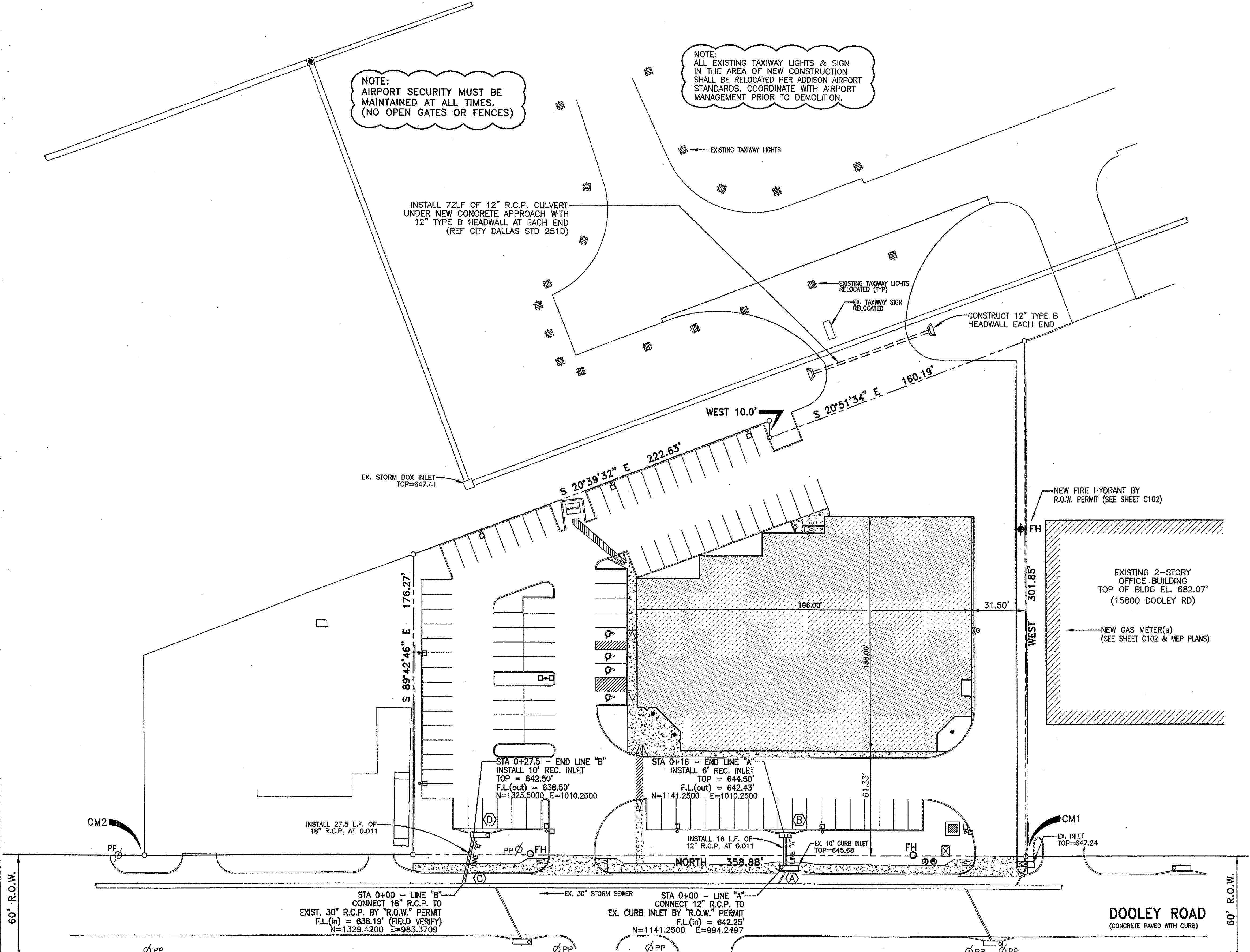

01 DIMENSION CONTROL PLAN - STORM DRAIN

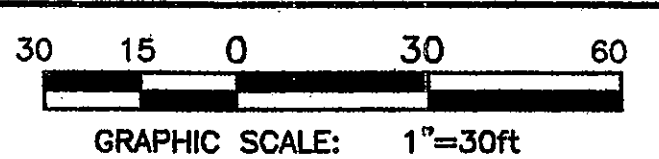

CARRERA consulting engineers, inc.
Structural, Civil, & Construction Engineering

3930 Meredith Avenue Dallas, Texas 75211 Tel: (214) 330-4771 Fax: (214) 330-2167

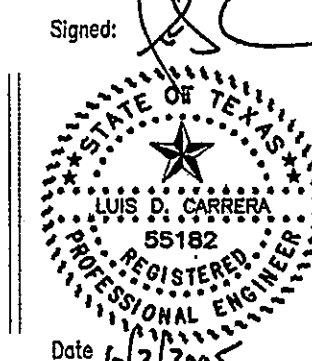

EXPIRATION DATE:
AFFIXATION DATE:

Addison Design Group, LLC
Interior Architecture
1750 North Collins Blvd., Suite 214
Richardson, Texas 75080
Tel: (972) 457-4611 Fax: (972) 671-9101

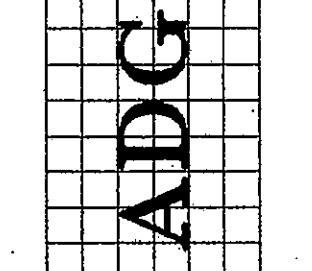

AIRCORP ROAD
15900 DOOLEY ROAD
ADDISON, TEXAS

Job No.
00018

Plan No.

Date
31 JAN 2005

Drawn By
Ccai

Revisions
19 MAY 2005
02 JUN 2005

Sheet Title
DIMENSION CONTROL PLAN
STORM DRAIN

Sheet No.

C201

of 16