

- NOTES:
- WHERE NEW PAVEMENT ABUTS EXISTING PAVEMENT, PROVIDE #5 SMOOTH STEEL REINFORCING BAR DOWELED INTO EXISTING PAVEMENT, A MINIMUM OF 9-INCHES, SECURED WITH EPOXY A104 (OR EQUAL) AND SPACED AT 18-INCH CENTERS. DOWELS SHALL BE NON-LUBRICATED.
 - SEE TYPICAL DETAIL THIS SHEET FOR CONCRETE PAVEMENT EXPANSION & CONTROL JOINTS.
 - CONCRETE TO HAVE MINIMUM 4000 PSI COMPRESSIVE STRENGTH AT 28 DAYS AND A MINIMUM CEMENT CONTENT OF 6 SACKS PER CUBIC YARD OF CONCRETE.

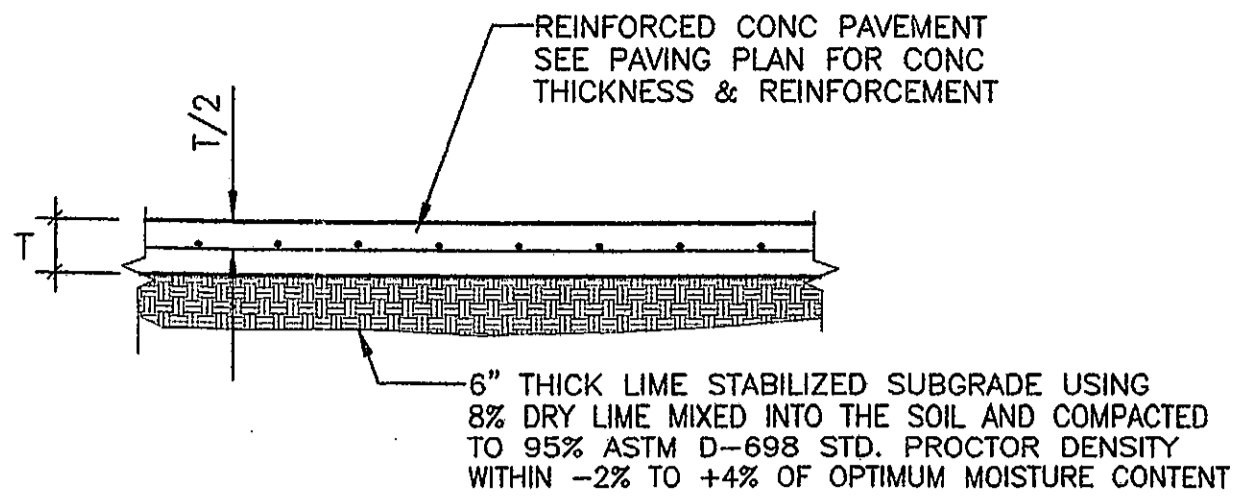

TYP SECTION - CONCRETE PAVEMENT OVER LIME STABILIZED SUBGRADE
not to scale

NOTES:

- NON-LUBRICATED SMOOTH DOWEL BARS SHALL BE DRILLED INTO PAVEMENT HORIZONTALLY BY USE OF A MECHANICAL RIG. DRILLING BY HAND IS NOT ACCEPTABLE. PUSHING DOWEL BARS INTO GREEN CONCRETE IS NOT ACCEPTABLE.

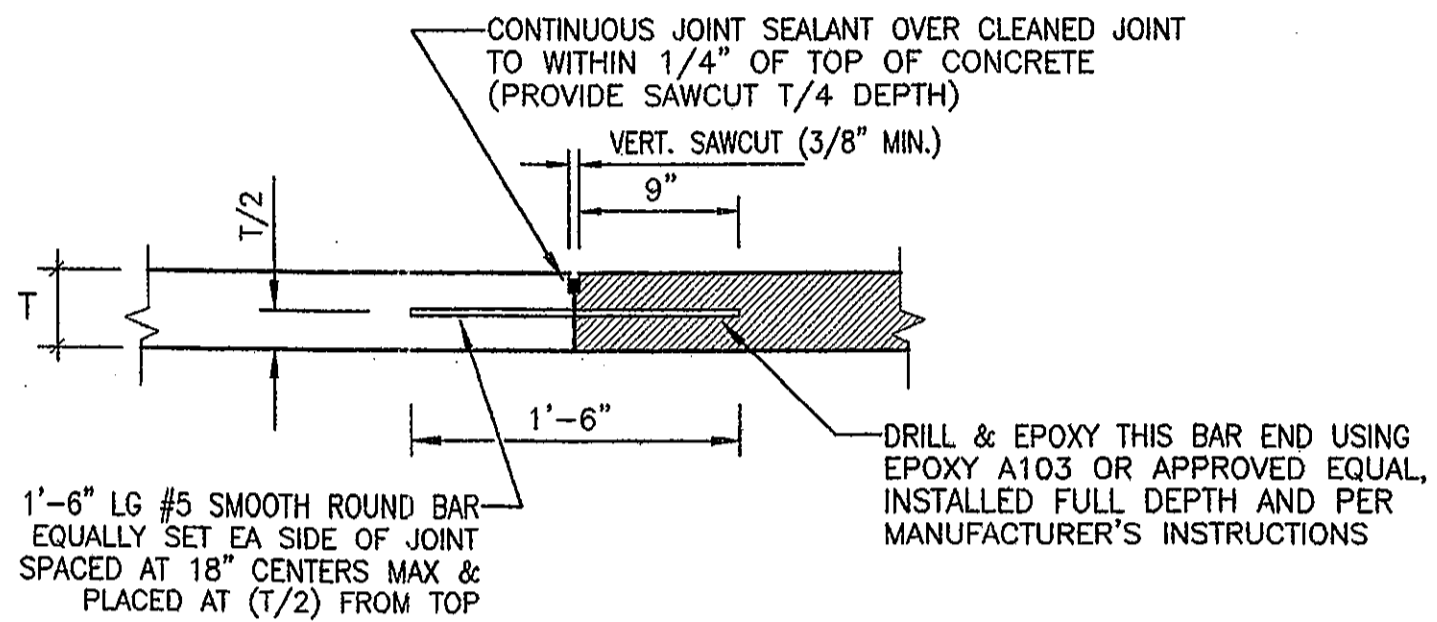

TYP SECTION - CONCRETE PAVEMENT CONNECTION TO EXISTING PAVEMENT
not to scale

NOTES:

- SLOPE SIDEWALKS TO DRAIN IN DIRECTION OF WATER FLOW, NOT TO EXCEED 5% SLOPE.
- SIDEWALKS ADJACENT TO BUILDINGS, SHALL SLOPE AWAY FROM BUILDING NOT TO EXCEED 2% SLOPE.
- WHERE NEW SIDEWALKS ABUT EXISTING SIDEWALKS, PROVIDE #3 STEEL REINFORCING BARS DOWELED INTO EXISTING SIDEWALK, A MINIMUM OF 6-INCHES, SECURED WITH EPOXY AND SPACED AT 12-INCH CENTERS.
- SEE TYPICAL DETAIL THIS SHEET FOR CONCRETE SIDEWALK EXPANSION & CONTROL JOINTS.
- CONCRETE SIDEWALK FINISH TO BE LIGHT BRUSH OR SWEAT FINISH.
- CONCRETE TO HAVE MINIMUM 4000 PSI COMPRESSIVE STRENGTH AT 28 DAYS AND A MINIMUM CEMENT CONTENT OF 6 SACKS PER CUBIC YARD OF CONCRETE.

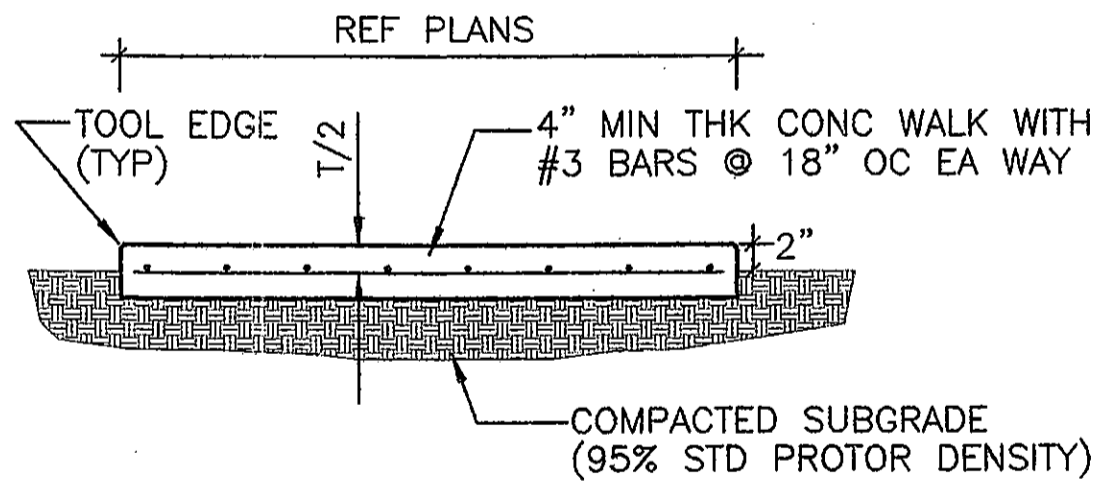

TYP SECTION - REINFORCED SIDEWALK
not to scale

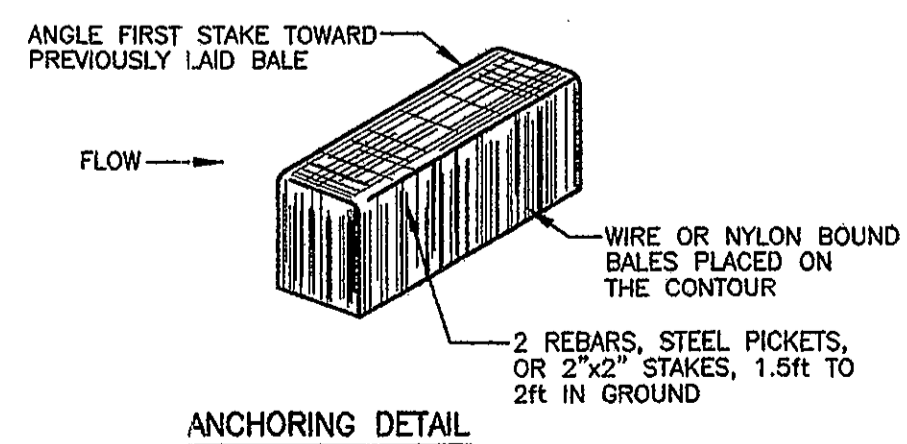
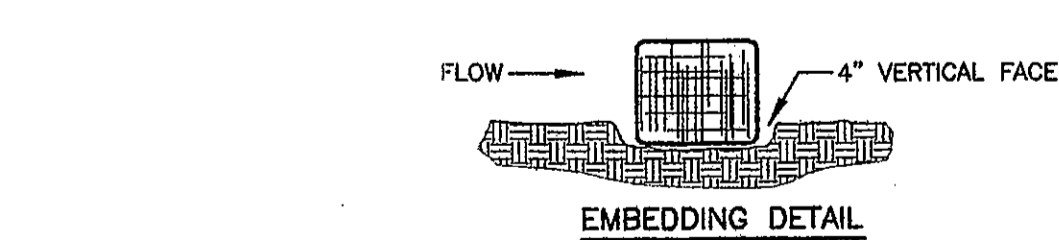

TYP EROSION CONTROL DEVICE - HAY BALE BARRIER
not to scale

- NOTES:
- WHERE NEW CURB EXISTING CURB, PROVIDE 24" LG #3 DEFORMED STEEL REINFORCING BAR DOWELED INTO EXISTING CURB, A MINIMUM OF 12-INCHES, SECURED WITH EPOXY A103 (OR EQUAL). DOWELS SHALL BE NON-LUBRICATED.
 - SEE TYPICAL DETAIL THIS SHEET FOR CONNECTION TO EXISTING CURB.
 - CONCRETE TO HAVE MINIMUM 4000 PSI COMPRESSIVE STRENGTH AT 28 DAYS AND A MINIMUM CEMENT CONTENT OF 6 SACKS PER CUBIC YARD OF CONCRETE AND SHALL BE PLACED MONOLITHICALLY.

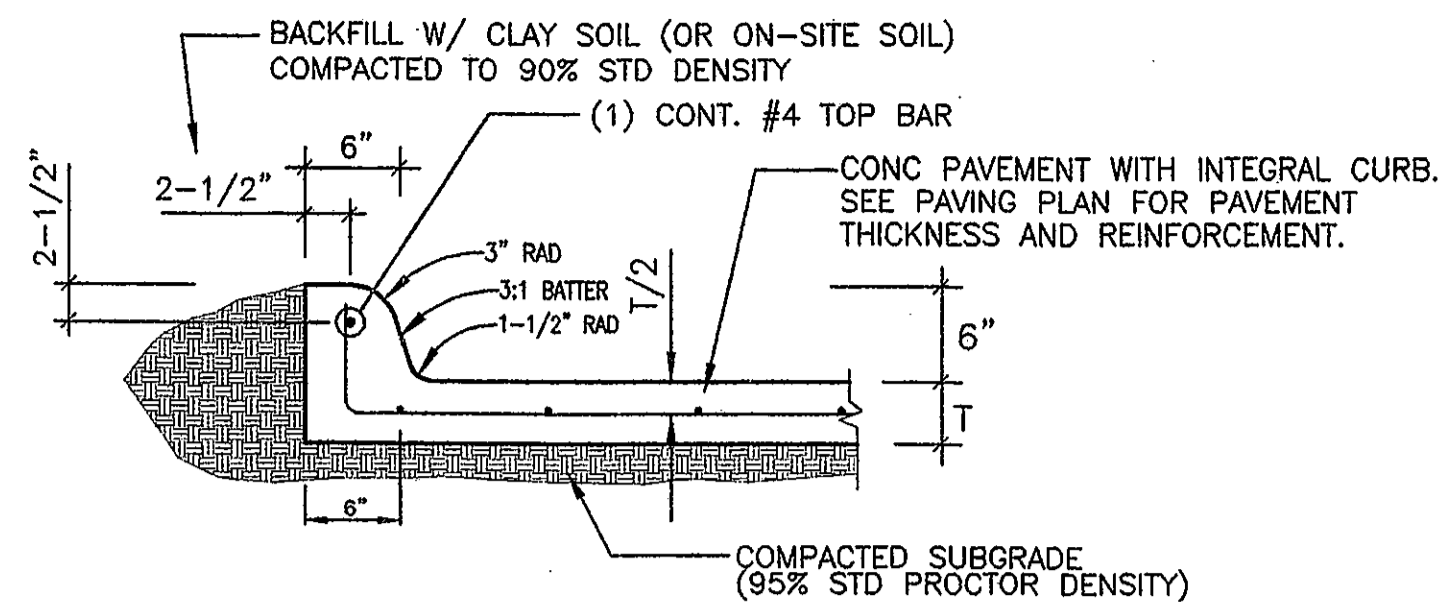

TYP PAVEMENT SECTION W/ INTEGRAL CURB
not to scale

NOTES:

- NON-LUBRICATED DEFORMED DOWEL BARS SHALL BE DRILLED INTO CURB HORIZONTALLY BY USE OF A MECHANICAL RIG. DRILLING BY HAND IS NOT ACCEPTABLE. PUSHING DOWEL BARS INTO GREEN CONCRETE IS NOT ACCEPTABLE.

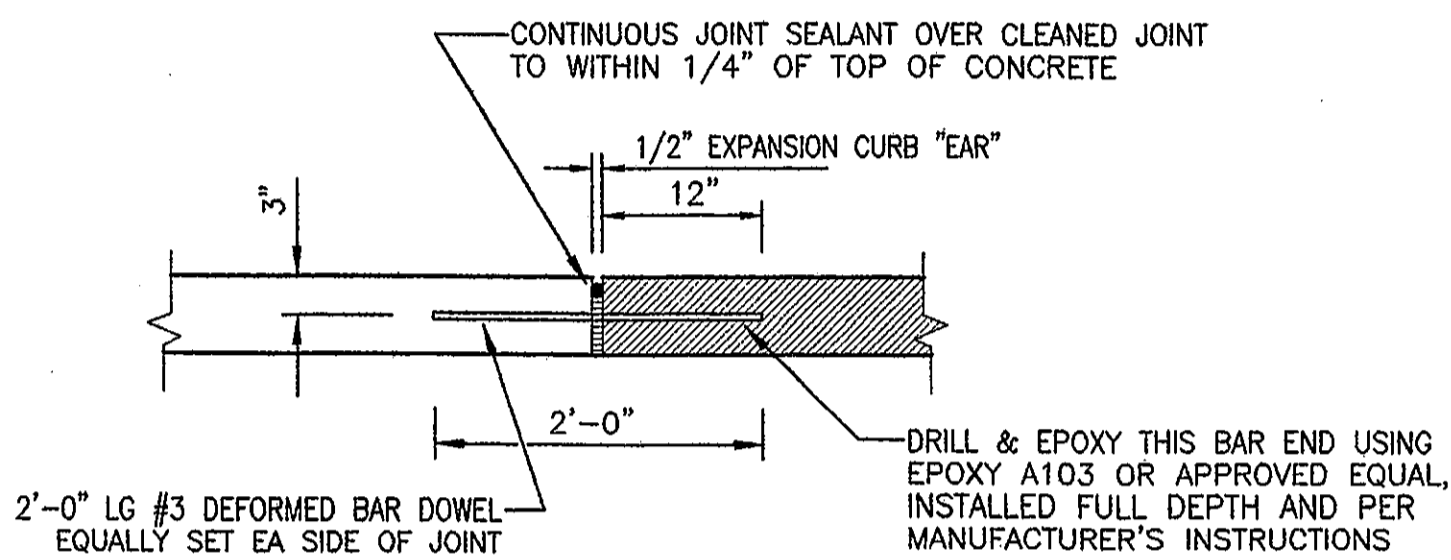

TYP SECTION - CONCRETE CURB CONNECTION TO EXISTING CURB
not to scale

NOTES:

- SLOPE SIDEWALKS TO DRAIN IN DIRECTION OF WATER FLOW, NOT TO EXCEED 5% SLOPE.
- SIDEWALKS ADJACENT TO BUILDINGS, SHALL SLOPE AWAY FROM BUILDING NOT TO EXCEED 2% SLOPE.
- WHERE NEW SIDEWALKS ABUT EXISTING SIDEWALKS, PROVIDE #3 STEEL REINFORCING BARS DOWELED INTO EXISTING SIDEWALK, A MINIMUM OF 6-INCHES, SECURED WITH EPOXY AND SPACED AT 12-INCH CENTERS.
- SEE TYPICAL DETAIL THIS SHEET FOR CONCRETE SIDEWALK EXPANSION & CONTROL JOINTS.
- CONCRETE SIDEWALK FINISH TO BE LIGHT BRUSH OR SWEAT FINISH.
- CONCRETE TO HAVE MINIMUM 4000 PSI COMPRESSIVE STRENGTH AT 28 DAYS AND A MINIMUM CEMENT CONTENT OF 6 SACKS PER CUBIC YARD OF CONCRETE.

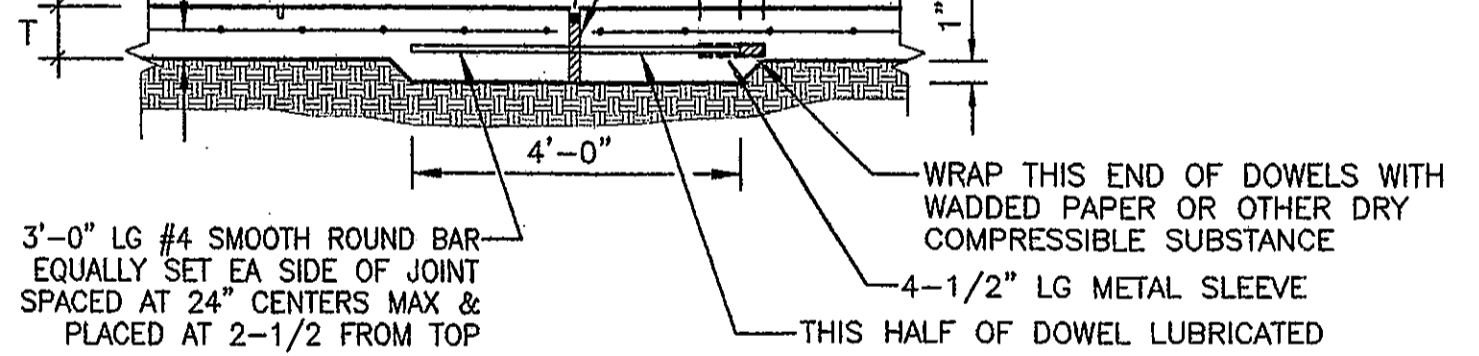

TYP SECTION - CONCRETE SIDEWALK EXPANSION AND CONTROL JOINTS
not to scale

NOTES:

- SET THE STAKES.
- EXCAVATE A 6" X 6" TRENCH UPSLOPE ALONG THE LINE OF STAKES.
- STAPLE FILTER MATERIAL TO STAKES AND EXTEND IT INTO THE TRENCH.
- BACKFILL AND COMPACT THE EXCAVATED SOIL.

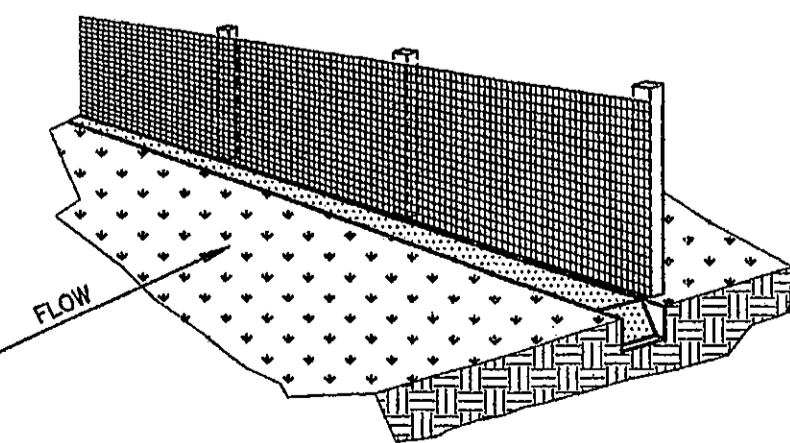

TYP EROSION CONTROL DEVICE - SILT FENCE BARRIER
not to scale

- NOTES:
- SEE PAVING PLAN FOR PAVEMENT GRADES.
 - SEE TYPICAL DETAIL THIS SHEET FOR PAVEMENT CONNECTION TO EXISTING CONCRETE.
 - CONCRETE TO HAVE MINIMUM 4000 PSI COMPRESSIVE STRENGTH AT 28 DAYS AND A MINIMUM CEMENT CONTENT OF 6 SACKS PER CUBIC YARD OF CONCRETE AND SHALL BE PLACED MONOLITHICALLY.

NOTE:
LIMITS OF 8" THK. CONC. APPROACH PAVEMENT IS FROM EXISTING CITY PAVEMENT TO PROPERTY LINE

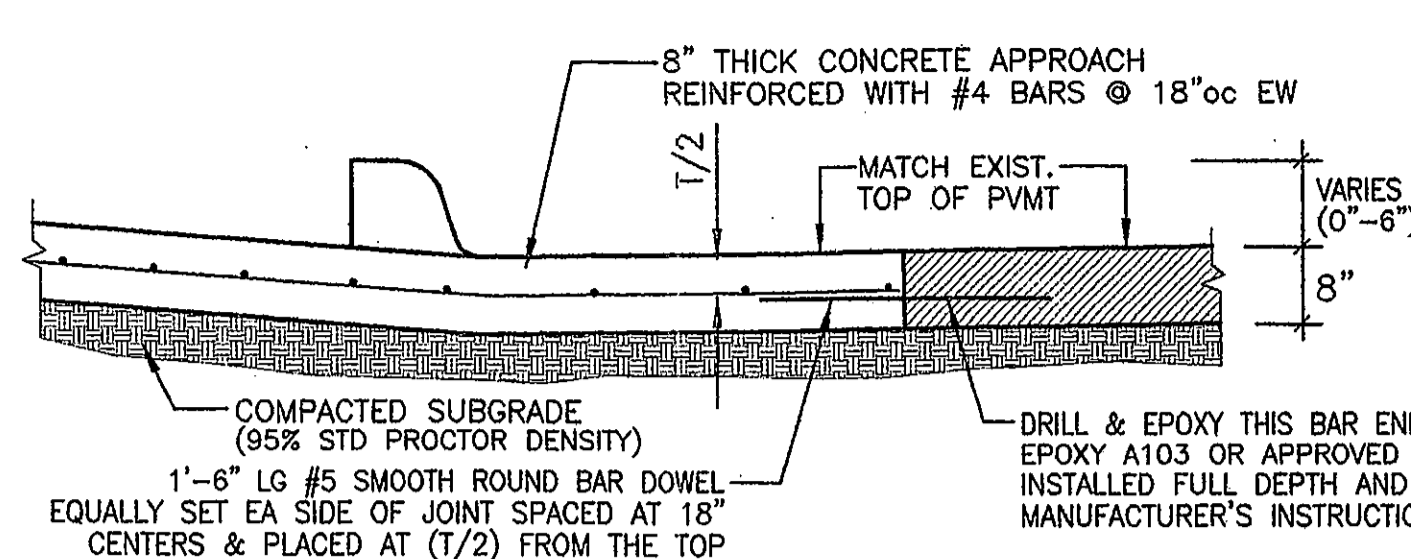

TYP SECTION - CONCRETE APPROACH
not to scale

NOTES:

- SEE TYPICAL DETAIL THIS SHEET FOR CONCRETE PAVEMENT EXPANSION & CONTROL JOINTS.
- CONCRETE TO HAVE MINIMUM 4000 PSI COMPRESSIVE STRENGTH AT 28 DAYS AND A MINIMUM CEMENT CONTENT OF 6 SACKS PER CUBIC YARD OF CONCRETE.

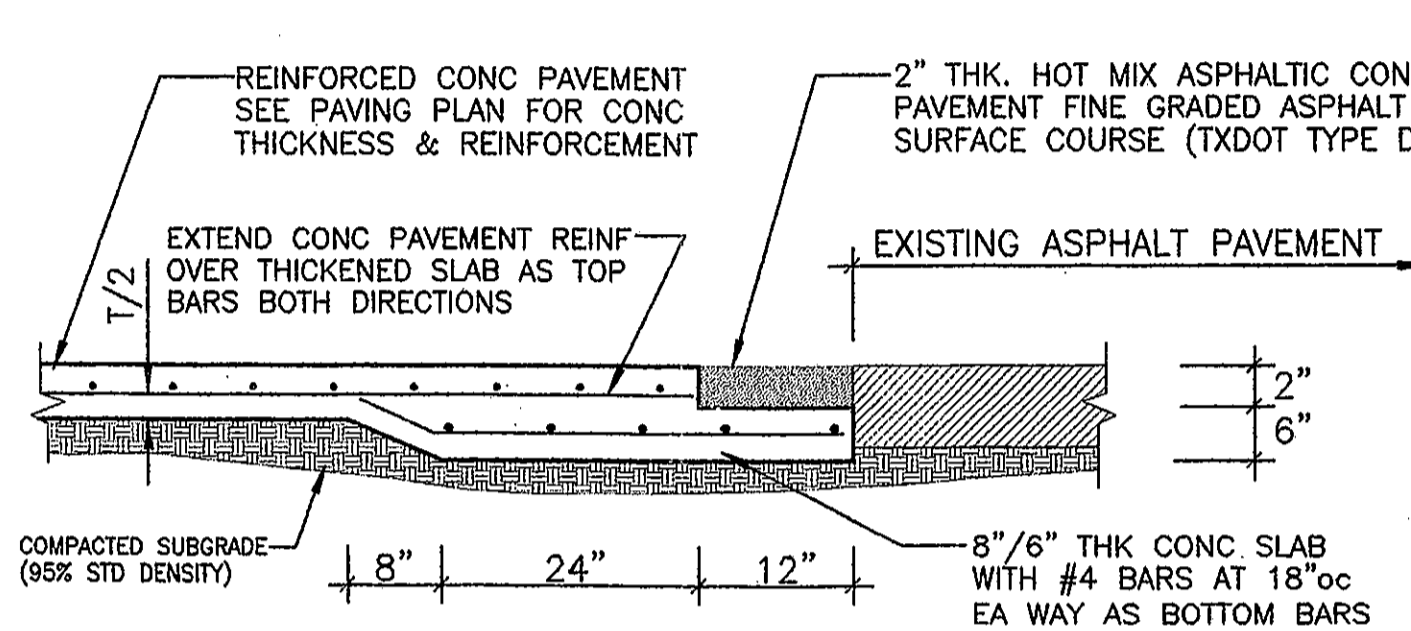

TYP SECTION - CONC CONNECTION TO EXISTING ASPHALT PAVEMENT
not to scale

NOTES:

- SEE TYPICAL DETAIL THIS SHEET FOR CONCRETE PAVEMENT EXPANSION & CONTROL JOINTS.
- CONCRETE TO HAVE MINIMUM 4000 PSI COMPRESSIVE STRENGTH AT 28 DAYS AND A MINIMUM CEMENT CONTENT OF 6 SACKS PER CUBIC YARD OF CONCRETE.

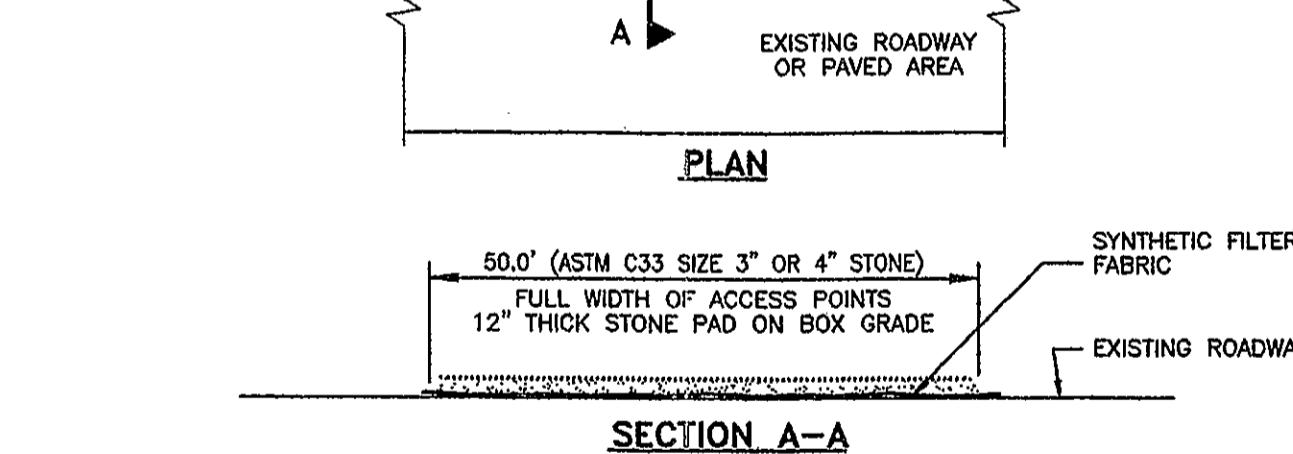

TYP EROSION CONTROL - STABILIZED CONST ENTRANCE
not to scale

NOTES:

- HARDWARE CLOTH OR COMPARABLE WIRE MESH WITH 1/2" OPENINGS SHALL BE PLACED OVER THE CURB INLET OPENING SO THAT AT LEAST 12" OF WIRE EXTENDS ACROSS THE INLET COVER AND AT LEAST 12" OF WIRE EXTENDS ACROSS THE GUTTER FROM THE INLET OPENING, AS ILLUSTRATED.
- STONE SHALL BE PILED AGAINST THE WIRE SO AS TO ANCHOR IT AGAINST THE GUTTER AND INLET COVER AND TO COVER THE INLET OPENING COMPLETELY. TWO (2) TO THREE (3) INCH COARSE AGGREGATE SHALL BE USED.
- IF THE STONE FILTER BECOMES CLOGGED WITH SEDIMENT SO THAT IT NO LONGER ADEQUATELY PERFORMS ITS FUNCTION, THE STONE MUST BE PULLED AWAY FROM THE INLET, CLEANED AND REPLACED.

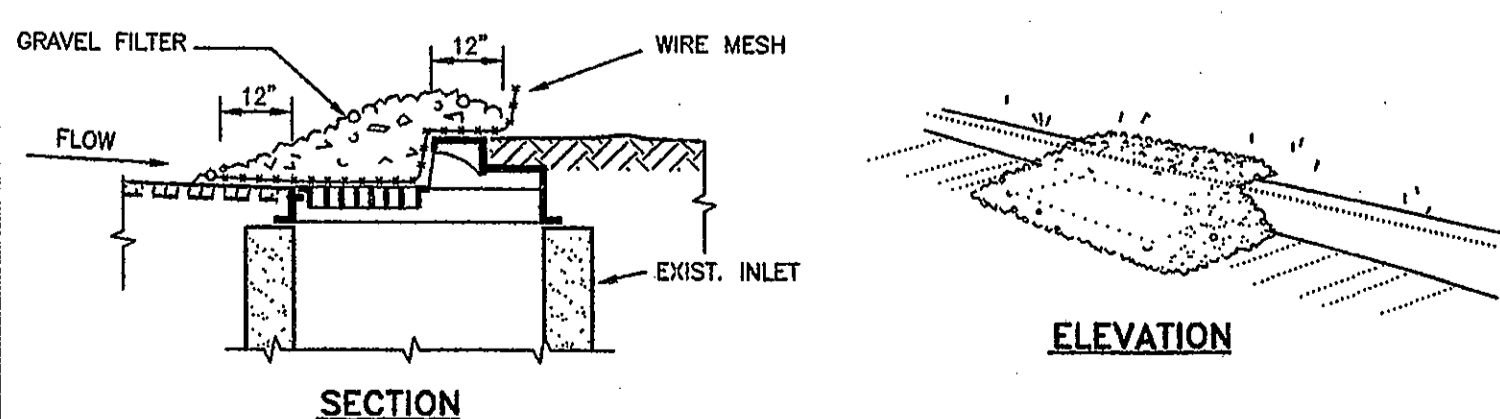

TYP EROSION CONTROL DEVICE - INLET PROTECTION
not to scale

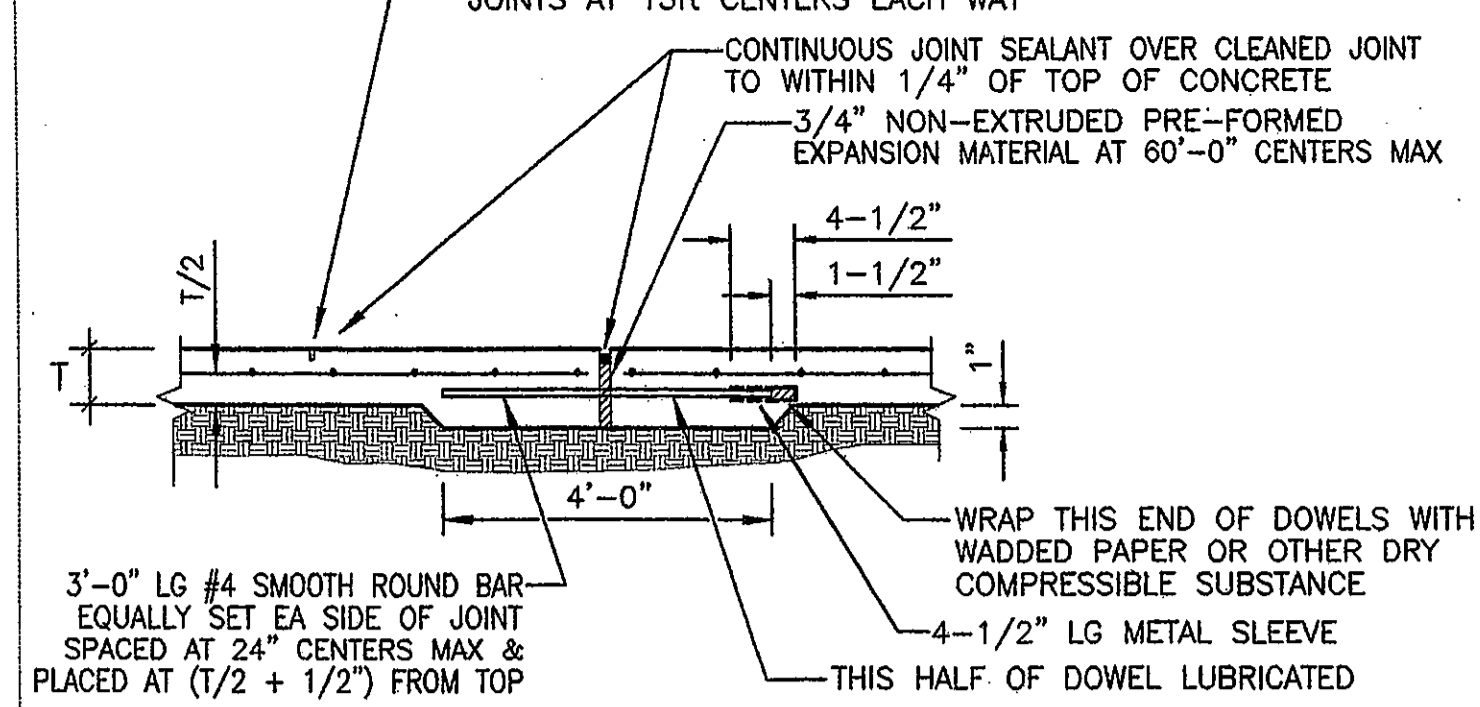

TYP SECTION - CONCRETE PAVEMENT EXPANSION AND SAWED CONTROL JOINTS
not to scale

NOTES:

- ALL ACCESSIBLE CURB RAMPS SHALL HAVE SLOPES, TEXTURE, AND CONTRAST TO CONFORM WITH THE ACCESSIBILITY STANDARDS ADOPTED BY THE TEXAS DEPARTMENT OF LICENSING AND REGULATION COMPLYING WITH THE TEXAS ARCHITECTURAL BARRIERS ACT, ARTICLE 9102, TEXAS CIVIL STATUTES

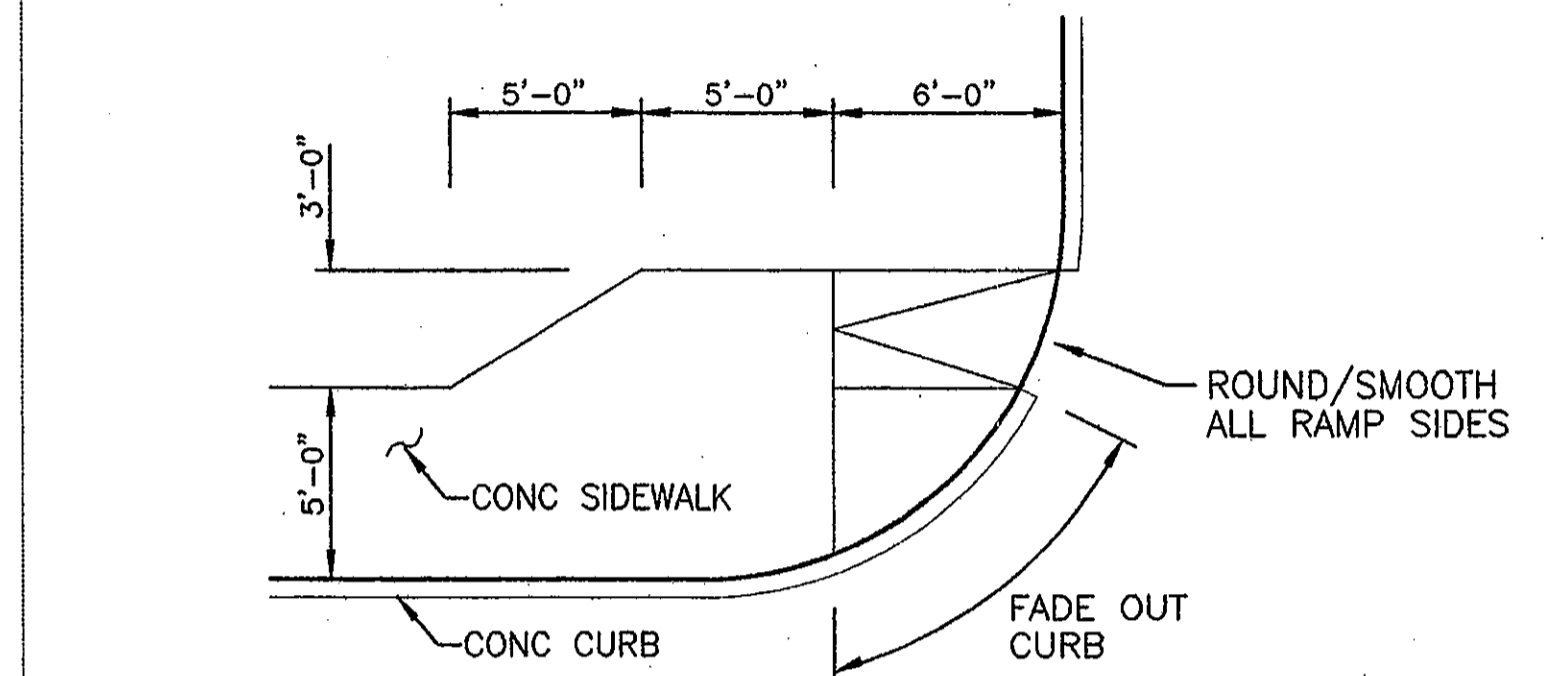

BARRIER FREE RAMP AT DRIVE
not to scale

NOTES:

- ALL ACCESSIBLE CURB RAMPS SHALL HAVE SLOPES, TEXTURE, AND CONTRAST TO CONFORM WITH THE ACCESSIBILITY STANDARDS ADOPTED BY THE TEXAS DEPARTMENT OF LICENSING AND REGULATION COMPLYING WITH THE TEXAS ARCHITECTURAL BARRIERS ACT, ARTICLE 9102, TEXAS CIVIL STATUTES

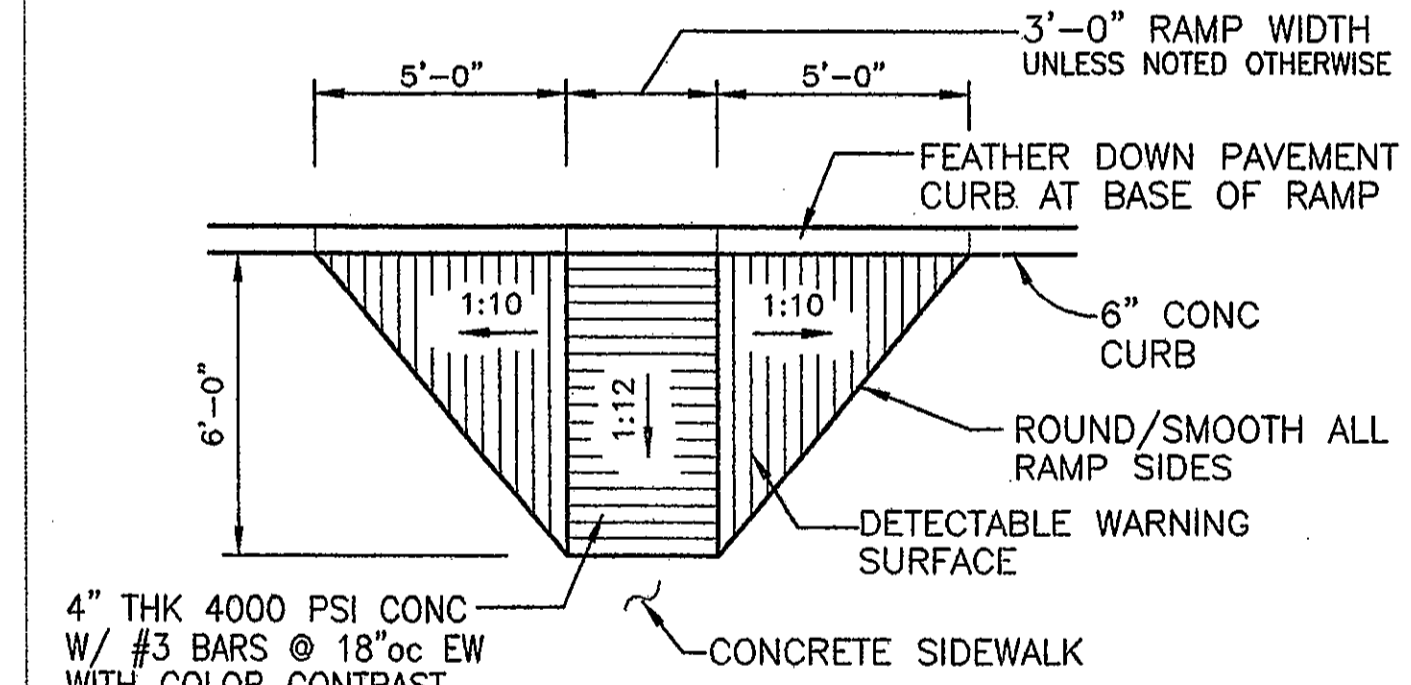

TYP PLAN - BARRIER FREE CURB RAMP
not to scale

EXPIRATION DATE:

AFFIXATION DATE:

Addison Design Group, LLC

Architecture - Interior Architecture
1750 North Collins Blvd., Suite 214
Richardson, Texas 75081
Tel: (972) 457-4611 Fax: (972) 671-0181

ADG

AIRCORP
15900 DOOLEY ROAD
ADDISON, TEXAS

Job No.

00018

Plan No.

Date

31 JAN 2005

Drawn By

Ccei

Revisions

▲ 19 MAY 2005

▲ 02 JUN 2005

▲

Sheet Title

SITWORK
AND
PAVING
DETAILS

Sheet No.

C602

of 16

CARRERA consulting engineers, inc.
Structural, Civil, & Construction Engineering

3930 Meredith Avenue
Dallas, Texas 75211

Tel: (214) 330-4771
Fax: (214) 330-2167

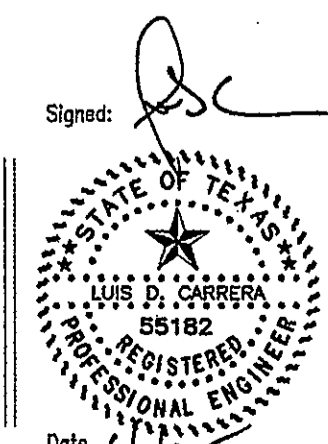

Date: 1/27/05