

ROOM SCHEDULE

RM NO	ROOM NAME
101	VESTIBULE
102	LOBBY
103	RECEPTION
104	AT OFFICE
105	QATS
106	TOWER MANAGER
107	MAIL/FAX/COPY ROOM
108	BREAKROOM
109	STORAGE
110	CORRIDOR
111	AF OFFICE
112	RMM/LIS/MMS ROOM
113	ELECTRONIC ROOM
114	TELCO
115	MATERIAL STORAGE
116	AT/AR/CBI TRAINING RM
117	AT/AF STORAGE
118	CORRIDOR
119	ESU SHOP
120	MEN'S TOILET
121	WOMEN'S TOILET
122	LINK
123	AT/AF CONFERENCE RM
124	MECH/ELEC ROOM
125	TOILET/SHOWER
126	E/G ROOM
127	WORKROOM
128	UPS
129	CABLE ACCESS ROOM

- NOTES:**
1. REFERENCE SHEET A01 FOR ARCHITECTURAL GENERAL NOTES AND BUILDING STATISTICS.
 2. REFERENCE SHEET G03 FOR ABBREVIATIONS AND SHEET G04 FOR LEGENDS.
 3. CONTRACTOR SHALL PROVIDE EDGE TRIM NECESSARY TO INSTALL CEMENT BOARD SOFFIT. PAINT SOFFIT WHITE.

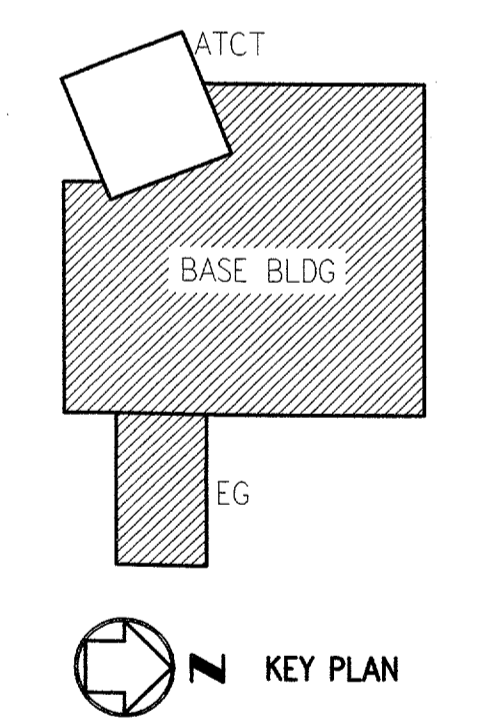

A16

REV.	DATE	DESCRIPTION	DFTG.	CHECKED

James E. Harper
6/22/01

PARSONS
DALLAS, TX

DEPARTMENT OF TRANSPORTATION
FEDERAL AVIATION ADMINISTRATION
SOUTHWEST REGION FORT WORTH, TEXAS

LOW ACTIVITY LEVEL
AIRPORT TRAFFIC CONTROL TOWER

REFLECTED CEILING PLAN
BASE-EG BUILDING

ADDISON (ADDISON AIRPORT) TEXAS

SUBMITTED BY: <i>Gary Williams</i> SYSTEMS ENGINEER, ANI-640	APPROVED BY: <i>Chris Callahan</i> MANAGER TERMINAL PLATFORM, ANI-640
DESIGNED: GARY WILLIAMS REVIEWED: A. AMBARDEKAR ORIG. DFT.: E. DANE FACILITY:	ISSUED BY: AIRWAY FACILITIES DIVISION
DATE: 06-22-01 DRAWING NUMBER: ADS-ATCT- A16	REF. DWG.:

FILE NAME: ADSA016.PCT