

THIS DRAWING PRODUCED ON THE SOUTHWEST REGION MICROSTATION SYSTEM

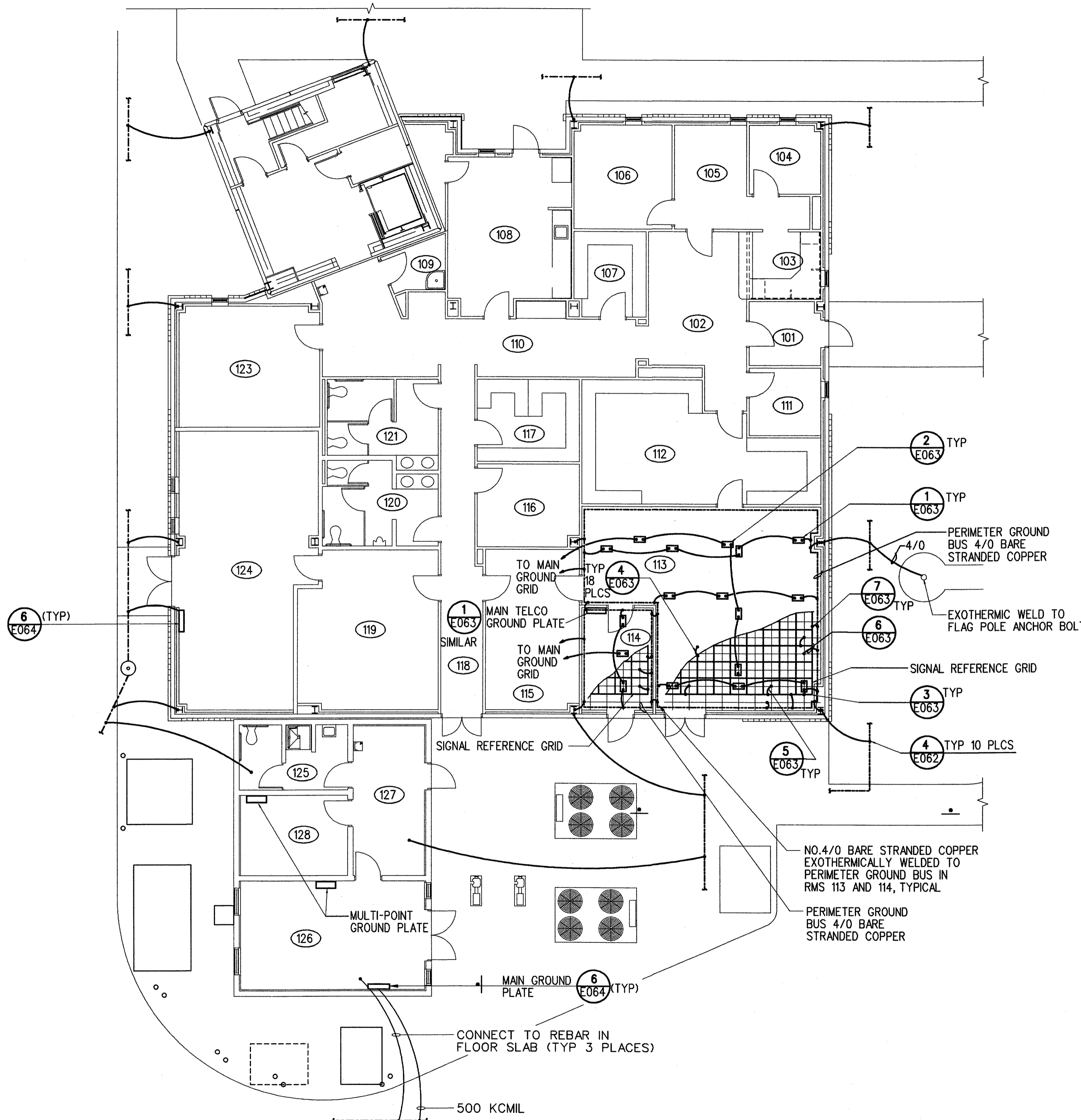
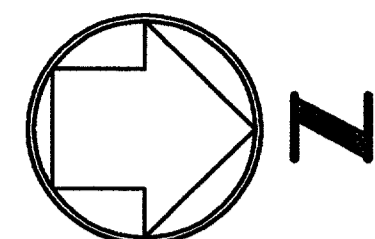

FLOOR PLAN
SCALE: 1/8" = 1'-0"

RM NO.	ROOM NAME
101	VESTIBULE
102	LOBBY
103	RECEPTION
104	AT OFFICE
105	QATS
106	TOWER MANAGER
107	MAIL/FAX/COPY ROOM
108	BREAKROOM
109	JAN CLOSET
110	CORRIDOR
111	AF OFFICE
112	RMM/LIS/MMS ROOM
113	ELECTRONIC ROOM
114	TELCO
115	MATERIAL STORAGE
116	AT/AR/CBI TRAINING RM
117	AT/AF STORAGE
118	CORRIDOR
119	ESU SHOP
120	MEN'S TOILET
121	WOMEN'S TOILET
122	LINK
123	AT/AF CONFERENCE RM
124	MECH/ELEC ROOM
125	TOILET/SHOWER
126	E/G ROOM
127	WORKROOM
128	UPS

GENERAL NOTES:

- FOR WIRE INTERCONNECTIONS, SEE SHEET E033.
- FOR MULTI-POINT GROUND PLATES IN TOWER, SEE SHEET E011, E012 AND E033.
- FOR TOWER ROOM SCHEDULE, SEE DWGS E011 AND E012.
- GROUND ALL DUCTWORK AND PIPING WHERE DUCTWORK AND PIPING ENTER OR LEAVE ROOM 113, SEE DETAIL 6 ON DRAWING E062.
- GROUND ALL METALLIC CONDUIT ENTERING THROUGH SLAB. SEE DETAIL 7 DRAWING E062.

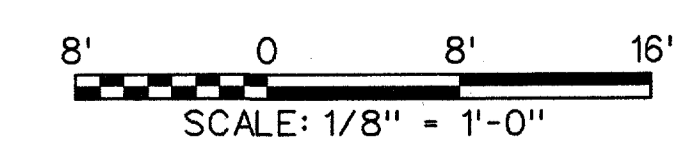
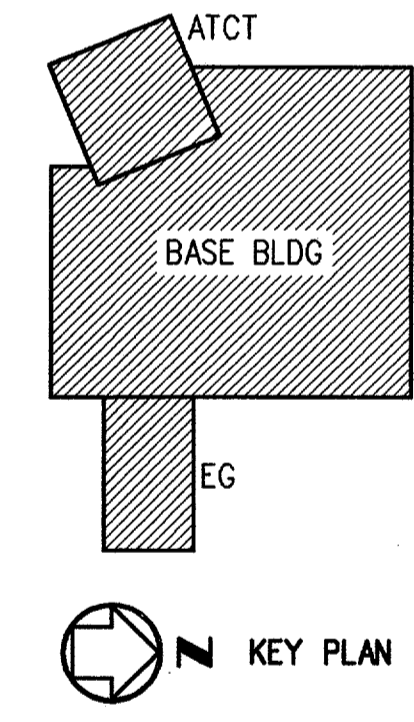

A		06-23-03	FAA REDESIGN OF HVAC, JON 21874.	9700164	06-23-03	
REV	DATE	DESCRIPTION		JCN	REDLINE DATE	APVD
DEPARTMENT OF TRANSPORTATION FEDERAL AVIATION ADMINISTRATION FORT WORTH IMPLEMENTATION CENTER FORT WORTH, TX LOW ACTIVITY LEVEL ATCT GROUNDING PLAN ATCT/BASE-EG BUILDINGS						
ADDISON		ADDISON AIRPORT		TX		
REVIEWED BY	SUBMITTED BY		APPROVED BY			
	<i>M.A. Hebecks 7/18/03</i>		<i>Shunnie L. White 7/18/03</i>			
DESIGNED	PROJECT ENGINEER, ANI-630		PLATFORM MANAGER, ANI-630			
DRAWN	M. DOERR	ISSUED BY	DATE	06-23-03	JCN	9700164
CHECKED	KS	NAS IMPLEMENTATION ANI-600	DRAWING NO.	9700164		
			ADS-D-ATCT-E032	REV A		

m:\data\active\hvac\atct\eg02.dgn 07/17/2003 04:59:52 PM Admin