

*Changed location in the field as shown*

*Services added as extra into meter box*

*CONCRETE ENCASMENT REV'D AS SHOWN*

*PROPERTY HAD ONLY ONE ENTRANCE LEAVING @ TIME CONSTRUCTION BEGAN*

FOR MISC. DETAIL SEE SHT. 2

NOTE: CONTRACTOR SHALL INSTALL OR TIE-IN SERVICES AS DIRECTED BY ENGINEER

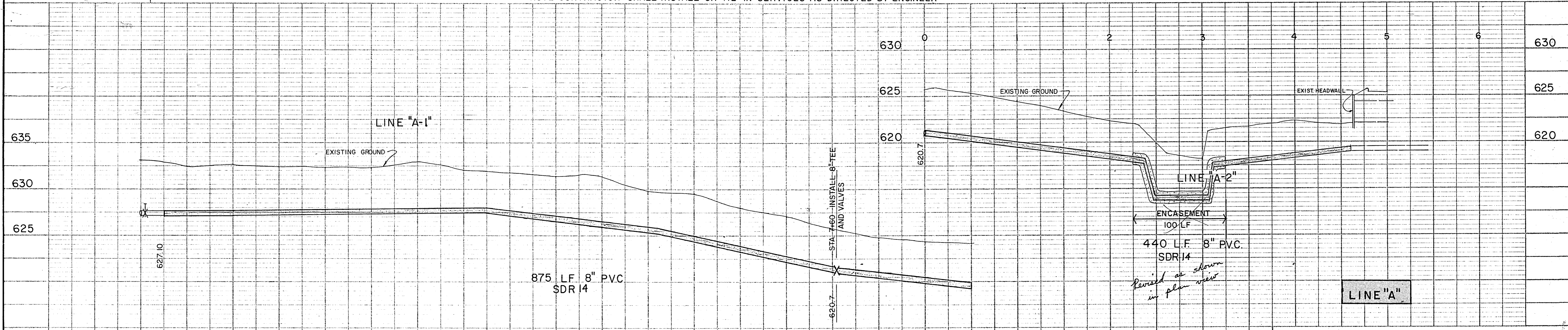

1	Moved 15' Esm't. & Water Line South	RB	9/9/82
No.	Revision	By	Date
CITY OF ADDISON DALLAS COUNTY, TEXAS			
DOOLEY ROAD WATER IMPROVEMENTS			
GINN, INC. Consulting Engineers Dallas, Texas			
Designed - HWG	Drawn - RJB	Date - MAY 1982	Job No. - J224
Approved - HWG	Checked - GF	Scale - 11"=50'	V-1"=5'
		Sheet	7 of 2