

- LEGEND**
- FIRE HYDRANT
  - POWER POLE
  - LIGHT STANDARD
  - WATER METER
  - WATER VALVE
  - CLEANOUT
  - MANHOLE
  - GAS METER
  - PROPERTY LINE

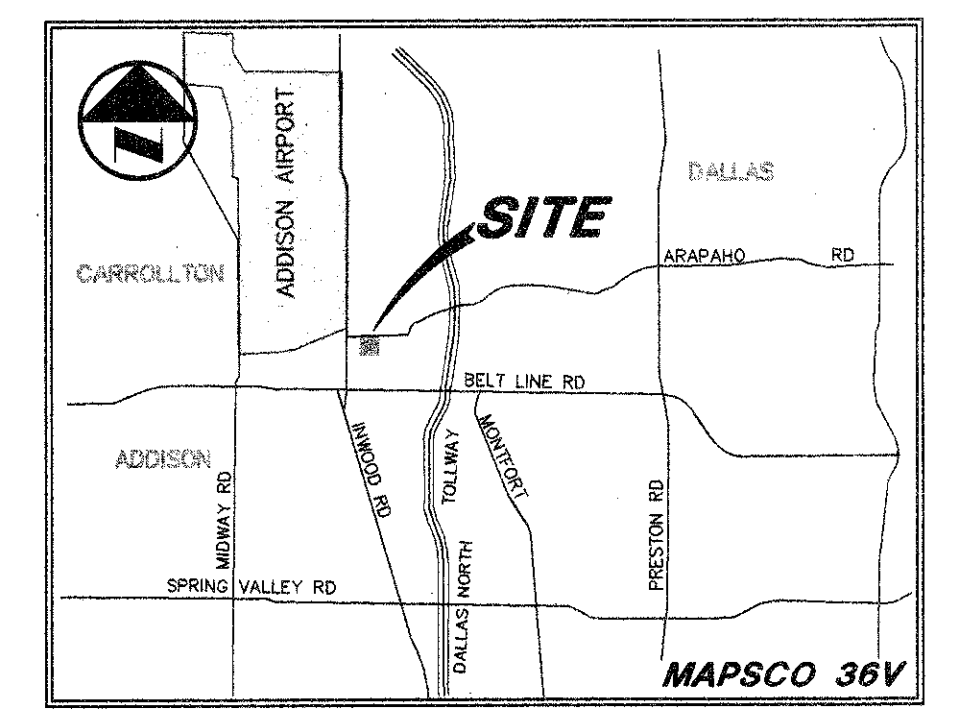
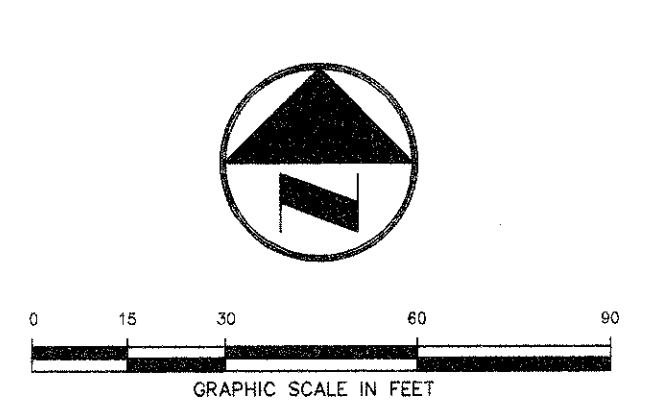

**COORDINATE LIST**

POINT NO.	NORTH	EAST	DESCRIPTION
1	1711.54	1578.31	TRAVERSE POINT No. 1
2	1116.63	1562.99	TRAVERSE POINT No. 2
3	1114.50	1170.83	TRAVERSE POINT No. 3
4	1612.83	1143.28	TRAVERSE POINT No. 4
5	1616.86	1181.80	PROPERTY CORNER
6	1614.70	1475.02	PC PROPERTY CORNER
7	1620.54	1545.33	PROPERTY CORNER
8	1124.13	1538.38	PROPERTY CORNER
9	1181.80	1181.80	PROPERTY CORNER
10	1546.22	1408.65	BUILDING CORNER "A"
11	1460.95	1495.08	BUILDING CORNER "A"
12	1417.33	1445.03	BUILDING CORNER "A"
13	1502.60	1364.60	BUILDING CORNER "A"
14	1394.43	1477.30	BUILDING CORNER "B"
15	1274.43	1476.71	BUILDING CORNER "B"
16	1274.67	1425.76	BUILDING CORNER "B"
17	1394.67	1423.31	BUILDING CORNER "B"
18	1254.35	1492.11	BUILDING CORNER "C"
19	1206.35	1491.67	BUILDING CORNER "C"
20	1207.19	1325.88	BUILDING CORNER "C"
21	1255.18	1324.11	BUILDING CORNER "C"
22	1206.78	1297.87	BUILDING CORNER "D"
23	1207.01	1249.87	BUILDING CORNER "D"
24	1327.01	1250.47	BUILDING CORNER "D"
25	1326.78	1298.87	BUILDING CORNER "D"
26	1341.53	1266.54	BUILDING CORNER "E"
27	1341.70	1314.54	BUILDING CORNER "E"
28	1473.84	1287.19	BUILDING CORNER "E"
29	1473.61	1315.19	BUILDING CORNER "E"
30	1494.04	1345.79	BUILDING CORNER "E"
31	1542.04	1246.03	BUILDING CORNER "F"
32	1541.50	1354.33	BUILDING CORNER "F"
33	1493.50	1353.79	BUILDING CORNER "F"
34	1603.21	1449.84	PT # BC
35	1578.76	1449.72	PT # BC
36	1574.29	1453.34	RADIUS POINT (2'R)
37	1583.42	1464.70	P1 # BC
38	1516.83	1530.13	P1 # BC
39	1500.27	1521.50	RADIUS POINT (2'R)
40	1468.33	1533.67	PT # BC
41	1199.66	1508.88	PT # BC
42	1158.87	1510.24	PRC # BC
43	1151.00	1515.85	RADIUS POINT (10'R)
44	1134.29	1506.27	P1 # BC
45	1134.69	1424.27	P1 # BC
46	1134.73	1416.27	P1 # BC
47	1135.18	1325.27	P1 # BC
48	1135.22	1317.27	P1 # BC
49	1135.63	1236.27	P1 # BC
50	1149.88	1235.34	PC # BC
51	1149.87	1235.64	PC # BC
52	1153.25	1233.81	PT # BC
53	1157.15	1235.13	OUTSIDE CORNER DUMPSTER
54	1140.15	1230.04	OUTSIDE CORNER DUMPSTER
55	1140.24	1213.04	OUTSIDE CORNER DUMPSTER
56	1157.23	1213.13	OUTSIDE CORNER DUMPSTER B & C
57	1149.83	1208.69	RADIUS POINT (5'R)
58	1174.40	1193.71	P1 # BC
59	1274.40	1194.21	P1 # BC
60	1276.83	1208.71	RADIUS POINT (2'R)
61	1275.87	1200.71	RADIUS POINT (10'R)
62	1285.87	1200.16	PT # BC
63	1285.45	1184.26	GC # PL
64	1316.45	1184.41	GC # PL
65	1316.37	1200.91	PC # BC
66	1325.87	1200.96	RADIUS POINT (10'R)
67	1333.83	1205.95	RADIUS POINT (2'R)
68	1327.40	1194.47	P1 # BC
69	1445.40	1195.05	P1 # BC
70	1453.40	1195.09	P1 # BC
71	1580.40	1195.72	P1 # BC
72	1581.83	1210.23	RADIUS POINT (2'R)
73	1599.71	1217.83	P1 # BC
74	1599.20	1219.91	P1 # BC
75	1599.22	1310.81	P1 # BC
76	1598.81	1305.81	P1 # BC
77	1584.30	1394.24	RADIUS POINT (2'R)
78	1602.18	1415.03	PT # BC
79	1557.68	1420.33	PC # BC
80	1548.93	1441.15	PT # BC
81	1489.36	1500.13	PC # BC
82	1468.46	1508.67	PT # BC
83	1424.78	1506.95	RADIUS POINT (2'R)
84	1423.35	1492.45	P1 # BC
85	1284.35	1491.76	P1 # BC
86	1282.78	1505.25	RADIUS POINT (2'R)
87	1199.78	1507.34	PC # BC
88	1176.93	1483.98	RADIUS POINT (2'R)
89	1191.40	1482.55	P1 # BC
90	1191.94	1373.55	P1 # BC
91	1191.98	1365.55	P1 # BC
92	1192.51	1293.65	P1 # BC
93	1178.05	1257.98	RADIUS POINT (2'R)
94	1201.13	1234.84	PT # BC
95	1300.08	1237.08	RADIUS POINT (2'R)
96	1351.51	1231.59	P1 # BC
97	1472.51	1252.19	P1 # BC
98	1474.08	1237.59	RADIUS POINT (2'R)
99	1529.08	1235.47	PC # BC
100	1558.44	1266.11	PT # BC
101	1386.52	1351.03	MAINTENANCE BUILDING CORNER
102	1369.48	1367.91	MAINTENANCE BUILDING CORNER
103	1352.60	1350.66	MAINTENANCE BUILDING CORNER
104	1369.64	1333.98	MAINTENANCE BUILDING CORNER

**CAUTION!**  
GAS LINE IN AREA—CONTACT  
LONE STAR GAS 48 HOURS  
PRIOR TO CONSTRUCTION  
PHONE: (214)263-3444

**CONTACT:**  
MR. ED KEAH, OPERATING SUPPORT SECTION  
DISTRIBUTION DEPARTMENT, 2 WORKING  
DAYS PRIOR TO EXCAVATING T.U. ELECTRIC  
FACILITIES.  
PHONE: (214)698-7239 OR (214)698-7207

**CAUTION!**  
UNDERGROUND TELEPHONE  
IN AREA—CONTACT S.W.B.T.  
48 HOURS PRIOR TO CONSTRUCTION  
PHONE: (214)698-7239 (UNDERGROUND)  
PHONE: (214)698-7240 (OVER-HEAD)

**RECORD DRAWING**  
THIS DRAWING HAS BEEN REVISED TO REFLECT  
CONSTRUCTION RECORDS MAINTAINED AND  
PROVIDED BY THE CONTRACTOR FOR THIS PROJECT.  
  
CONTRACTOR: UNLIMITED CONSTRUCTION, INC.  
P.O. BOX 462213  
DALLAS, TEXAS 75046-2213  
  
DATE REVISED: 29 MARCH 1996

NOTE:  
SEE DETAIL SHEET FOR  
GENERAL NOTES & DETAILS

NOTE:  
ALL DIMENSIONS ARE FROM  
FACE OF CURB TO FACE OF  
CURB UNLESS NOTED OTHERWISE.

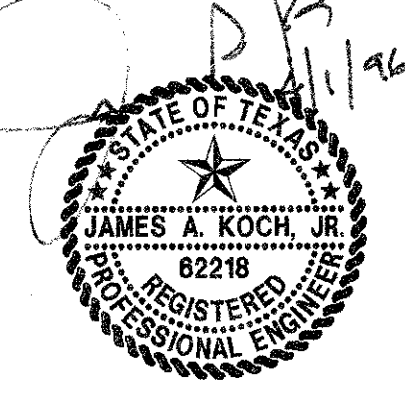

**PACHECO KOCH** 9401 LBJ Freeway, Suite 300  
Consulting Engineers, Inc. Dallas, Texas 75243  
Civil Engineering • Land Surveying (214) 235-3031

**DIMENSIONAL CONTROL & PAVING PLAN**  
**SUMMERFIELD SUITES HOTEL**  
**ARAPAHO ROAD**  
**QUORUM CENTER ADDITION**  
**TOWN OF ADDISON, TEXAS**

DESIGN	DRAWN	DATE	SCALE	NOTES	FILE	NO.
JAK	BB	5/3/95	1"=30'			

**PRINTS ISSUED**

DATE	PURPOSE	NO.

**FOR CONSTRUCTION**

**REVISIONS**

DATE	ITEM	NO.

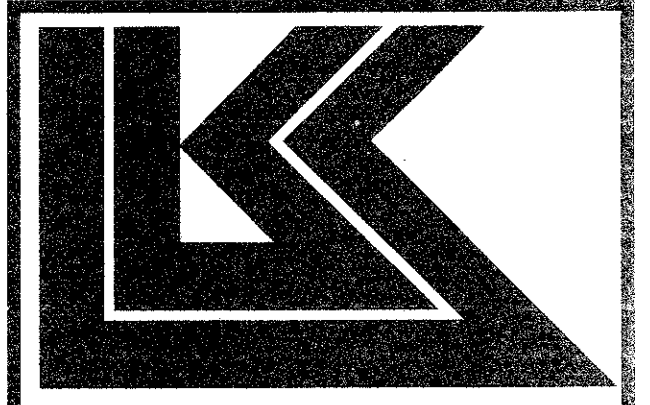

LAW/KINGDON, INC.  
ARCHITECTS & ENGINEERS  
345 RIVERVIEW, MIDCHITA, KS 67203  
Phone (316) 868-9230 Fax (316) 868-0205  
Copyright © 1994

4900 Edann  
Lewis  
B16-16

DRAWN	CHECKED
BB	JAK

**RELATED DRAWINGS**

SHELL	STRUCTURE	MECHANICAL	ELECTRICAL	OTHER

SEQUENCE NUMBER \_\_\_\_\_ OF \_\_\_\_\_ SHEETS

**SUMMERFIELD SUITES HOTEL**

ADDISON, TEXAS

PROJECT NUMBER 94780

**DIMENSIONAL CONTROL PLAN**

SHEET TITLE

SHEET NUMBER

**C-1**

1 OF 7 SHEETS

PRINTS ISSUED		
DATE	PURPOSE	NO.

**FOR CONSTRUCTION:**

REVISIONS		
DATE	ITEM	NO.

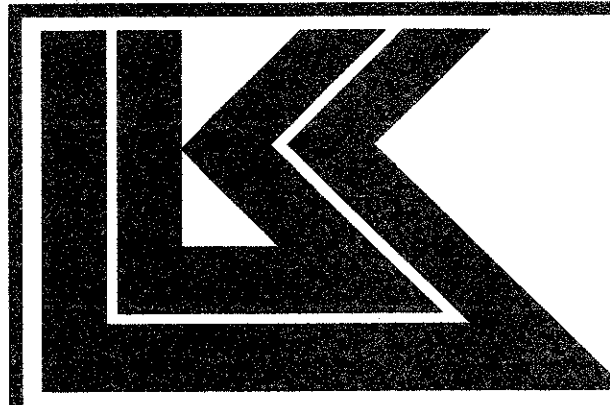

LAW/KINGDON, INC.  
ARCHITECTS & ENGINEERS  
345 RIVERVIEW, WICHITA, KS 67209  
Phone (316) 268-0230 Fax (316) 268-0232  
Copyright © 1994

DRAWN	CHECKED
BB	JAK

**RELATED DRAWINGS**

SHELL	DETAILS	STRUCTURE	MECHANICAL	ELECTRICAL	OTHER

SEQUENCE NUMBER \_\_\_\_\_ OF \_\_\_\_\_ SHEETS

ADDISON, TEXAS

PROJECT NUMBER 94780

GRADING PLAN	
SHEET TITLE	SHEET NUMBER
<b>C-2</b>	
2 OF 7 SHEETS	

## ARAPAHO ROAD

**LEGEND**

- PHO FIRE HYDRANT
- PP POWER POLE
- LS LIGHT STANDARD
- WM WATER METER
- WV WATER VALVE
- CL CLEANOUT
- MANHOLE
- GM GAS METER
- PL PROPERTY LINE
- EX EXIST CONTOUR
- EL 612.39 EXIST SPOT ELEVATION
- TO 612.39 EXIST TOP OF CURB ELEVATION
- OF 611.92 EXIST GUTTER ELEVATION
- PROPOSED CONTOUR
- TO 614.5 PROP TOP OF CURB ELEVATION
- OF 614.5 PROP SPOT ELEVATION
- PROP DRAINAGE FLOW DIRECTION
- PROP DRAINAGE DIVIDE
- PROP EROSION CONTROL
- HANDICAPPED ACCESSIBLE ENTRANCE

**DRAINAGE CRITERIA**

Q = CIA  
C = 0.90, 0.30 for DA#15 & DA#16  
T<sub>c</sub> = 10 minutes, 15 minutes for DA#15 & DA#16  
I = 8.74 inch/hour, 7.52 inch/hour for DA#15 & DA#16  
DRAINAGE BASED ON 100 YEAR FLOOD

DRAINAGE AREA #	AREA (acres)	Q <sub>100</sub> (cfs)	COLLECTED INTO
DA#1	0.63	4.96	10" CURB INLET (NORTH SYSTEM)
DA#2	0.17	1.34	ROOF DRAIN (WEST SYSTEM)
DA#3	0.13	1.02	ROOF DRAIN (WEST SYSTEM)
DA#4	0.19	1.49	ROOF DRAIN (WEST SYSTEM)
DA#5	0.13	1.02	ROOF DRAIN (WEST SYSTEM)
DA#6	0.14	1.10	ROOF DRAIN (WEST SYSTEM)
DA#7	0.12	0.94	ROOF DRAIN (WEST SYSTEM)
DA#8	0.12	0.94	12" GRATE INLET (WEST SYSTEM)
DA#9	0.18	1.42	12" GRATE INLET (WEST SYSTEM)
DA#10	0.34	2.67	24" GRATE INLET (WEST SYSTEM)
DA#11	0.11	0.87	12" GRATE INLET (WEST SYSTEM)
DA#12	0.64	5.04	24" GRATE INLET (WEST SYSTEM)
DA#13	0.79	6.21	24" GRATE INLET (WEST SYSTEM)
DA#14	1.64	12.90	TYPE "Y" INLET (WEST SYSTEM)
DA#15	1.05	2.37	36" GRATE INLET (WEST SYSTEM)
DA#16	0.70	1.58	TYPE "Y" INLET (NORTH SYSTEM)

**GRATE INLET CALCULATIONS**

Q = CA<sup>0.781</sup>  
C = 0.7 (Clogging Factor)  
A = AREA GRATE INLET OPENING (sq ft)  
g = 32.2 ft/sec  
h = 0.5 ft

AREA FOR GRATE No.12 = 0.28 sq ft  
MAX Q FOR GRATE No.12 = 1.11 cfs  
AREA FOR GRATE No.24 = 1.42 sq ft  
MAX Q FOR GRATE No.24 = 5.65 cfs  
AREA FOR GRATE No.36 = 3.61 sq ft  
MAX Q FOR GRATE No.36 = 14.37 cfs

**GRATE INLETS TO BE**  
American Industrial Pre-cast Products, Inc. CATCH BASIN No.12, No.20 & No.36 OR APPROVED EQUAL

**POLLUTION CONTROL GENERAL NOTES**

- THIS PLAN HAS BEEN PREPARED TO PROVIDE MEANS TO PREVENT OR MINIMIZE POLLUTION OF STORM WATER.
- THE CONSTRUCTION ACTIVITY INCLUDED IN THIS PLAN WILL INCLUDE:
  - A. CLEARING AND GRUBBING
  - B. ROUGH GRADING
  - C. FINAL GRADING
  - D. UTILITY INSTALLATION
  - E. PAVEMENT INSTALLATION
  - F. BUILDING CONSTRUCTION
- THE TOTAL ESTIMATED LAND AREA TO BE DISTURBED IS 4 ACRES.
- THE ESTIMATED RUNOFF COEFFICIENT UPON COMPLETION OF THE PROJECT IS 0.90X.
- THE STORM WATER EXITING THE SITE IS COLLECTED IN AN EXISTING DRAINAGE SYSTEM MAINTAINED BY THE CITY OF ADDISON, TEXAS.
- THE SOILS ON THE SITE ARE GENERALLY EXPANSIVE CLAYS.
- THE CONTRACTOR SHALL PROVIDE EROSION PROTECTION AROUND THE WORK AREA PERIMETER AND AT ALL INLET MOUTHS DURING CONSTRUCTION.
- THE CONTRACTOR WILL REMOVE ALL EXCESS SOIL FROM CONSTRUCTION VEHICLES PRIOR TO EXITING THE SITE.
- ALL DISTURBED AREAS WHICH WILL NOT BE RE-DISTURBED FOR A MINIMUM OF 21 DAYS MUST BE STABILIZED BY THE CONTRACTOR TO CONTROL EROSION.
- THE CONTRACTOR SHALL UNDERTAKE PROPER METHODS TO REDUCE DUST GENERATION FROM THE SITE.
- THE CONTRACTOR MUST COMPLY WITH FEDERAL, STATE AND LOCAL REGULATIONS REGARDING SEDIMENT AND EROSION CONTROL.
- A COPY OF THIS PLAN MUST BE KEPT AT THE CONSTRUCTION FACILITY DURING THE ENTIRE CONSTRUCTION PERIOD.

**VIEW "A-A"**  
NTS

**DRAINAGE AREA MAP**  
SCALE: 1"=300'

**RECORD DRAWING**  
THIS DRAWING HAS BEEN REVISED TO REFLECT CONSTRUCTION RECORDS MAINTAINED AND PROVIDED BY THE CONTRACTOR FOR THIS PROJECT.  
CONTRACTOR: UNLIMITED CONSTRUCTION, INC.  
P.O. BOX 482213  
DALLAS, TEXAS 75046-2213  
DATE REVISED: 29 MARCH 1996

**PACHECO KOCH Consulting Engineers, Inc.**  
Civil Engineering • Land Surveying  
8401 LBJ Freeway, Suite 300  
Dallas, Texas 75243  
(214) 235-3031

**GRADING & EROSION CONTROL PLAN**  
**SUMMERFIELD SUITES HOTEL**  
**ARAPAHO ROAD**  
**QUORUM CENTER ADDITION**  
**TOWN OF ADDISON, TEXAS**

DESIGN	DRAWN	DATE	SCALE	NOTES	FILE	NO.
JAK	BB	5/3/95	1"=30'			

PK NO: 1467-95-011 DWG NO: 1467-038

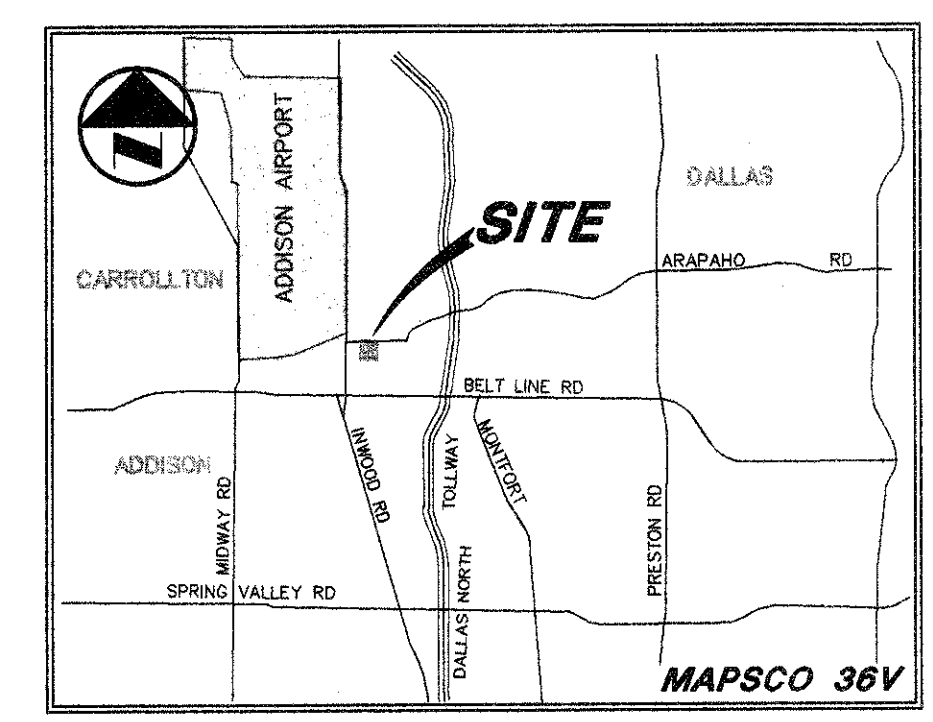

**CAUTION!!!**  
GAS LINE IN AREA—CONTACT LONE STAR GAS 48 HOURS PRIOR TO CONSTRUCTION PHONE: (214)263-3444

**CONTACT:**  
MR ED KEAH, OPERATING SUPPORT SECTION DISTRIBUTION DEPARTMENT, 2 WORKING DAYS PRIOR TO EXCAVATING T.U. ELECTRIC FACILITIES. PHONE: (214)698-7239 OR (214)698-7207

**CAUTION!!!**  
UNDERGROUND TELEPHONE IN AREA — CONTACT S.W.B.T. 48 HOURS PRIOR TO CONSTRUCTION PHONE: (214)698-7239 (UNDERGROUND) PHONE: (214)698-7240 (OVER-HEAD)

**BENCH MARKS:**

- "O" CUT ON S.E. CORNER OF SIDEWALK AT THE ENTRANCE TO 4805 ARAPAHO RD. APPROX ±400 FEET EAST OF ADDISON RD. ELEV. 630.66
- "O" ON SOUTH RIM OF MANHOLE LOCATED ON THE SOUTH SIDE OF ARAPAHO RD AT THE NORTHEAST CORNER OF SITE, APPROX. 16.5' EAST OF THE WEST END OF SIDEWALK. ELEV. 632.25

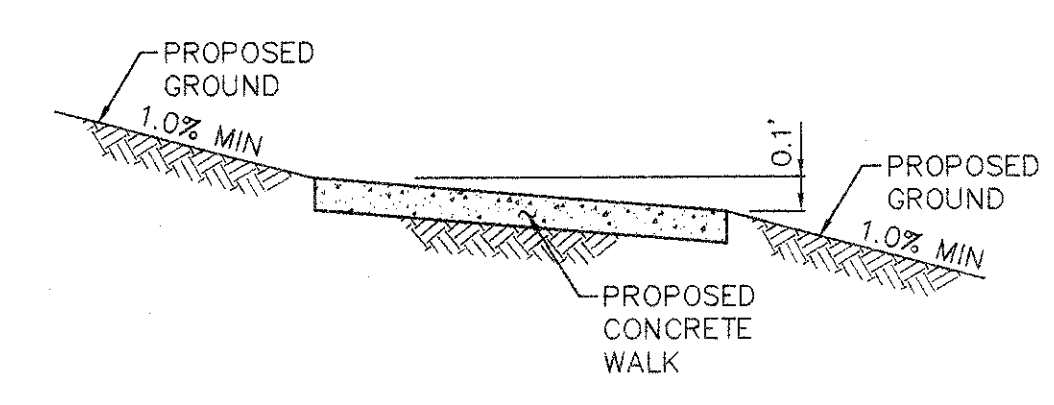

**NOTE:**  
CONSTRUCT TYPE "Y" INLET FOR TEMPORARY COLLECTION OF DRAINAGE EAST OF SITE. INLET TO BE REMOVED UPON DEVELOPMENT OF AREA EAST OF SITE.

**NOTE:**  
CONTRACTOR TO GRADE TO DRAIN TO TYPE "Y" INLET

**NOTE:**  
AREA FOR GRATE No.12 = 0.28 sq ft  
MAX Q FOR GRATE No.12 = 1.11 cfs  
AREA FOR GRATE No.24 = 1.42 sq ft  
MAX Q FOR GRATE No.24 = 5.65 cfs  
AREA FOR GRATE No.36 = 3.61 sq ft  
MAX Q FOR GRATE No.36 = 14.37 cfs

**NOTE:**  
AREA FOR GRATE No.12 = 0.28 sq ft  
MAX Q FOR GRATE No.12 = 1.11 cfs  
AREA FOR GRATE No.24 = 1.42 sq ft  
MAX Q FOR GRATE No.24 = 5.65 cfs  
AREA FOR GRATE No.36 = 3.61 sq ft  
MAX Q FOR GRATE No.36 = 14.37 cfs

**NOTE:**  
AREA FOR GRATE No.12 = 0.28 sq ft  
MAX Q FOR GRATE No.12 = 1.11 cfs  
AREA FOR GRATE No.24 = 1.42 sq ft  
MAX Q FOR GRATE No.24 = 5.65 cfs  
AREA FOR GRATE No.36 = 3.61 sq ft  
MAX Q FOR GRATE No.36 = 14.37 cfs

**NOTE:**  
DRAINAGE AREA #16 INDICATE TEMPORARY COLLECTION OF DRAINAGE UPON DEVELOPMENT OF THE AREA EAST OF SITE. DA#16 TO DRAIN INTO ARAPAHO ROAD AND THE TYPE "Y" INLET AT THE NORTHEAST CORNER IS TO BE REMOVED, PLUG BACK OF CURB INLET UPON REMOVAL OF 18" DRAIN PIPE

**NOTE:**  
DRAINAGE AREA #15 INDICATE TEMPORARY COLLECTION OF DRAINAGE UPON DEVELOPMENT OF THE AREA SOUTH AND EAST OF SITE. DA#15 TO DRAIN INTO ARAPAHO ROAD AND DRAINAGE COLLECTION SYSTEM OF AREA SOUTH OF SITE AND COLLECTED IN 24" DRAIN PIPE SERVING TYPE "Y" INLET AT THE SOUTHWEST CORNER OF SITE.

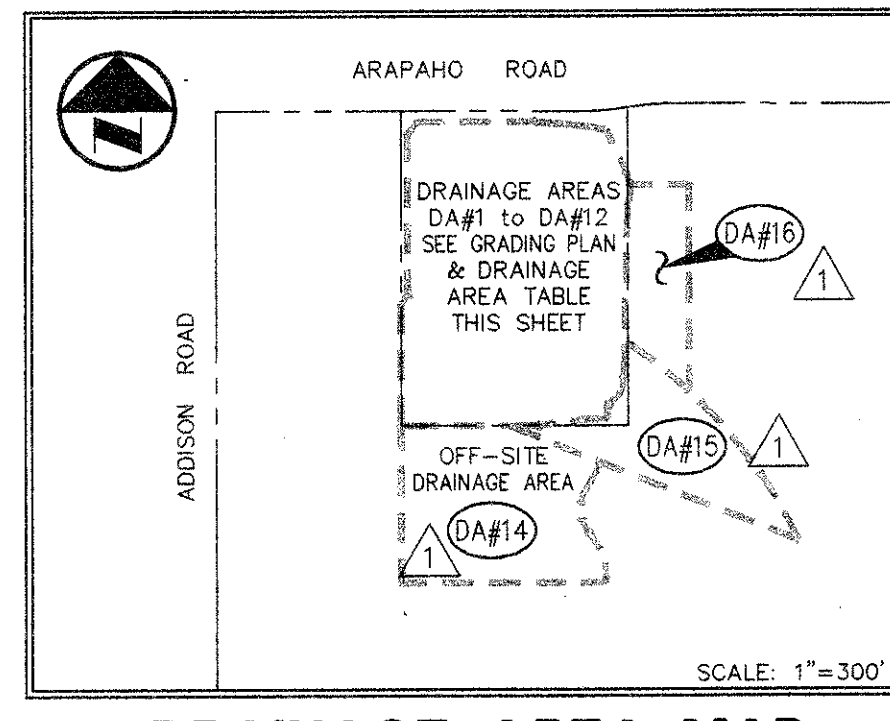

**RECORD DRAWING**  
THIS DRAWING HAS BEEN REVISED TO REFLECT CONSTRUCTION RECORDS MAINTAINED AND PROVIDED BY THE CONTRACTOR FOR THIS PROJECT.  
CONTRACTOR: UNLIMITED CONSTRUCTION, INC.  
P.O. BOX 482213  
DALLAS, TEXAS 75046-2213  
DATE REVISED: 29 MARCH 1996

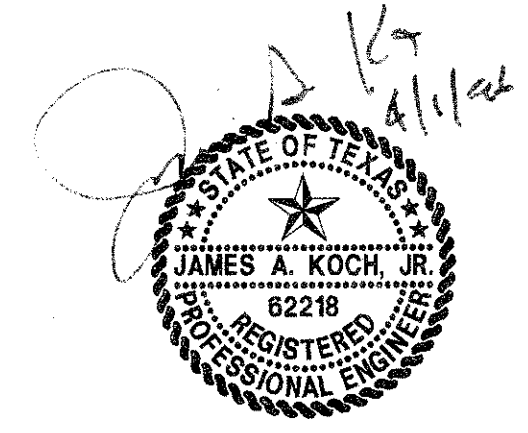

**PACHECO KOCH Consulting Engineers, Inc.**  
Civil Engineering • Land Surveying  
8401 LBJ Freeway, Suite 300  
Dallas, Texas 75243  
(214) 235-3031

**GRADING & EROSION CONTROL PLAN**  
**SUMMERFIELD SUITES HOTEL**  
**ARAPAHO ROAD**  
**QUORUM CENTER ADDITION**  
**TOWN OF ADDISON, TEXAS**

DESIGN	DRAWN	DATE	SCALE	NOTES	FILE	NO.
JAK	BB	5/3/95	1"=30'			

PK NO: 1467-95-011 DWG NO: 1467-038

PRINTS ISSUED		
DATE	PURPOSE	NO.

FOR CONSTRUCTION		
REVISIONS		
DATE	ITEM	NO.

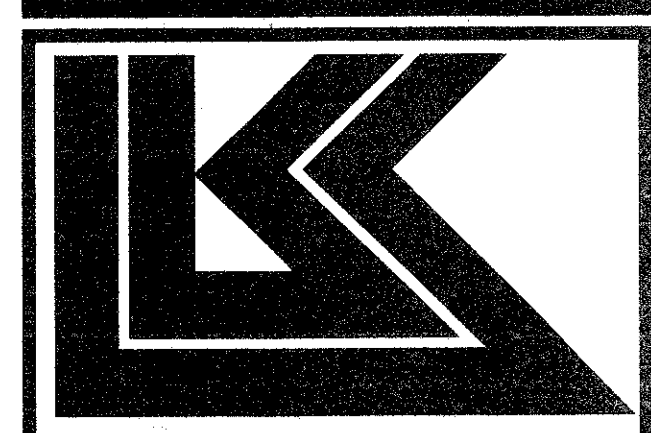

LAW/KINGDON, INC.  
ARCHITECTS & ENGINEERS  
345 RIVERVIEW, WICHITA, KS 67203  
Phone (316) 268-9200, Fax (316) 268-9205  
Copyright © 1996

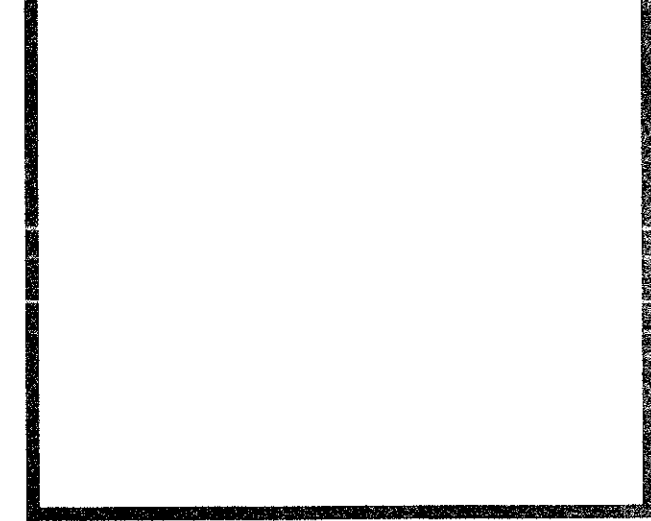

DRAWN	CHECKED
BB	JAK
RELATED DRAWINGS	
SHELL	
DETAILS	
STRUCTURE	
MECHANICAL	
ELECTRICAL	
OTHER	
SEQUENCE NUMBER	

**SUMMERFIELD SUITES HOTEL**  
ADDISON, TEXAS

PROJECT NUMBER 94780

DRAINAGE PLAN	
SHEET TITLE	
SHEET NUMBER	
<b>C-3</b>	
3 OF 7 SHEETS	

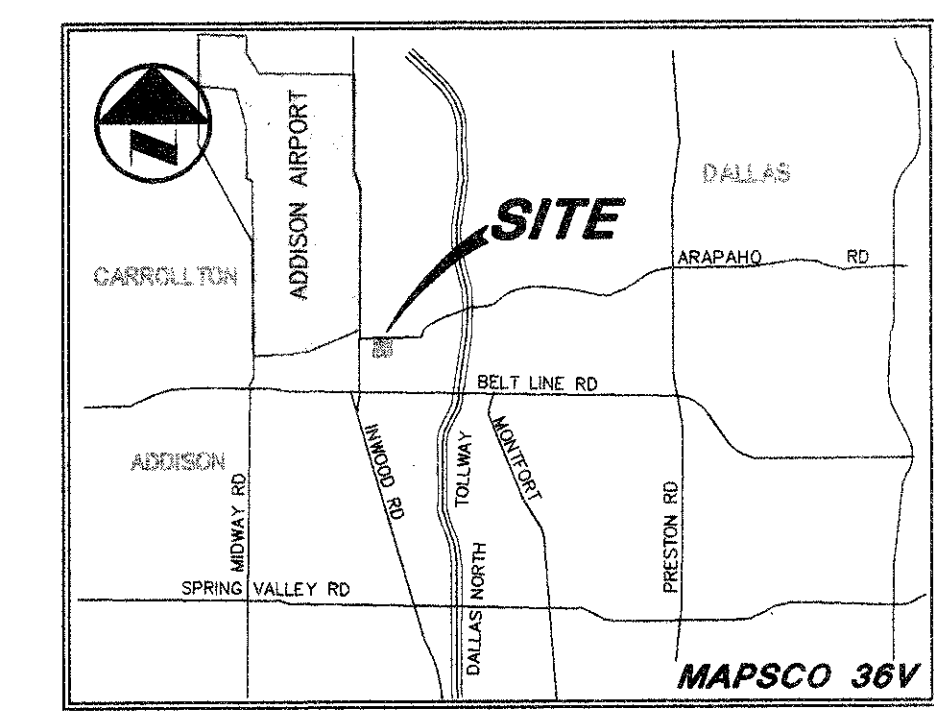

VICINITY MAP

**CAUTION!!!**  
GAS LINE IN AREA—CONTACT LONE STAR GAS 48 HOURS PRIOR TO CONSTRUCTION PHONE: (214)263-3444

**CONTACT:**  
MR ED REAH, OPERATING SUPPORT SECTION DISTRIBUTION DEPARTMENT, 2 WORKING DAYS PRIOR TO EXCAVATING T.U. ELECTRIC FACILITIES. PHONE: (214)698-7239 OR (214)698-7207

**CAUTION!!!**  
UNDERGROUND TELEPHONE IN AREA - CONTACT S.W.B.T. 48 HOURS PRIOR TO CONSTRUCTION PHONE: (214)698-7239 (UNDERGROUND) PHONE: (214)698-7240 (OVER-HEAD)

**BENCH MARKS:**  
1. "D" CUT ON S.E. CORNER OF SIDEWALK AT THE ENTRANCE TO 4805 ARAPAHO RD. APPROX ±400 FEET EAST OF ADDISON RD. ELEV. 630.66  
2. "D" ON SOUTH RIM OF MANHOLE LOCATED ON THE SOUTH SIDE OF ARAPAHO RD AT THE NORTHEAST CORNER OF THE SOUTH SIDE OF THE WEST END OF SIDEWALK. ELEV. 632.25

- LEGEND**
- THO FIRE HYDRANT
  - PP POWER POLE
  - LS LIGHT STANDARD
  - WM WATER METER
  - WV WATER VALVE
  - CL CLEANOUT
  - MH MANHOLE
  - GM GAS METER
  - PROPERTY LINE

**NOTE:**  
CONNECT BUILDING "A" ROOF DRAIN TO 12" DRAIN PIPE STA 14-33.5 LINE "ST-5"  
CONNECT BUILDING "B" ROOF DRAIN TO 12" DRAIN PIPE LINE "ST-6", SECTION "6-A"  
CONNECT BUILDING "C" ROOF DRAIN TO 12" DRAIN PIPE LINE "ST-2", SECTION "2-D"  
CONNECT BUILDING "D" ROOF DRAIN TO 24" DRAIN PIPE LINE "ST-2", SECTION "2-B"  
CONNECT BUILDING "E" ROOF DRAIN TO 12" DRAIN PIPE LINE "ST-5", SECTION "5-A"  
CONNECT BUILDING "F" ROOF DRAIN TO 12" DRAIN PIPE STA 14-33.5 LINE "ST-5"

SECTION	PIPE DIA	SLOPE	Q <sub>100</sub>	V <sub>100</sub>	V <sup>2</sup> /2g	C	Sf	n	*Q <sub>100</sub>
SEC "1-A"	18"	0.3%	4.96 cfs	2.81 fps	0.1226	5.75 cfs	0.0022	0.013	6.54 cfs
SEC "1-B"	18"	0.3%	4.96 cfs	2.81 fps	0.1226	5.75 cfs	0.0022	0.013	6.54 cfs
SEC "1-C"	18"	2.0%	0.00 cfs	0.00 fps	0.0000	14.86 cfs	0.0000	0.013	1.58 cfs
SEC "2-A"	21"	3.4%	24.06 cfs	10.00 fps	1.5528	36.82 cfs	0.0231	0.013	
SEC "2-B"	21"	0.3%	12.81 cfs	5.33 fps	0.4411	8.68 cfs	0.0065	0.013	
SEC "2-C"	21"	0.3%	6.99 cfs	2.91 fps	0.3315	8.68 cfs	0.0019	0.013	
SEC "2-D"	12"	1.0%	2.36 cfs	3.00 fps	0.1398	3.56 cfs	0.0044	0.013	
SEC "2-E"	8"	25.0%	0.87 cfs	2.47 fps	0.0947	6.12 cfs	0.0050	0.013	
SEC "3-A"	24"	1.4%	12.90 cfs	3.98 fps	0.2460	26.77 cfs	0.0031	0.013	
SEC "4-A"	18"	2.6%	6.21 cfs	3.51 fps	0.5988	16.94 cfs	0.0035	0.013	13.62 cfs
SEC "5-A"	12"	1.0%	4.80 cfs	6.11 fps	0.5797	3.56 cfs	0.1982	0.013	
SEC "5-B"	8"	5.3%	1.42 cfs	4.03 fps	0.2322	2.82 cfs	0.0134	0.013	
SEC "6-A"	12"	5.0%	1.96 cfs	2.50 fps	0.0970	7.97 cfs	0.0030	0.013	
SEC "6-B"	8"	2.5%	0.94 cfs	2.67 fps	0.1107	1.94 cfs	0.0059	0.013	
SEC "8-A"	18"	0.8%	5.04 cfs	2.85 fps	0.1261	9.40 cfs	0.0023	0.013	

\* INDICATES TEMPORARY RUNOFF CALCULATION (INCLUDES DA#15 OR DA#16)

**NOTE:**  
DRAINAGE BASED ON 100 YEAR FLOOD, T<sub>c</sub> = 10 minutes, I = 8.74 inch/hr, C = 0.90

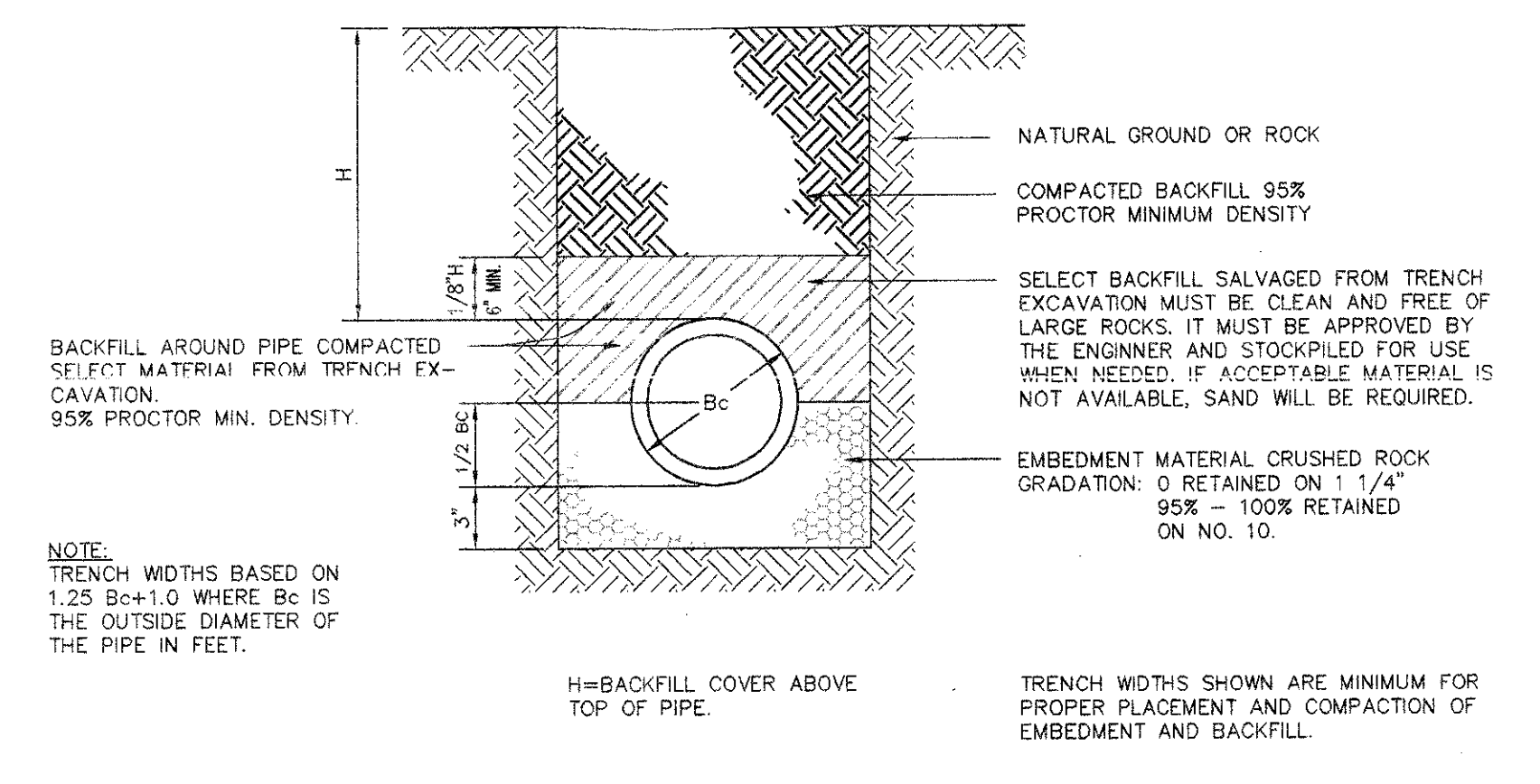

**RECORD DRAWING**

THIS DRAWING HAS BEEN REVISED TO REFLECT CONSTRUCTION RECORDS MAINTAINED AND PROVIDED BY THE CONTRACTOR FOR THIS PROJECT.

CONTRACTOR: SOUTHERN MECHANICAL PLUMBING, INC.  
400 S. ASTON  
SUNNYVALE, TEXAS 75182

DATE REVISED: 29 MARCH 1996

REVISED: MARCH 29, 1996  
REVISED: JULY 13, 1995

**PACHECO KOCH** Consulting Engineers, Inc.  
Civil Engineering • Land Surveying

9401 LBJ Freeway, Suite 300  
Dallas, Texas 75243  
(214) 235-3031

**DRAINAGE PLAN**  
**SUMMERFIELD SUITES HOTEL**  
**ARAPAHO ROAD**  
**QUORUM CENTER ADDITION**  
**TOWN OF ADDISON, TEXAS**

DESIGN	DRAWN	DATE	SCALE	NOTES	FILE	NO.
JAK	BB	5-3-95	1"=30'			

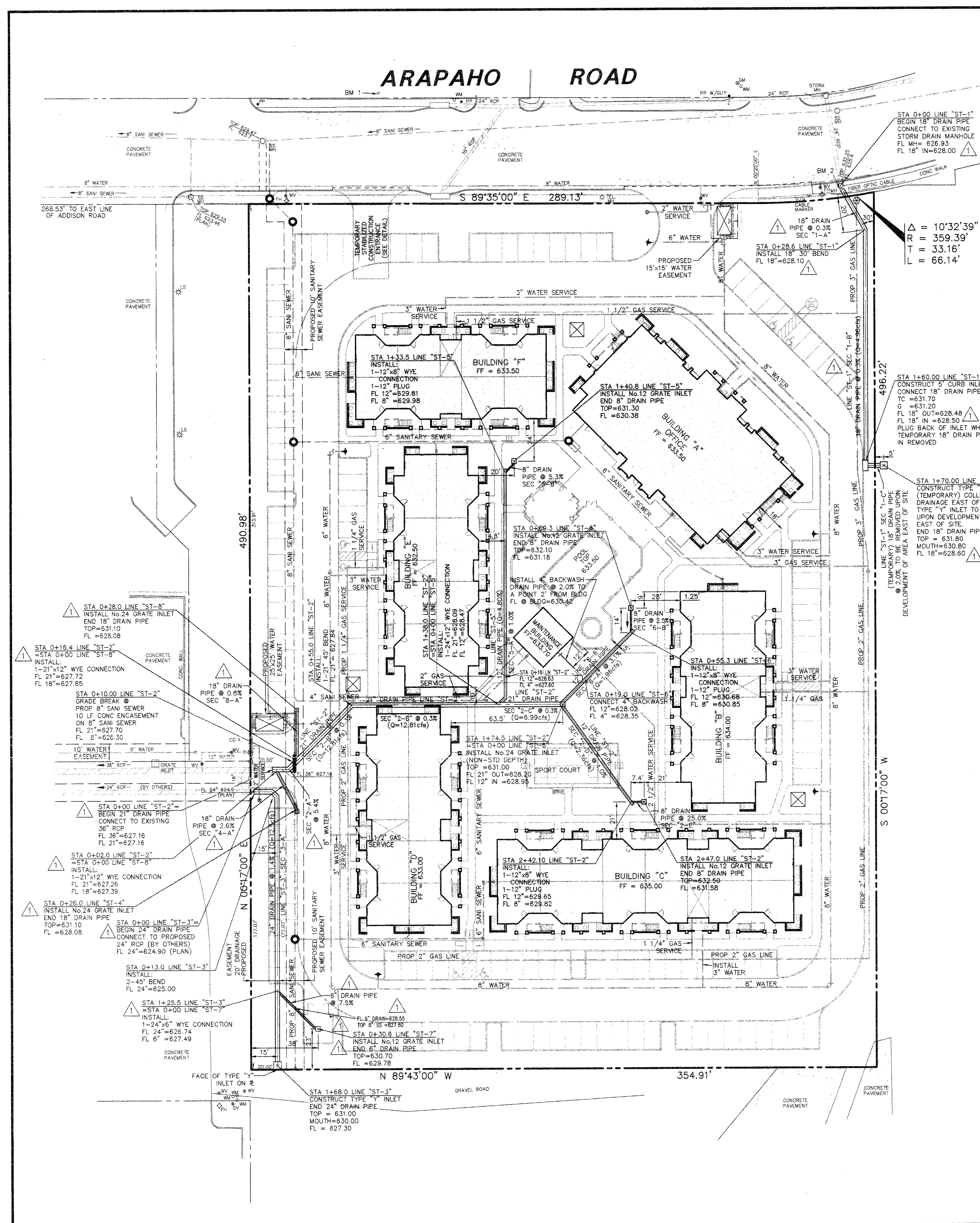
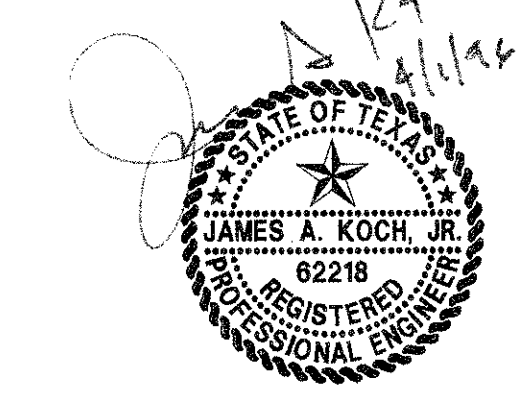

PRINTS ISSUED		
DATE	PURPOSE	NO.

FOR CONSTRUCTION		
REVISIONS		
DATE	ITEM	NO.

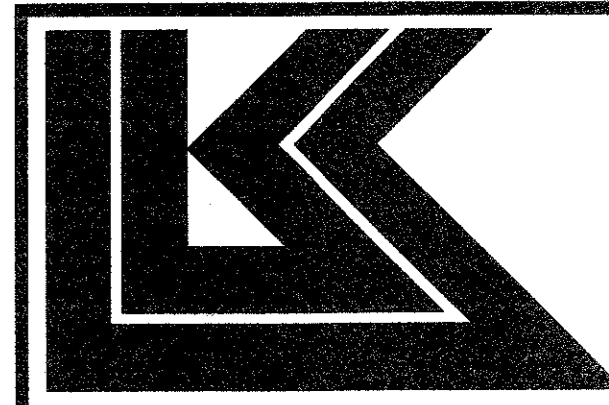

LAW/KINGDON, INC.  
ARCHITECTS & ENGINEERS  
345 RIVERVIEW, WICHITA, KS 67203  
Phone (316) 268-6230 Fax (316) 268-6230  
Copyright © 1994

DRAWN	CHECKED
BB	JAK
RELATED DRAWINGS	
SHELL	
DETAILS	
STRUCTURE	
MECHANICAL	
ELECTRICAL	
OTHER	
SEQUENCE NUMBER	
OF _____ SHEETS	

**SUMMERFIELD SUITES HOTEL**  
ADDISON, TEXAS

PROJECT NUMBER 94780

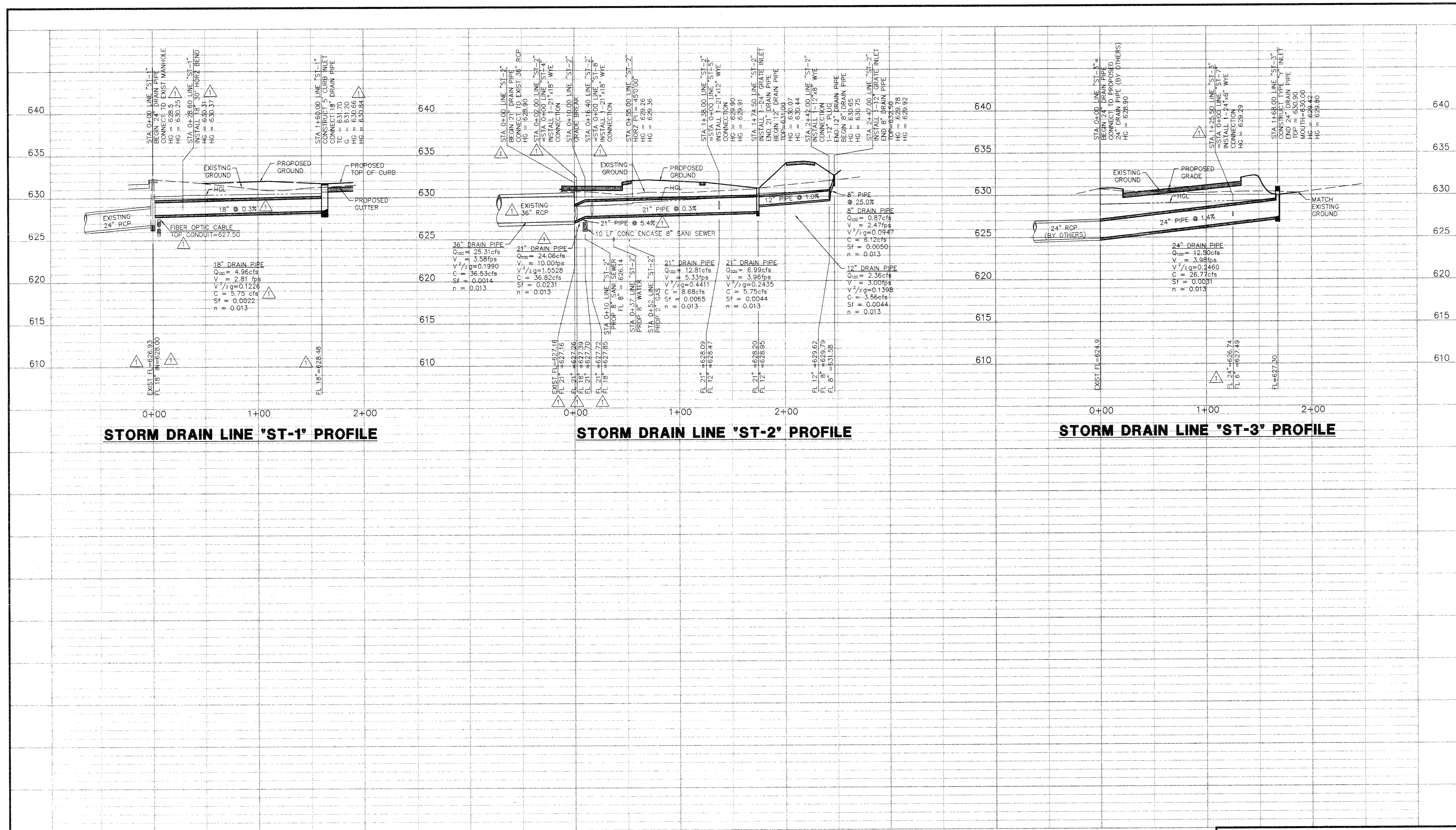

**STORM DRAIN LINE 'ST-1' PROFILE**

**STORM DRAIN LINE 'ST-2' PROFILE**

**STORM DRAIN LINE 'ST-3' PROFILE**

**BENCH MARKS:**  
1. "B" CUT ON S.E. CORNER OF SIDEWALK AT THE ENTRANCE TO 4805 ARAPAHO RD. APPROX ±400 FEET EAST OF ADDISON RD. ELEV. 630.66  
2. "B" ON SOUTH RIM OF MANHOLE LOCATED ON THE SOUTH SIDE OF ARAPAHO RD AT THE NORTHEAST CORNER OF SITE, APPROX. 16.5' EAST OF THE WEST END OF SIDEWALK. ELEV. 632.25

**RECORD DRAWING**  
THIS DRAWING HAS BEEN REVISED TO REFLECT CONSTRUCTION RECORDS MAINTAINED AND PROVIDED BY THE CONTRACTOR FOR THIS PROJECT.  
CONTRACTOR: SOUTHERN MECHANICAL PLUMBING, INC.  
400 S. ASTON  
SUNNYVALE, TEXAS 75182  
DATE REVISED: 29 MARCH 1996

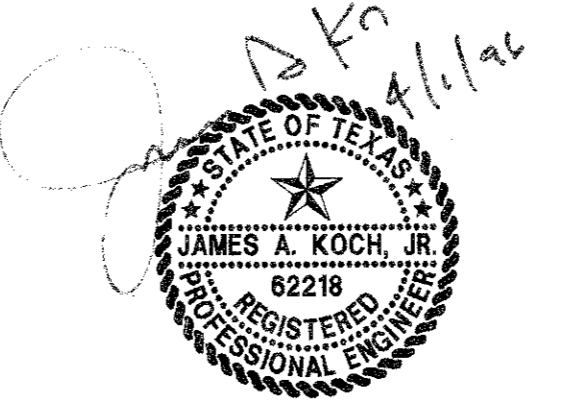

REVISED: MARCH 29, 1996  
REVISED: JULY 13, 1995

**PACHECO KOCH** 9401 LBJ Freeway, Suite 300  
Consulting Engineers, Inc. Dallas, Texas 75243  
Civil Engineering • Land Surveying (214) 235-3031

**STORM DRAIN PROFILE**  
**SUMMERFIELD SUITES HOTEL**  
**ARAPAHO ROAD**  
**QUORUM CENTER ADDITION**  
**CITY OF ADDISON, TEXAS**

DESIGN	DRAWN	DATE	SCALE	NOTES	FILE	NO.
JAK	BB	4/27/95	1"=40'H 1"=5'V			

PK NO: 1467-95.01 DWG NO: 1467-04

STORM DRAIN PROFILE  
SHEET TITLE  
SHEET NUMBER  
**C4**  
4 OF 7 SHEETS

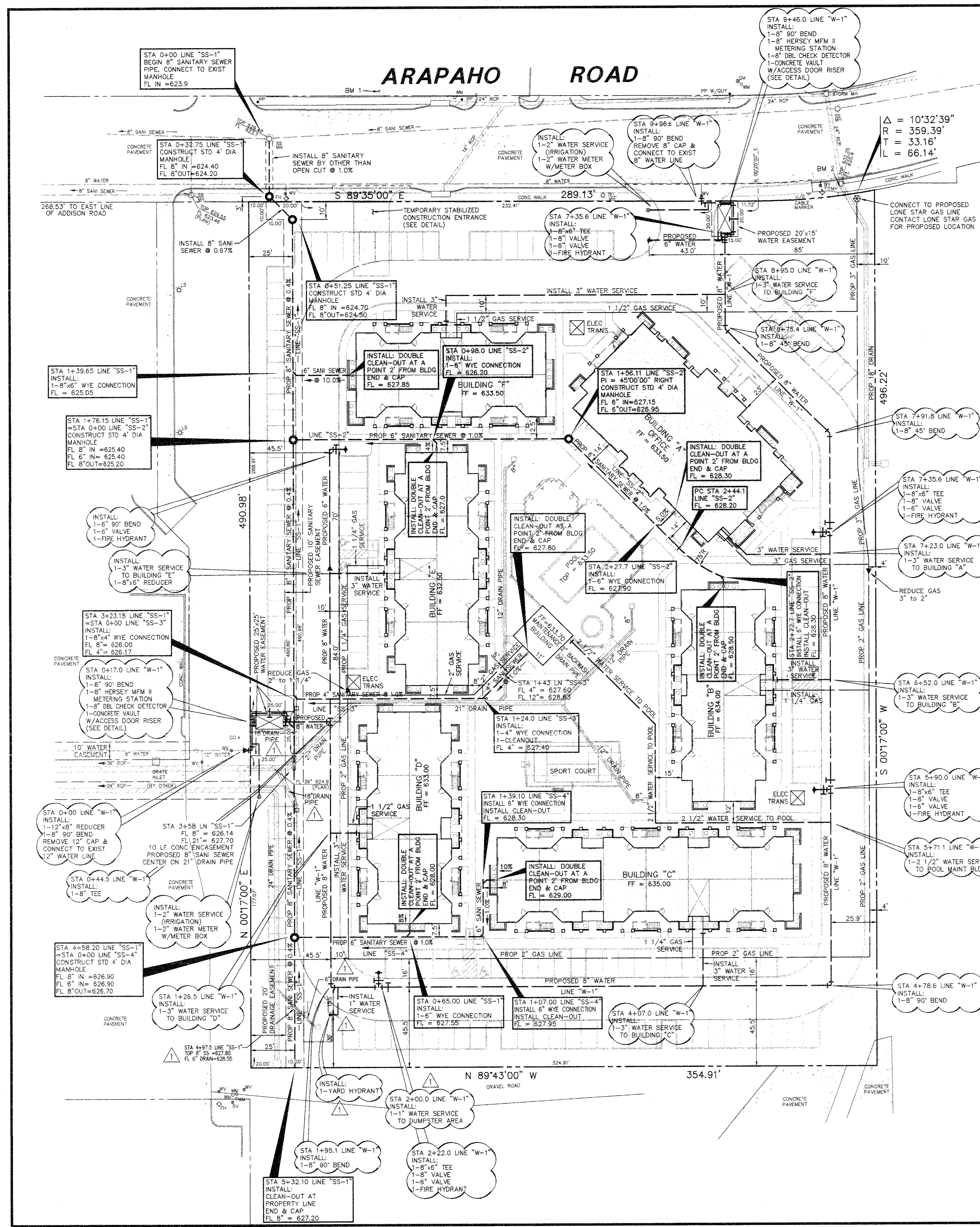

- LEGEND**
- PH Fire Hydrant
  - PP Power Pole
  - LS Light Standard
  - WM Water Meter
  - WV Water Valve
  - WC Cleanout
  - MH Manhole
  - GM Gas Meter
  - DL Property Line

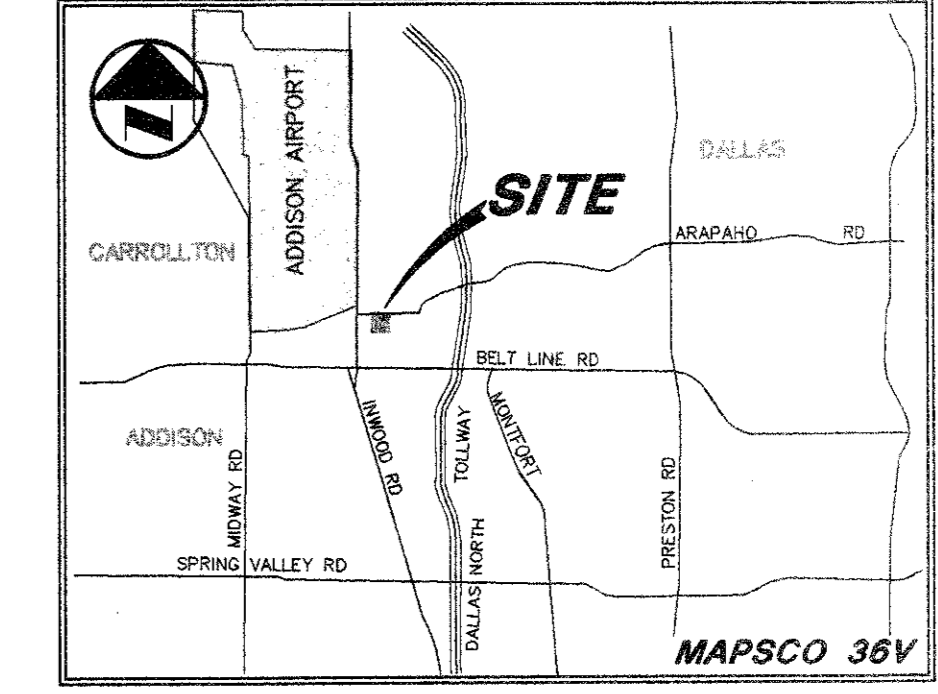
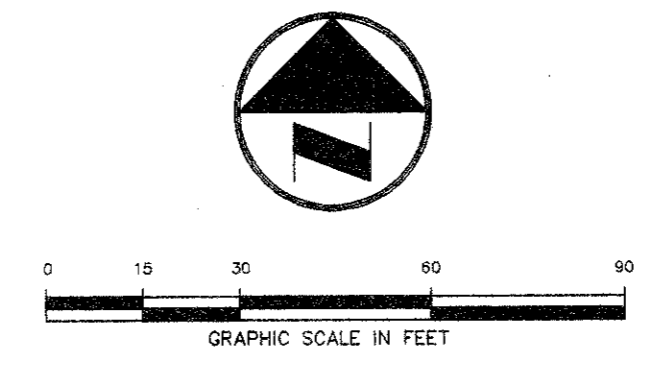

VICINITY MAP

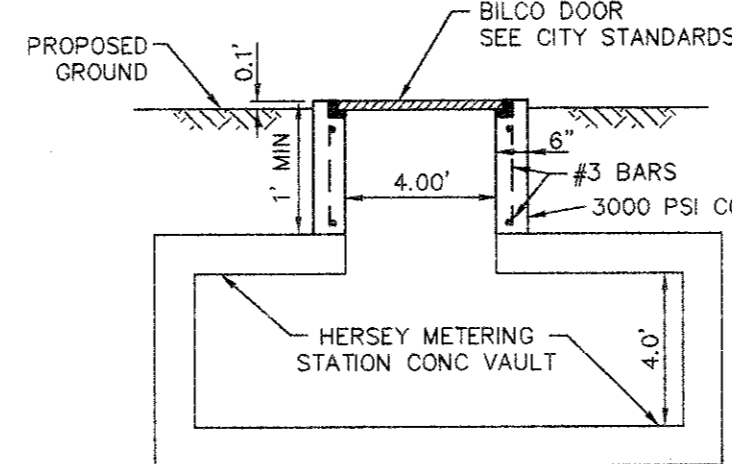

ACCESS DOOR RISER

**CAUTION!!!**  
GAS LINE IN AREA - CONTACT LONE STAR GAS 48 HOURS PRIOR TO CONSTRUCTION PHONE: (214)263-3444

**CONTACT:**  
MR ED KEAH, OPERATING SUPPORT SECTION DISTRIBUTION DEPARTMENT, 2 WORKING DAYS PRIOR TO EXCAVATING T.U. ELECTRIC FACILITIES. PHONE: (214)698-7239 OR (214)698-7207

**CAUTION!!!**  
UNDERGROUND TELEPHONE IN AREA - CONTACT S.W.B.T. 48 HOURS PRIOR TO CONSTRUCTION PHONE: (214)698-7239 (UNDERGROUND) PHONE: (214)698-7240 (OVER-HEAD)

**BENCH MARKS:**  
1. "D" CUT ON S.E. CORNER OF SIDEWALK AT THE ENTRANCE TO 4805 ARAPAHO RD. APPROX ±400 FEET EAST OF ADDISON RD. ELEV. 630.66  
2. "D" ON SOUTH RIM OF MANHOLE LOCATED ON THE SOUTH SIDE OF ARAPAHO RD AT THE NORTHEAST CORNER OF SITE, APPROX. 16.5' EAST OF THE WEST END OF SIDEWALK. ELEV. 632.25

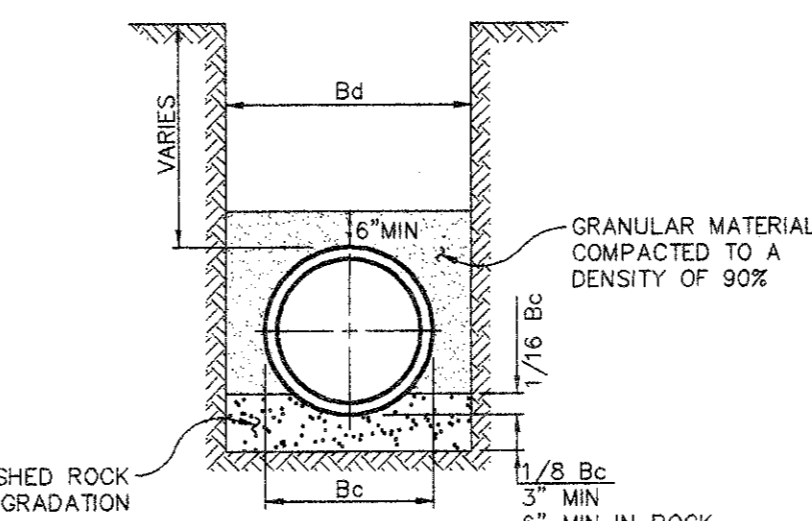

EMBEDMENT FOR PRIVATE WATER CONDUITS

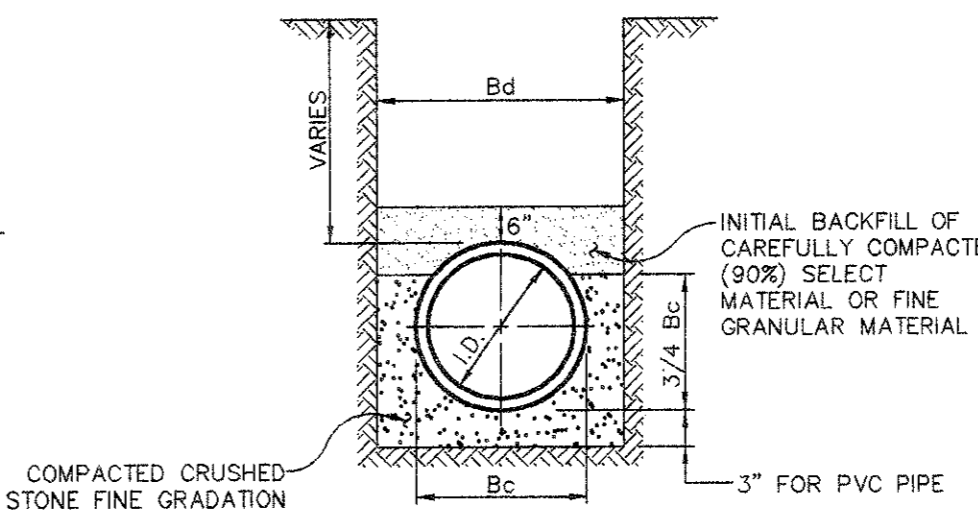

EMBEDMENT FOR PRIVATE SANITARY SEWER CONDUITS

**NOTE:**  
PRIOR TO INSTALLATION OF WATER SERVICE, THE BACKFLOW PREVENTION DEVICE SHALL BE TESTED AND CERTIFIED TO FUNCTION BY A LICENSED PROFESSIONAL.

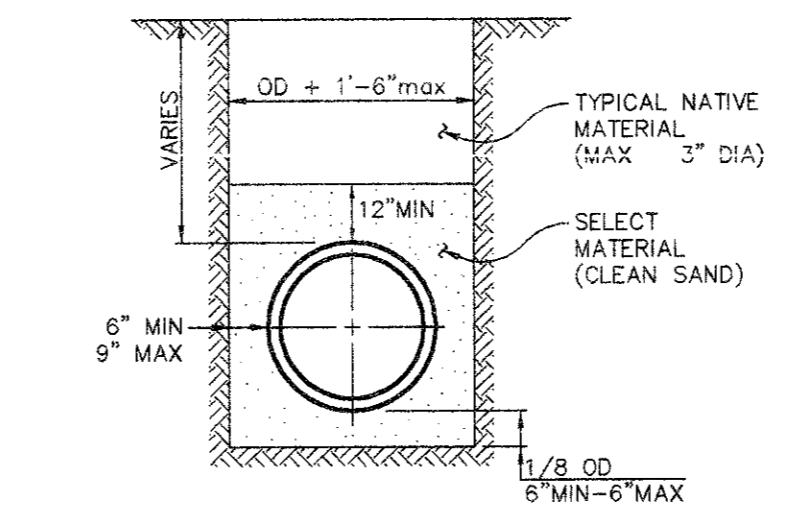

CLASS 4 EMBEDMENT FOR PUBLIC WATER CONDUITS

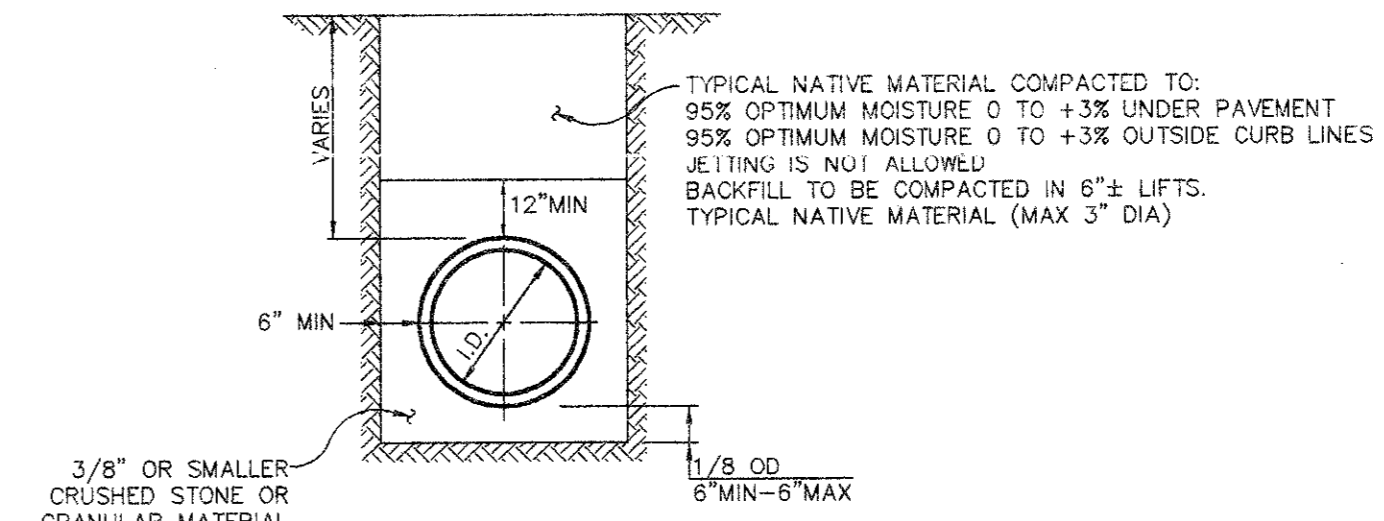

CLASS 4 EMBEDMENT FOR PUBLIC SANITARY SEWER CONDUITS

**RECORD DRAWING**  
THIS DRAWING HAS BEEN REVISED TO REFLECT CONSTRUCTION RECORDS MAINTAINED AND PROVIDED BY THE CONTRACTOR FOR THIS PROJECT.  
CONTRACTOR: SOUTHERN MECHANICAL PLUMBING, INC. 400 S. ASTON SUNNYVALE, TEXAS 75182  
DATE REVISED: 29 MARCH 1996

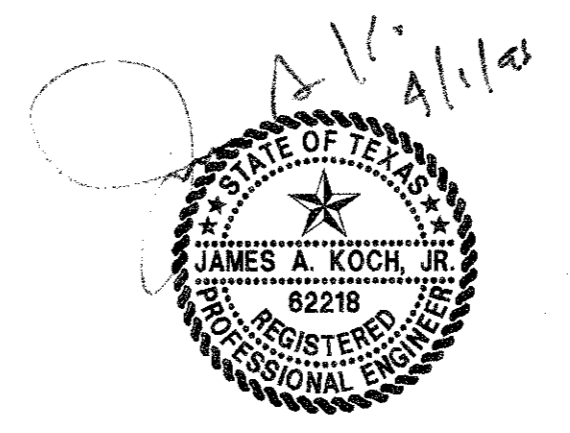

REVIS: MARCH 29, 1996  
REVIS: JULY 13, 1995

**PACHECO KOCH** 9401 LBJ Freeway, Suite 300  
Consulting Engineers, Inc. Dallas, Texas 75243  
Civil Engineering • Land Surveying (214) 235-3051

**UTILITY PLAN**  
**SUMMERFIELD SUITES HOTEL**  
**ARAPAHO ROAD**  
**QUORUM CENTER ADDITION**  
**TOWN OF ADDISON, TEXAS**

DESIGN	DRAWN	DATE	SCALE	NOTES	FILE	NO.
JAK	BB	5/3/95	1"=30'			

**PRINTS ISSUED**

DATE	PURPOSE	NO.

**FOR CONSTRUCTION:**

**REVISIONS**

DATE	ITEM	NO.

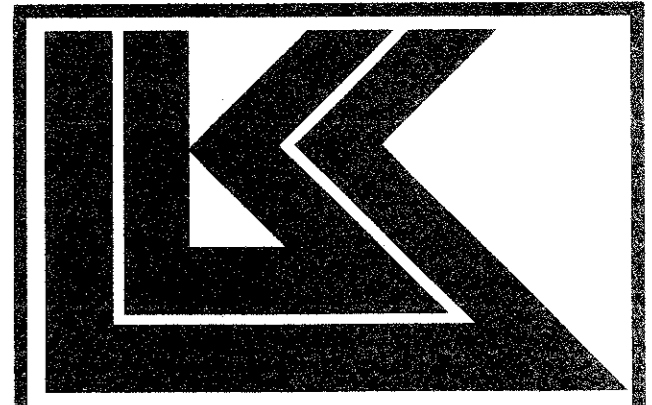

**LAW/KINGDON, INC.**  
ARCHITECTS & ENGINEERS  
345 RIVERVIEW, WICHITA, KS 67208  
Phone: (316) 268-0239 Fax: (316) 268-0202  
Copyright © 1994

DRAWN	CHECKED
BB	JAK

**RELATED DRAWINGS**

SHELL	SEQUENCE NUMBER
DETAILS	
STRUCTURE	
MECHANICAL	
ELECTRICAL	
OTHER	

OF \_\_\_\_\_ SHEETS

**SUMMERFIELD SUITES HOTEL**  
ADDISON, TEXAS

PROJECT NUMBER 94780

**UTILITY PLAN**

SHEET TITLE

SHEET NUMBER

**C-5**

5 of 7 SHEETS

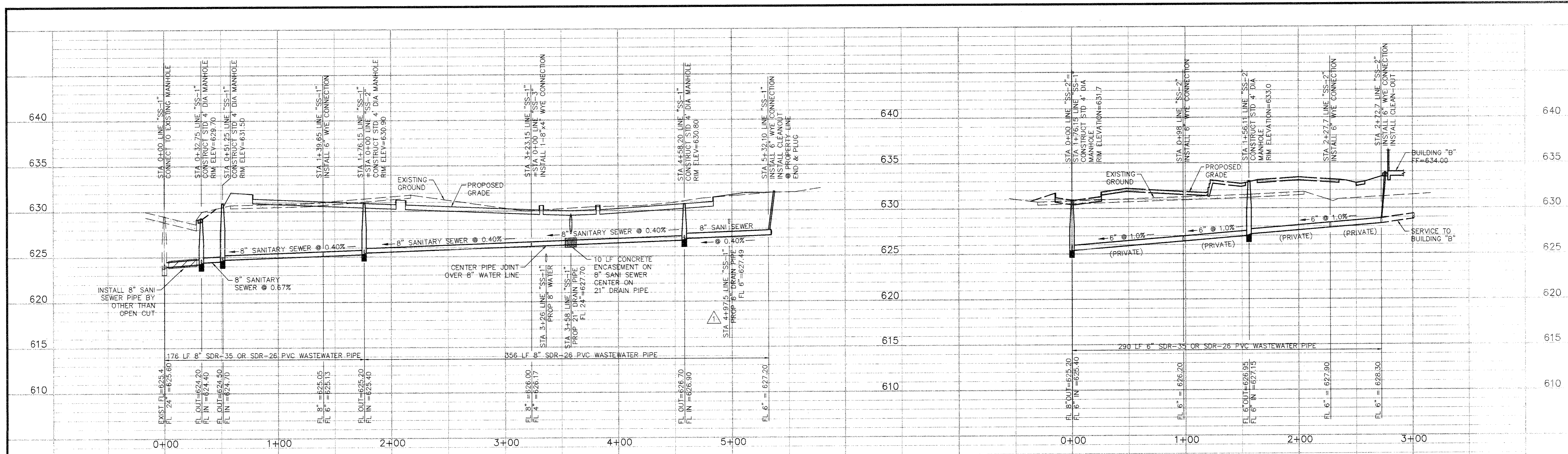

**SANITARY SEWER LINE 'SS-1' PROFILE**

**SANITARY SEWER LINE 'SS-2' PROFILE**

- BENCH MARKS:**
- "D" OUT ON S.E. CORNER OF SIDEWALK AT THE ENTRANCE TO 4805 ARAPAHO RD. APPROX ±400 FEET EAST OF ADDISON RD. ELEV. 630.66
  - "D" ON SOUTH RIM OF MANHOLE LOCATED ON THE SOUTH SIDE OF ARAPAHO RD AT THE NORTHEAST CORNER OF SITE, APPROX. 16.5' EAST OF THE WEST END OF SIDEWALK. ELEV. 632.25

**RECORD DRAWING**

THIS DRAWING HAS BEEN REVISED TO REFLECT CONSTRUCTION RECORDS MAINTAINED AND PROVIDED BY THE CONTRACTOR FOR THIS PROJECT.

CONTRACTOR: SOUTHERN MECHANICAL PLUMBING, INC.  
400 S. ASTON  
SUNNYVALE, TEXAS 75182

DATE REVISED: 29 MARCH 1996



- REVISED: MARCH 29, 1996
- REVISED: JULY 13, 1995

**PACHECO KOCH** 9401 LBJ Freeway, Suite 300  
Consulting Engineers, Inc. Dallas, Texas 75243  
(214) 255-3031  
Civil Engineering • Land Surveying

**SANITARY SEWER PROFILE**  
**SUMMERFIELD SUITES HOTEL**  
**ARAPAHO ROAD**  
**QUORUM CENTER ADDITION**  
**CITY OF ADDISON, TEXAS**

DESIGN	DRAWN	DATE	SCALE	NOTES	FILE	NO.
JAK	BB	5/3/95	1"=40'H 1"=5'V			

PK NO: 1467-95.01 DWG NO: 1457-05

**PRINTS ISSUED**

DATE	PURPOSE	NO.

**FOR CONSTRUCTION:**

**REVISIONS**

DATE	ITEM	NO.

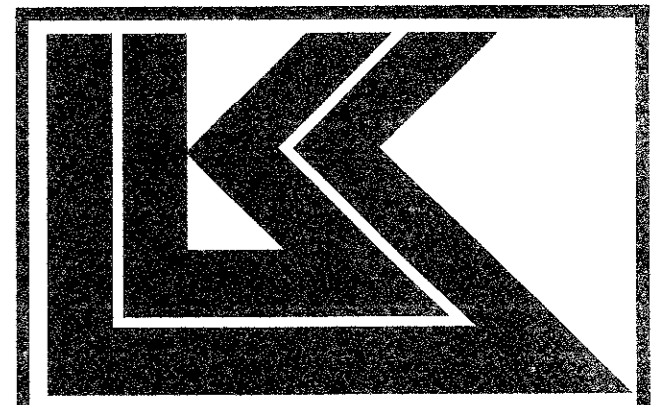

**LAW/KINGDON, INC.**  
ARCHITECTS & ENGINEERS  
345 RIVERVIEW, WICHITA, KS 67205  
Phone: (316) 268-0200 Fax: (316) 268-6000  
Copyright © 1994

DRAWN	CHECKED
BB	JAK

**RELATED DRAWINGS**

SHELL	DETAILS	STRUCTURE	MECHANICAL	ELECTRICAL	OTHER

SEQUENCE NUMBER

DF \_\_\_\_\_ SHEETS

**SUMMERFIELD SUITES HOTEL**

ADDISON, TEXAS

PROJECT NUMBER 94780

**SANITARY SEWER PROFILE**

SHEET TITLE

SHEET NUMBER

**C-6**

6 OF 7 SHEETS

PRINTS ISSUED			
DATE	PURPOSE	BY	NO.

FOR CONSTRUCTION			
REVISIONS			
DATE	ITEM	BY	NO.

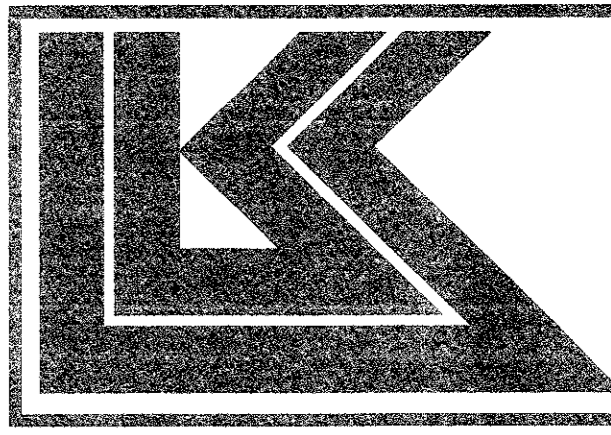

LAW/KINGDON, INC.  
ARCHITECTS & ENGINEERS  
345 SILVERVIEW, WICHITA, KS 67209  
Phone: (316) 268-3550 Fax: (316) 268-3552  
Copyright © 1994

10. BARRICADING AND PROJECT SIGNS SHALL CONFORM TO "STATE DEPARTMENT OF HIGHWAYS AND PUBLIC TRANSPORTATION BARRICADING AND CONSTRUCTION STANDARDS."

11. PRIOR TO COMMENCEMENT OF CONSTRUCTION, BONDS AND THREE-WAY CONTRACTS SHALL BE SUBMITTED TO THE CITY AS REQUIRED.

12. WHERE A SANITARY SEWER PARALLELS A WATER LINE, THE SEWER SHALL BE CONSTRUCTED OF CAST IRON, DUCTILE IRON OR PVC MEETING ASTM SPECIFICATIONS WITH A PRESSURE RATING FOR BOTH THE PIPE AND JOINTS OF 150 PSI. THE VERTICAL SEPARATION SHALL BE MINIMUM OF TWO FEET BETWEEN OUTSIDE DIAMETERS AND THE HORIZONTAL SEPARATION SHALL BE A MINIMUM OF FOUR FEET BETWEEN OUTSIDE DIAMETERS. THE SEWER SHALL BE LOCATED BELOW THE WATER LINE.

BROWN	CHECKED
BB	JAK
RELATED DRAWINGS	
SHELL	
DETAILS	
STRUCTURE	
MECHANICAL	
ELECTRICAL	
OTHER	
SEQUENCE NUMBER	
OF _____ SHEETS	

REVISED: MARCH 29, 1996

**PACHECO KOCH** Consulting Engineers, Inc.  
8401 LBJ Freeway, Suite 800 Dallas, Texas 75243 (214) 236-3031  
Civil Engineering • Land Surveying

**STANDARD DETAILS**  
**SUMMERFIELD SUITES HOTEL**  
**ARAPAHO ROAD**  
**QUORUM CENTER ADDITION**  
**TOWN OF ADDISON, TEXAS**

DESIGN	DRAWN	DATE	SCALE	NOTES	FILE	NO.
JAK	BB	4/27/95	1"=30'			

PROJECT NUMBER 94780

STANDARD DETAILS  
SHEET TITLE  
SHEET NUMBER  
**C-7**  
7 OF 7 SHEETS

**PAVING AND DRAINAGE GENERAL NOTES**

1. ALL WORK, UNLESS OTHERWISE NOTED, SHALL CONFORM TO THE STANDARD SPECIFICATIONS FOR PUBLIC WORKS CONSTRUCTION, ISSUED BY THE NORTH CENTRAL TEXAS COUNCIL OF GOVERNMENTS, AND TOWN OF ADDISON STANDARD CONSTRUCTION SPECIFICATIONS.
2. UNLESS OTHERWISE NOTED, ALL CONCRETE SHALL BE CLASS "A", (3000 PSI).
3. THE HORIZONTAL AND VERTICAL LOCATIONS OF EXISTING SUBSURFACE UTILITIES HAVE BEEN DETERMINED FROM DATA RECORDED BY OTHERS. CONTRACTOR SHALL VERIFY THAT NECESSARY CROSSING CLEARANCES BETWEEN EXISTING AND PROPOSED UTILITIES EXIST PRIOR TO CONSTRUCTION OF ANY SUCH CROSSING. IT WILL BE THE RESPONSIBILITY OF THE CONTRACTOR TO PROTECT ALL PUBLIC UTILITIES IN THE CONSTRUCTION OF THIS PROJECT.
4. CONTRACTOR SHALL MAINTAIN ONE SET OF "RECORD DRAWINGS" ON SITE WHICH WILL BE SUBMITTED TO OWNER OR ENGINEER UPON COMPLETION OF THE PROJECT. RECORD DRAWINGS SHALL INDICATE THE LOCATION OF ALL SUBTERRANEAN UTILITY IMPROVEMENTS, AND INDICATE TIES TO ALL MANHOLES, CULVERTS, INLETS, JUNCTION BOXES, ETC.
5. THE CONTRACTOR IS RESPONSIBLE FOR COMPLIANCE WITH ALL FEDERAL, STATE AND LOCAL REGULATIONS REGARDING TRENCH SAFETY.
6. STORM DRAIN LINES MAY BE OF THE FOLLOWING MATERIALS:  
a. RCP C-76, CLASS III  
INSTALLED IN ACCORDANCE WITH MANUFACTURER'S SPECIFICATIONS.
7. BARRICADING AND PROJECT SIGNS SHALL CONFORM TO THE "TEXAS MANUAL ON UNIFORM TRAFFIC CONTROL DEVICES, PART VI".
8. PRIOR TO COMMENCEMENT OF CONSTRUCTION, BONDS AND THREE-WAY CONTRACTS SHALL BE SUBMITTED TO THE CITY AS REQUIRED.

**WATER AND SANITARY SEWER GENERAL NOTES**

1. ALL WORK, UNLESS OTHERWISE NOTED, SHALL CONFORM TO THE STANDARD SPECIFICATIONS FOR PUBLIC WORKS CONSTRUCTION, ISSUED BY THE NORTH CENTRAL TEXAS COUNCIL OF GOVERNMENTS, AND TOWN OF ADDISON STANDARD CONSTRUCTION SPECIFICATIONS.
2. UNLESS OTHERWISE NOTED, ALL CONCRETE SHALL BE CLASS "A", (3000 PSI).
3. THE HORIZONTAL AND VERTICAL LOCATIONS OF EXISTING SUBSURFACE UTILITIES HAVE BEEN DETERMINED FROM DATA RECORDED BY OTHERS. CONTRACTOR SHALL VERIFY THAT NECESSARY CROSSING CLEARANCES BETWEEN EXISTING AND PROPOSED UTILITIES EXIST PRIOR TO CONSTRUCTION OF ANY SUCH CROSSING. IT WILL BE THE RESPONSIBILITY OF THE CONTRACTOR TO PROTECT ALL PUBLIC UTILITIES IN THE CONSTRUCTION OF THIS PROJECT.
4. CONTRACTOR SHALL MAINTAIN ONE SET OF "RECORD DRAWINGS" ON SITE WHICH WILL BE SUBMITTED TO OWNER OR ENGINEER UPON COMPLETION OF THE PROJECT. RECORD DRAWINGS SHALL INDICATE THE LOCATION OF ALL SUBTERRANEAN UTILITY IMPROVEMENTS, AND INDICATE TIES TO ALL MANHOLES, CULVERTS, INLETS, JUNCTION BOXES, ETC.
5. ALL WATER MAINS SHALL BE PROTECTION OR PVC C900, DR 14, CLASS 200, CATHODIC PROTECTION.
6. ALL WATER MAINS UNLESS OTHERWISE NOTED SHALL HAVE A MINIMUM COVER OF 48" BELOW FINISHED GRADE.
7. SANITARY SEWER PIPE SHALL BE PVC SDR-35, OR SDR-26 AS NOTED.
8. THE CONTRACTOR IS RESPONSIBLE FOR COMPLIANCE WITH ALL FEDERAL, STATE AND LOCAL REGULATIONS REGARDING TRENCH SAFETY.
10. BARRICADING AND PROJECT SIGNS SHALL CONFORM TO "STATE DEPARTMENT OF HIGHWAYS AND PUBLIC TRANSPORTATION BARRICADING AND CONSTRUCTION STANDARDS."
11. PRIOR TO COMMENCEMENT OF CONSTRUCTION, BONDS AND THREE-WAY CONTRACTS SHALL BE SUBMITTED TO THE CITY AS REQUIRED.
12. WHERE A SANITARY SEWER PARALLELS A WATER LINE, THE SEWER SHALL BE CONSTRUCTED OF CAST IRON, DUCTILE IRON OR PVC MEETING ASTM SPECIFICATIONS WITH A PRESSURE RATING FOR BOTH THE PIPE AND JOINTS OF 150 PSI. THE VERTICAL SEPARATION SHALL BE MINIMUM OF TWO FEET BETWEEN OUTSIDE DIAMETERS AND THE HORIZONTAL SEPARATION SHALL BE A MINIMUM OF FOUR FEET BETWEEN OUTSIDE DIAMETERS. THE SEWER SHALL BE LOCATED BELOW THE WATER LINE.

**GENERAL NOTES:**

- Prior to final acceptance by the Town of Addison,
  1. A Texas Registered Professional Engineer shall certify that the project was constructed in accordance with the plans and specifications approved by the Town of Addison.
  2. The owner shall provide 1 reproducible set of as-builts (sealed and certified by a Texas Registered Professional Engineer) and 2 blue line sets.
  3. A five foot sidewalk shall be installed along Arapaho Road, See attached detail.
  4. A one year 10% maintenance bond is required for the internal subdivision infrastructure.
  5. Contractor shall demonstrate that the water and sanitary sewer systems meet the proper pressure, bacteria and mandrel tests. In addition, the contractor shall provide a VHS format video tape of the sanitary sewer.
- Prior to starting construction, the contractor shall contact the utility companies to located existing facilities. These include but may not be limited to the following:
  1. Town of Addison
  2. Lone Star Gas
  3. Southwestern Bell
  4. Storer Cable
  5. Planned Cable Systems
  6. TU Electric
- Prior to beginning construction, the owner or his authorized representative shall convene a Pre-Construction Conference between the Town of Addison, Consulting Engineer, Contractor(s), Utility companies and any other affected parties. Notify Bruce Ellis at 450-2847 at least 48-hours prior to beginning of construction.
- Any existing pavement, curbs, and/or sidewalks damaged or removed will be repaired by the contractor at their expense.
- Lot pins shall be installed after construction and prior to final acceptance; concrete monuments shall be placed as shown on the final plat and iron pins shall be placed at block corners, curve points and angle points in public right-of-way. Concrete monuments shall be six (6) inches in diameter and twenty-four (24) inches long. An iron rod one-half inch in diameter embedded at least three (3) inches in the monument at the exact intersection point of the monument. The monuments shall be set at such an elevation that after construction, the top of the monument will be not less than twelve (12) inches below the ground surface.
- The contractor shall stamp a 2-inch "S" and 2-inch "W" in the curb at the location of the sewer service and water service lines, respectively.
- At intersections that have valley drainage, the crown of the intersecting streets will culminate in a distance of 40 feet from the intersecting curb line unless otherwise noted.
- Temporary or permanent street barricades shall remain at all point of ingress and egress to prevent public use until such street received final acceptance.
- Contractor shall obtain a right-of-way permit by the Town of Addison for working within the public right-of-way.
- During construction, the owner shall provide a qualified geotechnical lab to perform materials testing during the construction, at the request of the Town of Addison.
- The contractor shall submit material sheets to the Town of Addison for approval prior to incorporating materials into the job.
- The utility contractor shall submit to the Town of Addison for approval a trench safety plan sealed by a registered professional engineer for the installation of utilities greater than five (5) feet in depth.

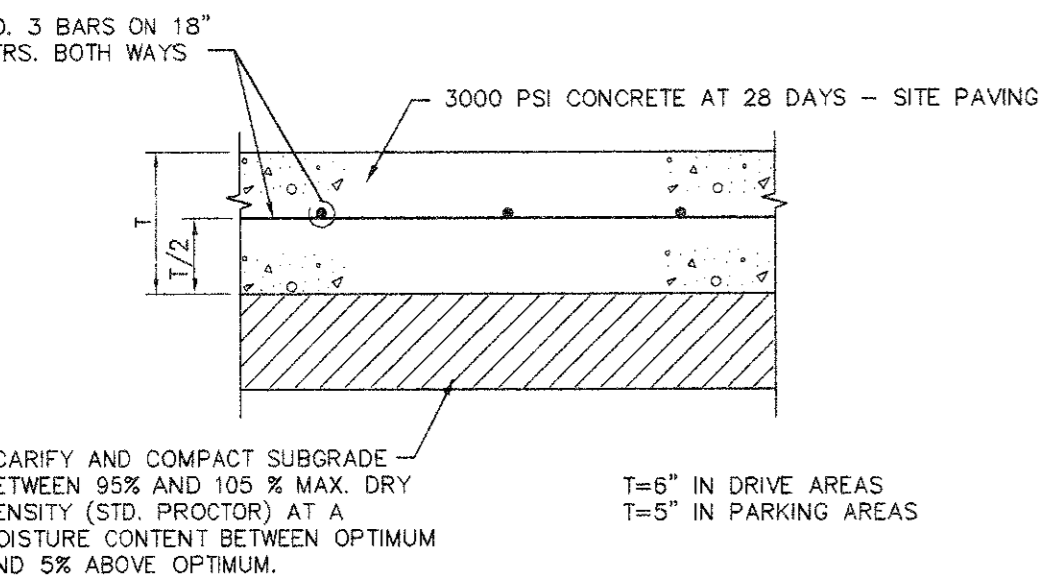

**1 PAVEMENT SECTION**  
NOT TO SCALE

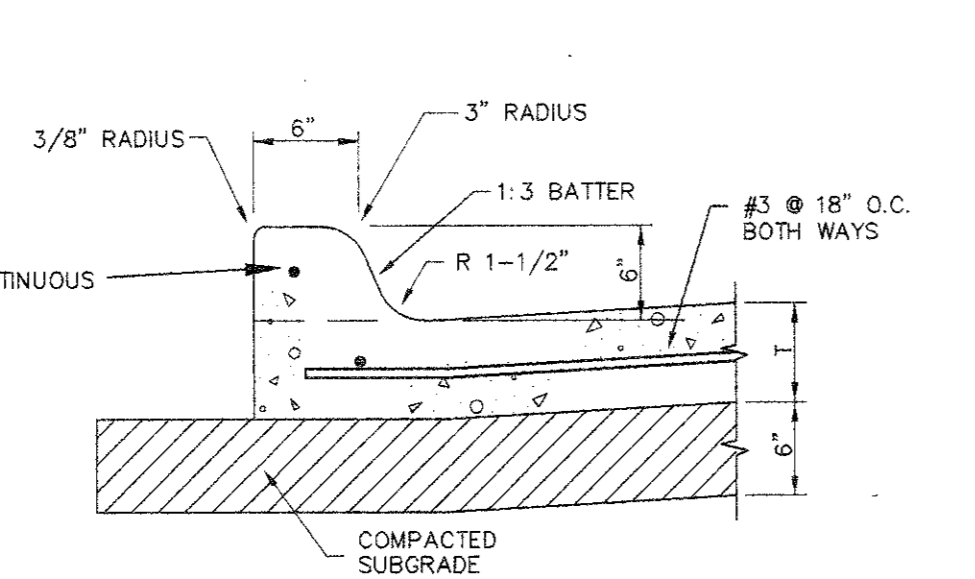

**2 INTEGRAL CURB**  
NOT TO SCALE

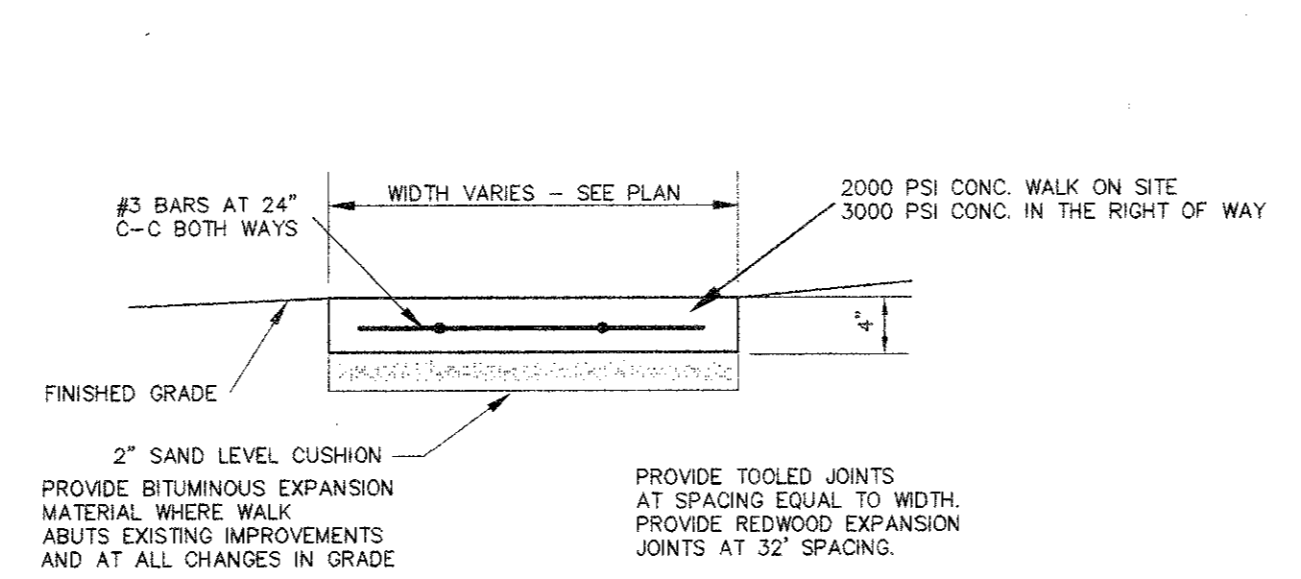

**3 CONCRETE WALK**  
NOT TO SCALE

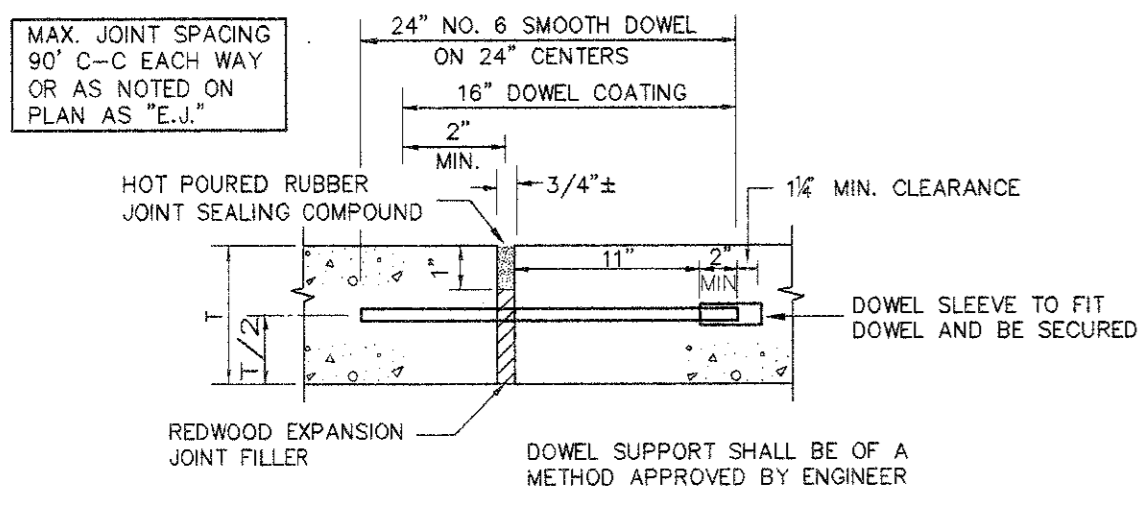

**4 EXPANSION JOINT**  
NOT TO SCALE

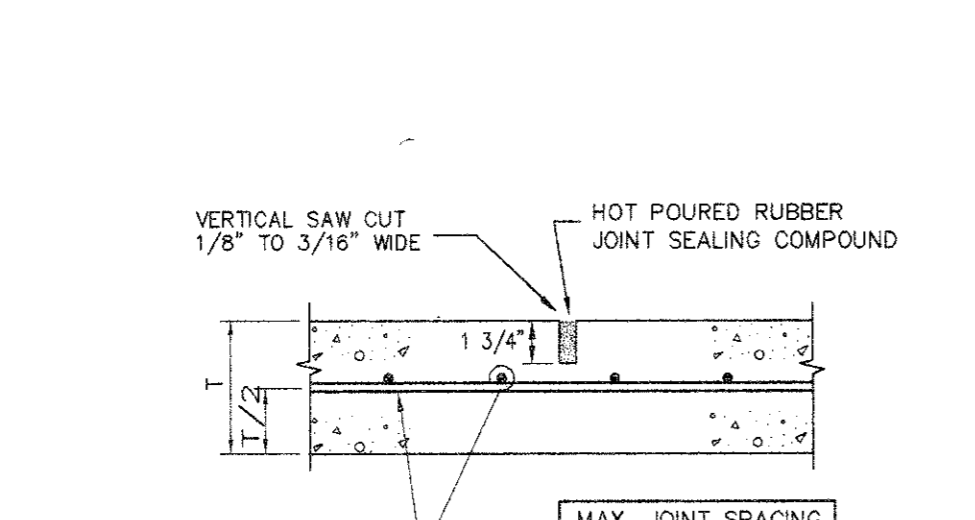

**5 SAWED DUMMY JOINT**  
NOT TO SCALE

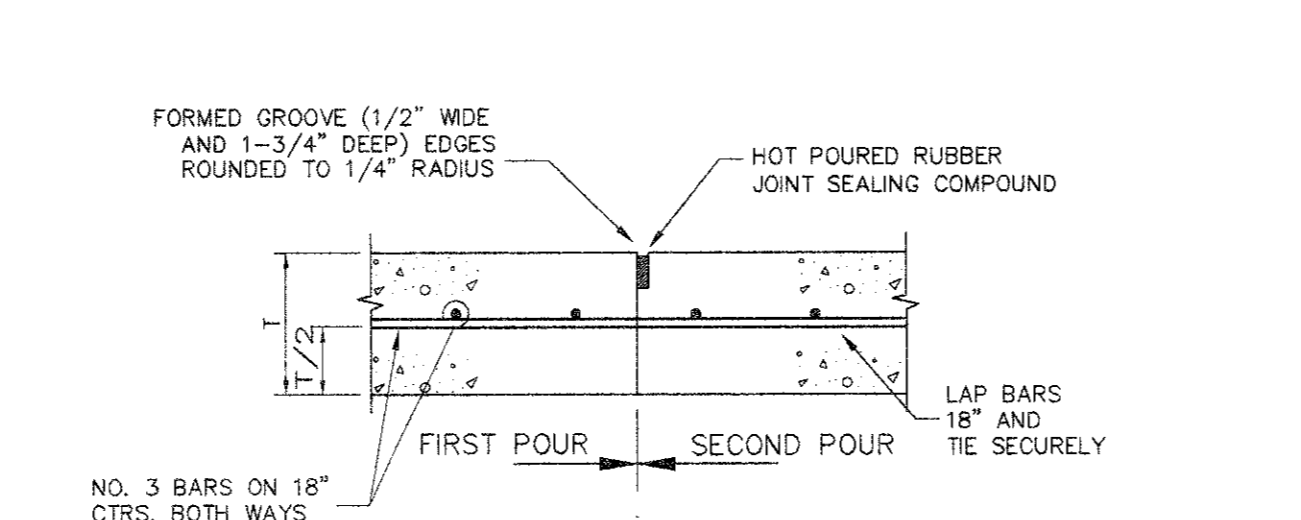

**6 CONSTRUCTION JOINT**  
NOT TO SCALE

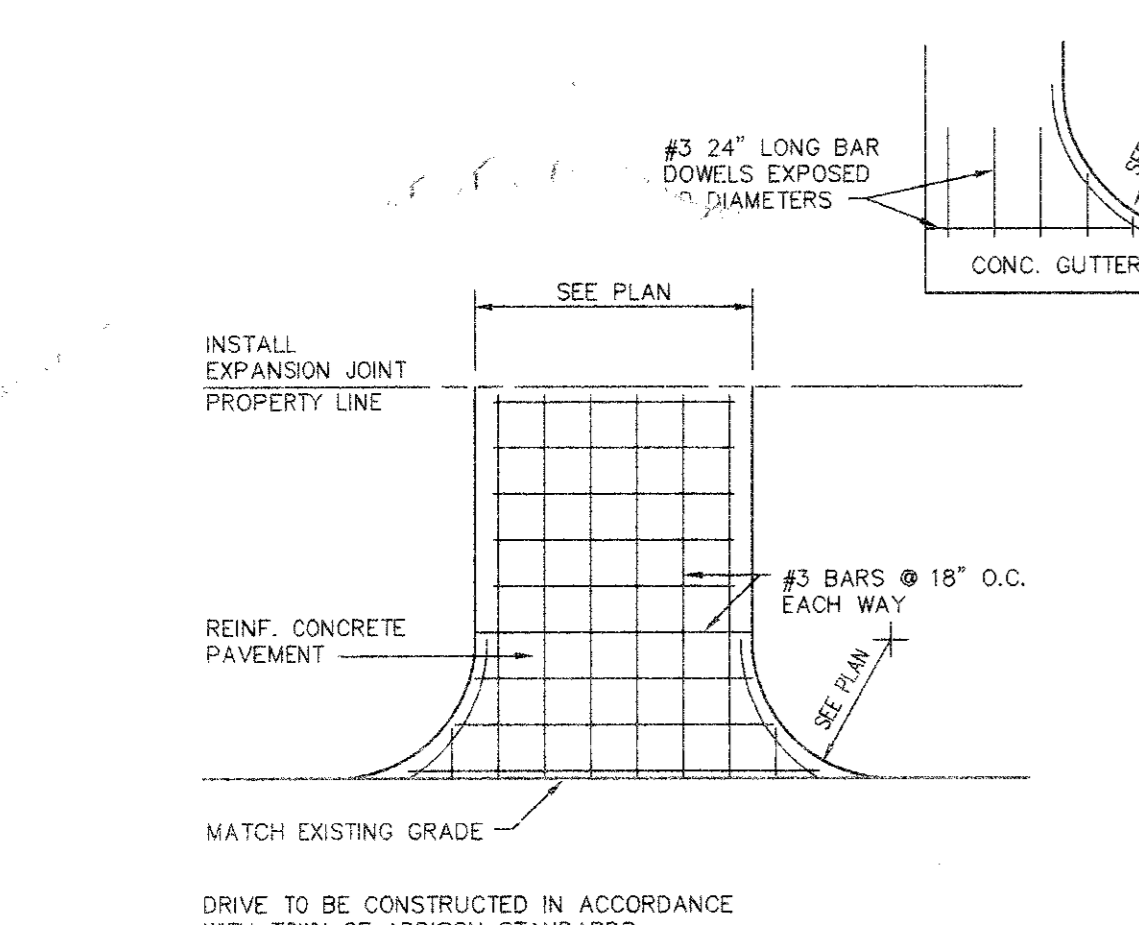

**7 DRIVEWAY APPROACH**  
NOT TO SCALE

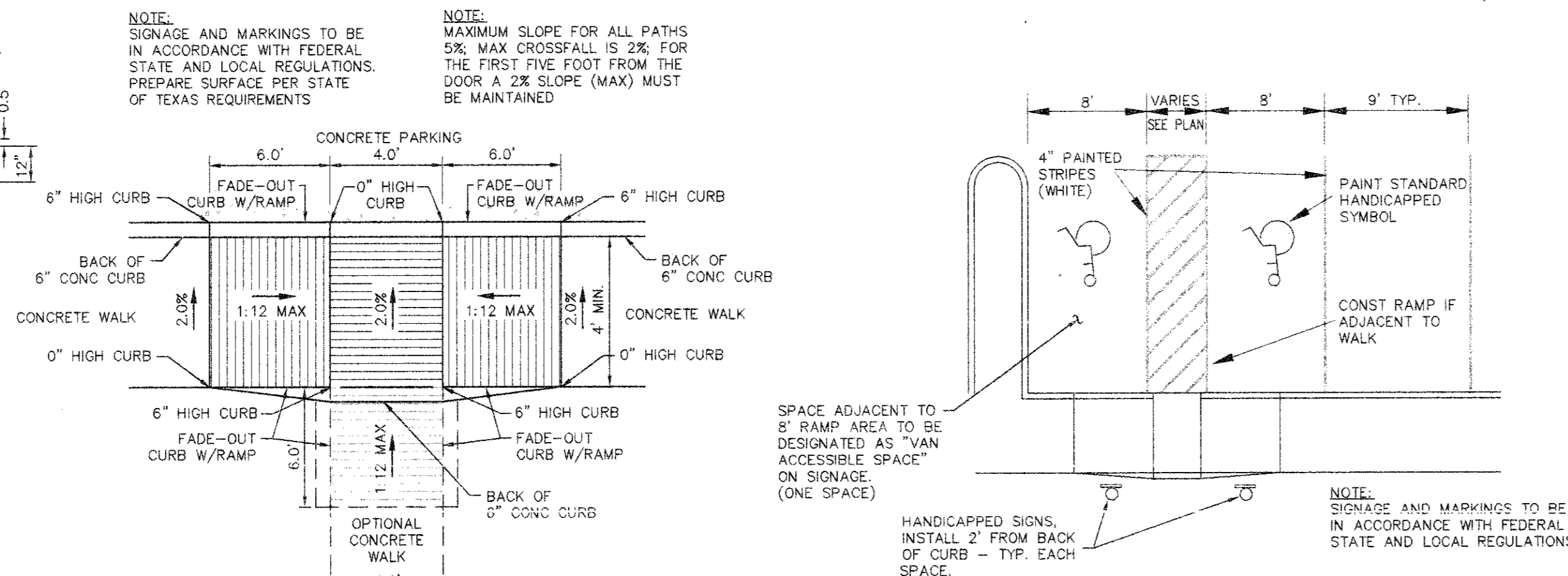

**8 ACCESS RAMP**  
NOT TO SCALE



**HANDICAPPED PARKING LAYOUT**

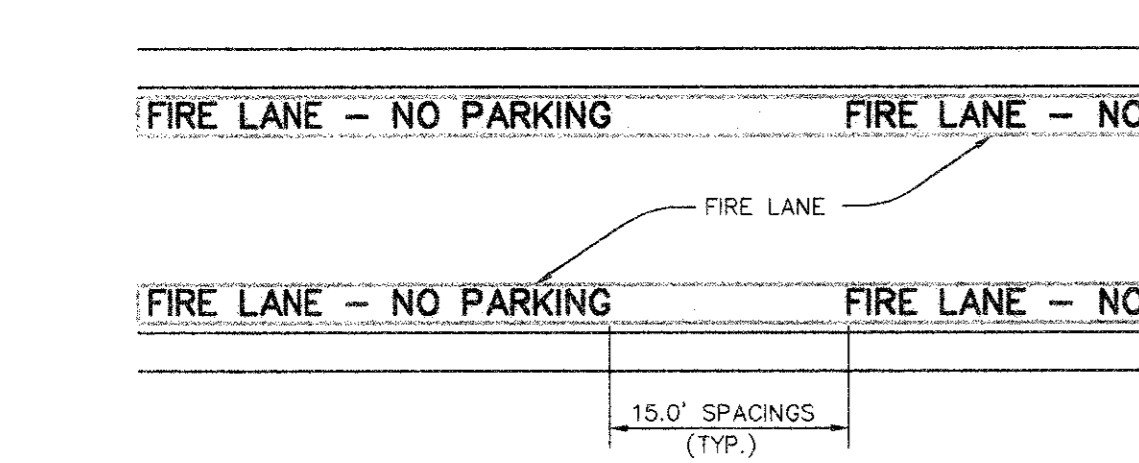

**9 FIRE LANE STRIPING DETAIL**  
NOT TO SCALE

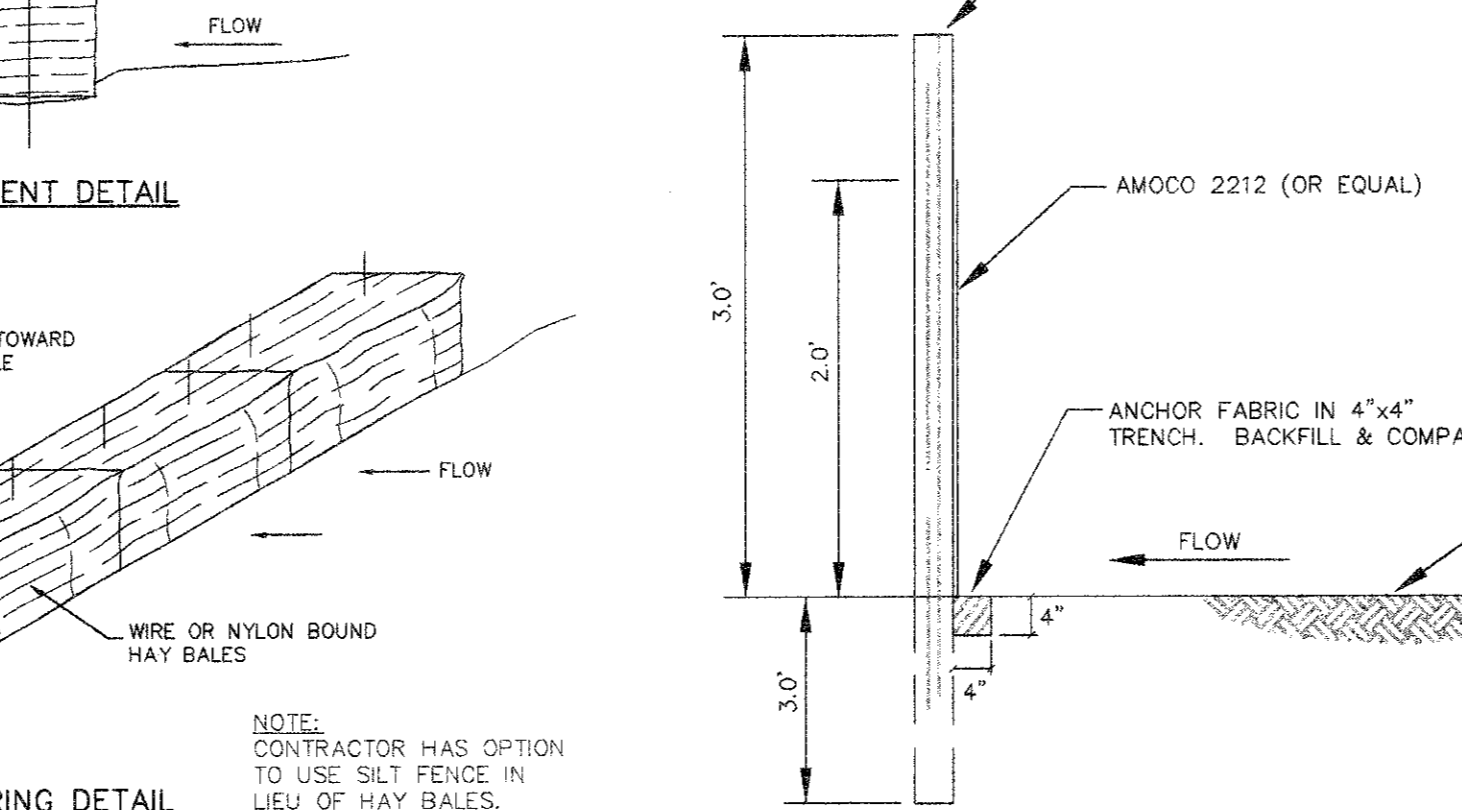

**CONSTRUCTION ENTRANCE**  
N.T.S.



**11 EROSION CONTROL DETAIL**  
NOT TO SCALE

**LOW FLOW SILT FENCE DETAIL:**  
TYPICAL TEMPORARY FILTER FABRIC WITHOUT WIRE FABRIC  
N.T.S.

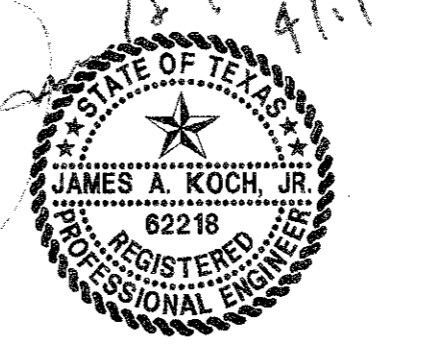

DESIGN	DRAWN	DATE	SCALE	NOTES	FILE	NO.
JAK	BB	4/27/95	1"=30'			