

- LEGEND**
- PH Fire Hydrant
 - PP Power Pole
 - LS Light Standard
 - WM Water Meter
 - WV Water Valve
 - WC Cleanout
 - MH Manhole
 - GM Gas Meter
 - DL Property Line

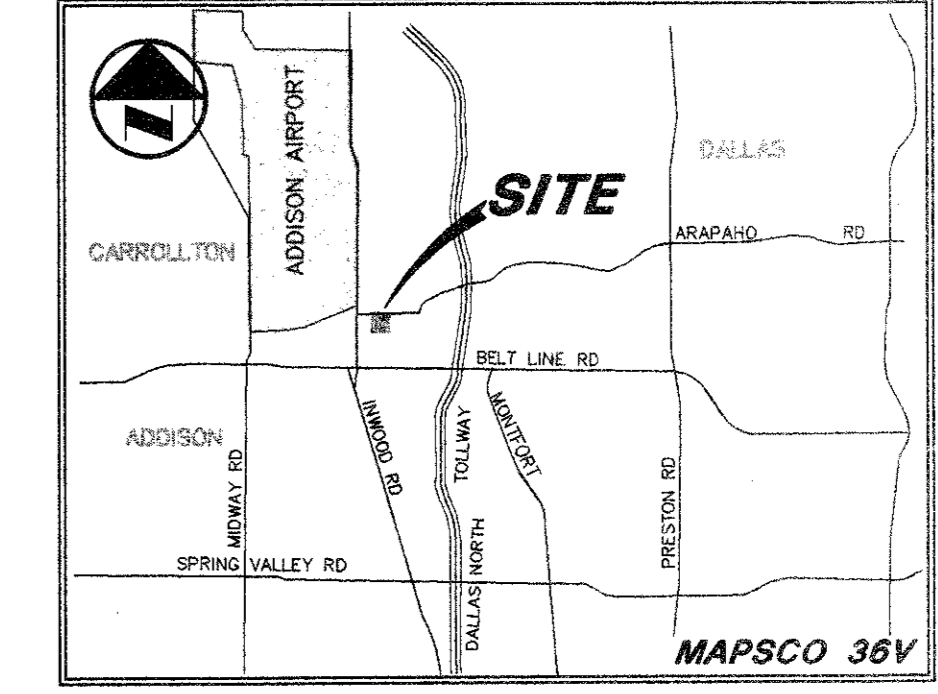

VICINITY MAP

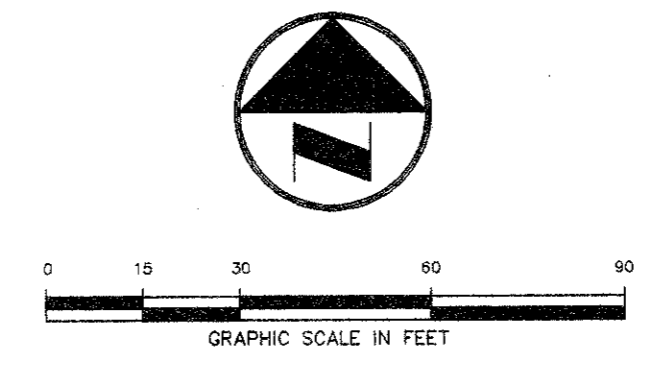
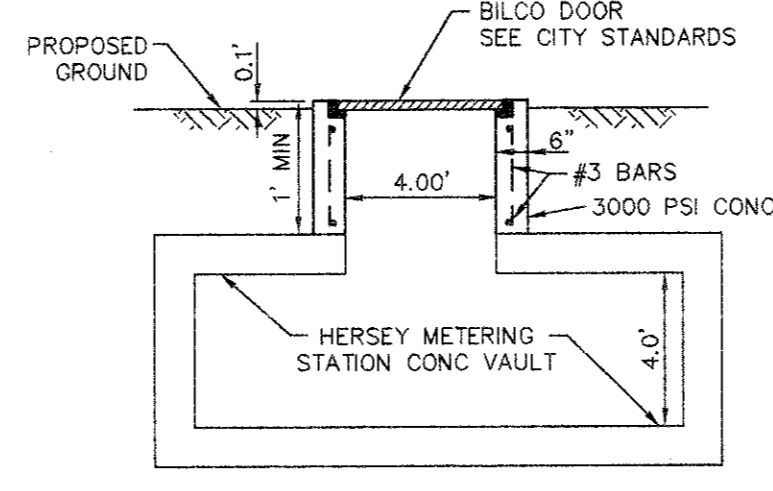

ACCESS DOOR RISER

CAUTION!!!
GAS LINE IN AREA - CONTACT LONE STAR GAS 48 HOURS PRIOR TO CONSTRUCTION PHONE: (214)263-3444

CONTACT:
MR ED KEAH, OPERATING SUPPORT SECTION DISTRIBUTION DEPARTMENT, 2 WORKING DAYS PRIOR TO EXCAVATING T.U. ELECTRIC FACILITIES. PHONE: (214)698-7239 OR (214)698-7207

CAUTION!!!
UNDERGROUND TELEPHONE IN AREA - CONTACT S.W.B.T. 48 HOURS PRIOR TO CONSTRUCTION PHONE: (214)698-7239 (UNDERGROUND) PHONE: (214)698-7240 (OVER-HEAD)

BENCH MARKS:
1. "D" CUT ON S.E. CORNER OF SIDEWALK AT THE ENTRANCE TO 4805 ARAPAHO RD. APPROX ±400 FEET EAST OF ADDISON RD. ELEV. 630.66
2. "D" ON SOUTH RIM OF MANHOLE LOCATED ON THE SOUTH SIDE OF ARAPAHO RD AT THE NORTHEAST CORNER OF SITE, APPROX. 16.5' EAST OF THE WEST END OF SIDEWALK. ELEV. 632.25

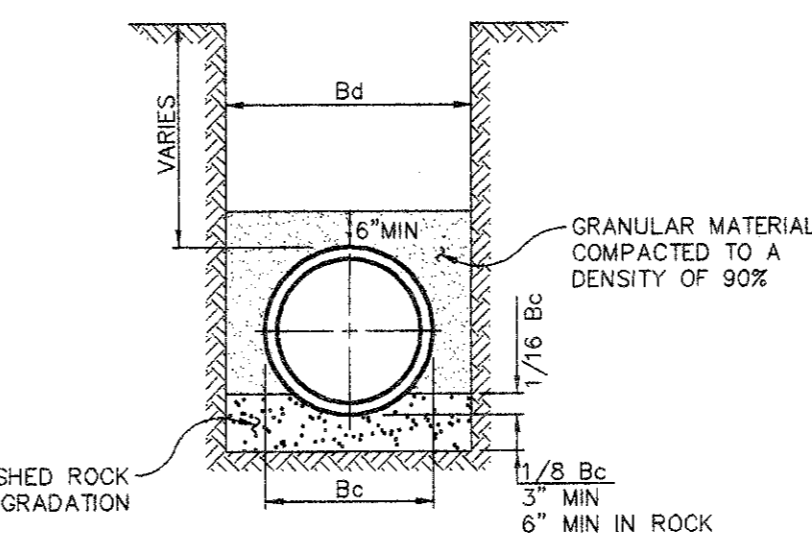

EMBEDMENT FOR PRIVATE WATER CONDUITS

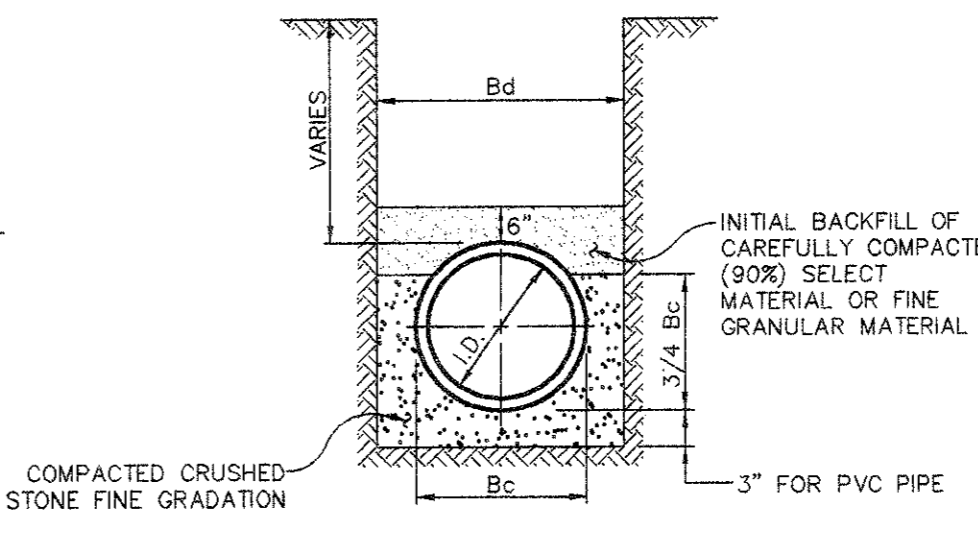

EMBEDMENT FOR PRIVATE SANITARY SEWER CONDUITS

NOTE:
PRIOR TO INSTALLATION OF WATER SERVICE, THE BACKFLOW PREVENTION DEVICE SHALL BE TESTED AND CERTIFIED TO FUNCTION BY A LICENSED PROFESSIONAL.

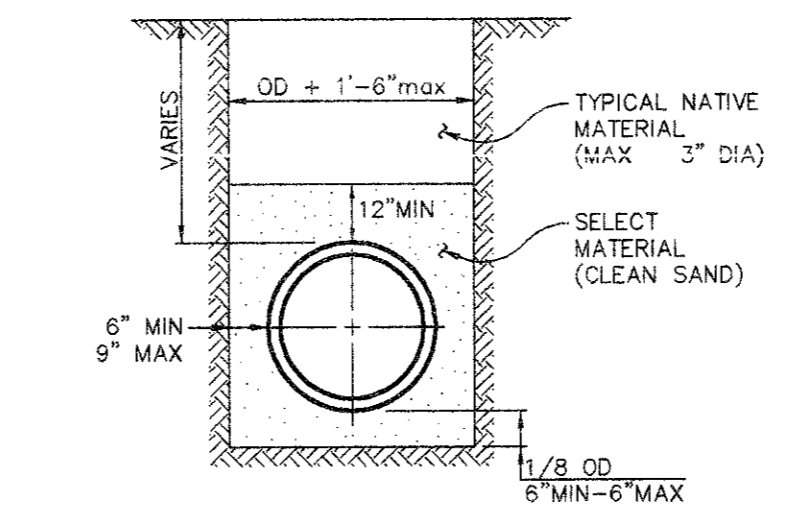

CLASS 4 EMBEDMENT FOR PUBLIC WATER CONDUITS

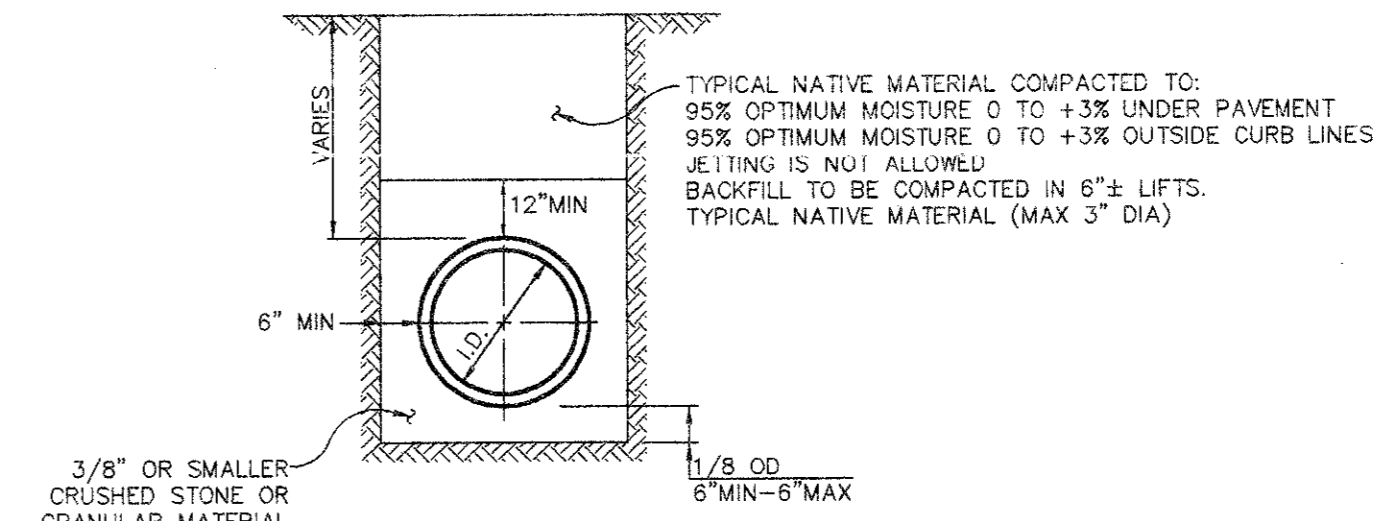

CLASS 4 EMBEDMENT FOR PUBLIC SANITARY SEWER CONDUITS

RECORD DRAWING

THIS DRAWING HAS BEEN REVISED TO REFLECT CONSTRUCTION RECORDS MAINTAINED AND PROVIDED BY THE CONTRACTOR FOR THIS PROJECT.

CONTRACTOR: SOUTHERN MECHANICAL PLUMBING, INC.
400 S. ASTON
SUNNYVALE, TEXAS 75182

DATE REVISED: 29 MARCH 1996

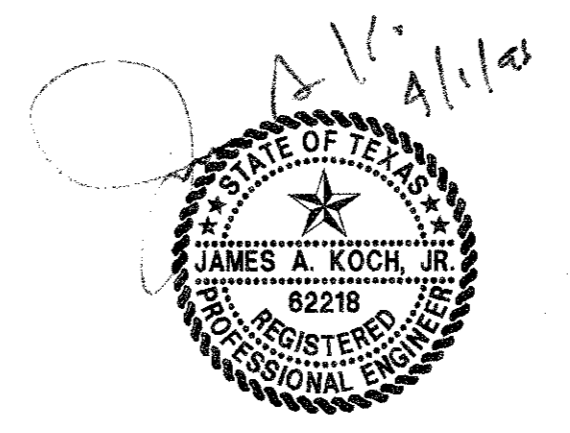

REVISED: MARCH 29, 1996
REVISED: JULY 13, 1995

PACHECO KOCH 9401 LBJ Freeway, Suite 300
Consulting Engineers, Inc. Dallas, Texas 75243
Civil Engineering • Land Surveying (214) 235-3031

UTILITY PLAN
SUMMERFIELD SUITES HOTEL
ARAPAHO ROAD
QUORUM CENTER ADDITION
TOWN OF ADDISON, TEXAS

DESIGN	DRAWN	DATE	SCALE	NOTES	FILE	NO.
JAK	BB	5/3/95	1"=30'			

PRINTS ISSUED

DATE	PURPOSE	NO.

FOR CONSTRUCTION

REVISIONS

DATE	ITEM	NO.

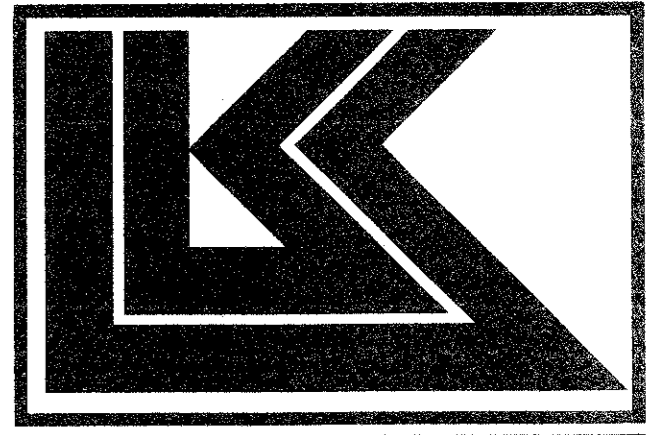

LAW/KINGDON, INC.
ARCHITECTS & ENGINEERS
345 RIVERVIEW, WICHITA, KS 67208
Phone: (316) 268-0239 Fax: (316) 268-0202
Copyright © 1994

DRAWN	CHECKED
BB	JAK

RELATED DRAWINGS

SHELL	SEQUENCE NUMBER
DETAILS	
STRUCTURE	
MECHANICAL	
ELECTRICAL	
OTHER	

OF _____ SHEETS

SUMMERFIELD SUITES HOTEL

ADDISON, TEXAS

PROJECT NUMBER 94780

UTILITY PLAN

SHEET TITLE

SHEET NUMBER

C-5

5 of 7 SHEETS