

CONSTRUCTION PLANS FOR ADDISON OFFICE / WAREHOUSE COMPLEX LOTS 1 & 2, BLOCK A WESTGROVE / BENT TREE PLAZA ADDITION

18.742 ACRES

WILLIAM LOMAX SURVEY, ABSTRACT No. 792,
TOWN OF ADDISON, DALLAS COUNTY, TEXAS

FOR

ROFDW ARCHITECTS, INC.
703 MCKINNEY AVE. STE. 401
DALLAS, TEXAS 75202
214-871-0616

OWNER

 FIRST INDUSTRIAL REALTY TRUST
13355 NOEL ROAD, STE. 1815
DALLAS, TEXAS 75240
972-386-4700

PREPARED BY

 Pacheco Koch Consulting Engineers
9401 LBJ FREEWAY SUITE 300 DALLAS, TEXAS 75243 972.235.3031

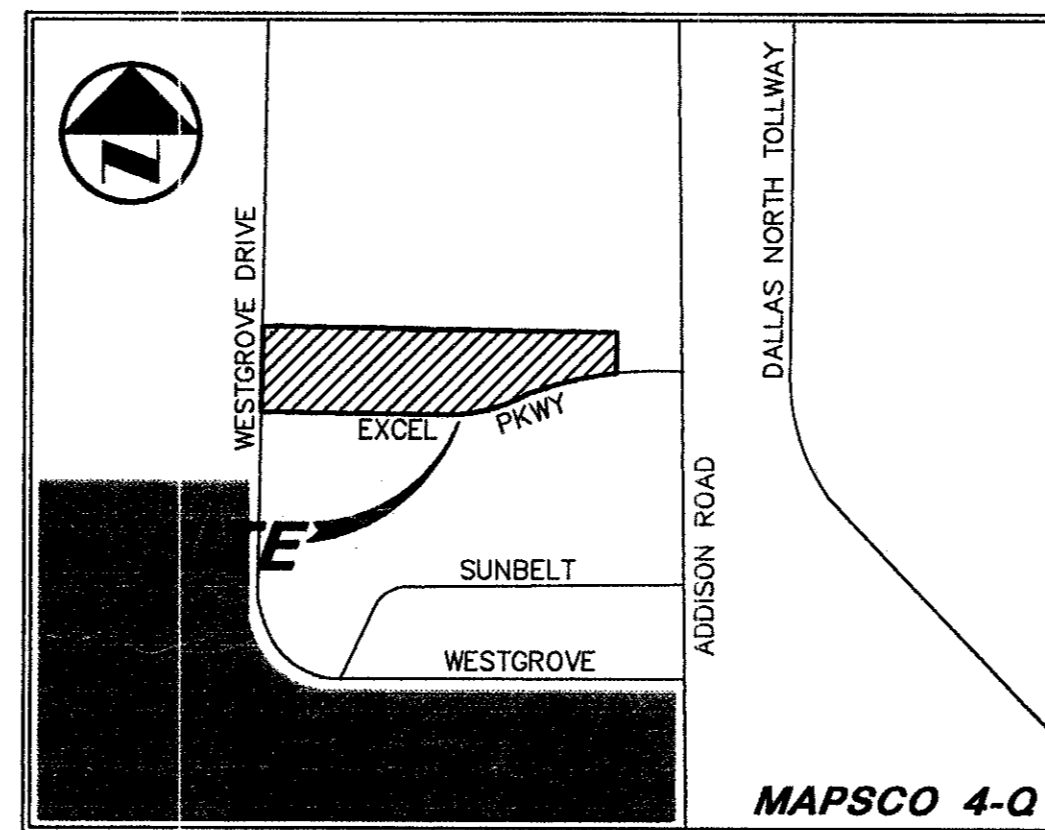

VICINITY MAP

RECORD DRAWING
THIS DRAWING HAS BEEN REVISED TO REFLECT CONSTRUCTION RECORDS MAINTAINED AND PROVIDED BY THE CONTRACTOR FOR THIS PROJECT.
CONTRACTOR: HILL & WILKINSON
DATE REVISED: 05/04/01

DRAWING SHEET INDEX

SHEET	DESCRIPTION
C1.1	FINAL PLAT (SHEET 1)
C2.1	DIMENSIONAL CONTROL PLAN (SHEET 1)
C2.2	DIMENSIONAL CONTROL PLAN (SHEET 2)
C3.1	GRADING PLAN (SHEET 1)
C3.2	GRADING PLAN (SHEET 2)
C4.1	DRAINAGE AREA MAP
C4.2	DRAINAGE PLAN (SHEET 1)
C4.3	DRAINAGE PLAN (SHEET 2)
C4.4	STORM SEWER PROFILES (SHEET 1)
C4.5	STORM SEWER PROFILES (SHEET 2)
C5.1	WATER & SANITARY SEWER PLAN (SHEET 1)
C5.2	WATER & SANITARY SEWER PLAN (SHEET 2)
C6.1	PAVING PLAN
C7.1	EROSION CONTROL PLAN



Steven A. Markussen
7/26/00

THE SEAL APPEARING ON THIS DOCUMENT WAS AUTHORIZED BY STEVEN A. MARKUSSEN, P.E. 70090 ON 07/26/00. ALTERATION OF A SEALED DOCUMENT WITHOUT PROPER NOTIFICATION TO THE RESPONSIBLE ENGINEER IS AN OFFENSE UNDER THE TEXAS ENGINEERING PRACTICE ACT.

△ REVISED 05/04/01

B18-14

4201 Excel Pkwy Addison Texas Center As-Built/Record Set 5/4/01