

BENT TREE GARDENS
PHASE 2
(VOL. 79193, PG. 2282)
BTP APARTMENTS I LLC
(INST. NO. 201600202167)

GRAYMARK ADDITION
(VOL. 83076, PG. 1978)
ABERFELDY PROPERTIES
(INST. NO. 201500011915)

EX 4
0.19
1.59

PART OF LOTS 5 AND 19
CARROLL ESTATES
(VOL. 10, PG. 473)

EX 2
0.29
2.42

THE ATRIUM, A REPLAT
OF PART OF LOT 19,
CARROLL ESTATES
(VOL. 82006, PG. 361)
JP BENT TREE LIMITED
PARTNERSHIP
(INST. NO. 201100064451)

STREITFELD FAMILY
LIMITED PARTNERSHIP
(INST. NO. 20070310677)

LOT 2, BLOCK A
WESTGROVE/BENT TREE
PLAZA ADDITION
(VOL. 2002096, PG. 25)

AKF3 ADDISON TECH LLC
(INST. NO. 201700312681)

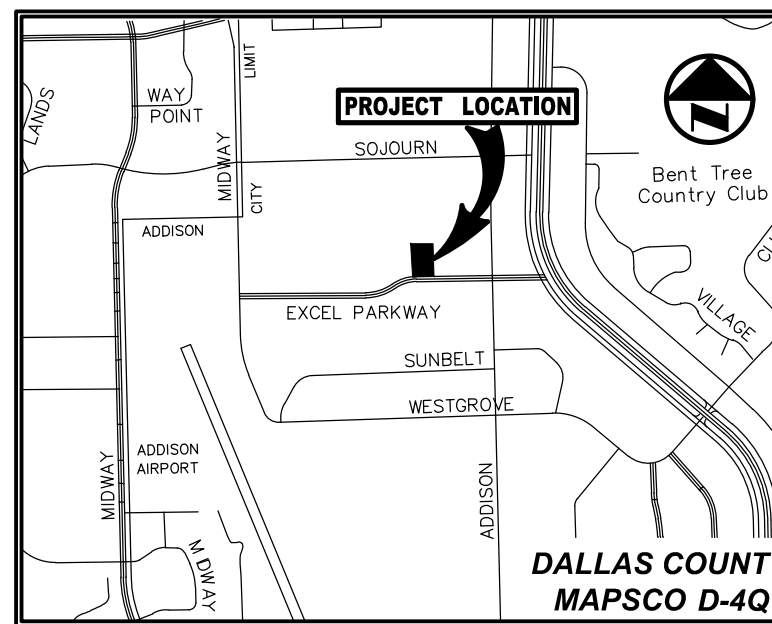

VICINITY MAP
(NOT TO SCALE)

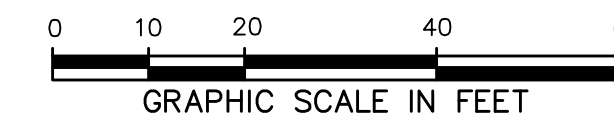
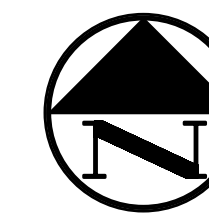

LEGEND

- B_o BOLLARD
- EM_o ELECTRIC METER
- PP_o POWER POLE
- LS_o LIGHT STANDARD
- WM_o WATER METER
- WV_o WATER VALVE
- ICV_o IRRIGATION CONTROL VALVE
- FHC_o FIRE HYDRANT CLEANOUT
- MH_o MANHOLE
- TSC_o TRAFFIC SIGNAL CONTROL
- TSP_o TRAFFIC SIGNAL POLE
- TELE_o TELEPHONE BOX
- FL_o FLOOD LIGHT
- FP_o FLAG POLE
- SIGN_o TRAFFIC SIGN
- x — PROPERTY LINE
- 613 — FENCE
- 613 — EXISTING CONTOUR
- DRAINAGE FLOW DIRECTION
- — — DRAINAGE DIVIDE
- EX 8
1.00
7.99 EXISTING DRAINAGE AREA ID
AREA IN ACRES
Q₁₀₀ IN CUBIC FEET PER SECOND

DRAINAGE AREA TABLE						
DRAINAGE AREA ID	AREA (acres)	C	T _c (min)	I ₁₀₀ (in/hr)	Q ₁₀₀ (cfs)	COMMENTS
EX 1	0.69	0.90	10	9.27	5.76	SURFACE DRAINS TO EX. WYE INLET
EX 2	0.29	0.90	10	9.27	2.42	SURFACE DRAINS OFFSITE TO THE WEST.
* EX 3	3.38	0.90	10	9.27	28.20	SURFACE DRAINS ONSITE TO THE WEST.
* EX 4	0.19	0.90	10	9.27	1.59	SURFACE DRAINS ONSITE TO THE SOUTH.

*OFFSITE DRAINAGE AREAS FROM "AS BUILT" DRAINAGE AREA MAP, SHEET 6 OF 11, DATED 12-15-1983

NO.	DATE	REVISION
1	11/10/2020	RECORD DRAWINGS

Pacheco Koch
7557 RAMBLER ROAD SUITE 1400
DALLAS, TX 75231 972.235.3031
TX REG. ENGINEERING FIRM F-469
TX REG. SURVEYING FIRM LS-10008000

EXISTING DRAINAGE AREA MAP
OFFICE BUILDING
4595 EXCEL PARKWAY
0.978 ACRE TRACT
TOWN OF ADDISON, DALLAS COUNTY, TEXAS

DESIGN	DRAWN	DATE	SCALE	NOTES	FILE	NO.
CRR	CBA	FEB 2020	1"=20'			C3.1

RECORD DRAWING

THE SIGNED AND SEALED CONSTRUCTION DOCUMENT HAS BEEN REVISED TO REFLECT CONSTRUCTION RECORDS MAINTAINED AND PROVIDED BY THE CONTRACTOR FOR THIS PROJECT. THE INFORMATION SHOWN ON THIS RECORD DRAWING, WHICH WAS PROVIDED BY THE CONTRACTOR, OR OTHERS NOT ASSOCIATED WITH THE DESIGN ENGINEER, CANNOT BE VERIFIED FOR ACCURACY OR COMPLETENESS. PACHECO KOCH SHALL ASSUME NO LIABILITY FOR ANY CHANGES MADE DURING CONSTRUCTION THAT WERE NOT SPECIFICALLY APPROVED BY THE ENGINEER PRIOR TO CONSTRUCTION. THE SEALED CONSTRUCTION DRAWINGS ARE ON FILE AT THE OFFICES OF PACHECO KOCH.

ATTESTED BY:
SIGNATURE: *Cody Risinger*
ENGINEER OF RECORD: CODY R. RISINGER, PE # 123160
CONTRACTOR: STRATEGIC CONSTRUCTION
DATE REVISED: 11/10/2020

EXCEL PARKWAY
(A VARIABLE WIDTH RIGHT-OF-WAY)