

- 3B-F
- 4B-F
- 4B-1
- 4C-F
- 5B-C
- 5C-C
- 6A-
- 6B-C
- 6C-C
- 7B-C
- 7C-C
- 8B-C
- 8C-C
- 9B-C
- 9C-C
- 10B-C
- 10C-C
- 11A-C
- 11B-C
- 11C-C
- 17B-C
- 17A-C
- 17B-C
- 17C-C
- 17D-C
- 17E-KALVE
- 17C-F
- 18C-F
- 18D-F
- 19E-F
- 20B-C
- 20C-C
- 21A-F
- 21B-F
- 21C-F
- 22B-C
- 22C-C
- 23B-C
- 23C-C
- 24B-C
- 24C-C

- EAST
- 1B-F
- 2B-F
- 2C-F
- 3B-F
- 3C-F
- 5C-SPALL
- 5B-SPALL

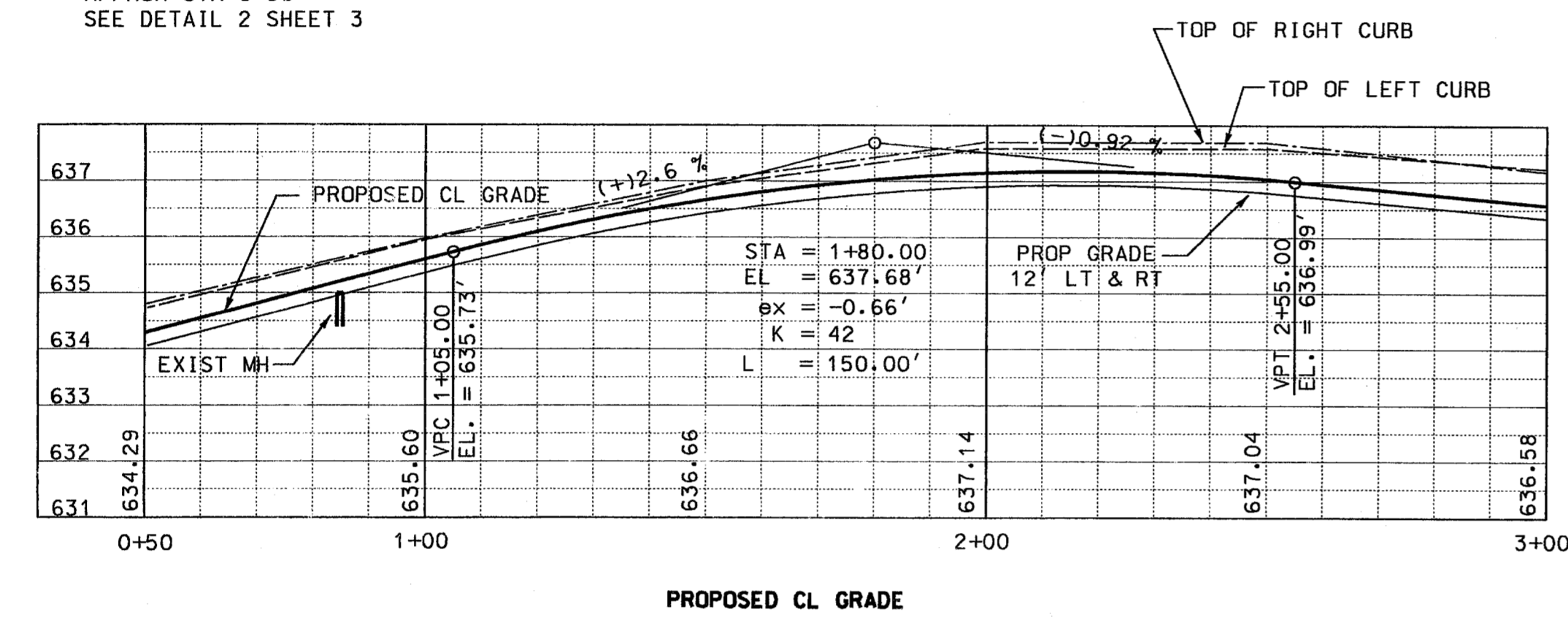

NOTE:
 ALL PROPOSED SAW CUTS ARE APPROXIMATE LOCATIONS. CONTRACTOR SHALL ONLY SAW CUT IN AN EXISTING CONSTRUCTION JOINT OR SAWED JOINT. CONTRACTOR SHALL LOCATE NEAREST JOINT OUTSIDE OF THE HATCHED AREAS SHOWN FOR LIMITS OF CONCRETE PAVEMENT REMOVAL.

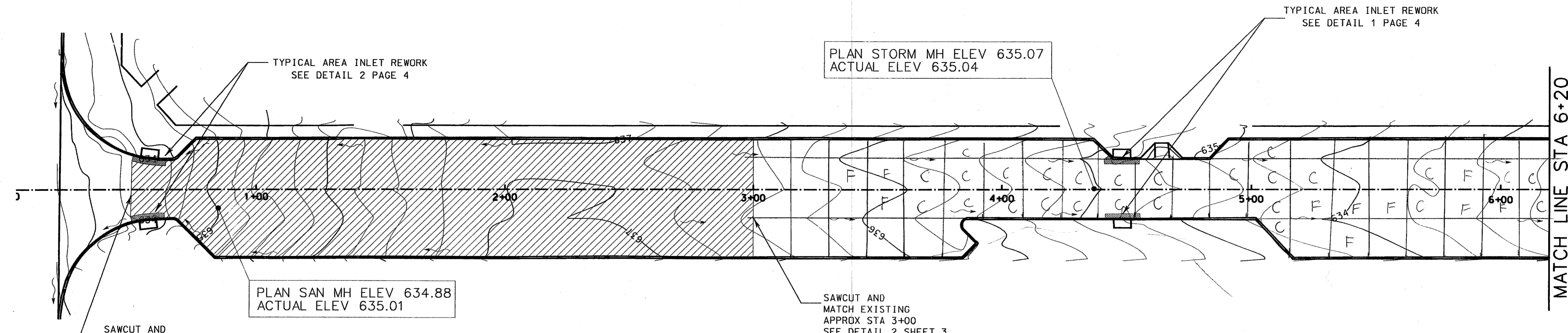
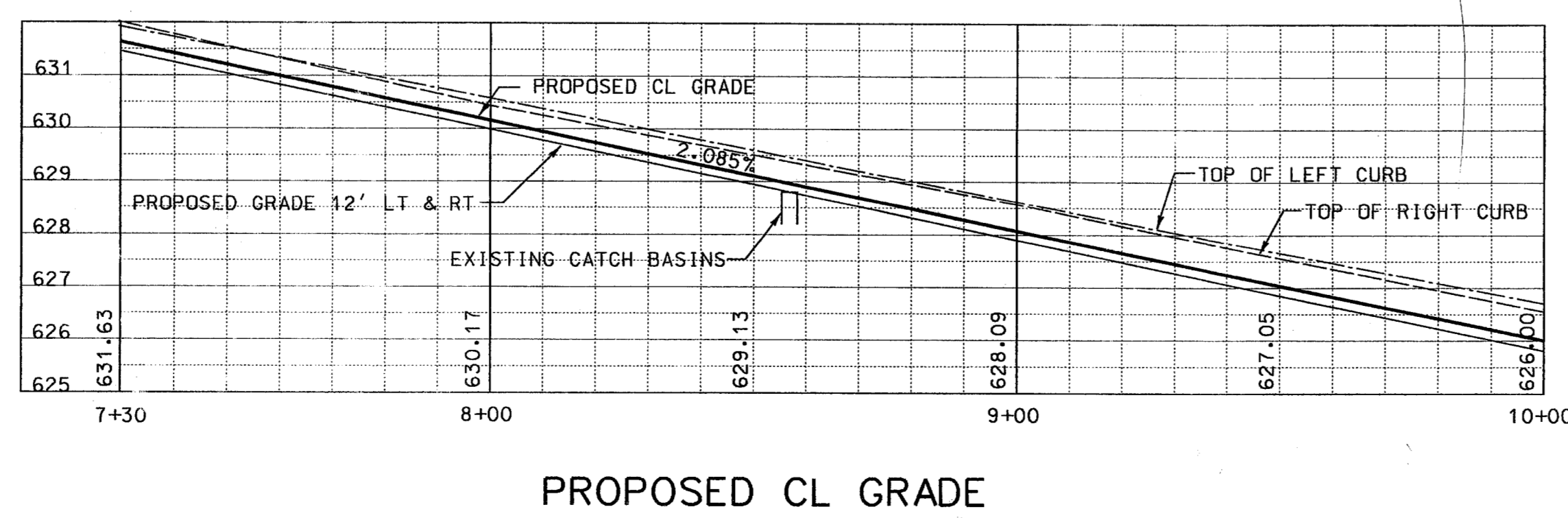
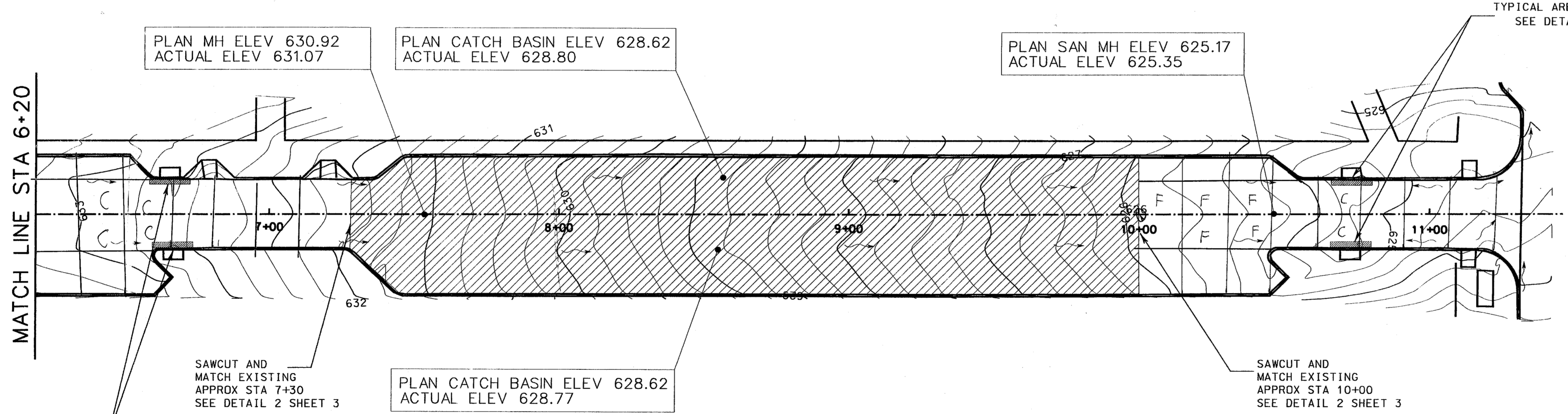

NOTE:
 THE DRAINAGE PATTERNS AND WATERSHED AREAS WERE NOT CHANGED. NO CHANGE IN THE APPROVED HYDRAULIC COMPUTATIONS.

NOTE:
 SEE ORIGINAL APPROVED CONSTRUCTION DOCUMENTS FOR BENCHMARK INFORMATION.

CONCRETE TO BE REPLACED

DATE	BY	REV	REVISION

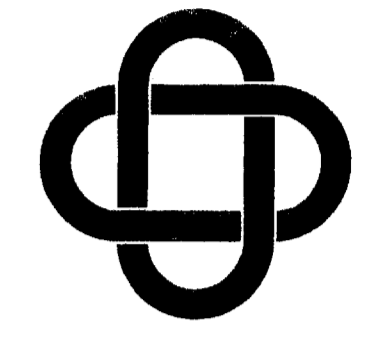

ERIC L. DAVIS ENGINEERING, INC.
 425 Suite G Pinson Road
 Forney, Texas 75126
 972/564-0592 Fax 972/564-6523
 E-Mail ericdavis@eldengineering.com

**FESTIVALWAY ROAD
 ELEVATIONS & CONTOURS**
 CITY OF ADDISON
 DALLAS COUNTY, TEXAS

DEVELOPER:	JOB NO.:
DRAWN BY:	CHECKED BY:
DATE:	DATE:

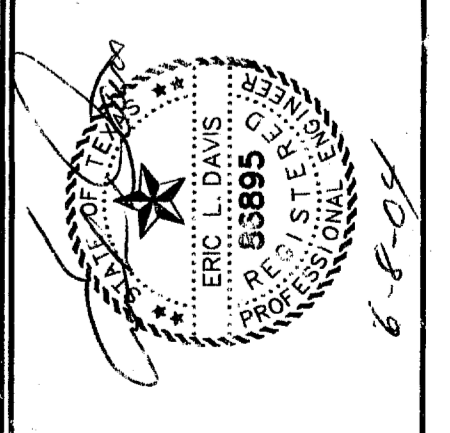

SCALE: 1" = 25'
 SHEET 02 OF 04
 SHEET 2