

01 SITE PLAN - MEP
 SCALE: 1" = 20'
2

SBS PROJECT FOR
TRANSCONTINENTAL REALTY, INC.
AIRCRAFT HANGER
 16921 ADDISON ROAD,
 ADDISON, TEXAS

H L M ARCHITECTS, INC.
 HENSLEY LAWKIN MARTINEZ RACHEL
 7557 RAMBLER ROAD
 DALLAS, TEXAS
 PH 214 369-2150
 SUITE 706
 75231
 FAX 214 369-2166

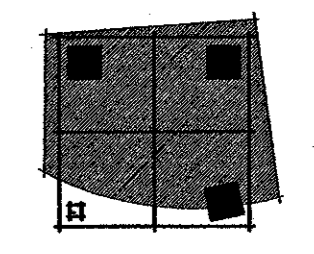

© 2000 H L M ARCHITECTS, INC. DOCUMENTS AS INSTRUMENTS OF SERVICE ARE GIVEN IN CONFIDENCE AND REMAIN THE PROPERTY OF H L M ARCHITECTS, INC. THIS DOCUMENT AND THE INFORMATION CONTAINED HEREIN MAY NOT BE DUPLICATED, USED OR DISCLOSED WITHOUT WRITTEN CONSENT OF H L M ARCHITECTS, INC.

ISSUED: 06-02-2000

DRAWN BY: JRM

REVISIONS	DATE
1 GENERAL REVISIONS	10/02/00
2 SITE COORDINATION	02/02/01

00032

SKIPPER + ROBINSON
 CONSULTING ENGINEERS INC.
 2301 W. NORTHWEST HWY, SUITE 2215
 DALLAS, TEXAS 75220
 TEL. (214) 902-1900
 FAX. (214) 902-8588
SRC Job # 1 2501 DESIGN FS CC FS

P1.1