

Typical Cul-de-sac Detail

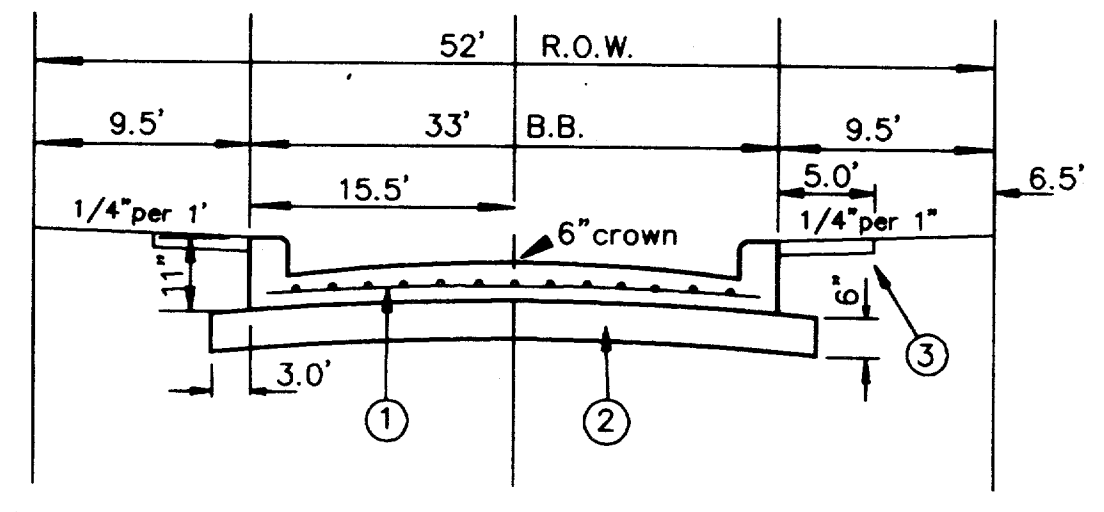
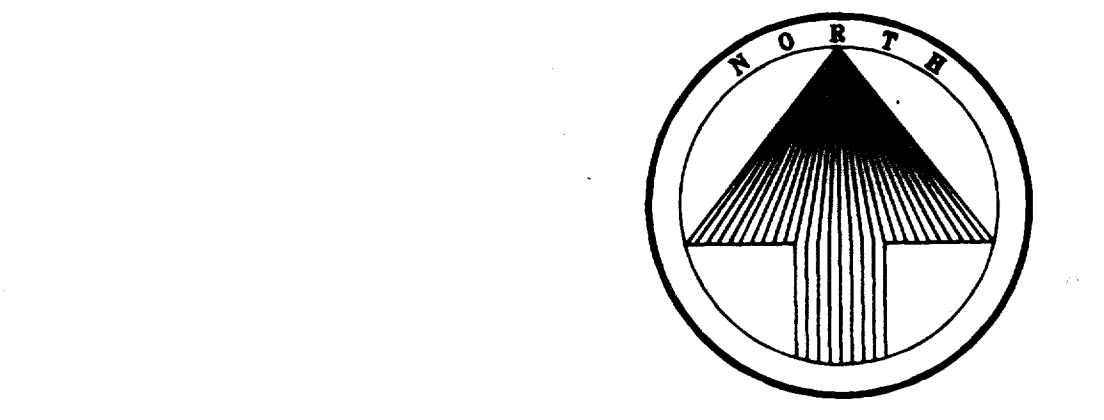

Typical Paving Section

- ① 6" Thk. - 3000 P.S.I. Conc. Reinf. w/No.3 Bars On 18" Centers (Both Ways).
- ② 6" Lime Stabilization required where PI >15. Optimum Lime content based on a Lime/PH. PH should be approximately 12. Test shall be conducted by a qualified Geotechnical firm, to be provided by the Developer. Test results shall be provided to the City. Separate test are required when subgrade conditions change.
- ③ 5' Sidewalk to be built by Homebuilder, Adjacent to the back of curb.

- Construction Notes**
1. All fill compaction shall have 95% density w/0% to +3.0% optimum moisture.
  2. Construct transverse sawed dummy joints every 15' max.
  3. (\*) Construct Barrier Free Ramp at all intersections as per Town standards.
  4. All spoils to be removed from the project & the Town of Addison.

**CAUTION !!!**  
EXISTING UTILITIES

EXISTING UTILITIES AND UNDERGROUND FACILITIES INDICATED ON THESE PLANS HAVE BEEN LOCATED FROM REFERENCE INFORMATION. IT SHALL BE THE RESPONSIBILITY OF THE CONTRACTOR TO VERIFY BOTH HORIZONTALLY AND VERTICALLY THE LOCATION OF ALL EXISTING UTILITIES AND UNDERGROUND FACILITIES PRIOR TO CONSTRUCTION. TO TAKE NECESSARY PRECAUTIONS IN ORDER TO PROTECT ALL FACILITIES ENCOUNTERED. THE CONTRACTOR SHALL PRESERVE AND PROTECT ALL EXISTING UTILITIES FROM DAMAGE DURING CONSTRUCTION.

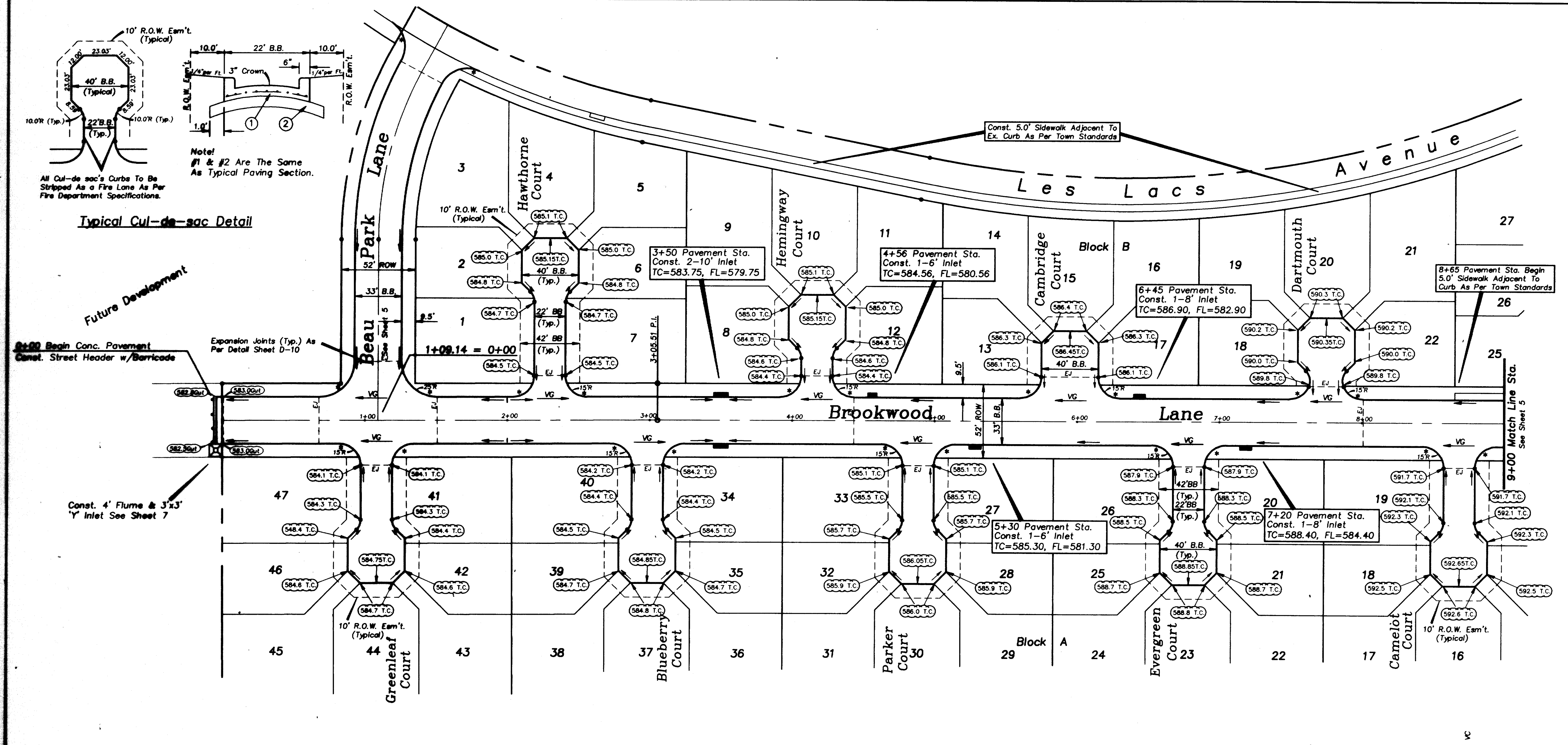

585	0+00	0+100	0+200	0+300	0+400	0+500	0+600	0+700	0+800	0+900	9+00
590											
595											
600											
605											
610											
615											
620											
625											
630											
635											
640											
645											
650											
655											
660											
665											
670											
675											
680											
685											
690											
695											
700											
705											
710											
715											
720											
725											
730											
735											
740											
745											
750											
755											
760											
765											
770											
775											
780											
785											
790											
795											
800											
805											
810											
815											
820											
825											
830											
835											
840											
845											
850											
855											
860											
865											
870											
875											
880											
885											
890											
895											
900											
905											
910											
915											
920											
925											
930											
935											
940											
945											
950											
955											
960											
965											
970											
975											
980											
985											
990											
995											

Bench Mark 1  
"X" in C.L. of Les Lacs Avenue @ 325'± South of Proton Drive. Elev.=601.80  
Bench Mark 2  
"E" in top of curb North side of Les Lacs Ave. @ curb return Northwest corner of Meadow Creek Cir. Elev.=587.30

As-Built Plans  
5-28-93

**PAVING PLAN**  
**GRAND ADDISON II**  
Town Of Addison, Texas

**TIPTON ENGINEERING, INC.**  
6330, Belt Line Rd. ~ Suite C ~ Garland, Texas 75043

DESIGN	DRAWN	DATE	SCALE	NOTES	FILE	NO.
T.E. Inc.	T.E. Inc.	10/92	1"=40'H 1"=6'V		3726	4

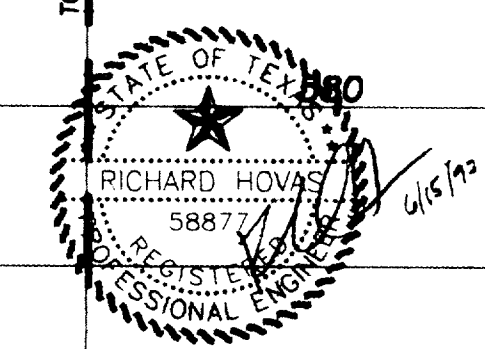

The seal appearing on this document was authorized by Richard Hovav, P.E. 5887