

Typical Cul-de-sac Detail

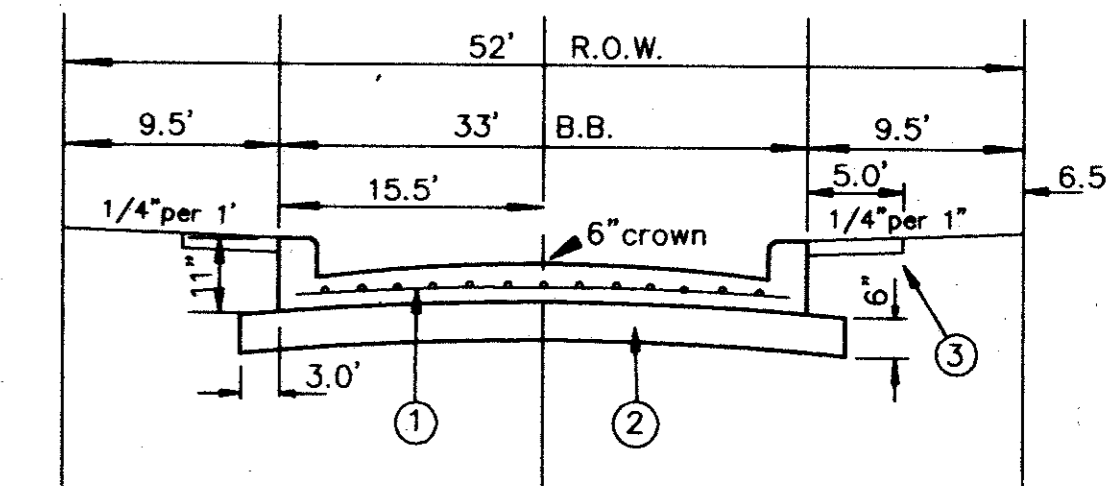

Typical Paving Section

- ① 6" Thk.-3000 P.S.I. Conc. Reinf. w/No.3 Bars On 18" Centers (Both Ways).
- ② 6" Lime Stabilization required where PI >15. Optimum Lime content based on a Lime/PH. PH should be approximately 12. Test shall be conducted by a qualified Geotechnical firm, to be provided by the Developer. Test results shall be provided to the City. Separate test are required when subgrade conditions change.
- ③ 5' Sidewalk to be built by Homebuilder, Adjacent to the back of curb.

- Construction Notes**
1. All fill compaction shall have 95% density w/0% to +3.0% optimum moisture.
 2. Construct transverse sowed dummy joints every 15' max.
 3. (*) Construct Barrier Free Ramp at all intersections as per Town standards.
 4. All spoils to be removed from the project & the Town Of Addison.

CAUTION !!!
EXISTING UTILITIES

EXISTING UTILITIES AND UNDERGROUND FACILITIES INDICATED ON THESE PLANS HAVE BEEN LOCATED FROM REFERENCE INFORMATION. IT SHALL BE THE RESPONSIBILITY OF THE CONTRACTOR TO VERIFY BOTH HORIZONTALLY AND VERTICALLY THE LOCATION OF ALL EXISTING UTILITIES AND UNDERGROUND FACILITIES PRIOR TO CONSTRUCTION, TO TAKE NECESSARY PRECAUTIONS IN ORDER TO PROTECT ALL FACILITIES ENCOUNTERED. THE CONTRACTOR SHALL PRESERVE AND PROTECT ALL EXISTING UTILITIES FROM DAMAGE DURING CONSTRUCTION.

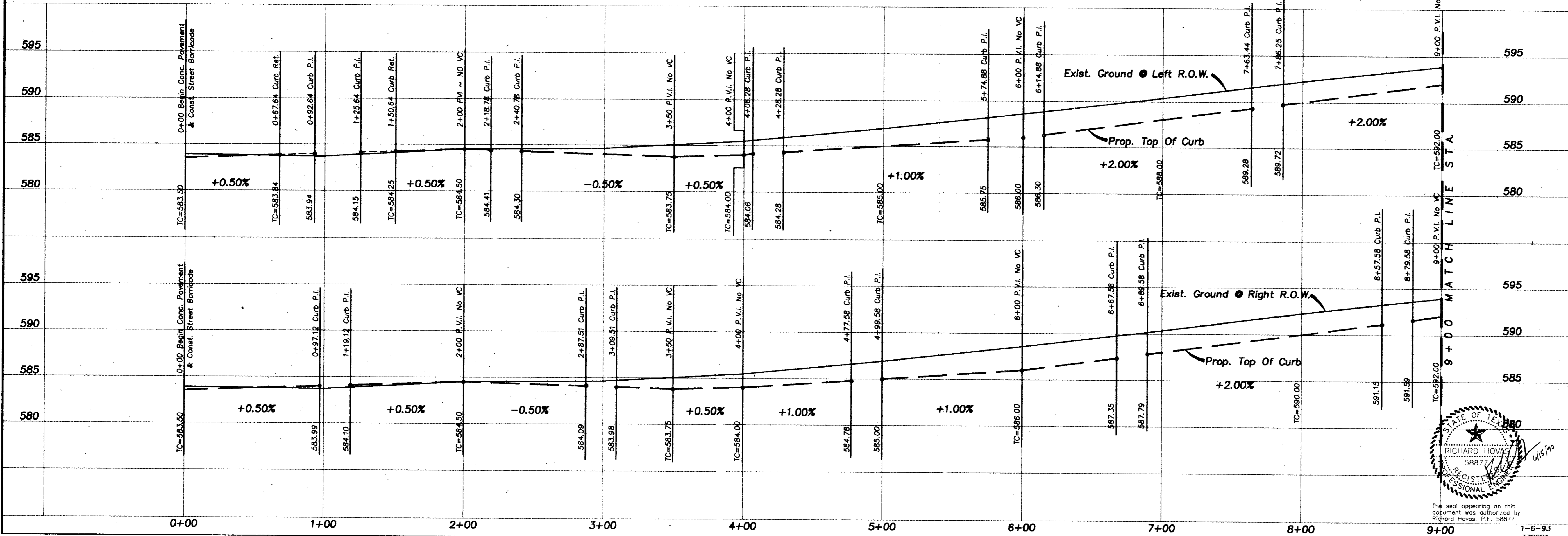
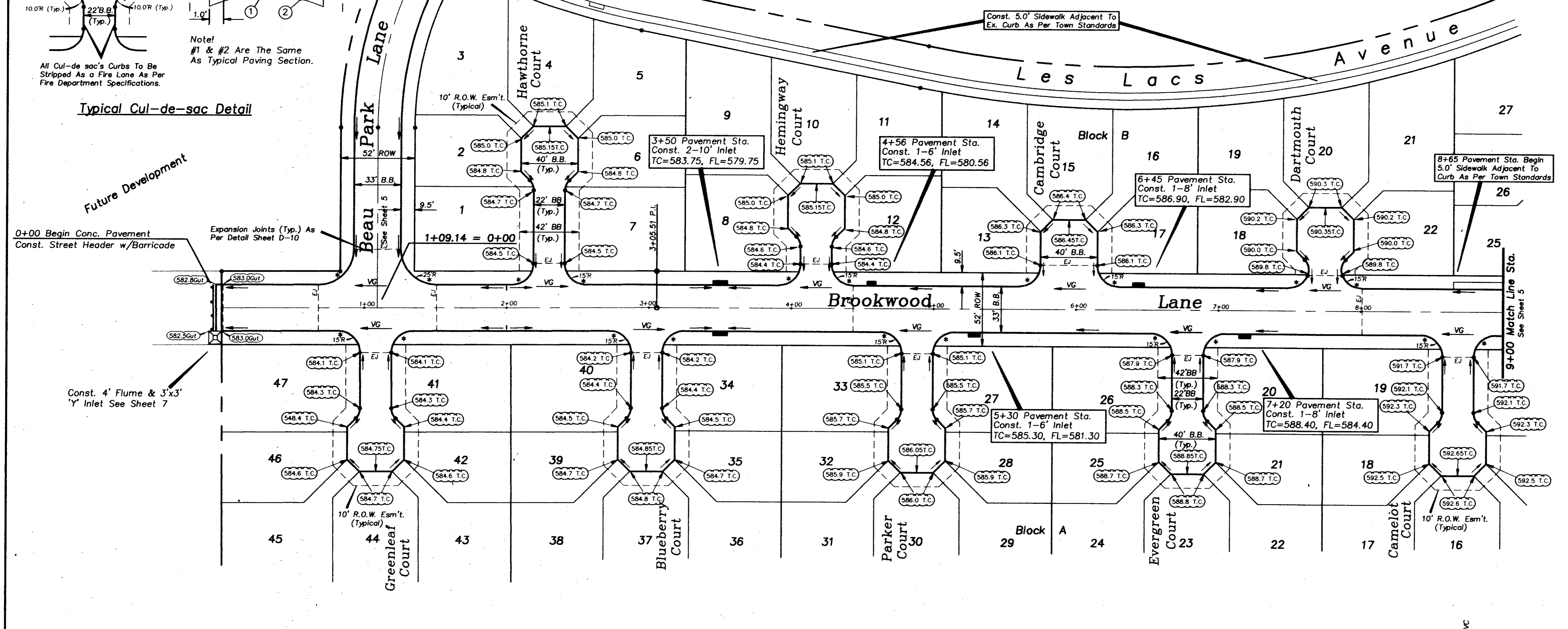

Bench Mark 1
"X" in C.L. of Les Lacs Avenue @ 325'± South of Proton Drive.
Elev.=601.80
Bench Mark 2
"B" in top of curb North side of Les Lacs Ave.
@ curb return Northwest corner of Meadow Creek Cir.
Elev.=587.30

As-Built Plans
5-28-93

PAVING PLAN
GRAND ADDISON II
Town Of Addison, Texas

TIPTON ENGINEERING, INC. 6330, Belt Line Rd. ~ Suite C ~ Garland, Texas 75043					
DESIGN	DRAWN	DATE	SCALE	NOTES	FILE
T.E. Inc.	T.E. Inc.	10/92	1"=40'H 1"=6'V		3726
					ND.
					4