

- LEGEND**
- CV = CHECK VALVE
 - DE = DRAINAGE EASEMENT
 - EA = EDGE ASPHALT
 - EC = EDGE CONCRETE
 - FH = FIRE HYDRANT
 - GM = GAS METER
 - LP = LIGHT POLE
 - OHE = OVERHEAD ELECTRIC
 - PP = POWER POLE
 - SH = SPRINKLER HEAD
 - SS = SANITARY SEWER
 - SSCO = SANITARY SEWER CLEANOUT
 - SV = SPRINKLER VALVE
 - TEL = TELEPHONE STRUCTURE
 - TMK = TELEPHONE STRUCTURE
 - TP = TOP OF PAVEMENT
 - UE = UTILITY EASEMENT
 - UG-E = UNDERGROUND ELECTRIC
 - UG-T = UNDERGROUND TELEPHONE
 - W = WATER
 - = PROPOSED WATER MAIN
 - ▣ = PAVEMENT REPLACEMENT WITH 8" 4000 PSI REIN. CONCRETE
 - ▤ = SIDEWALK REPLACEMENT WITH 6" 3000 PSI REIN. CONCRETE
 - ⊥ = EXISTING WATER VALVE

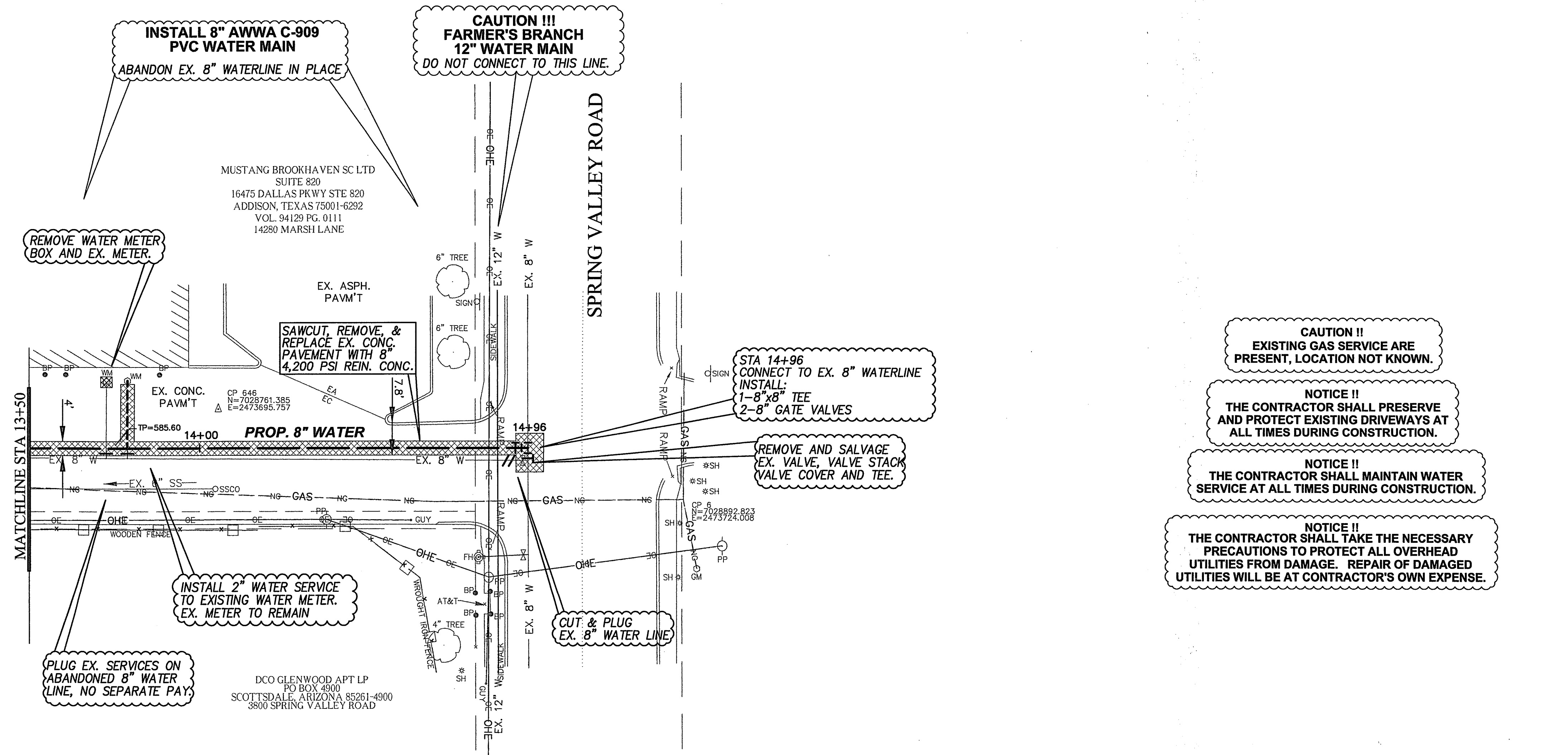

- BENCHMARKS:**
- CP 1 = "X" SET IN THE SOUTH SIDE OF A CONCRETE DRIVE 55 FEET EAST FROM THE CURB OF MARSH LANE, 39.4 FEET NORTH OF THE NORTH FACE OF THE BURGER HOUSE BUILDING AT 14248 MARSH LANE. ELEV.= 565.46
 - CP 3 = "X" SET IN THE SOUTH SIDE OF A CONCRETE DRIVE 404 FEET EAST FROM THE CURB OF MARSH LANE, 17 FEET EAST FROM A SANITARY SEWER MAN HOLE, 8 FEET NORTH OF AN INLET RIM. ELEV.=572.39
 - CP 4 = "X" SET IN THE CONCRETE PAVING AT THE SOUTHEAST CORNER OF 14280 MARSH LANE, 19.2 FEET SOUTHWEST FROM THE SOUTHWEST BUILDING CORNER, 17.7 FEET SOUTH FROM A WATER VAULT. ELEV.=576.44
 - CP 5 = "X" SET IN THE EAST SIDE OF A CONCRETE DRIVE 300 FEET SOUTH FROM THE SOUTH BACK OF CURB OF SPRING VALLEY DRIVE, 7.5 FEET WEST FROM THE EAST EDGE OF PAVING. ELEV.=581.81
 - CP 6 = "X" SET IN THE NORTH WALK OF SPRING VALLEY BOULEVARD NORTH OF ITS INTERSECTION WITH A CONCRETE DRIVE BETWEEN 3900 SPRING VALLEY ROAD AND 14280 MARSH LANE, 17.9 FEET SOUTHWEST FROM A POWER POLE, 3.2 FEET NORTH OF THE NORTH BACK OF CURB OF SPRING VALLEY ROAD. ELEV.=586.26

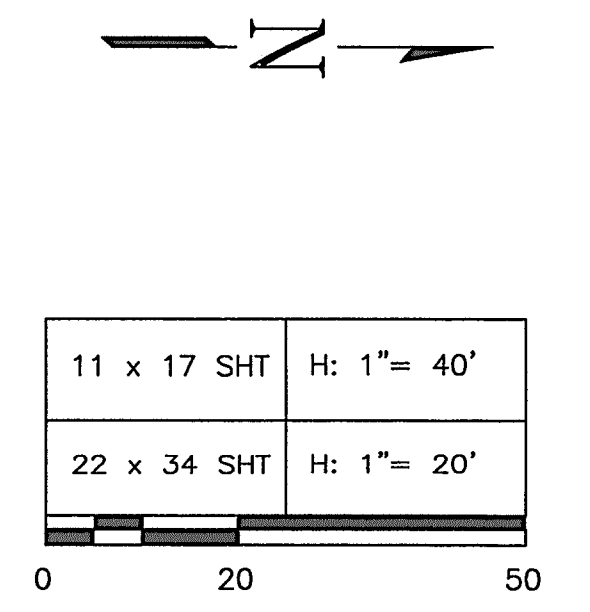
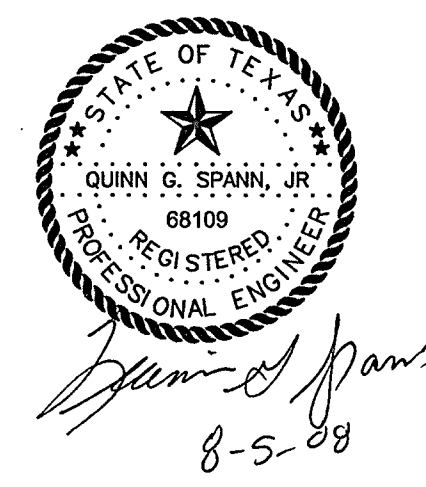

- CAUTION !!**
EXISTING GAS SERVICE ARE PRESENT, LOCATION NOT KNOWN.
- NOTICE !!**
THE CONTRACTOR SHALL PRESERVE AND PROTECT EXISTING DRIVEWAYS AT ALL TIMES DURING CONSTRUCTION.
- NOTICE !!**
THE CONTRACTOR SHALL MAINTAIN WATER SERVICE AT ALL TIMES DURING CONSTRUCTION.
- NOTICE !!**
THE CONTRACTOR SHALL TAKE THE NECESSARY PRECAUTIONS TO PROTECT ALL OVERHEAD UTILITIES FROM DAMAGE. REPAIR OF DAMAGED UTILITIES WILL BE AT CONTRACTOR'S OWN EXPENSE.

REVISION NO.	DESCRIPTION	BY	DATE
TOWN OF ADDISON, TEXAS PUBLIC WORKS DEPT. - ENGINEERING DIVISION			
GREENHAVEN WATERLINE RECONSTRUCTION			
WATER PLAN STA 9+50 TO STA 14+96			
GSWW, Inc. <small>DALLAS, TX • FORT WORTH, TX • AUSTIN, TX • HOUSTON, TX • SAN ANTONIO, TX • DALLAS, TX • FORT WORTH, TX • AUSTIN, TX • HOUSTON, TX • SAN ANTONIO, TX</small>			
DESIGN:	GSWW	SCALE:	AS NOTED
DRAWN:	GSWW	SHEET 5 OF 5	
APPROVED:	QGS		
DATE:	AUGUST 2008		