

- LEGEND**
- CV = CHECK VALVE
 - DE = DRAINAGE EASEMENT
 - EA = EDGE ASPHALT
 - EC = EDGE CONCRETE
 - FH = FIRE HYDRANT
 - GM = GAS METER
 - LP = LIGHT POLE
 - OHE = OVERHEAD ELECTRIC
 - PP = POWER POLE
 - SH = SPRINKLER HEAD
 - SS = SANITARY SEWER
 - SSCO = SANITARY SEWER CLEANOUT
 - SV = SPRINKLER VALVE
 - TEL = TELEPHONE STRUCTURE
 - TMK = TELEPHONE STRUCTURE
 - TP = TOP OF PAVEMENT
 - UE = UTILITY EASEMENT
 - UG-E = UNDERGROUND ELECTRIC
 - UG-T = UNDERGROUND TELEPHONE
 - W = WATER
 - = PROPOSED WATER MAIN
 - ▣ = PAVEMENT REPLACEMENT WITH 8" 4000 PSI REIN. CONCRETE
 - ▤ = SIDEWALK REPLACEMENT WITH 6" 3000 PSI REIN. CONCRETE
 - ⋈ = EXISTING WATER VALVE

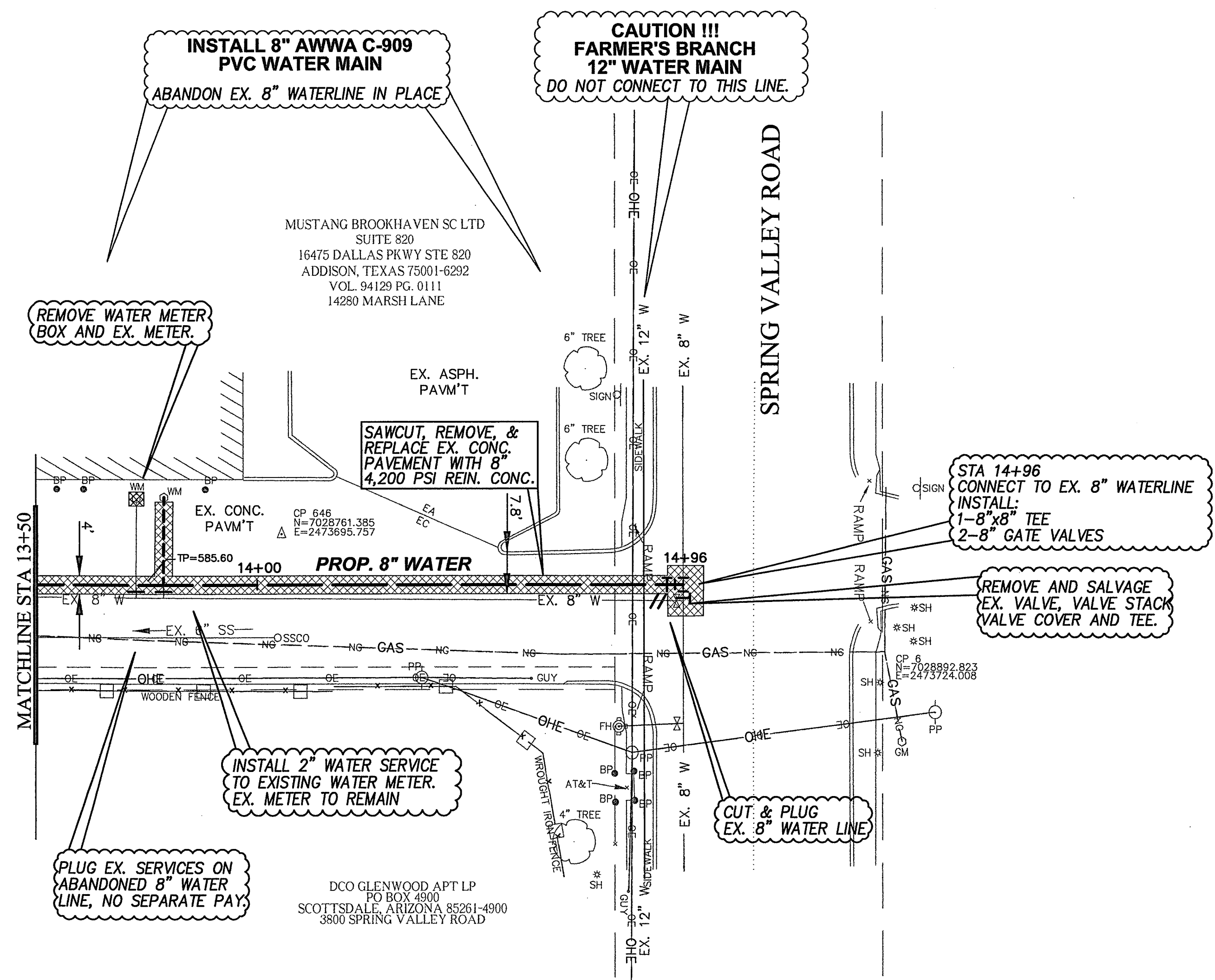

- CAUTION !!**
EXISTING GAS SERVICE ARE PRESENT. LOCATION NOT KNOWN.
- NOTICE !!**
THE CONTRACTOR SHALL PRESERVE AND PROTECT EXISTING DRIVEWAYS AT ALL TIMES DURING CONSTRUCTION.
- NOTICE !!**
THE CONTRACTOR SHALL MAINTAIN WATER SERVICE AT ALL TIMES DURING CONSTRUCTION.
- NOTICE !!**
THE CONTRACTOR SHALL TAKE THE NECESSARY PRECAUTIONS TO PROTECT ALL OVERHEAD UTILITIES FROM DAMAGE. REPAIR OF DAMAGED UTILITIES WILL BE AT CONTRACTOR'S OWN EXPENSE.

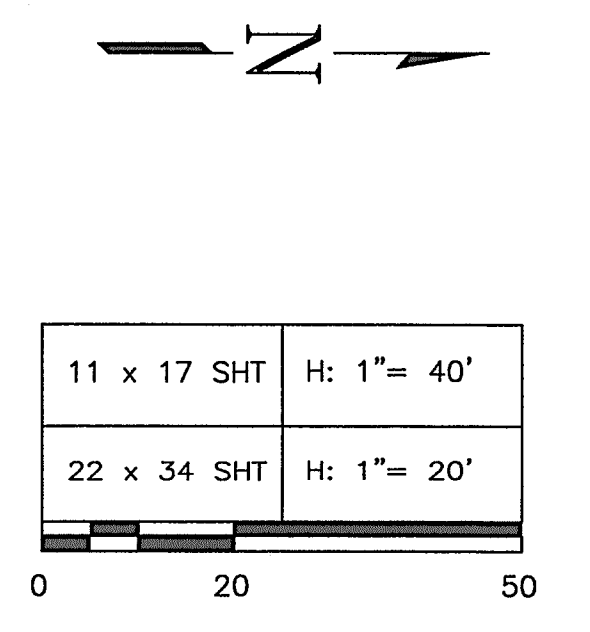
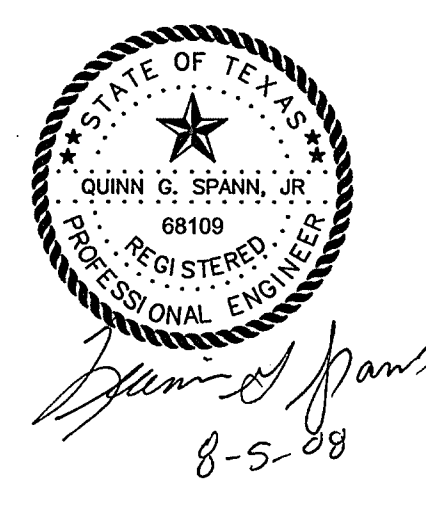

- BENCHMARKS:**
- CP 1 = "X" SET IN THE SOUTH SIDE OF A CONCRETE DRIVE 55 FEET EAST FROM THE CURB OF MARSH LANE, 39.4 FEET NORTH OF THE NORTH FACE OF THE BURGER HOUSE BUILDING AT 14248 MARSH LANE. ELEV.= 565.46
 - CP 3 = "X" SET IN THE SOUTH SIDE OF A CONCRETE DRIVE 404 FEET EAST FROM THE CURB OF MARSH LANE, 17 FEET EAST FROM A SANITARY SEWER MAN HOLE, 8 FEET NORTH OF AN INLET RIM. ELEV.=572.39
 - CP 4 = "X" SET IN THE CONCRETE PAVING AT THE SOUTHEAST CORNER OF 14280 MARSH LANE, 19.2 FEET SOUTHEAST FROM THE SOUTHEAST BUILDING CORNER, 17.7 FEET SOUTH FROM A WATER VAULT. ELEV.= 576.44
 - CP 5 = "X" SET IN THE EAST SIDE OF A CONCRETE DRIVE 300 FEET SOUTH FROM THE SOUTH BACK OF CURB OF SPRING VALLEY DRIVE, 7.5 FEET WEST FROM THE EAST EDGE OF PAVING. ELEV.=581.81
 - CP 6 = "X" SET IN THE NORTH WALK OF SPRING VALLEY BOULEVARD NORTH OF ITS INTERSECTION WITH A CONCRETE DRIVE BETWEEN 3900 SPRING VALLEY ROAD AND 14280 MARSH LANE, 17.9 FEET SOUTHWEST FROM A POWER POLE, 3.2 FEET NORTH OF THE NORTH BACK OF CURB OF SPRING VALLEY ROAD. ELEV.=586.26

REVISION NO.	DESCRIPTION	BY	DATE
TOWN OF ADDISON, TEXAS PUBLIC WORKS DEPT. - ENGINEERING DIVISION			
GREENHAVEN WATERLINE RECONSTRUCTION			
WATER PLAN STA 9+50 TO STA 14+96			
GSWW, Inc. <small>10000 WESTPORTER DRIVE DALLAS, TX 75241 • FORT WORTH, TX 76102 • AUSTIN, TX 78704 HOUSTON, TX 77060 • DALLAS, TX 75241 • HOUSTON, TX 77060</small>			
DESIGN:	GSWW	SCALE:	AS NOTED
DRAWN:	GSWW	SHEET 5 OF 5	
APPROVED:	QGS		
DATE:	AUGUST 2008		