

**HIGH FLOW SILT FENCE DETAIL:**

TYPICAL TEMPORARY FILTER  
FABRIC WITH WIRE FABRIC  
N.T.S.

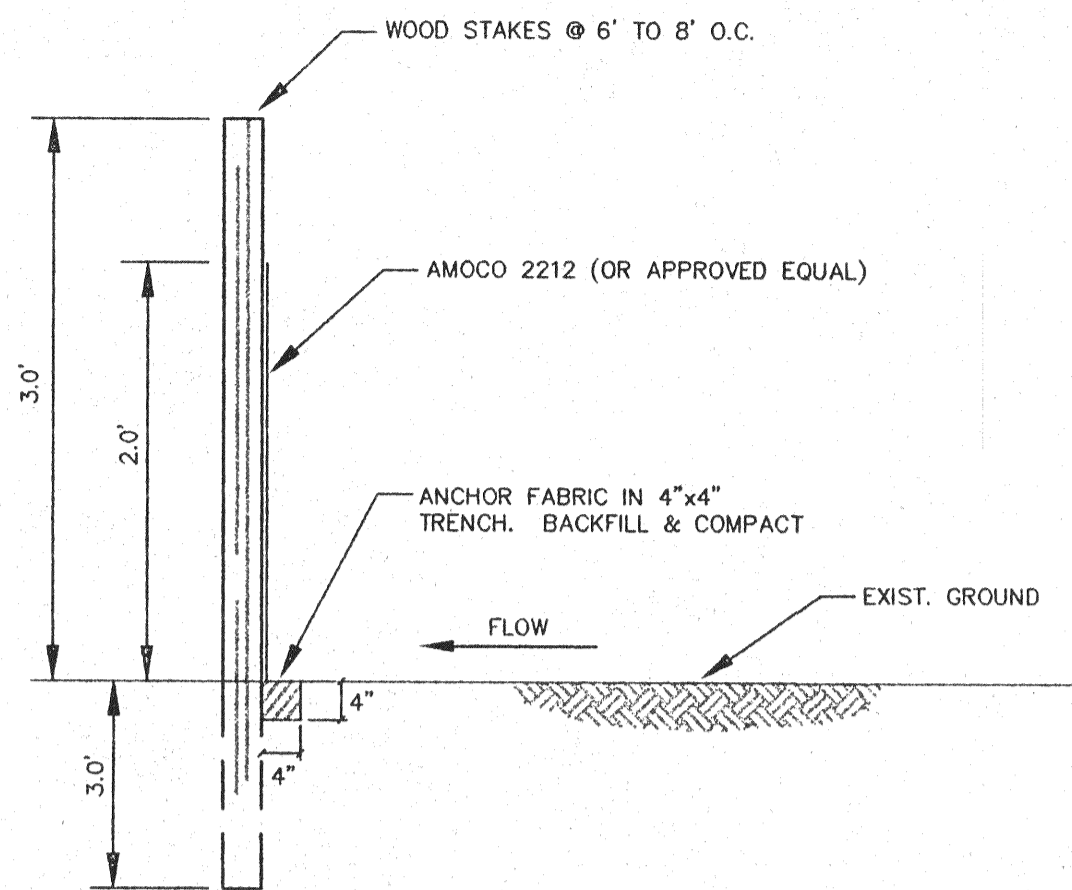

**LOW FLOW SILT FENCE DETAIL:**

TYPICAL TEMPORARY FILTER  
FABRIC WITHOUT WIRE FABRIC  
N.T.S.

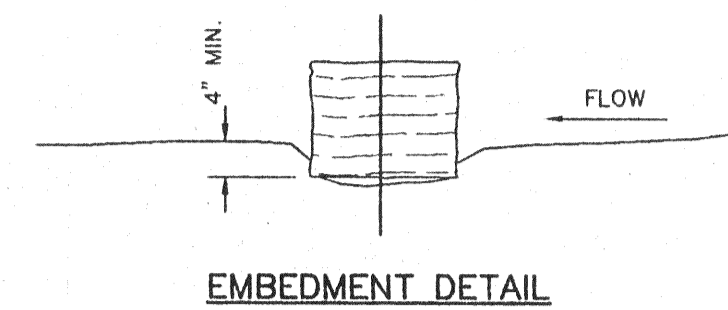

**EMBEDMENT DETAIL**

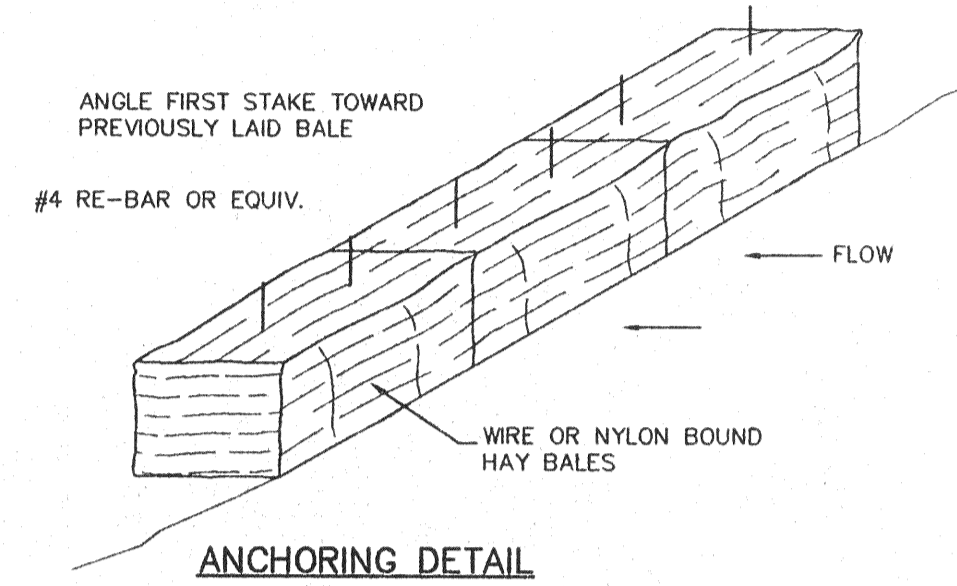

**ANCHORING DETAIL**

**EROSION CONTROL DETAIL:**

1. DURING THE CONSTRUCTION PERIOD, THE CONTRACTOR SHALL PROVIDE AND MAINTAIN HAY BALE CHECK DAMS PER THE DETAIL IN THE AREAS INDICATED ON THE GRADING PLAN AND ANY OTHER AREAS AS DIRECTED BY THE ENGINEER.
2. THE CONTRACTOR SHALL PROVIDE AND MAINTAIN HAY BALES AROUND ANY OPENINGS INTO THE STORM SEWER SYSTEM UNTIL THE PROJECT IS COMPLETED.

**11 EROSION CONTROL DETAIL**  
NOT TO SCALE

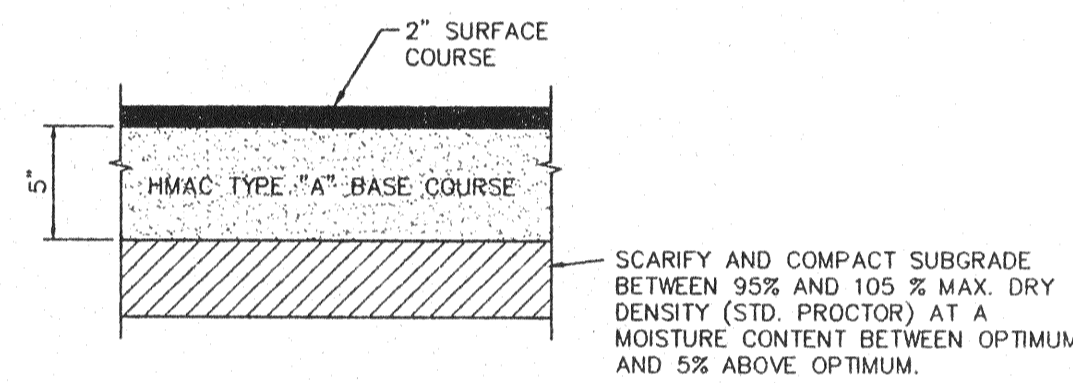

**25 ASPHALT PAVEMENT SECTION**  
NOT TO SCALE

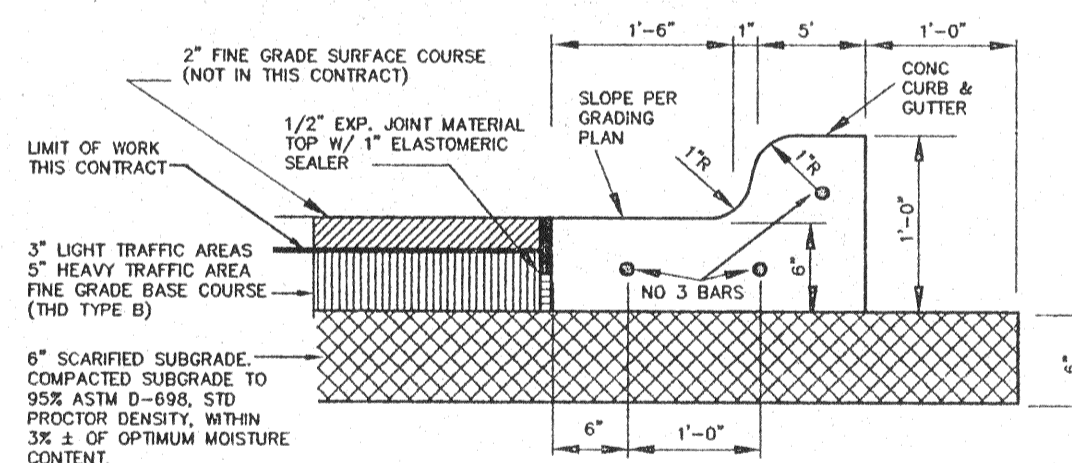

**SEPARATE CURB AND ASPHALT PAVING**  
NO SCALE

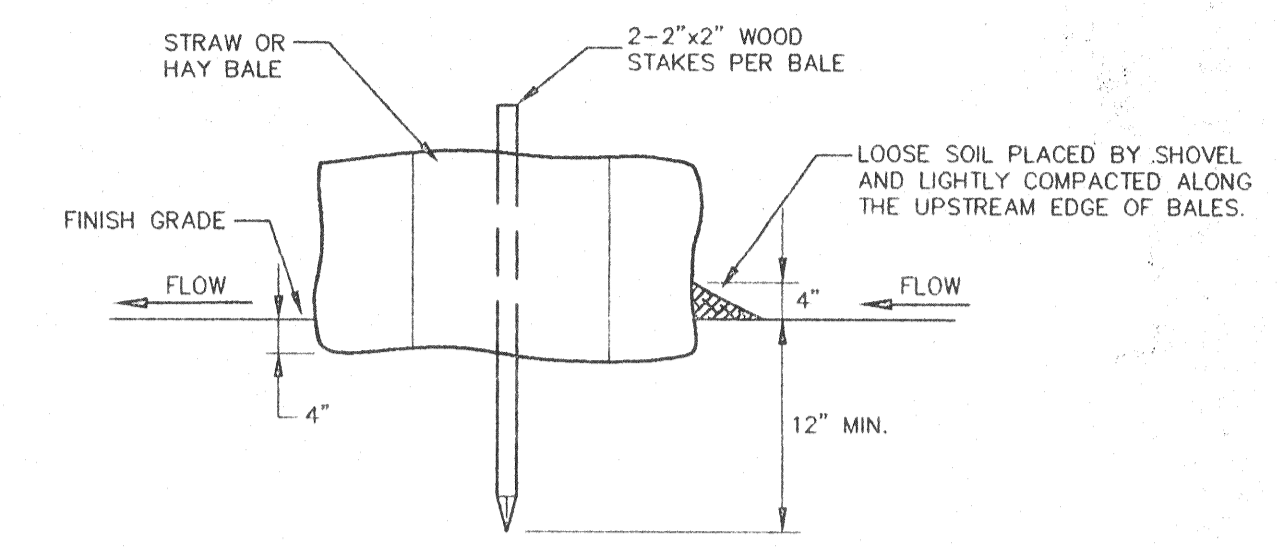
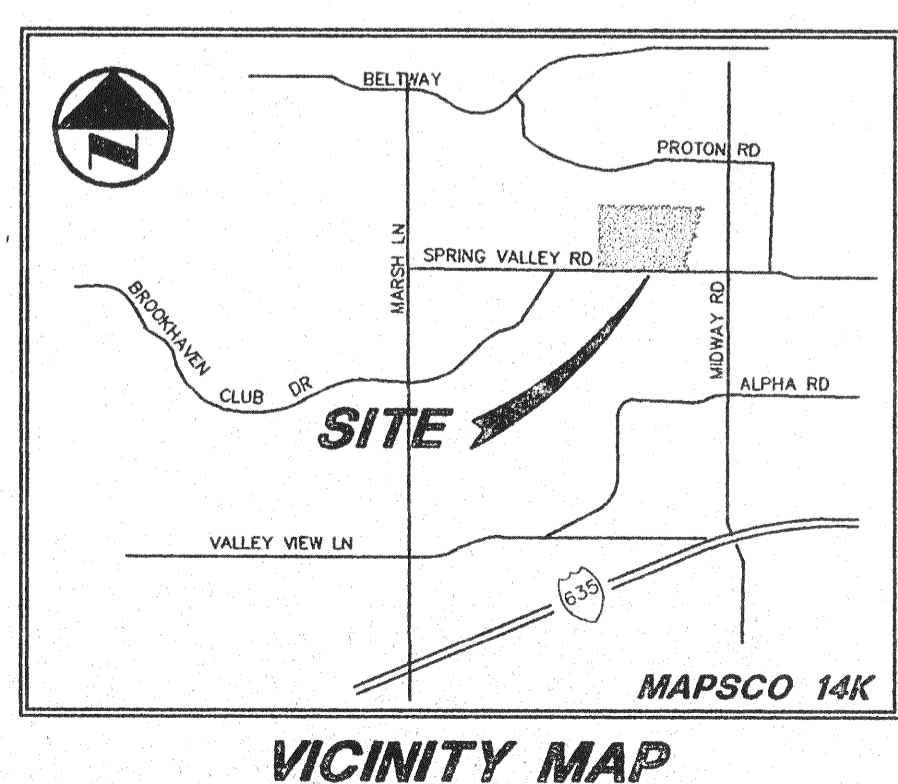

**TYPICAL ENTRENCHED BALE PLACEMENT**  
N.T.S.

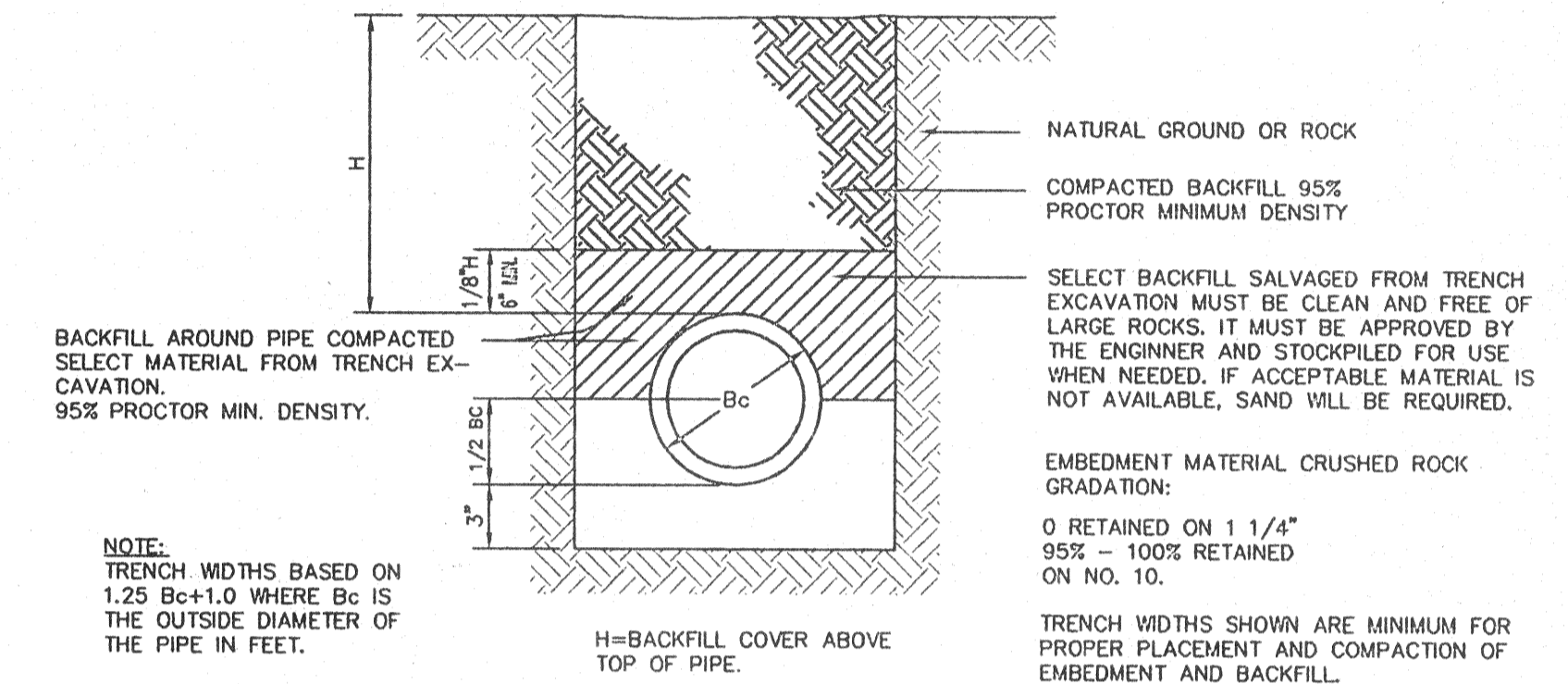

NOTE: TRENCH WIDTHS BASED ON 1.25 Bc+1.0 WHERE Bc IS THE OUTSIDE DIAMETER OF THE PIPE IN FEET. H=BACKFILL COVER ABOVE TOP OF PIPE.

**REINFORCED CONCRETE CLASS III PIPE INSTALLATION (EMBEDMENT DETAIL)**

- DRAINAGE GENERAL NOTES**
1. ALL WORK, UNLESS OTHERWISE NOTED, SHALL CONFORM TO THE STANDARD SPECIFICATIONS FOR PUBLIC WORKS CONSTRUCTION, ISSUED BY THE NORTH CENTRAL TEXAS COUNCIL OF GOVERNMENTS, AND CITY OF DALLAS STANDARD CONSTRUCTION SPECIFICATIONS.
  2. UNLESS OTHERWISE NOTED, ALL CONCRETE SHALL BE CLASS "A", (3000 PSI).
  3. THE HORIZONTAL AND VERTICAL LOCATIONS OF EXISTING SUBSURFACE UTILITIES HAVE BEEN DETERMINED FROM DATA RECORDED BY OTHERS. CONTRACTOR SHALL VERIFY THAT NECESSARY CROSSING CLEARANCES BETWEEN EXISTING AND PROPOSED UTILITIES EXIST PRIOR TO CONSTRUCTION OF ANY SUCH CROSSING. IT WILL BE THE RESPONSIBILITY OF THE CONTRACTOR TO PROTECT ALL PUBLIC UTILITIES IN THE CONSTRUCTION OF THIS PROJECT.
  4. CONTRACTOR SHALL MAINTAIN ONE SET OF "RECORD DRAWINGS" ON SITE WHICH WILL BE SUBMITTED TO OWNER OR ENGINEER UPON COMPLETION OF THE PROJECT. RECORD DRAWINGS SHALL INDICATE THE LOCATION OF ALL SUBTERRANEAN UTILITY IMPROVEMENTS, AND INDICATE TIES TO ALL MANHOLES, CULVERTS, INLETS, JUNCTION BOXES, ETC.
  5. THE CONTRACTOR IS RESPONSIBLE FOR COMPLIANCE WITH ALL FEDERAL, STATE AND LOCAL REGULATIONS REGARDING TRENCH SAFETY.
  6. STORM DRAIN LINES MAY BE OF THE FOLLOWING MATERIALS:
    - a. RCP C-76, CLASS III
    - b. ADS N-12
    - c. HANCOR HI-0
 INSTALLED IN ACCORDANCE WITH MANUFACTURER'S SPECIFICATIONS.
  7. BARRICADING AND PROJECT SIGNS SHALL CONFORM TO "STATE DEPARTMENT OF HIGHWAYS AND PUBLIC TRANSPORTATION BARRICADING AND CONSTRUCTION STANDARDS."
  8. PRIOR TO COMMENCEMENT OF CONSTRUCTION, BONDS AND THREE-WAY CONTRACTS SHALL BE SUBMITTED TO THE CITY AS REQUIRED.

*A.K.G. 7/11/94*

		9401 LBJ Freeway, Suite 300 Dallas, Texas 75243 (214) 235-3031	
<b>DETAILS SHEET</b>			
<b>BUILDING EXPANSION</b>			
<b>GREENHILL SCHOOL</b>			
<b>ABST No. 273, DALLAS COUNTY</b>			
<b>TOWN OF ADDISON, TEXAS</b>			
DESIGN	DRAWN	DATE	SCALE
JAK	BB	JUNE 1994	1"=20'
NOTES	FILE	NO.	
		C10	