

Revisions

I.	2/06/95

Job No. 93081.A

Issue Date: 12/29/94

Drawn By:

Checked By:

Sheet No.

of: C1

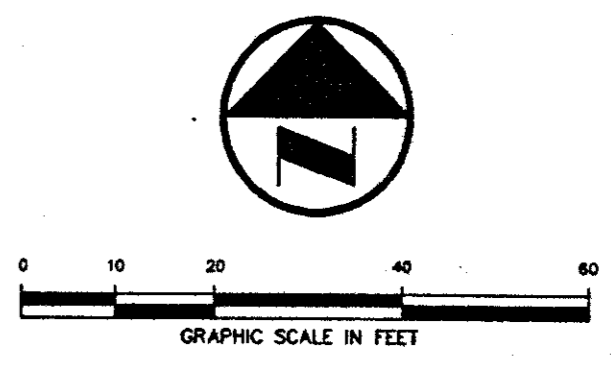
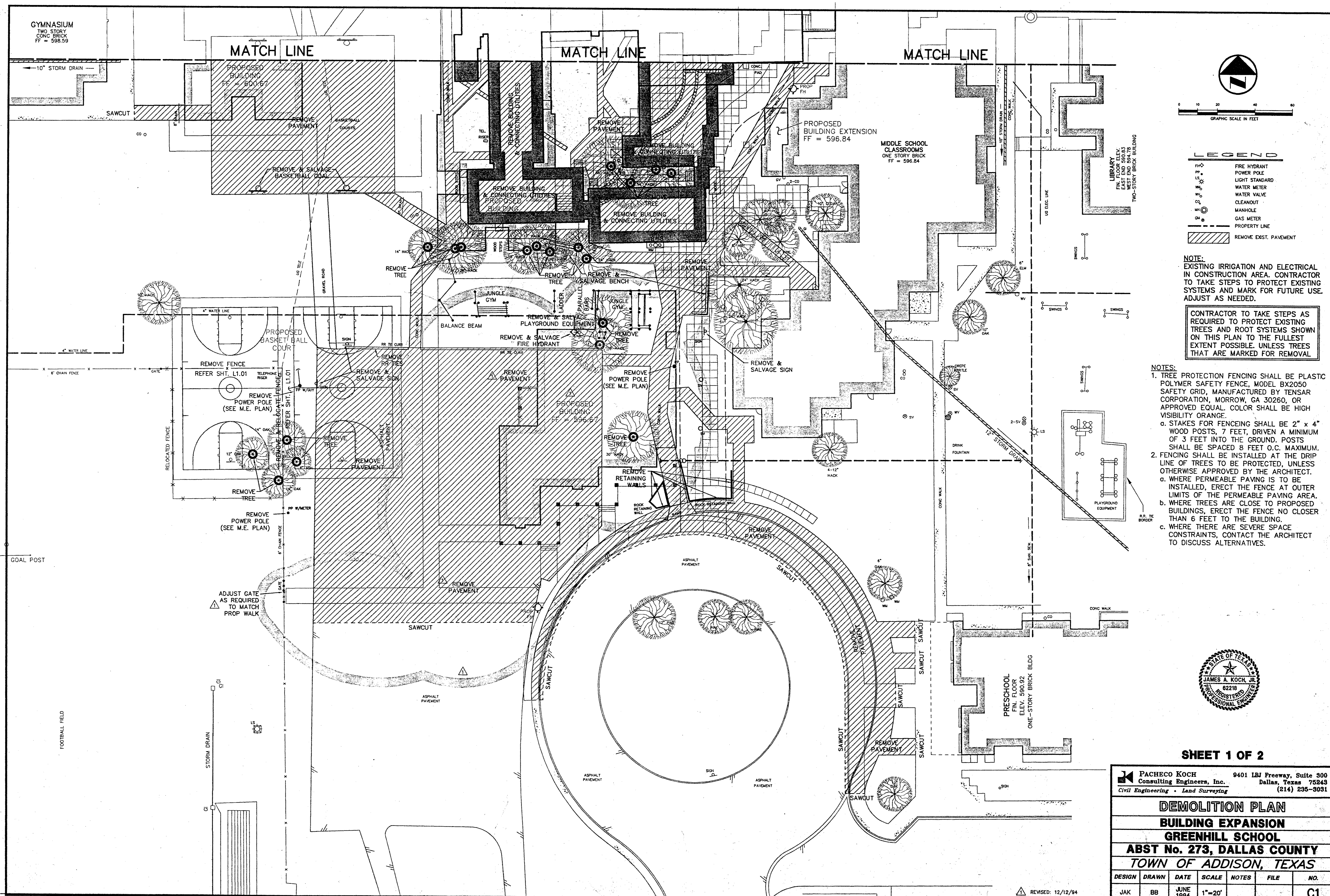

LEGEND

PH	FIRE HYDRANT
PP	POWER POLE
LS	LIGHT STANDARD
WM	WATER METER
WV	WATER VALVE
CS	CLEANOUT
MH	MANHOLE
GM	GAS METER
---	PROPERTY LINE
///	REMOVE EXIST. PAVEMENT

NOTE:
EXISTING IRRIGATION AND ELECTRICAL IN CONSTRUCTION AREA. CONTRACTOR TO TAKE STEPS TO PROTECT EXISTING SYSTEMS AND MARK FOR FUTURE USE. ADJUST AS NEEDED.

CONTRACTOR TO TAKE STEPS AS REQUIRED TO PROTECT EXISTING TREES AND ROOT SYSTEMS SHOWN ON THIS PLAN TO THE FULLEST EXTENT POSSIBLE. UNLESS TREES THAT ARE MARKED FOR REMOVAL.

- NOTES:**
- TREE PROTECTION FENCING SHALL BE PLASTIC POLYMER SAFETY FENCE, MODEL BX2050 SAFETY GRID, MANUFACTURED BY TENSAR CORPORATION, MORROW, GA 30260, OR APPROVED EQUAL. COLOR SHALL BE HIGH VISIBILITY ORANGE.
 - STAKES FOR FENCING SHALL BE 2" x 4" WOOD POSTS, 7 FEET DRIVEN A MINIMUM OF 3 FEET INTO THE GROUND. POSTS SHALL BE SPACED 8 FEET O.C. MAXIMUM.
 - FENCING SHALL BE INSTALLED AT THE DRIP LINE OF TREES TO BE PROTECTED, UNLESS OTHERWISE APPROVED BY THE ARCHITECT.
 - WHERE PERMEABLE PAVING IS TO BE INSTALLED, ERECT THE FENCE AT OUTER LIMITS OF THE PERMEABLE PAVING AREA.
 - WHERE TREES ARE CLOSE TO PROPOSED BUILDINGS, ERECT THE FENCE NO CLOSER THAN 6 FEET TO THE BUILDING.
 - WHERE THERE ARE SEVERE SPACE CONSTRAINTS, CONTACT THE ARCHITECT TO DISCUSS ALTERNATIVES.

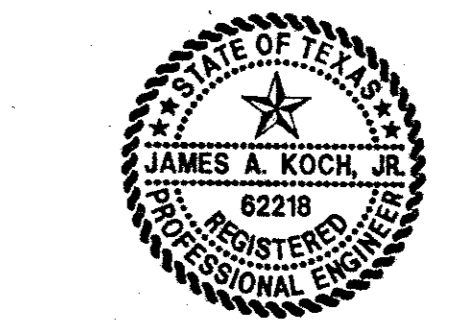

SHEET 1 OF 2

PACHECO KOCH Consulting Engineers, Inc. 9401 LBJ Freeway, Suite 300 Dallas, Texas 75243 (214) 235-3031
Civil Engineering - Land Surveying

DEMOLITION PLAN					
BUILDING EXPANSION					
GREENHILL SCHOOL					
ABST No. 273, DALLAS COUNTY					
TOWN OF ADDISON, TEXAS					
DESIGN	DRAWN	DATE	SCALE	NOTES	FILE
JAK	BB	JUNE 1994	1"=20'		C1

REVISED: 12/12/94