

CONSTRUCTION PLANS FOR

GREENHILL UPPER SCHOOL ADDITION/ NEW PRE-SCHOOL & LOWER SCHOOL

TOWN OF ADDISON, DALLAS COUNTY, TEXAS

FOR



 8350 North Central Expressway
 Suite 500
 Dallas, Texas 75206
 214.559.4851

OWNER/DEVELOPER

Greenhill School
 4141 Spring Valley Road
 Addison, TX 75001

PREPARED BY

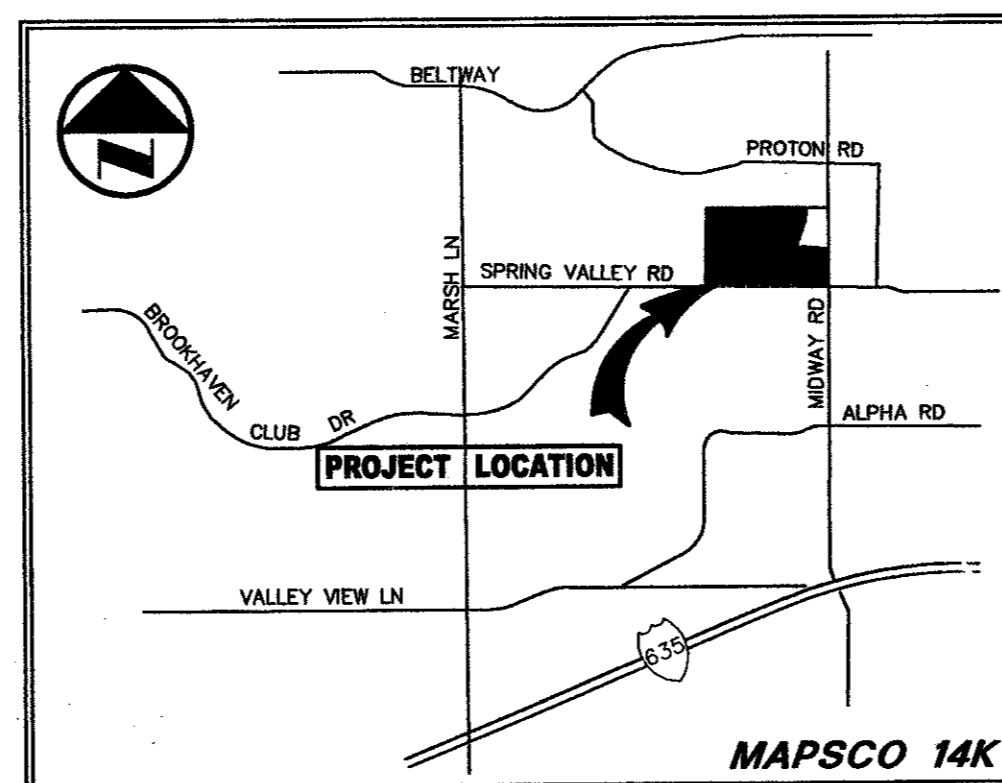
Pacheco Koch Consulting Engineers
 8350 N CENTRAL EXPWY SUITE 1000 DALLAS, TEXAS 75206 972.235.3031



VICINITY MAP



THE SEAL APPEARING ON THIS DOCUMENT WAS
 AUTHORIZED BY STEVEN A. MARKUSEN, P.E. 70090 ON
 03/31/2004. ALTERATION OF A SEALED DOCUMENT
 WITHOUT PROPER NOTIFICATION TO THE RESPONSIBLE
 ENGINEER IS AN OFFENSE UNDER THE TEXAS
 ENGINEERING PRACTICE ACT.

CONSTRUCTION SET
 ISSUED BY
 TOWN OF ADDISON
 PUBLIC WORKS DEPARTMENT
 NAME: *Steve Chubb* DATE: *5/11/04*

DRAWING SHEET INDEX

SHEET	DESCRIPTION
-	REPLAT (SHEET 1 OF 2)
-	REPLAT (SHEET 2 OF 2)
C1.0	DEMOLITION PLAN (SHEET 1 OF 2)
C1.1	DEMOLITION PLAN (SHEET 2 OF 2)
C2.0	DIMENSIONAL CONTROL PLAN (SHEET 1 OF 2)
C2.1	DIMENSIONAL CONTROL PLAN (SHEET 2 OF 2)
C3.0	GRADING PLAN (SHEET 1 OF 2)
C3.1	GRADING PLAN (SHEET 2 OF 2)
C3.2	FLOODPLAIN STUDY MAP
C3.3	FLOODPLAIN STUDY DETAILS (EXISTING CONDITIONS)
C3.4	FLOODPLAIN STUDY DETAILS (PROPOSED CONDITIONS)
C3.5	DRAINAGE PLAN (SHEET 1 OF 2)
C3.6	DRAINAGE PLAN (SHEET 2 OF 2)
C3.7	DRAINAGE PLAN & PROFILE
C4.0	WATER & SEWER PLAN (SHEET 1 OF 2)
C4.1	WATER & SEWER PLAN (SHEET 2 OF 2)
C5.0	WEST PARKING PLAN
C6.0	PAVING PLAN & DETAILS
C7.0	EROSION CONTROL PLAN (SHEET 1 OF 2)
C7.1	EROSION CONTROL PLAN (SHEET 2 OF 2)

TxDOT STANDARD DETAILS
(PW) PARALLEL WINGS
(MC-9-10) MULTIPLE BOX CULVERTS