

LES LECS VILLAGE PHASE I
V. 83183, P. 4319

PROTON PLAZA
V. 81001, P. 2042

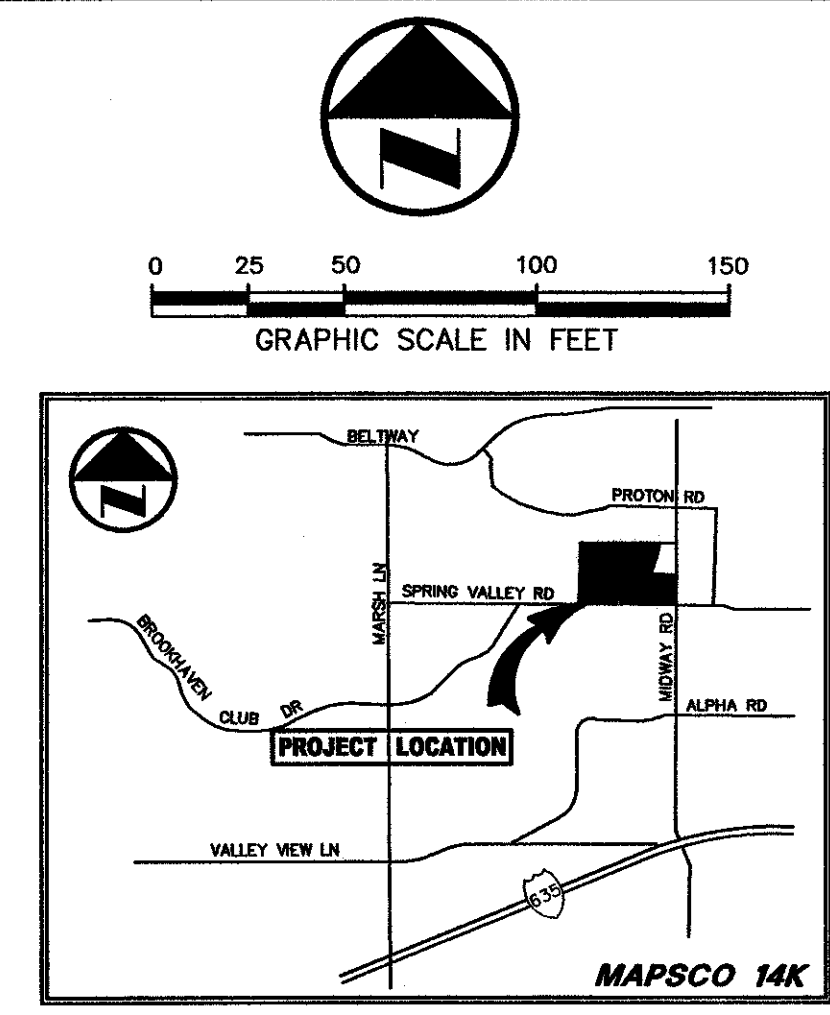

VICINITY MAP

LEGEND

- B. BOLLARD
- EM ELECTRIC METER
- PP POWER POLE
- LS LIGHT STANDARD
- WM WATER METER
- WV WATER VALVE
- ICV IRRIGATION CONTROL VALVE
- FH FIRE HYDRANT
- CQ CLEANOUT
- MH MANHOLE
- TSC TRAFFIC SIGNAL CONTROL
- TSP TRAFFIC SIGNAL POLE
- TELE TELEPHONE BOX
- FL FLOOD LIGHT
- FP FLAG POLE
- TRAF TRAFFIC SIGN
- IRS 1/2-INCH IRON ROD W/ "PACHECO KOCH" CAP SET
- (C.M.) CONTROLLING MONUMENT
- PROPERTY LINE
- FENCE
- OH OVERHEAD UTILITY LINE
- UW UNDERGROUND WATER LINE
- UE UNDERGROUND ELECTRIC LINE
- UT UNDERGROUND TELEPHONE LINE
- UC UNDERGROUND CABLE LINE
- USS UNDERGROUND SANITARY SEWER LINE
- PROPOSED FIRELANE

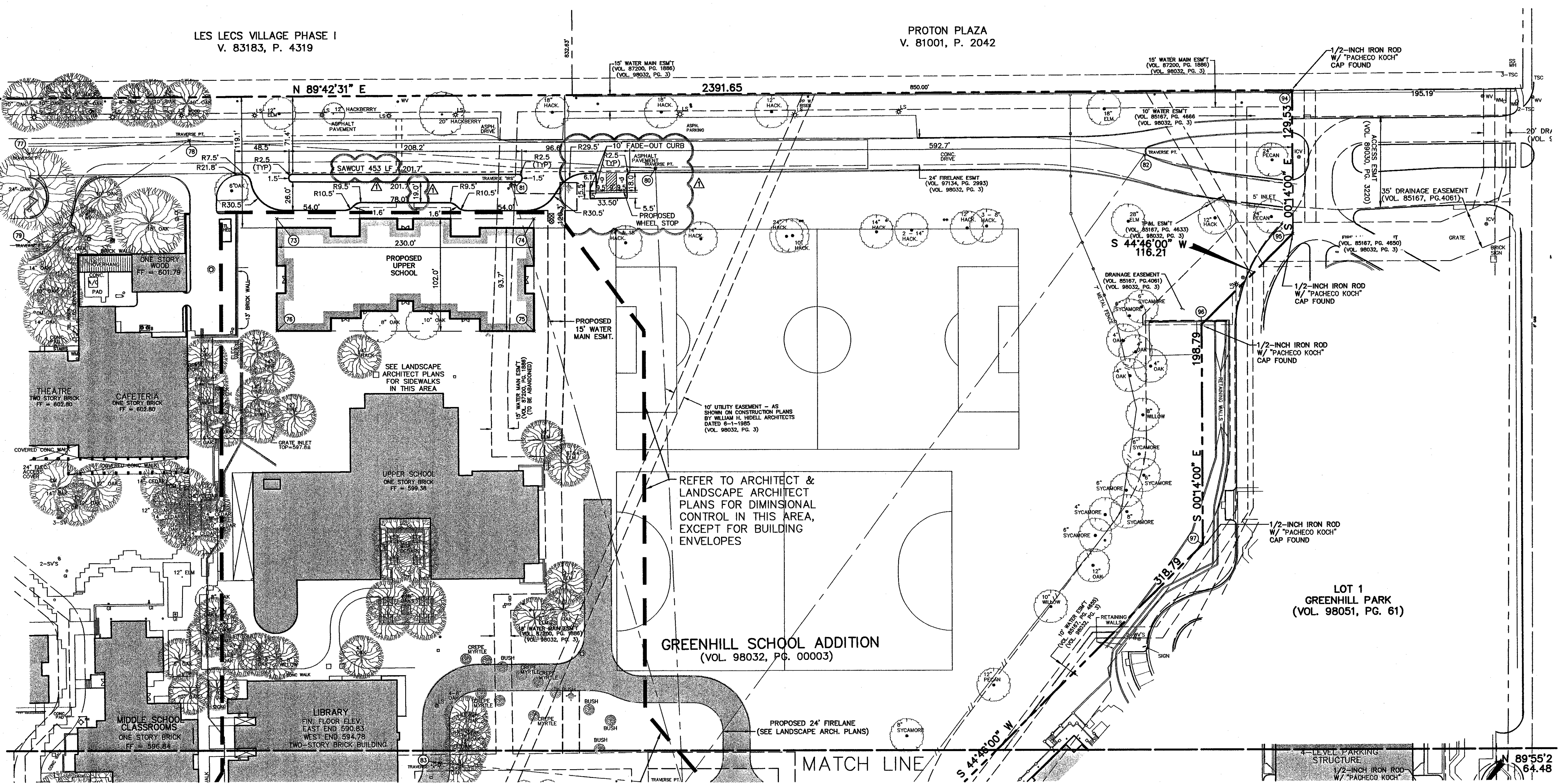

REFER TO ARCHITECT & LANDSCAPE ARCHITECT PLANS FOR DIMENSIONAL CONTROL IN THIS AREA, EXCEPT FOR BUILDING ENVELOPES

GREENHILL SCHOOL ADDITION
(VOL. 98032, PG. 00003)

LOT 1
GREENHILL PARK
(VOL. 98051, PG. 61)

DIMENSIONAL CONTROL COORDINATE TABLE

| PNT # | NORTHING | EASTING | PNT # | NORTHING | EASTING | PNT # | NORTHING | EASTING |
|-------|----------|-------------|-------|-----------|-------------|-------|-----------|-------------|
| 1 | 184.0808 | E 1722.7034 | 41 | 499.6743 | E 1743.1797 | 81 | 1388.7588 | E 1860.5899 |
| 2 | 218.0366 | E 1745.9137 | 42 | 494.1745 | E 1743.2234 | 82 | 1411.9607 | E 2427.1351 |
| 3 | 380.5633 | E 1872.4919 | 43 | 489.6152 | E 1740.1472 | 83 | 1862.5503 | E 1791.2912 |
| 4 | 229.4379 | E 1788.3817 | 44 | 524.5533 | E 1727.8372 | 84 | 840.8214 | E 2012.9484 |
| 5 | 167.1381 | E 1805.4590 | 45 | 525.8219 | E 1887.7087 | 85 | 678.8974 | E 2374.5294 |
| 6 | 227.0977 | E 1846.2127 | 46 | 497.2288 | E 1983.7477 | 86 | 723.7834 | E 2758.7574 |
| 7 | 207.9853 | E 1874.3272 | 47 | 475.1859 | E 1987.8302 | 87 | 151.1724 | E 2758.3104 |
| 8 | 288.5520 | E 1935.8792 | 48 | 452.8547 | E 2048.3304 | 88 | 481.7513 | E 1976.5316 |
| 9 | 189.0520 | E 1935.8792 | 49 | 452.8547 | E 2109.9805 | 89 | 140.3280 | E 2375.5873 |
| 10 | 189.0520 | E 2109.9805 | 50 | 310.8547 | E 2251.9805 | 90 | 47.5318 | E 1913.2240 |
| 11 | 306.0520 | E 2109.9805 | 51 | 306.0520 | E 2251.9805 | 91 | 207.7759 | E 1721.8991 |
| 12 | 192.4730 | E 2138.0666 | 52 | 184.0520 | E 2109.9805 | 92 | 455.5778 | E 1429.2246 |
| 13 | 211.4028 | E 2133.3856 | 53 | 184.0520 | E 1935.8792 | 93 | 527.3229 | E 1538.2246 |
| 14 | 203.7578 | E 2151.3248 | 54 | 187.3128 | E 1860.2742 | 94 | 1470.4389 | E 2559.2877 |
| 15 | 195.7209 | E 2170.1833 | 55 | 206.4213 | E 1832.1597 | 95 | 1340.9101 | E 2559.8152 |
| 16 | 213.7251 | E 2180.3904 | 56 | 207.8545 | E 1781.1670 | 96 | 1258.4032 | E 2477.9776 |
| 17 | 305.9419 | E 2110.1702 | 57 | 723.7679 | E 2012.6545 | 97 | 1059.6149 | E 2478.7872 |
| 18 | 306.0520 | E 2215.1701 | 58 | 681.8097 | E 2085.3283 | 98 | 833.2802 | E 2254.2885 |
| 19 | 310.8547 | E 2215.1701 | 59 | 531.4805 | E 1998.5380 | 99 | 702.0713 | E 2254.8228 |
| 20 | 310.7446 | E 2110.1702 | 60 | 573.4398 | E 1925.8648 | 100 | 702.3850 | E 2477.6526 |
| 21 | 362.8000 | E 2201.3581 | 61 | 634.8631 | E 1777.6300 | 101 | 747.1835 | E 2477.5935 |
| 22 | 372.9632 | E 2210.1614 | 62 | 634.8631 | E 1925.2987 | 102 | 747.1835 | E 2913.4991 |
| 23 | 378.0988 | E 2198.9027 | 63 | 572.8631 | E 1925.2987 | 103 | 784.8623 | E 2513.4991 |
| 24 | 378.0916 | E 2179.6321 | 64 | 572.8631 | E 1777.6300 | 104 | 784.8623 | E 2543.3738 |
| 25 | 392.7269 | E 2193.9825 | 65 | 697.7894 | E 1838.0050 | 105 | 795.0107 | E 2543.3606 |
| 26 | 310.8547 | E 2109.9805 | 66 | 697.7894 | E 1915.3384 | 106 | 795.0107 | E 2688.8037 |
| 27 | 427.8547 | E 2109.9805 | 67 | 644.7894 | E 1915.3384 | 107 | 815.1907 | E 2688.7121 |
| 28 | 427.8547 | E 2048.3304 | 68 | 644.7894 | E 1838.0050 | 108 | 815.2757 | E 2751.1888 |
| 29 | 540.3547 | E 2048.3304 | 69 | 803.6472 | E 1542.0470 | 109 | 828.9648 | E 2751.8253 |
| 30 | 438.8187 | E 2002.3243 | 70 | 803.6430 | E 1748.1717 | 110 | 148.5953 | E 2672.1634 |
| 31 | 418.8588 | E 1994.7284 | 71 | 537.2889 | E 1748.1717 | 111 | 145.4682 | E 1903.8988 |
| 32 | 437.3916 | E 1988.6582 | 72 | 537.2889 | E 1542.0470 | 112 | 155.0591 | E 1803.8188 |
| 33 | 432.3105 | E 1973.1410 | 73 | 1355.0159 | E 1850.9673 | 113 | 153.6337 | E 1453.8215 |
| 34 | 443.1751 | E 1859.2307 | 74 | 1355.0159 | E 1880.9679 | 114 | 143.6338 | E 1453.8215 |
| 35 | 465.2078 | E 1934.6482 | 75 | 1253.0159 | E 1880.9679 | 115 | 205.7334 | E 1939.2929 |
| 36 | 413.8254 | E 1888.9554 | 76 | 1425.6886 | E 1880.9673 | 116 | 412.8493 | E 2045.8305 |
| 37 | 482.8233 | E 1888.0479 | 77 | 1413.9781 | E 1429.2246 | 117 | 487.8493 | E 2089.9564 |
| 38 | 481.8231 | E 1782.0009 | 78 | 1425.6886 | E 1572.7820 | 118 | 412.8493 | E 2125.7843 |
| 39 | 497.6447 | E 1770.9889 | 79 | 1334.5872 | E 1429.2246 | 119 | 191.4118 | E 2135.7488 |
| 40 | 499.8843 | E 1789.8521 | 80 | 1400.2619 | E 1988.7834 | | | |

GENERAL NOTES

- ALL WORK, UNLESS OTHERWISE NOTED, SHALL CONFORM TO THE STANDARD SPECIFICATIONS FOR PUBLIC WORKS CONSTRUCTION, ISSUED BY THE NORTH CENTRAL TEXAS COUNCIL OF GOVERNMENT, AND TOWN OF ADDISON STANDARD CONSTRUCTION SPECIFICATIONS.
- PRIOR TO ANY CONSTRUCTION, THE CONTRACTOR SHALL BE FAMILIAR WITH THE PLANS INCLUDING ALL NOTES, THE STANDARD SPECIFICATIONS FOR PUBLIC WORKS CONSTRUCTION NORTH CENTRAL TEXAS AND THE CITY STANDARDS FOR CONSTRUCTION AND ANY OTHER APPLICABLE STANDARD AND SPECIFICATIONS RELEVANT TO THE PROPER COMPLETION OF THE WORK SPECIFIED. FAILURE ON THE PART OF THE CONTRACTOR TO BE FAMILIAR WITH ALL STANDARDS AND SPECIFICATIONS PERTAINING TO THIS WORK SHALL IN NO WAY RELIEVE THE CONTRACTOR OF RESPONSIBILITY OF PERFORMING THE WORK IN ACCORDANCE WITH ALL SUCH APPLICABLE STANDARDS AND SPECIFICATIONS.
- THE HORIZONTAL AND VERTICAL LOCATIONS OF EXISTING SUBSURFACE UTILITIES HAVE BEEN DETERMINED FROM DATA RECORDED BY OTHERS. CONTRACTOR SHALL VERIFY THAT NECESSARY CROSSING CLEARANCES BETWEEN EXISTING AND PROPOSED UTILITIES EXIST PRIOR TO CONSTRUCTION OF ANY SUCH CROSSING. IT WILL BE THE RESPONSIBILITY OF THE CONTRACTOR TO PROTECT ALL UTILITIES IN THE CONSTRUCTION OF THIS PROJECT. CONTRACTOR TO VERIFY SIZE AND LOCATION OF ALL UTILITIES PRIOR TO CONSTRUCTION.
- IT WILL BE THE RESPONSIBILITY OF THE CONTRACTOR TO PROTECT ALL MANHOLES, CLEANOUTS, VALVE BOXES, FIRE HYDRANTS, ETC. THEY MUST BE ADJUSTED TO PROPER LINE, AND GRADE BY THE CONTRACTOR PRIOR TO AND AFTER THE PLACING OF PERMANENT PAVING AND GRADING. UTILITIES MUST BE MAINTAINED TO PROPER LINE AND GRADE DURING THE CONSTRUCTION OF THE PAVING FOR THIS DEVELOPMENT.
- PROTECT AND MAINTAIN ROADWAY TRAFFIC THROUGHOUT THE PROJECT, PROVIDING A MINIMUM OF ONE (1) LANE OPEN IN EACH DIRECTION; PROVIDE AND MAINTAIN INTERIM ACCESS FROM ROADWAYS CURRENTLY IN USE TO ALL DRIVEWAYS AND INTERSECTING STREETS OR ALLEYS; MAINTAIN NORMAL PROJECT DRAINAGE UNTIL NEW DRAINAGE FACILITIES ARE FUNCTIONAL INCLUDING, WHERE NECESSARY, INTERIM REPLACEMENT OF EXISTING DRAINAGE STRUCTURES REMOVED FOR CONSTRUCTION OF NEW DRAINAGE FACILITIES; MAINTAIN ALL WORK AND MATERIAL STORAGE AREAS IN ORDERLY CONDITION, FREE OF DEBRIS AND WASTE, ON COMPLETION OF CONSTRUCTION, CLEAN UP THE PROJECT AND ADJACENT AFFECTED AREAS TO ACCEPTABLE CONDITION, ALL AS PROVIDED IN THE GENERAL CONDITIONS.
- PRIOR TO COMMENCEMENT OF CONSTRUCTION, BONDS AND THREE-WAY CONTRACTS SHALL BE SUBMITTED TO THE CITY AS REQUIRED.
- THE CONTRACTOR IS RESPONSIBLE FOR COMPLIANCE WITH ALL FEDERAL, STATE AND LOCAL REGULATIONS REGARDING TRENCH SAFETY.
- REFER TO ARCHITECTURAL AND STRUCTURAL PLANS TO VERIFY ALL BUILDING DIMENSIONS.
- REFER TO ARCHITECTURAL PLANS FOR DETAILED BUILDING ENTRANCE LAYOUTS, RAMPS, LANDSCAPE AND SIDEWALKS.
- BARRICADING AND PROJECT SIGNS SHALL CONFORM TO TEXAS DEPARTMENT OF TRANSPORTATION MANUAL OF UNIFORM TRAFFIC CONTROL DEVICES AND LATEST UPDATES.

NOTE: ALL DIMENSIONS ARE TO BACK OF CURB UNLESS OTHERWISE NOTED.

| | | |
|------------|------|----------------------------------------------|
| NO. | DATE | REVISION |
| 04/30/2004 | | ADDED DIMENSIONS, REVISED NOTE & H.C. SPACES |

Pacheco Koch Consulting Engineers
8350 N CENTRAL EXPWY SUITE 1000 DALLAS, TEXAS 75206 972.235.3031

DIMENSIONAL CONTROL PLAN
GREENHILL SCHOOL
GREENHILL SCHOOL ADDITION
THOMAS L. CHENOWETH SURVEY, ABSTRACT NO. 273
TOWN OF ADDISON, TEXAS

| DESIGN | DRAWN | DATE | SCALE | NOTES | FILE | NO. |
|--------|-------|-----------|--------|-------|------|-------------|
| BJM | FJM | NOV, 2003 | 1"=50' | | | C2.0 |



THE SEAL APPEARING ON THIS DOCUMENT WAS AUTHORIZED BY STEVEN A. MARKUSSEN, P.E. 70989 ON 03/31/2004. ALTERATION OF A SEALED DOCUMENT WITHOUT PROPER NOTIFICATION TO THE RESPONSIBLE ENGINEER IS AN OFFENSE UNDER THE TEXAS ENGINEERING PRACTICE ACT.

DIVEY 04/30/2004 - 1:20PM M:\DWG-10\1082-03-02A\DWG\1082-03-024CV.DWG