

**CONTACT:**  
MR ED KEAH, OPERATING SUPPORT SECTION  
DISTRIBUTION DEPARTMENT, 2 WORKING  
DAYS PRIOR TO EXCAVATING T.U. ELECTRIC  
FACILITIES.  
PHONE: (214)698-7239 OR (214)698-7207

**CAUTION!!**  
UNDERGROUND TELEPHONE  
IN AREA - CONTACT S.W.B.T.  
48 HOURS PRIOR TO CONSTRUCTION  
PHONE: 1-800-315-0440

**CAUTION!!!**  
GAS LINE IN AREA-CONTACT  
LONE STAR GAS 48 HOURS  
PRIOR TO CONSTRUCTION  
PHONE: (214)263-DIGG

REMOVE EXISTING  
SANI SEWER SEWER  
SERVICE TO PORTABLE  
BUILDING TO A POINT  
5' SOUTH OF PROPOSED  
NATATORUM & PLUG  
CONTRATOR TO VERIFY  
LOCATION

CONTRACTOR TO TAKE STEPS AS  
REQUIRED TO PROTECT EXISTING  
TREES AND ROOT SYSTEMS SHOWN  
ON THIS PLAN TO THE FULLEST  
EXTENT POSSIBLE. UNLESS TREES  
THAT ARE MARKED FOR REMOVAL  
MAINTAIN EXISTING GRADE AS CLOSE  
AS POSSIBLE UNDER DRIP LINE

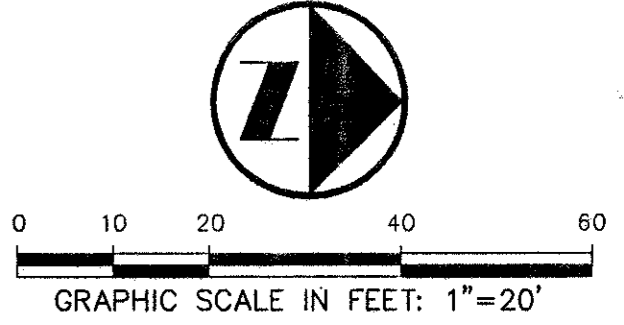

**LEGEND**

FW	FIRE HYDRANT
PP	POWER POLE
LS	LIGHT STANDARD
WM	WATER METER
WV	WATER VALVE
CO	CLEANOUT
MH	MANHOLE
GM	GAS METER
---	PROPERTY LINE

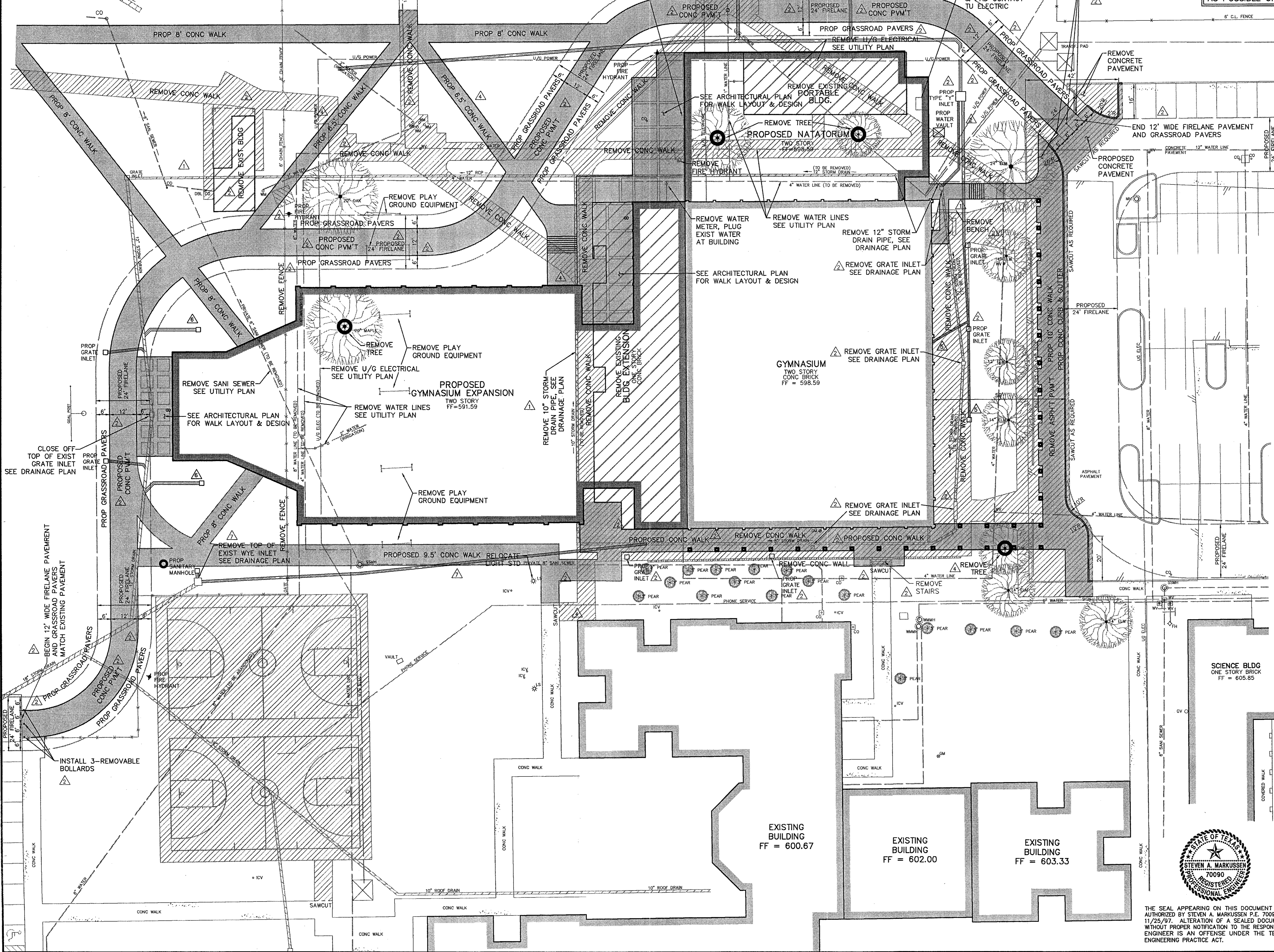

- GENERAL NOTES:**
1. SIZE AND LOCATION OF ALL UNDERGROUND UTILITIES HAVE BEEN REPRODUCED FROM PLANS ON FILE WITH THE CITY OF ADDISON, TEXAS DEPARTMENT OF TRANSPORTATION AND PUBLIC UTILITY COMPANIES. CONTRACTOR TO VERIFY LOCATION OF ALL UTILITIES PRIOR TO CONSTRUCTION.
  2. ALL PROPERTY CORNER MONUMENTS ON SUBJECT TRACT ARE 1/2-INCH IRON RODS WITH "PACHECO KOCH" CAPS SET UNLESS OTHERWISE NOTED.
  3. REFER TO STANDARD DETAILS AND GENERAL NOTES SHEET FOR PAVING, DRAINAGE AND UTILITY STANDARD DETAILS AND GENERAL NOTES.
  4. REFER TO ARCHITECTURAL/M.E.P. PLANS FOR COORDINATION OF SIGHT LIGHTING FOR LOCATIONS AND REQUIREMENTS.
  5. REFER TO ARCHITECTURAL PLANS FOR DETAILS AND DIMENSIONS OF THE PROPOSED BUILDING, DUMPSTER AREA AND OVERHANGS.
  6. COORDINATE WITH THE CONSTRUCTION MANAGER FOR EXACT SIZE AND LOCATION OF THE SITE SIGNAGE AND STRIPING.
  7. ALL DIMENSIONS ARE FACE OF CURB TO FACE OF CURB UNLESS OTHERWISE INDICATED.
  8. CONTRACTOR TO PROVIDE EROSION CONTROL MEASURES ALONG PERIMETER OF WORK AREA.
  9. BARRACADING AND PROJECT SIGNS SHALL CONFORM TO "STATE OF TEXAS DEPARTMENT OF HIGHWAYS AND PUBLIC TRANSPORTATION BARRACADING AND CONSTRUCTION STANDARDS".
  10. SEE LANDSCAPING PLAN FOR PROPOSED SIDEWALKS AND FENCE DESIGN AND LOCATION.
  11. SEE REPEAT OF THE GREEN HILL SCHOOL ADDITION, DATED MAY 1997 FOR SPECIFIC LOCATION OF PROPOSED FIRE LANE AND UTILITY EASEMENTS.
  12. ITEMS TO BE REMOVED FOR CONSTRUCTION ARE TO REMAIN THE PROPERTY OF GREEN HILL SCHOOL.

- △ REVISED: NOV 13, 1998
- △ REVISED: OCT. 5, 1998
- △ REVISED: JUNE 3, 1998
- △ REVISED: NOV 25, 1997
- △ REVISED: OCT 24, 1997
- △ REVISED: SEP 8, 1997
- △ REVISED: JUN 30, 1997

**PACHECO KOCH** Consulting Engineers, Inc. 9401 LBJ Freeway, Suite 300  
Dallas, Texas 75243  
Civil Engineering • Land Surveying (972) 235-3031



**DIMENSIONAL CONTROL PLAN**  
**BUILDING EXPANSION**  
**GREENHILL SCHOOL**  
**ABST No. 273, DALLAS COUNTY**  
**CITY OF ADDISON, TEXAS**

DESIGN	DRAWN	DATE	SCALE	NOTES	FILE	NO.
SAM	BB	SEP 1997	1"=20'			C-1

THE SEAL APPEARING ON THIS DOCUMENT WAS AUTHORIZED BY STEVEN A. MARKUSSEN P.E. 70090 ON 11/25/97. ALTERATION OF A SEALED DOCUMENT WITHOUT PROPER NOTIFICATION TO THE RESPONSIBLE ENGINEER IS AN OFFENSE UNDER THE TEXAS ENGINEERING PRACTICE ACT.

MOD. TIME: 11/17/98 09:31 AM PLOT BY: Ron Lewis PLOT TIME: 11/17/98 09:31 AM DWG NAME: 1082-42a.dwg