

GENERAL NOTES

1. ALL WORK, UNLESS OTHERWISE NOTED, SHALL CONFORM TO THE STANDARD SPECIFICATIONS FOR PUBLIC WORKS CONSTRUCTION, ISSUED BY THE NORTH CENTRAL TEXAS COUNCIL OF GOVERNMENTS, AND TOWN OF ADDISON STANDARD CONSTRUCTION SPECIFICATIONS.
2. UNLESS OTHERWISE NOTED, ALL CONCRETE SHALL BE CLASS "A" (3000 PSI).
3. THE HORIZONTAL AND VERTICAL LOCATIONS OF EXISTING SUBSURFACE UTILITIES HAVE BEEN DETERMINED FROM DATA RECORDED BY OTHERS. CONTRACTOR SHALL VERIFY THAT NECESSARY CROSSING CLEARANCES BETWEEN EXISTING AND PROPOSED UTILITIES EXIST PRIOR TO CONSTRUCTION OF ANY SUCH CROSSING. IT WILL BE THE RESPONSIBILITY OF THE CONTRACTOR TO PROTECT ALL PUBLIC UTILITIES IN THE CONSTRUCTION OF THIS PROJECT.
4. CONTRACTOR SHALL MAINTAIN ONE SET OF "RECORD DRAWINGS" ON SITE WHICH WILL BE SUBMITTED TO OWNER OR ENGINEER UPON COMPLETION OF THE PROJECT. RECORD DRAWINGS SHALL INDICATE THE LOCATION OF ALL SUBTERRANEAN UTILITY IMPROVEMENTS, AND INDICATE TIES TO ALL MANHOLES, CULVERTS, INLETS, JUNCTION BOXES, ETC.
5. ALL WATER MAINS SHALL BE DUCTILE IRON CLASS 51 WITH CATHODIC PROTECTION OR PVC C900, DR 14, CLASS 200.
6. ALL WATER MAINS, UNLESS OTHERWISE NOTED SHALL HAVE A MINIMUM COVER OF 48" BELOW FINISHED GRADE.
7. THE CONTRACTOR IS RESPONSIBLE FOR COMPLIANCE WITH ALL FEDERAL, STATE AND LOCAL REGULATIONS REGARDING TRENCH SAFETY.
8. CONCRETE STORM SEWER PIPE SHALL BE CLASS III, ASTM C76, ADS N-12, OR HANCOR HI-Q INSTALLED IN ACCORDANCE WITH MANUFACTURER'S SPECIFICATIONS.

NOTE: CONTRACTOR IS RESPONSIBLE FOR THE ADJUSTMENT OF EXISTING UTILITIES IN THE EXPANSION AREA AS REQUIRED. THE OWNER IS RESPONSIBLE FOR THE ADJUSTMENT OR RELOCATION OF THE IRRIGATION SYSTEM.

- BM # 3: CUT "X" ON SIDEWALK ON EAST SIDE OF DRIVE NEAR SOUTHEAST CORNER OF LOWER SCHOOL. TRAVERSE POINT 20.
ELEV. 586.06
- BM # 12: CUT SQUARE AT NORTHWEST CORNER OF INTERSECTION OF SIDEWALKS ON NORTH SIDE OF DRIVE NEAR THE SOUTHWEST CORNER OF THE LOWER SCHOOL.
ELEV. 587.78

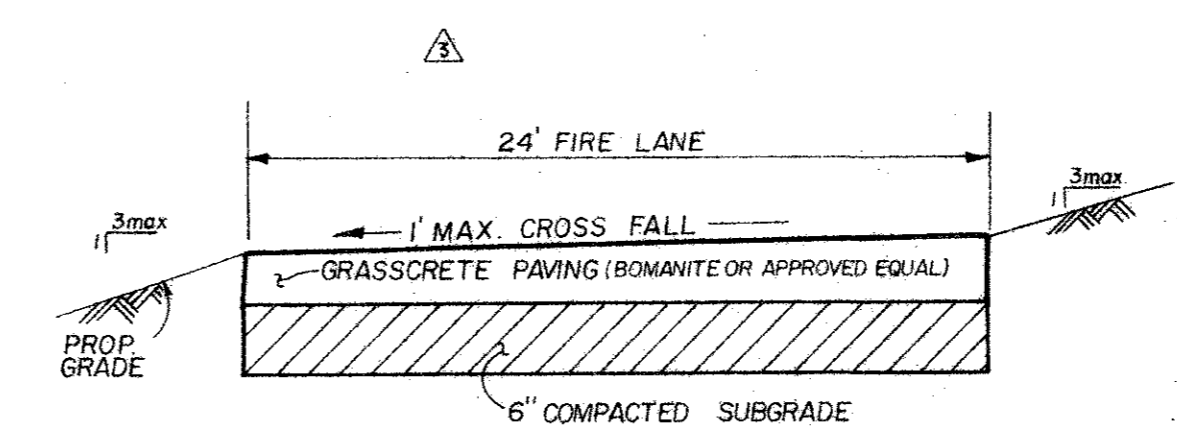

TYPICAL FIRE LANE SECTION
NTS

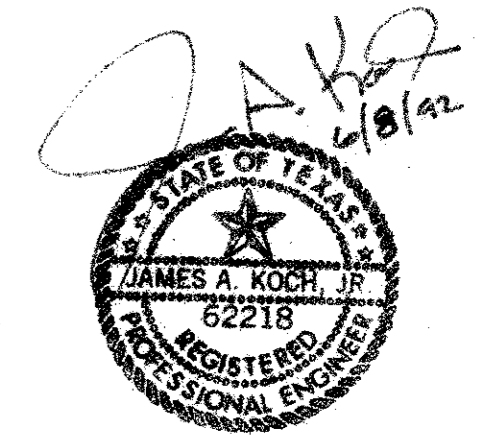

PACHECO KOCH Consulting Engineers, Inc. 9401 LBJ Freeway, Suite 300 Dallas, Texas 75243 (214) 235-3081

GRADING, DRAINAGE AND UTILITY PLAN
LOWER SCHOOL EXPANSION
GREENHILL SCHOOL CAMPUS
CITY OF ADDISON, TEXAS

DESIGN	DRAWN	DATE	SCALE	NOTES	FILE	NO.
JAK	JAK	MAY 1992	1"=20'			

- △ REVISED 7/31/92
- △ REVISED 6/2/92
- △ REVISED 05/27/92

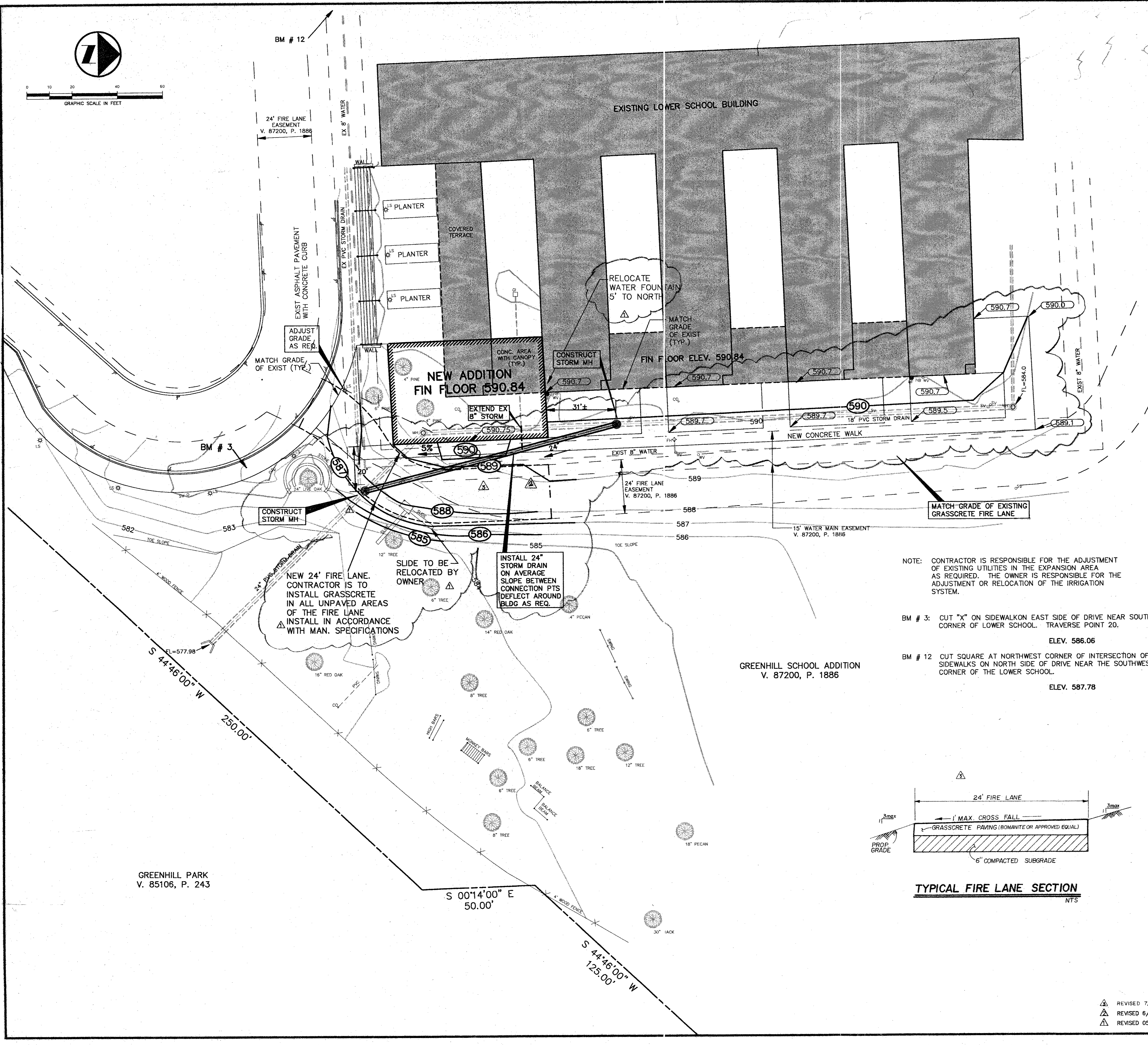

GREENHILL PARK
V. 85106, P. 243

GREENHILL SCHOOL ADDITION
V. 87200, P. 1886