

Greenhill School  
DEASON FAMILY  
TENNIS CENTER

HIDELL

ASSOCIATES  
ARCHITECTS

3033 KELWAY DRIVE, SUITE 120  
DALLAS, TEXAS 75243-5505  
(972) 351-1168  
FAX: (972) 351-4189  
E-MAIL: hidell@hidell.com

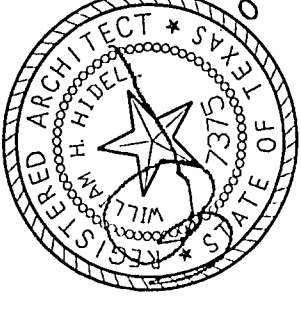

STRUCTURAL ENGINEER  
RAYMOND L. COODSON, JR., INC.  
3045 L. S. SICKS, SUITE 300  
DALLAS, TEXAS 75243  
(214) 739-8100  
Fax: (214) 739-8394

CIVIL ENGINEER  
PACHECO KOCH CONSULTING ENGINEERS  
1000 W. W. WALKER, SUITE 300  
DALLAS, TEXAS 75243  
(972) 235-3031  
Fax: (972) 235-8944

MEP ENGINEER  
BOYKIN ENGINEERING, INC.  
1000 W. W. WALKER, SUITE 300  
DALLAS, TEXAS 75243  
(972) 338-3300  
Fax: (972) 338-4768

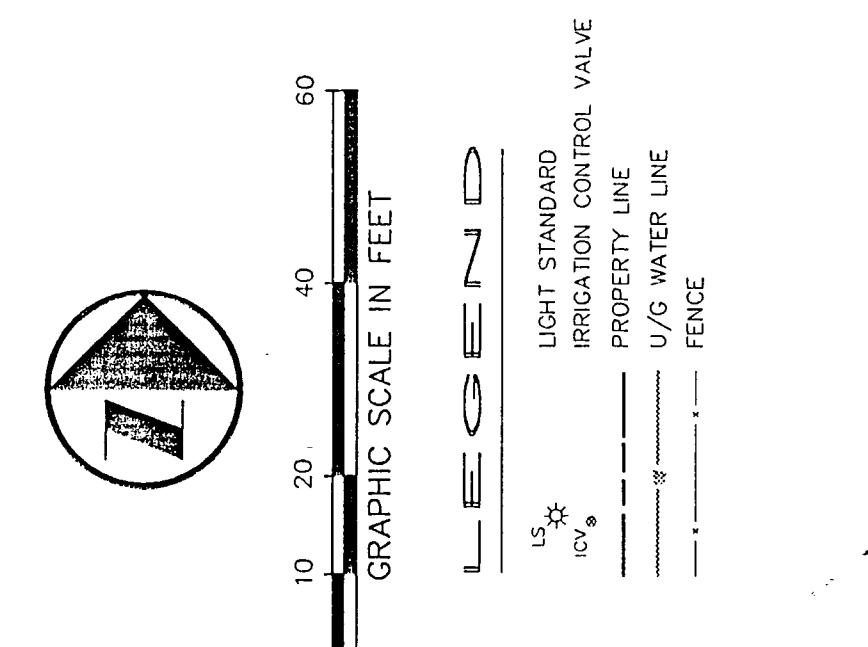
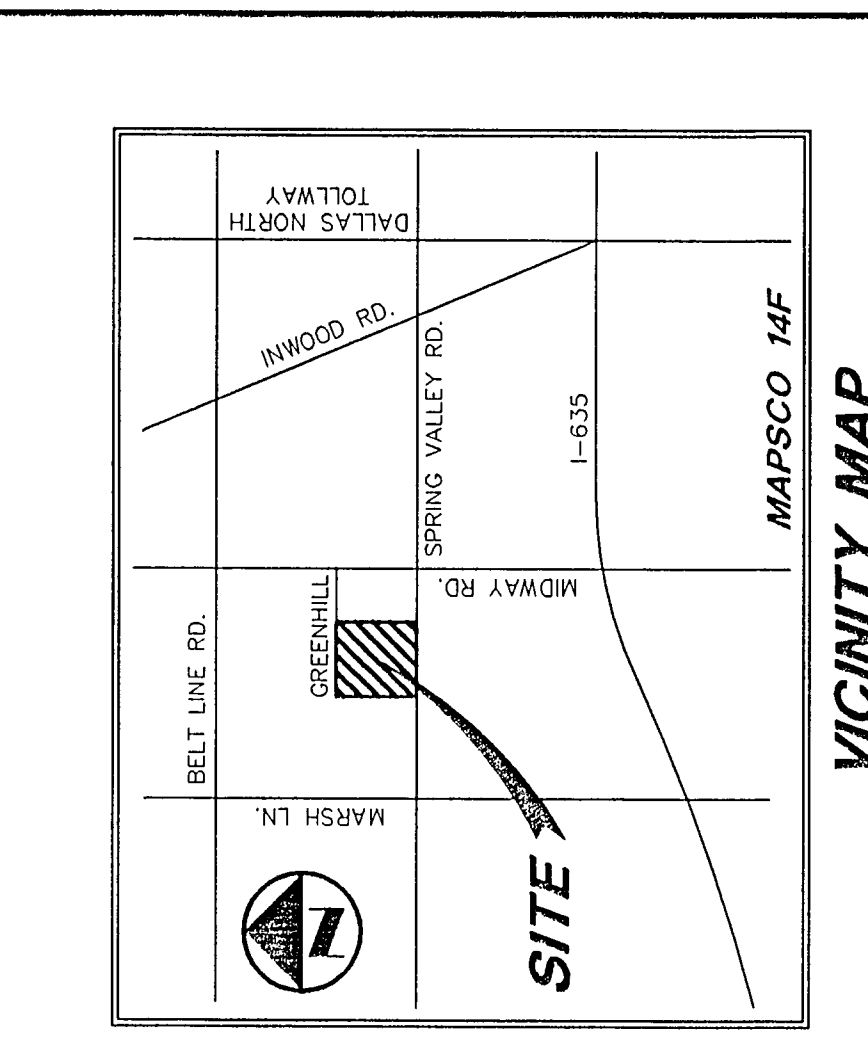

NOTE: PROPOSED WATER LINES SHALL BE CONCRETE ENCASED. CONCRETE ENCASEMENT SHALL BE INSTALLED AT ALL CROSSINGS OF EXISTING WATER LINES, STORM DRAIN CROSSINGS, AND WHERE PROPOSED SEWER &/OR STORM DRAINS CROSS EXISTING WATER LINES. THE EXISTING LINE SHALL BE CONCRETE ENCASED IN THE SAME MANNER.

LEGEND:  
= AREAS OF PROPOSED ENCASEMENT

- WATER AND SANITARY SEWER GENERAL NOTES**
1. ALL WORK, UNLESS OTHERWISE NOTED, SHALL CONFORM TO THE STANDARD SPECIFICATIONS FOR PUBLIC WORKS CONSTRUCTION, ISSUED BY THE TEXAS DEPARTMENT OF TRANSPORTATION, AND TOWN OF ADDISON STANDARD CONSTRUCTION SPECIFICATIONS.
  2. UNLESS OTHERWISE NOTED, ALL CONCRETE SHALL BE CLASS "A", (3000 PS).
  3. THE HORIZONTAL AND VERTICAL LOCATIONS OF EXISTING SUBSURFACE UTILITIES HAVE BEEN DETERMINED FROM DATA RECORDED BY OTHERS. CONTRACTOR SHALL VERIFY THAT NECESSARY CROSSING CLEARANCES ARE MAINTAINED AT ALL CROSSINGS. IT WILL BE THE RESPONSIBILITY OF THE CONTRACTOR TO PROTECT ALL PUBLIC UTILITIES IN THE CONSTRUCTION OF THIS PROJECT.
  4. CONTRACTOR SHALL MAINTAIN ONE SET OF "RECORD DRAWINGS" ON SITE WHICH WILL BE SUBMITTED TO OWNER OR ENGINEER UPON COMPLETION OF THE PROJECT. RECORD DRAWINGS SHALL INDICATE THE LOCATION OF ALL MANHOLES, CULVERTS, INLETS, JUNCTION BOXES, ETC.
  5. ALL WATER MAINS SHALL BE DUCTILE IRON, CLASS 51 WITH CATHODIC PROTECTION OR PVC 6900, DR-18, CLASS 150.
  6. ALL WATER MAINS UNLESS OTHERWISE NOTED SHALL HAVE A MINIMUM COVER OF 45" BELOW FINISHED GRADE.
  7. THE CONTRACTOR IS RESPONSIBLE FOR COMPLIANCE WITH ALL FEDERAL, STATE AND LOCAL REGULATIONS REGARDING TRENCH SAFETY.
  8. BARRICADING AND PROJECT SIGNS SHALL CONFORM TO "STATE DEPARTMENT OF HIGHWAYS AND PUBLIC TRANSPORTATION BARRICADING AND CONSTRUCTION STANDARDS."
  9. PRIOR TO COMMENCEMENT OF CONSTRUCTION, BONDS AND THREE-WAY CONTRACTS SHALL BE SUBMITTED TO THE CITY AS REQUIRED.

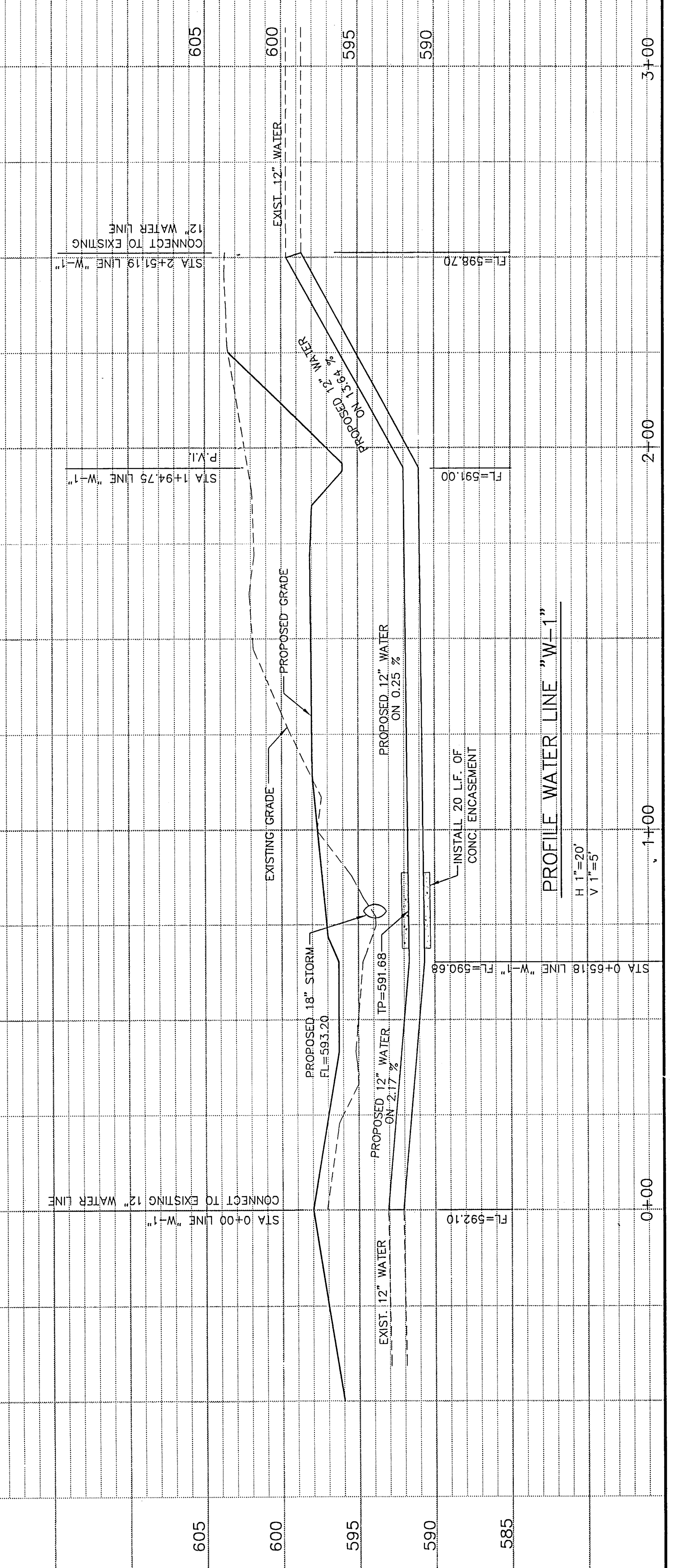
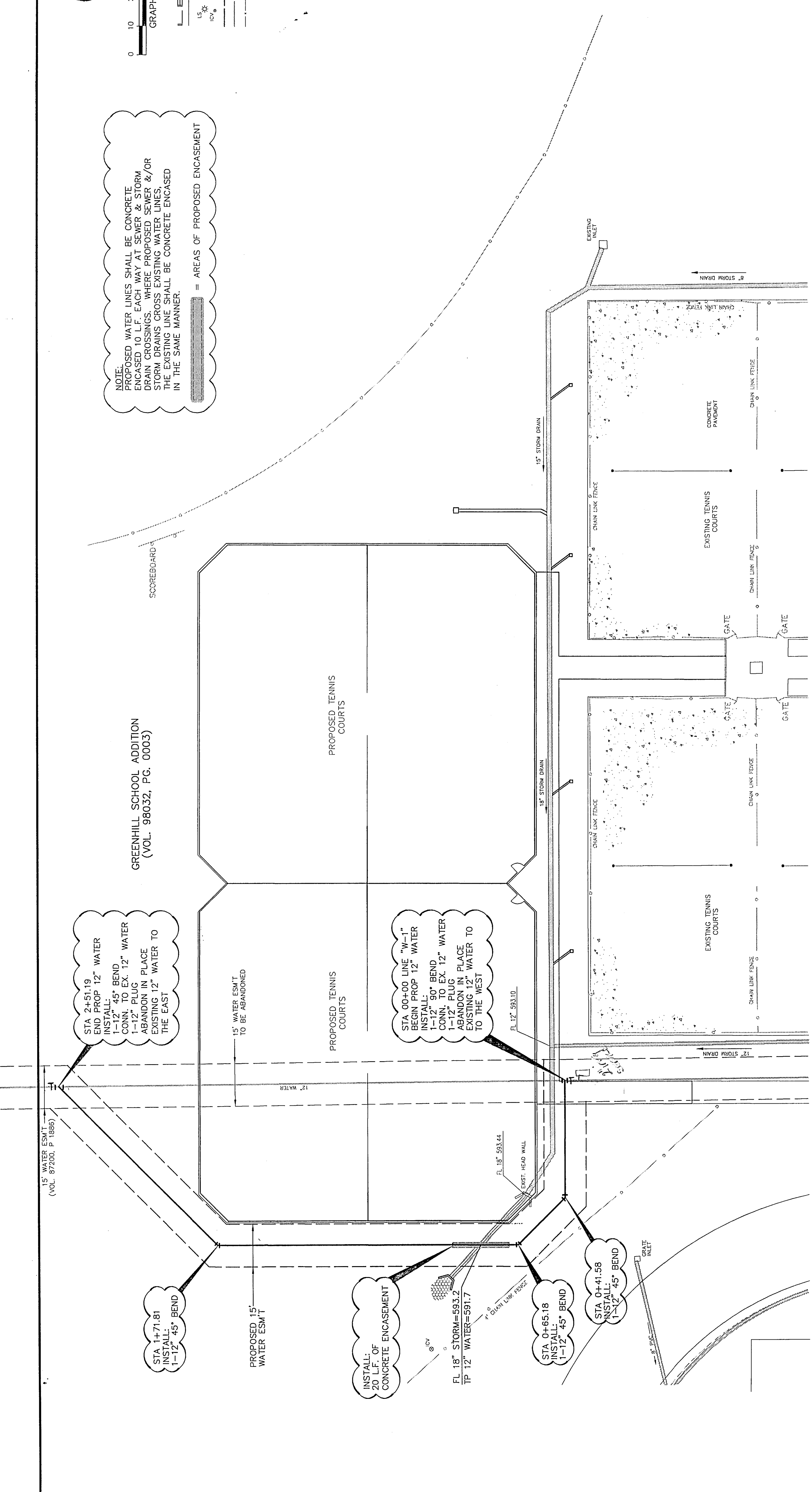

**Pacheco Koch Consulting Engineers**  
9401 LBJ FREEWAY, SUITE 300, DALLAS, TEXAS 75243 972.238.3031

**WATER RELOCATION PLAN**  
**GREENHILL SCHOOL**  
**DEASON FAMILY TENNIS COMPLEX**  
**DALLAS COUNTY**  
**CITY OF ADDISON, TEXAS**

DESIGN	DRAWN	DATE	SCALE	NOTES	FILE NO.
SAM	RRL	JUNE 26 2000	1"=20'	1"=4'	C-4.0



THE SEAL APPEARING ON THIS DOCUMENT WAS AUTHORIZED BY STEVEN A. MARKOWSKI P.E. 20090 ON 06/23/2000 WITHOUT PROPER NOTIFICATION TO THE RESPONSIBLE ENGINEERING PRACTICE ACT.

Job No. 99011  
Issue Date:  
Drawn By:  
Checked By:  
Sheet No.