



Greenhill School  
DEASON FAMILY  
TENNIS CENTER

HIDEELL

ARCHITECTS

3033 KELLWAY DRIVE, SUITE 120  
DALLAS, TEXAS 75243  
(972) 410-4664 FAX (972) 416-0169  
E-MAIL: hideell@hideell.com

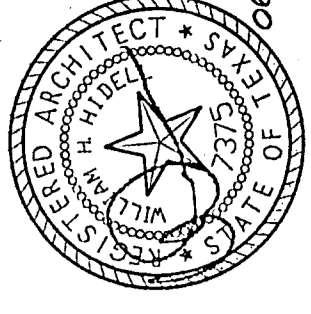

STRUCTURAL ENGINEER  
RAYMOND L. GOODSON, JR., INC.  
5445 L. Street, Suite 300  
Dallas, Texas 75243  
(214) 739-8100  
Fax: (214) 739-6354

CIVIL ENGINEER  
RACHEL KOCH CONSULTING ENGINEERS  
9400 W. LBJ Fwy, Suite 300  
Dallas, TX 75243  
(972) 231-3333  
Fax: (972) 231-9644

MEP ENGINEER  
BASARRAH ENGINEERING, INC.  
1905 Tech Center  
Fort Worth, Texas 76118  
(817) 590-0500  
Fax: (817) 590-0248

IRRIGATION ENGINEER  
IRE & O  
1905 Tech Center  
Dallas, Texas 75243  
(972) 231-3333  
Fax: (972) 231-9172

*R. Hideell*

TITLE  
COMPOSITE PLAN

Revisions

Job No. 41011  
Issue Date: JUNE 26, 2000  
Drawn By: TP, PJ  
Checked By: DC, PL  
Sheet No.

S100

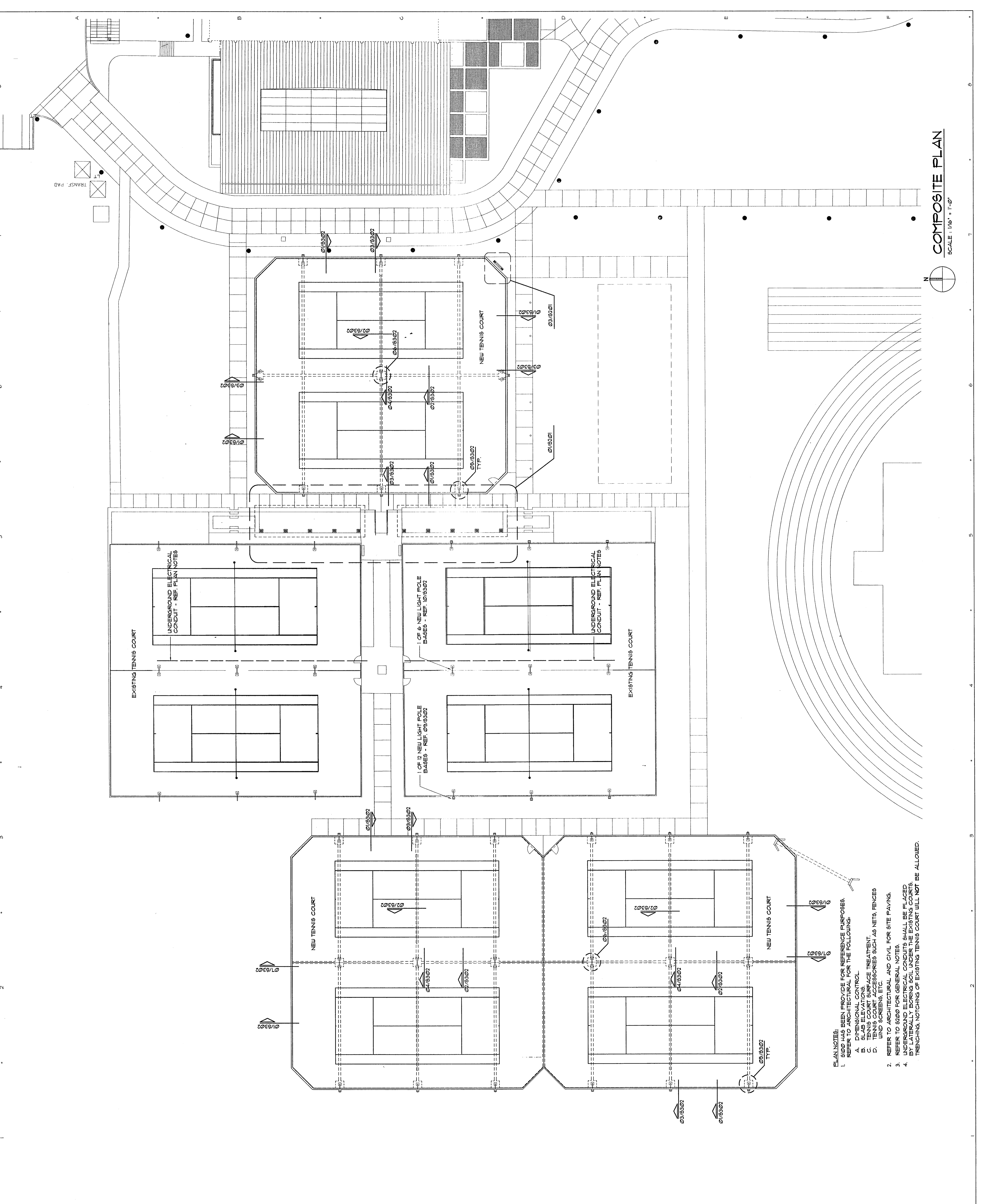

- PLAN NOTES:
1. S100 HAS BEEN PROVIDED FOR REFERENCE PURPOSES. REFER TO ARCHITECTURAL FOR THE FOLLOWING:
    - A. TYPICAL ELEVATIONS
    - B. TYPICAL ELEVATIONS
    - C. TENNIS COURT SURFACE TREATMENT.
    - D. TENNIS COURT ACCESSORIES SUCH AS NETS, FENCES AND SCREENS, ETC.
  2. REFER TO ARCHITECTURAL AND CIVIL FOR SITE PAVING.
  3. REFER TO S100 FOR GENERAL NOTES.
  4. UNDERGROUND ELECTRICAL CONDUITS SHALL BE PLACED BY LATERALLY BORING UNDER EXISTING COURTS BY TRENCHING OF EXISTING TENNIS COURT WILL NOT BE ALLOWED.

COMPOSITE PLAN  
SCALE: 1/16" = 1'-0"

