



Greenhill School
DEASON FAMILY
TENNIS CENTER

HIDELL

ASSOCIATES
ARCHITECTS

3033 KELLAWAY DRIVE, SUITE 120
DUBLIN, OHIO 43017
(614) 412-4888 FAX (614) 412-0189
E-MAIL: hidell@hidell.com

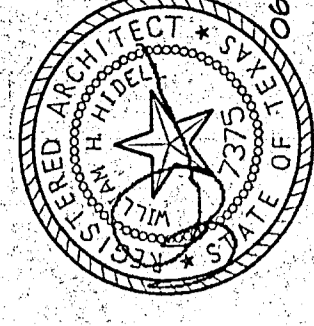

SEAL NO. 0062600

SEAL NO. 0062600

SEAL NO. 0062600

SEAL NO. 0062600

SEAL NO. 0062600

SEAL NO. 0062600

SEAL NO. 0062600

SEAL NO. 0062600

SEAL NO. 0062600

SEAL NO. 0062600

SEAL NO. 0062600

SEAL NO. 0062600

SEAL NO. 0062600

SEAL NO. 0062600

SEAL NO. 0062600

SEAL NO. 0062600

SEAL NO. 0062600

SEAL NO. 0062600

SEAL NO. 0062600

SEAL NO. 0062600

SEAL NO. 0062600

SEAL NO. 0062600

SEAL NO. 0062600

SEAL NO. 0062600

SEAL NO. 0062600

SEAL NO. 0062600

SEAL NO. 0062600

SEAL NO. 0062600

SEAL NO. 0062600

SEAL NO. 0062600

SEAL NO. 0062600

SEAL NO. 0062600

SEAL NO. 0062600

4/27/01

BEI Job # F00040

Title
ELECTRICAL SITE PLAN

Revisions

Job No. 99011
Issue Date: JUNE 26, 2000
Drawn By: M.H. M.T.P.
Checked By: S.B.

Sheet No.

E101

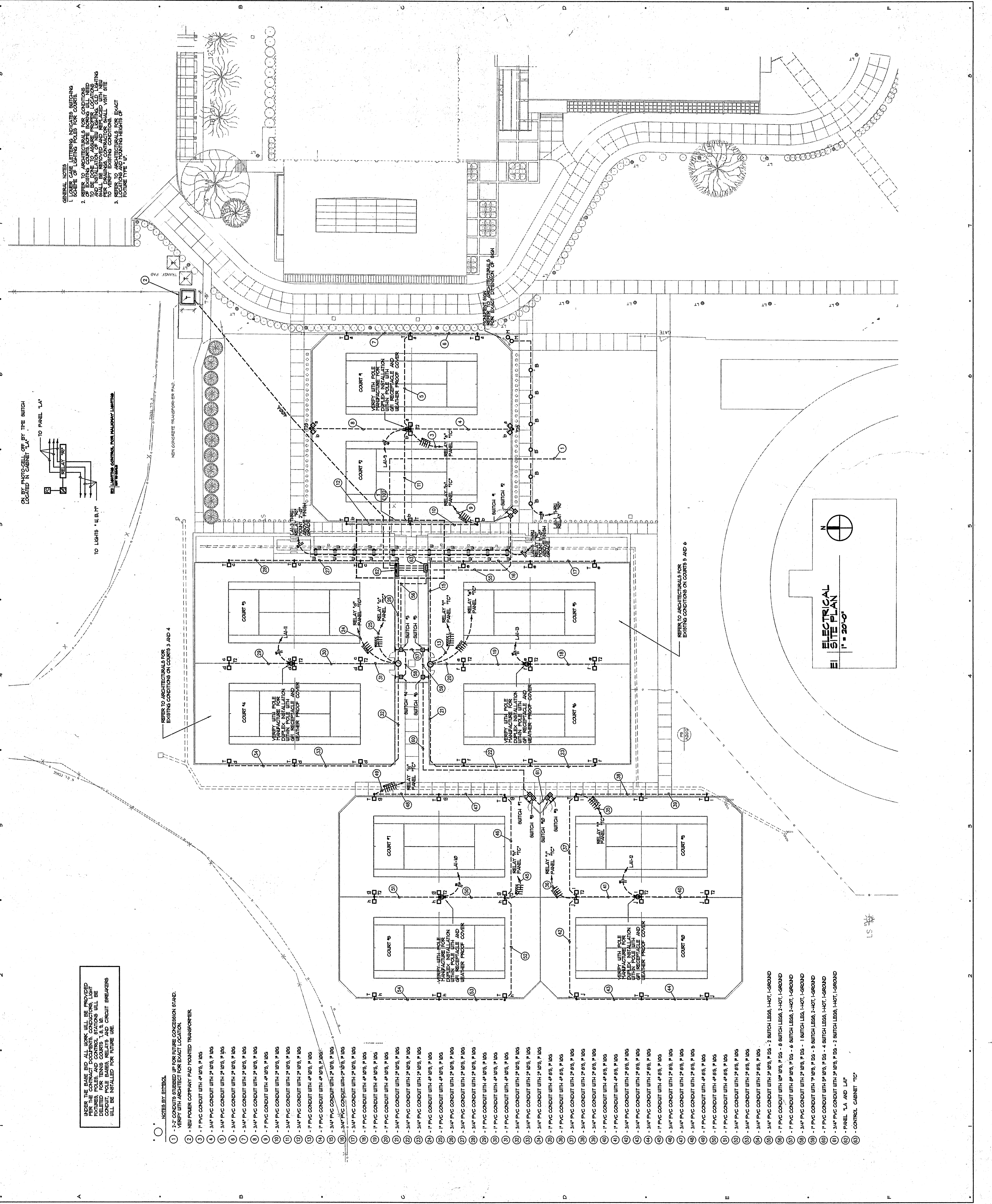

INSURE THE BASE BID ALL WORK WILL BE PROVIDED WITH THE CONTRACT. ALL ELECTRICAL MATERIALS AND CONTROL DEVICES WILL BE PROVIDED BY THE CONTRACTOR. ALL ELECTRICAL MATERIALS AND CONTROL DEVICES WILL BE PROVIDED BY THE CONTRACTOR. ALL ELECTRICAL MATERIALS AND CONTROL DEVICES WILL BE PROVIDED BY THE CONTRACTOR.

NOTES BY SITEWORK

1. 2" PVC CONDUIT WITH 4" 12'S, 1" 12'S
2. NEW POWER COMPANY PAD MOUNTED TRANSFORMER
3. 1" PVC CONDUIT WITH 4" 12'S, 1" 12'S
4. 3/4" PVC CONDUIT WITH 2" 12'S, 1" 12'S
5. 3/4" PVC CONDUIT WITH 2" 12'S, 1" 12'S
6. 3/4" PVC CONDUIT WITH 2" 12'S, 1" 12'S
7. 3/4" PVC CONDUIT WITH 2" 12'S, 1" 12'S
8. 3/4" PVC CONDUIT WITH 2" 12'S, 1" 12'S
9. 1" PVC CONDUIT WITH 4" 12'S, 1" 12'S
10. 3/4" PVC CONDUIT WITH 2" 12'S, 1" 12'S
11. 3/4" PVC CONDUIT WITH 2" 12'S, 1" 12'S
12. 3/4" PVC CONDUIT WITH 2" 12'S, 1" 12'S
13. 1" PVC CONDUIT WITH 4" 12'S, 1" 12'S
14. 1" PVC CONDUIT WITH 4" 12'S, 1" 12'S
15. 3/4" PVC CONDUIT WITH 2" 12'S, 1" 12'S
16. 3/4" PVC CONDUIT WITH 2" 12'S, 1" 12'S
17. 3/4" PVC CONDUIT WITH 2" 12'S, 1" 12'S
18. 1" PVC CONDUIT WITH 4" 12'S, 1" 12'S
19. 1" PVC CONDUIT WITH 4" 12'S, 1" 12'S
20. 3/4" PVC CONDUIT WITH 2" 12'S, 1" 12'S
21. 3/4" PVC CONDUIT WITH 2" 12'S, 1" 12'S
22. 3/4" PVC CONDUIT WITH 2" 12'S, 1" 12'S
23. 3/4" PVC CONDUIT WITH 2" 12'S, 1" 12'S
24. 1" PVC CONDUIT WITH 4" 12'S, 1" 12'S
25. 3/4" PVC CONDUIT WITH 2" 12'S, 1" 12'S
26. 3/4" PVC CONDUIT WITH 2" 12'S, 1" 12'S
27. 3/4" PVC CONDUIT WITH 2" 12'S, 1" 12'S
28. 1" PVC CONDUIT WITH 4" 12'S, 1" 12'S
29. 3/4" PVC CONDUIT WITH 2" 12'S, 1" 12'S
30. 3/4" PVC CONDUIT WITH 2" 12'S, 1" 12'S
31. 1" PVC CONDUIT WITH 4" 12'S, 1" 12'S
32. 3/4" PVC CONDUIT WITH 2" 12'S, 1" 12'S
33. 3/4" PVC CONDUIT WITH 2" 12'S, 1" 12'S
34. 3/4" PVC CONDUIT WITH 2" 12'S, 1" 12'S
35. 1" PVC CONDUIT WITH 4" 12'S, 1" 12'S
36. 3/4" PVC CONDUIT WITH 2" 12'S, 1" 12'S
37. 3/4" PVC CONDUIT WITH 2" 12'S, 1" 12'S
38. 3/4" PVC CONDUIT WITH 2" 12'S, 1" 12'S
39. 3/4" PVC CONDUIT WITH 2" 12'S, 1" 12'S
40. 1" PVC CONDUIT WITH 4" 12'S, 1" 12'S
41. 3/4" PVC CONDUIT WITH 2" 12'S, 1" 12'S
42. 3/4" PVC CONDUIT WITH 2" 12'S, 1" 12'S
43. 3/4" PVC CONDUIT WITH 2" 12'S, 1" 12'S
44. 3/4" PVC CONDUIT WITH 2" 12'S, 1" 12'S
45. 1" PVC CONDUIT WITH 4" 12'S, 1" 12'S
46. 3/4" PVC CONDUIT WITH 2" 12'S, 1" 12'S
47. 3/4" PVC CONDUIT WITH 2" 12'S, 1" 12'S
48. 3/4" PVC CONDUIT WITH 2" 12'S, 1" 12'S
49. 1" PVC CONDUIT WITH 4" 12'S, 1" 12'S
50. 3/4" PVC CONDUIT WITH 2" 12'S, 1" 12'S
51. 3/4" PVC CONDUIT WITH 2" 12'S, 1" 12'S
52. 3/4" PVC CONDUIT WITH 2" 12'S, 1" 12'S
53. 3/4" PVC CONDUIT WITH 2" 12'S, 1" 12'S
54. 3/4" PVC CONDUIT WITH 2" 12'S, 1" 12'S
55. 3/4" PVC CONDUIT WITH 2" 12'S, 1" 12'S
56. 3/4" PVC CONDUIT WITH 2" 12'S, 1" 12'S
57. 3/4" PVC CONDUIT WITH 2" 12'S, 1" 12'S
58. 3/4" PVC CONDUIT WITH 2" 12'S, 1" 12'S
59. 3/4" PVC CONDUIT WITH 2" 12'S, 1" 12'S
60. 3/4" PVC CONDUIT WITH 2" 12'S, 1" 12'S

CONTROL CABINET 'C'