

CONSTRUCTION PLANS FOR GREENHILL SCHOOL DEASON FAMILY TENNIS CENTER

FOR

HIDELL ASSOCIATES
3033 Kellway Drive, Suite 120
Carrollton, Texas 75006
Ph. (972) 416-4666

OWNER/DEVELOPER

GREENHILL SCHOOL
14255 Midway Road
Dallas, Texas 75224
Ph. (972) 661-1211

PREPARED BY

 **Pacheco Koch Consulting Engineers**
9401 LBJ FREEWAY SUITE 300 DALLAS, TEXAS 75243 972.235.3031

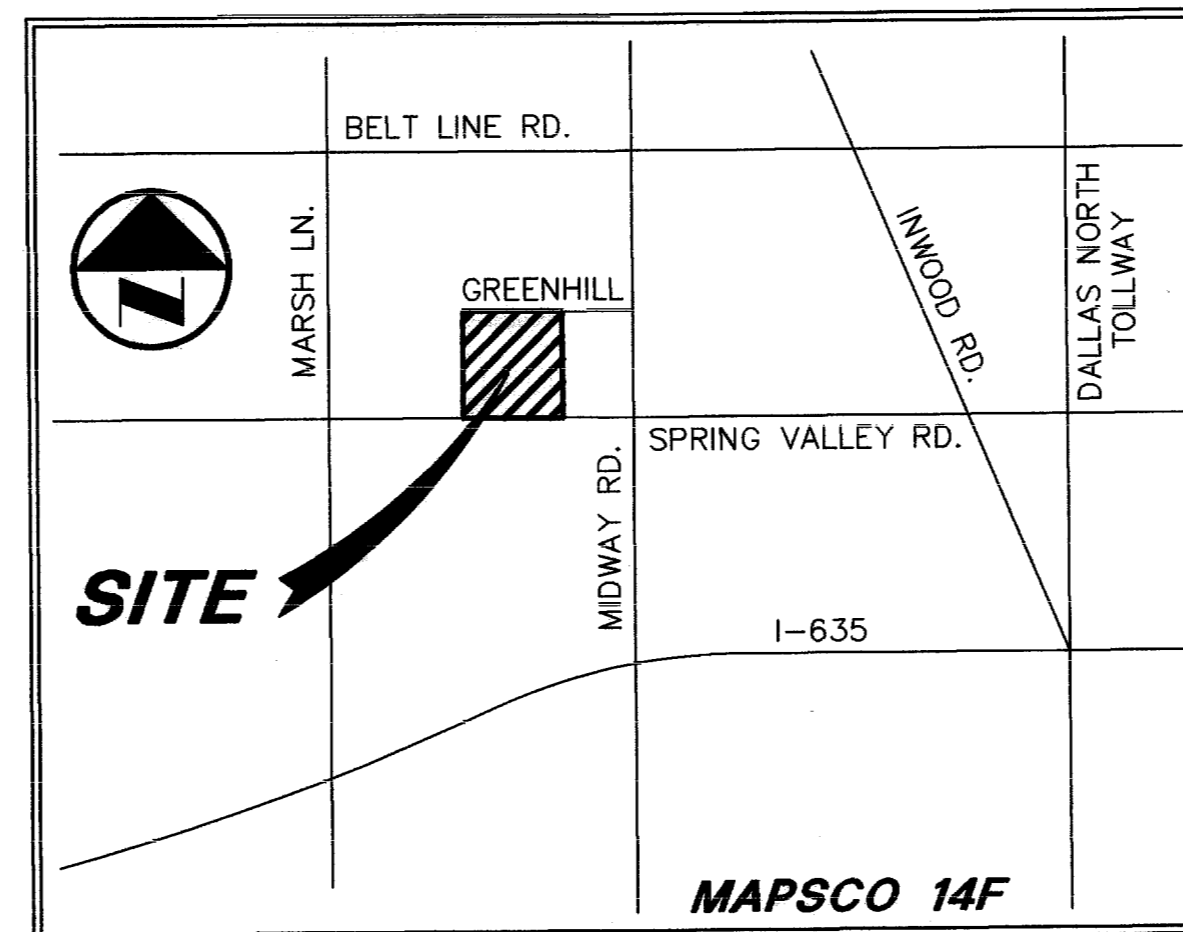

VICINITY MAP

DRAWING SHEET INDEX

SHEET	DESCRIPTION
C1.0	DIMENSIONAL CONTROL PLAN
C2.0	GRADING PLAN
C3.0	DRAINAGE PLAN
C4.0	WATER RELOCATION PLAN
C5.0	EROSION CONTROL PLAN

RECORD DRAWING

THIS DRAWING HAS BEEN REVISED TO REFLECT CONSTRUCTION RECORDS MAINTAINED AND PROVIDED BY THE CONTRACTOR FOR THIS PROJECT.
CONTRACTOR: *Australian Courtworks, Inc.*
DATE REVISED: 03/20/2001



THE SEAL APPEARING ON THIS DOCUMENT WAS AUTHORIZED BY STEVEN A. MARKUSSEN P.E. 70090 ON 06/28/00. ALTERATION OF A SEALED DOCUMENT WITHOUT PROPER NOTIFICATION TO THE RESPONSIBLE ENGINEER IS AN OFFENSE UNDER THE TEXAS ENGINEERING PRACTICE ACT.

△ REVISED 03/22/2001

GREENHILL SCHOOL ADDITION
(VOL. 98032, PG. 0003)

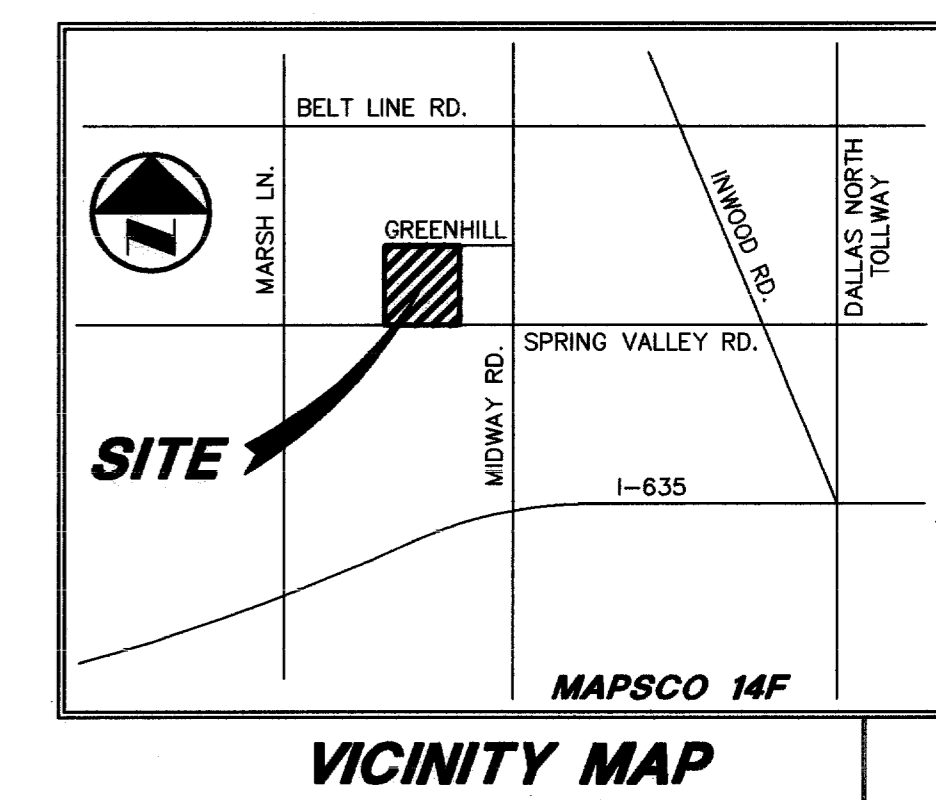
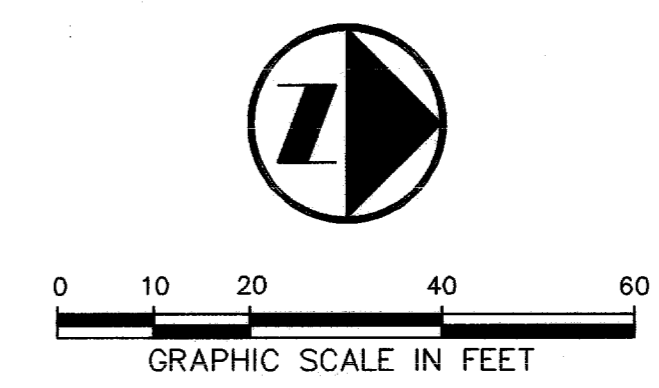

LEGEND

B	BOLLARD
EM	ELECTRIC METER
PP	POWER POLE
LS	LIGHT STANDARD
WM	WATER METER
WV	WATER VALVE
ICV	IRRIGATION CONTROL VALVE
FH	FIRE HYDRANT
CO	CLEANOUT
MH	MANHOLE
GM	GAS METER
TSC	TRAFFIC SIGNAL CONTROL
TSP	TRAFFIC SIGNAL POLE
TELE	TELEPHONE BOX
TV	TV BOX
FP	FLAG POLE
---	PROPERTY LINE
---	O.H. POWER LINES
---	U/G TELEPHONE LINES
---	U/G WATER LINE
---	U/G GAS LINE
---	FENCE

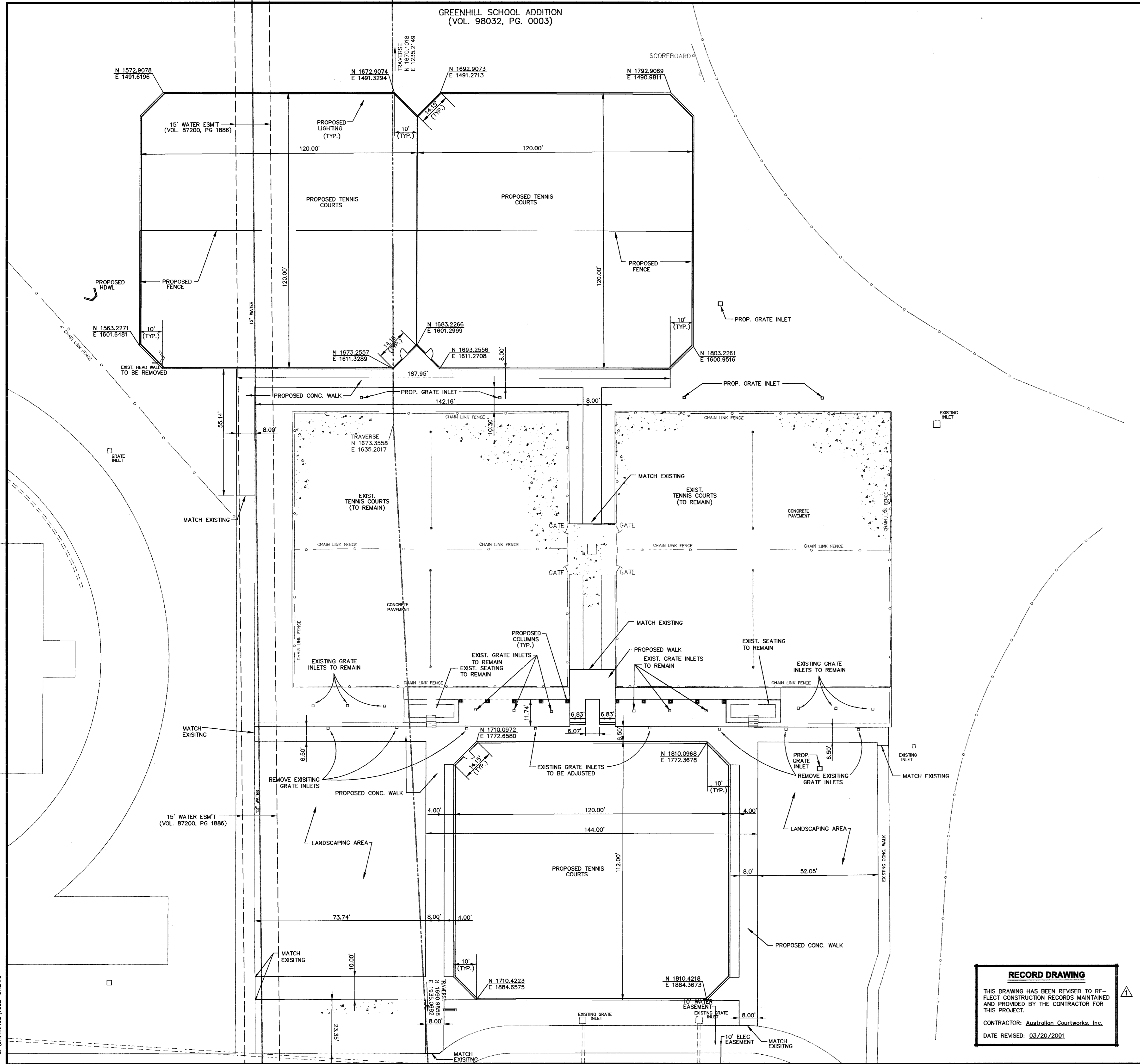

GENERAL NOTES

- ALL WORK, UNLESS OTHERWISE NOTED, SHALL CONFORM TO THE STANDARD SPECIFICATIONS FOR PUBLIC WORKS CONSTRUCTION, ISSUED BY THE NORTH CENTRAL TEXAS COUNCIL OF GOVERNMENT, AND CITY OF ADDISON STANDARD CONSTRUCTION SPECIFICATIONS.
- PRIOR TO ANY CONSTRUCTION, THE CONTRACTOR SHALL BE FAMILIAR WITH THE PLANS, INCLUDING ALL NOTES, THE STANDARD SPECIFICATIONS FOR PUBLIC WORKS CONSTRUCTION NORTH CENTRAL TEXAS AND THE CITY STANDARDS FOR CONSTRUCTION AND ANY OTHER APPLICABLE STANDARD AND SPECIFICATIONS RELEVANT TO THE PROPER COMPLETION OF THE WORK SPECIFIED. FAILURE ON THE PART OF THE CONTRACTOR TO BE FAMILIAR WITH ALL STANDARDS AND SPECIFICATION PERTAINING TO THIS WORK SHALL IN NO WAY RELIEVE THE CONTRACTOR OF RESPONSIBILITY OF PERFORMING THE WORK IN ACCORDANCE WITH ALL SUCH APPLICABLE STANDARDS AND SPECIFICATIONS.
- THE HORIZONTAL AND VERTICAL LOCATIONS OF EXISTING SUBSURFACE UTILITIES HAVE BEEN DETERMINED FROM DATA RECORDED BY OTHERS. CONTRACTOR SHALL VERIFY THAT NECESSARY CROSSING CLEARANCES BETWEEN EXISTING AND PROPOSED UTILITIES EXIST PRIOR TO CONSTRUCTION OF ANY SUCH CROSSING. IT WILL BE THE RESPONSIBILITY OF THE CONTRACTOR TO PROTECT ALL UTILITIES IN THE CONSTRUCTION OF THIS PROJECT. CONTRACTOR TO VERIFY SIZE AND LOCATION OF ALL UTILITIES PRIOR TO CONSTRUCTION.
- IT WILL BE THE RESPONSIBILITY OF THE CONTRACTOR TO PROTECT ALL MANHOLES, CLEANOUTS, VALVE BOXES, FIRE HYDRANTS, ETC., THEY MUST BE ADJUSTED TO PROPER LINE, AND GRADE BY THE CONTRACTOR PRIOR TO AND AFTER THE PLACING OF PERMANENT PAVING AND GRADING. UTILITIES MUST BE MAINTAINED TO PROPER LINE AND GRADE DURING THE CONSTRUCTION OF THE PAVING FOR THIS DEVELOPMENT.
- 5.1 MAINTAIN NORMAL PROJECT DRAINAGE UNTIL NEW DRAINAGE FACILITIES ARE FUNCTIONAL, INCLUDING, WHERE NECESSARY, INTERIM REPLACEMENT OF EXISTING DRAINAGE STRUCTURES REMOVED FOR CONSTRUCTION OF NEW DRAINAGE FACILITIES.
5.2 MAINTAIN ALL WORK AND MATERIAL STORAGE AREAS IN ORDERLY CONDITION, FREE OF DEBRIS AND WASTE; ON COMPLETION OF CONSTRUCTION, CLEAN UP THE PROJECT AND ADJACENT AFFECTED AREAS TO ACCEPTABLE CONDITION, ALL AS PROVIDED IN THE GENERAL CONDITIONS.
- PRIOR TO COMMENCEMENT OF CONSTRUCTION, BONDS AND THREE-WAY CONTRACTS SHALL BE SUBMITTED TO THE CITY AS REQUIRED.
- THE CONTRACTOR IS RESPONSIBLE FOR COMPLIANCE WITH ALL FEDERAL, STATE AND LOCAL REGULATIONS REGARDING TRENCH SAFETY.
- REFER TO ARCHITECTURAL PLANS FOR DETAILED DIMENSIONS, LAYOUTS, RAMPS, RETAINING WALLS AND SIDEWALKS. DIMENSIONS SHOWN ON THESE PLANS ARE FOR REFERENCE ONLY.
- BARRICADING AND PROJECT SIGNS SHALL CONFORM TO TEXAS DEPARTMENT OF TRANSPORTATION MANUAL OF UNIFORM TRAFFIC CONTROL DEVICES AND LATEST UPDATES.

REVISED 03/22/2001

Pacheco Koch Consulting Engineers
9401 LBJ FREEWAY SUITE 300 DALLAS, TEXAS 75243 972.235.3031

DIMENSIONAL CONTROL PLAN
GREENHILL SCHOOL
DEASON FAMILY TENNIS COMPLEX
DALLAS COUNTY

CITY OF ADDISON, TEXAS

DESIGN	DRAWN	DATE	SCALE	NOTES	FILE	NO.
SAM	RRL	JUNE 26 2000	1"=20'			C-1.0

RECORD DRAWING
THIS DRAWING HAS BEEN REVISED TO REFLECT CONSTRUCTION RECORDS MAINTAINED AND PROVIDED BY THE CONTRACTOR FOR THIS PROJECT.
CONTRACTOR: **Australian Courtworks, Inc.**
DATE REVISED: **03/20/2001**



THE SEAL APPEARING ON THIS DOCUMENT WAS AUTHORIZED BY STEVEN A. MARKUSSEN P.E. 70990 ON 03/26/00. ALTERATION OF A SEALED DOCUMENT WITHOUT PROPER NOTIFICATION TO THE RESPONSIBLE ENGINEER IS AN OFFENSE UNDER THE TEXAS ENGINEERING PRACTICE ACT.

03/22/2001 - 2:28PM
C:\DRAWINGS\1082-61.DWG

GREENHILL SCHOOL ADDITION
(VOL. 98032, PG. 0003)

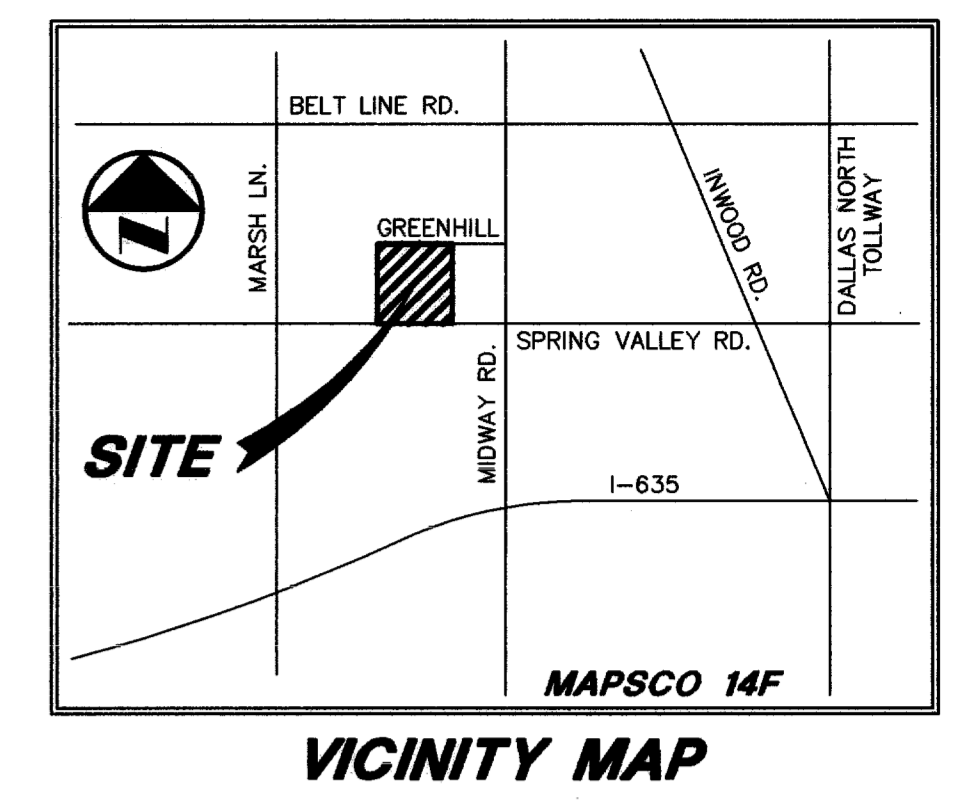
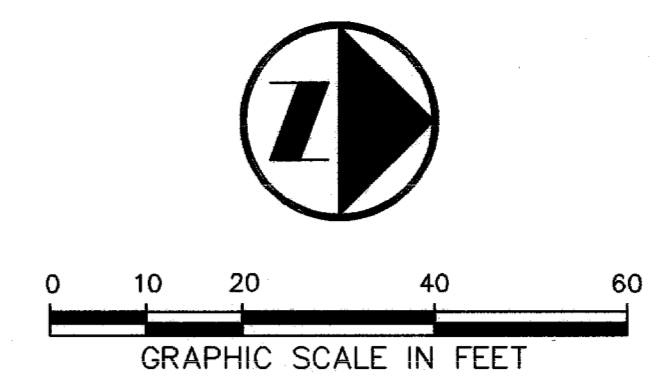

LEGEND

B	BOLLARD
EM	ELECTRIC METER
PP	POWER POLE
LS	LIGHT STANDARD
WM	WATER METER
WV	WATER VALVE
ICV	IRRIGATION CONTROL VALVE
FH	FIRE HYDRANT
CQ	CLEANOUT
MH	MANHOLE
GM	GAS METER
TSC	TRAFFIC SIGNAL CONTROL
TSP	TRAFFIC SIGNAL POLE
TELE	TELEPHONE BOX
TV	TV BOX
FP	FLAG POLE
---	PROPERTY LINE
OHL	O.H. POWER LINES
TEL	U/G TELEPHONE LINES
W	U/G WATER LINE
G	U/G GAS LINE
- - -	FENCE

GRADING AND DRAINAGE GENERAL NOTES

- REFER TO GEOTECHNICAL REPORT FOR REQUIREMENTS REGARDING FILL COMPACTION AND MOISTURE CONTENT.
- UNLESS NOTED, ALL FILL IS TO BE COMPACTED TO A MINIMUM OF 95% STANDARD PROCTOR DENSITY WITHIN 3% OF OPTIMUM MOISTURE CONTENT. FILL TO BE PLACED IN A MAXIMUM OF 6" LIFTS.
- ALL WALKS TO HAVE A MAXIMUM CROSS SLOPE OF 2%.
- UNLESS NOTED, STORM DRAIN LINES MAY BE OF THE FOLLOWING MATERIALS:
 - RCP C-76, CLASS III
 - ADS N-12
 - HANCOR HI-Q
 AND INSTALLED IN ACCORDANCE WITH MANUFACTURER'S SPECIFICATIONS.
- UNLESS NOTED, GRATE INLET TO BE "AMERICAN INDUSTRIAL PRE-CAST PRODUCTS, INC." PRECAST CATCH BASIN, SIZED AS SHOWN, OF APPROVED EQUAL.
- FINAL PAVING, CURB AND SIDEWALK ELEVATIONS WILL BE PLACED AT PLUS OR MINUS 0.03 FOOT.
- REFER TO LANDSCAPE SPECIFICATION FOR SEEDING AND SODDING REQUIREMENTS.
- ANY CONCRETE, ROCK OR MATERIAL DEEMED UNSUITABLE FOR SUBGRADE, BY ENGINEER, SHALL BE DISPOSED OF OFFSITE AT CONTRACTOR'S EXPENSE.
- TRENCH BACKFILL MATERIAL SHALL CONFORM TO THE REQUIREMENTS OF NCTCOG ITEM 6.2.10, AND SHALL BE MECHANICALLY COMPACTED IN ACCORDANCE WITH NCTCOG ITEM 6.2.9 TO A MINIMUM OF 95% STANDARD PROCTOR DENSITY UNLESS OTHERWISE SHOWN ON THESE PLANS OR STATED IN THE STANDARD CITY SPECIFICATIONS.
- EMBEDMENT SHALL CONFORM TO THE REQUIREMENTS OF NCTCOG ITEM 6.2.9 UNLESS OTHERWISE SHOWN ON THESE PLANS OR STATED IN THE STANDARD CITY SPECIFICATIONS.
- ALL CONCRETE FOR INLETS AND DRAINAGE STRUCTURES SHALL CONFORM TO NCTCOG ITEM 7.4.5, CLASS "A" UNLESS OTHERWISE SHOWN ON THESE PLANS OR STATED IN STANDARD CITY SPECIFICATIONS.
- CRUSHED STONE BEDDING OR APPROVED EQUAL SHALL BE PROVIDED BY THE CONTRACTOR WHEN ROCK IS ENCOUNTERED IN TRENCHES. THERE SHALL BE NO ADDITIONAL PAY ITEM OF THE CRUSHED STONE BEDDING.
- IF REQUIRED DUE TO CONSTRUCTION, POWER POLES TO BE BRACED OR RELOCATED AT CONTRACTORS EXPENSE.
- EXCESS DIRT FROM ON-SITE GRADING IS TO REMAIN ON-SITE AND BE PLACED ALONG THE WESTERN PROPERTY LINE AS DESIGNATED BY THE PROJECT ARCHITECT.

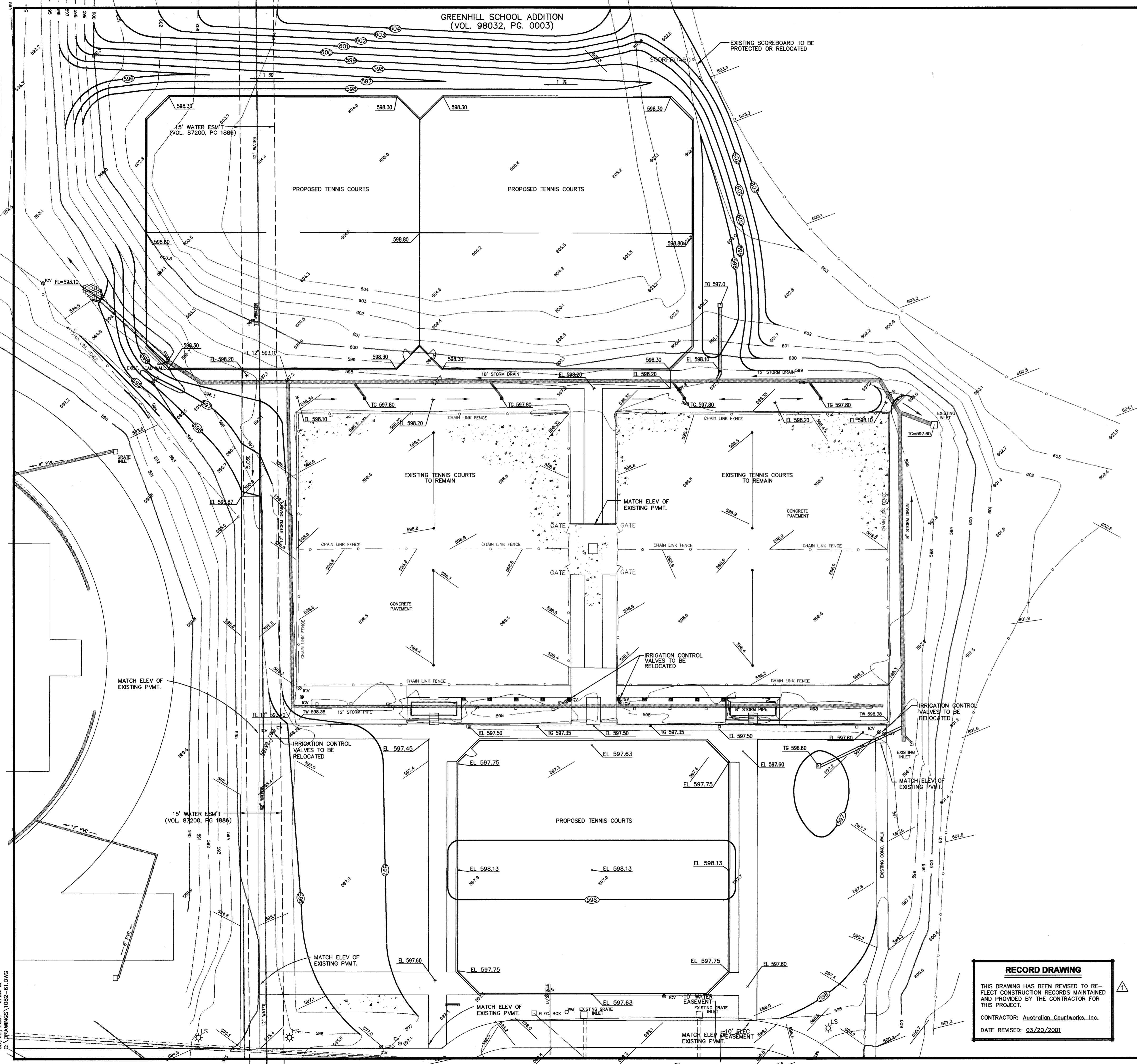

RECORD DRAWING

THIS DRAWING HAS BEEN REVISED TO REFLECT CONSTRUCTION RECORDS MAINTAINED AND PROVIDED BY THE CONTRACTOR FOR THIS PROJECT.

CONTRACTOR: *Austrailian Courtworks, Inc.*

DATE REVISED: 03/20/2001



THE SEAL APPEARING ON THIS DOCUMENT WAS AUTHORIZED BY STEVEN A. MARKUSSEN P.E. 70090 ON 03/25/00. ALTERATION OF A SEALED DOCUMENT WITHOUT PROPER NOTIFICATION TO THE RESPONSIBLE ENGINEER IS AN OFFENSE UNDER THE TEXAS ENGINEERING PRACTICE ACT.

REVISED 03/22/2001

Pacheco Koch Consulting Engineers
9401 LBJ FREEWAY SUITE 300 DALLAS, TEXAS 75243 972.235.3031

GRADING PLAN
GREENHILL SCHOOL
DEASON FAMILY TENNIS COMPLEX
DALLAS COUNTY
CITY OF ADDISION, TEXAS

DESIGN	DRAWN	DATE	SCALE	NOTES	FILE	NO.
SAM	RRL	JUNE 26 2000	1"=20'			C-2.0

PK FILE: 1082-99.151 DWG FILE: 1082-61.DWG

UN: JLV/AN
03/22/2001 - 2:29PM
C:\DRAWINGS\1082-61.DWG

GREENHILL SCHOOL ADDITION
(VOL. 98032, PG. 0003)

- ① CONNECT TO EXIST. 12" DRAIN PIPE
INSTALL:
40 L.F. 6" DRAIN PIPE
1 - No. 14 GRATE INLET
TG = 596.60
FL 8" = 595.10
- ② EXISTING GRATES TO BE RAISED
4 INCHES
- ③ EXISTING GRATES TO BE REMOVED
AND DRAIN LATERALS CAPPED
- ④ CONNECT TO EXIST. 18" DRAIN PIPE
INSTALL:
32 L.F. 12" DRAIN PIPE
1 - No. 20 GRATE INLET
TG = 597.00
FL 12" = 595.00
- ⑤ CONNECT TO EXIST. 15" OR 18" DRAIN PIPE
INSTALL:
7.5 L.F. 6" DRAIN PIPE
1 - No. 12 GRATE INLET
TG = 597.80
FL 12" = 596.90

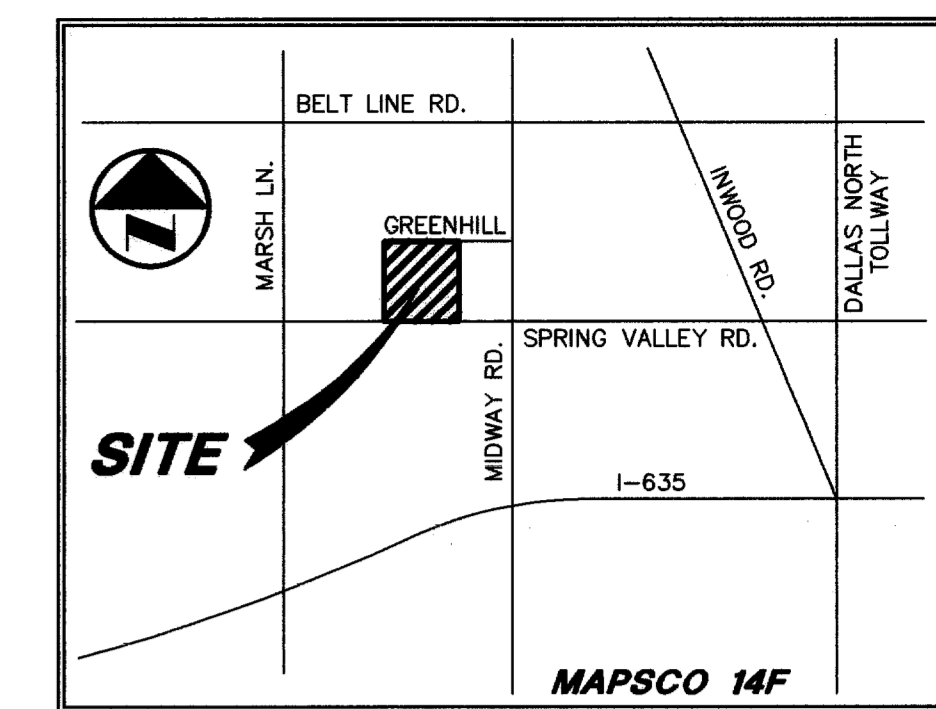
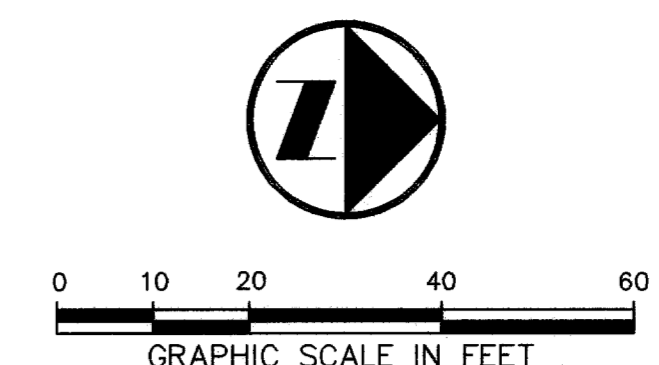

LEGEND

B	BOLLARD
EM	ELECTRIC METER
PP	POWER POLE
LS	LIGHT STANDARD
WM	WATER METER
WV	WATER VALVE
ICV	IRRIGATION CONTROL VALVE
FH	FIRE HYDRANT
CS	CLEANOUT
MH	MANHOLE
GM	GAS METER
TSC	TRAFFIC SIGNAL CONTROL
TSP	TRAFFIC SIGNAL POLE
TELE	TELEPHONE BOX
TV	TV BOX
FP	FLAG POLE
---	PROPERTY LINE
OH	O.H. POWER LINES
TEL	U/G TELEPHONE LINES
W	U/G WATER LINE
G	U/G GAS LINE
- - -	FENCE

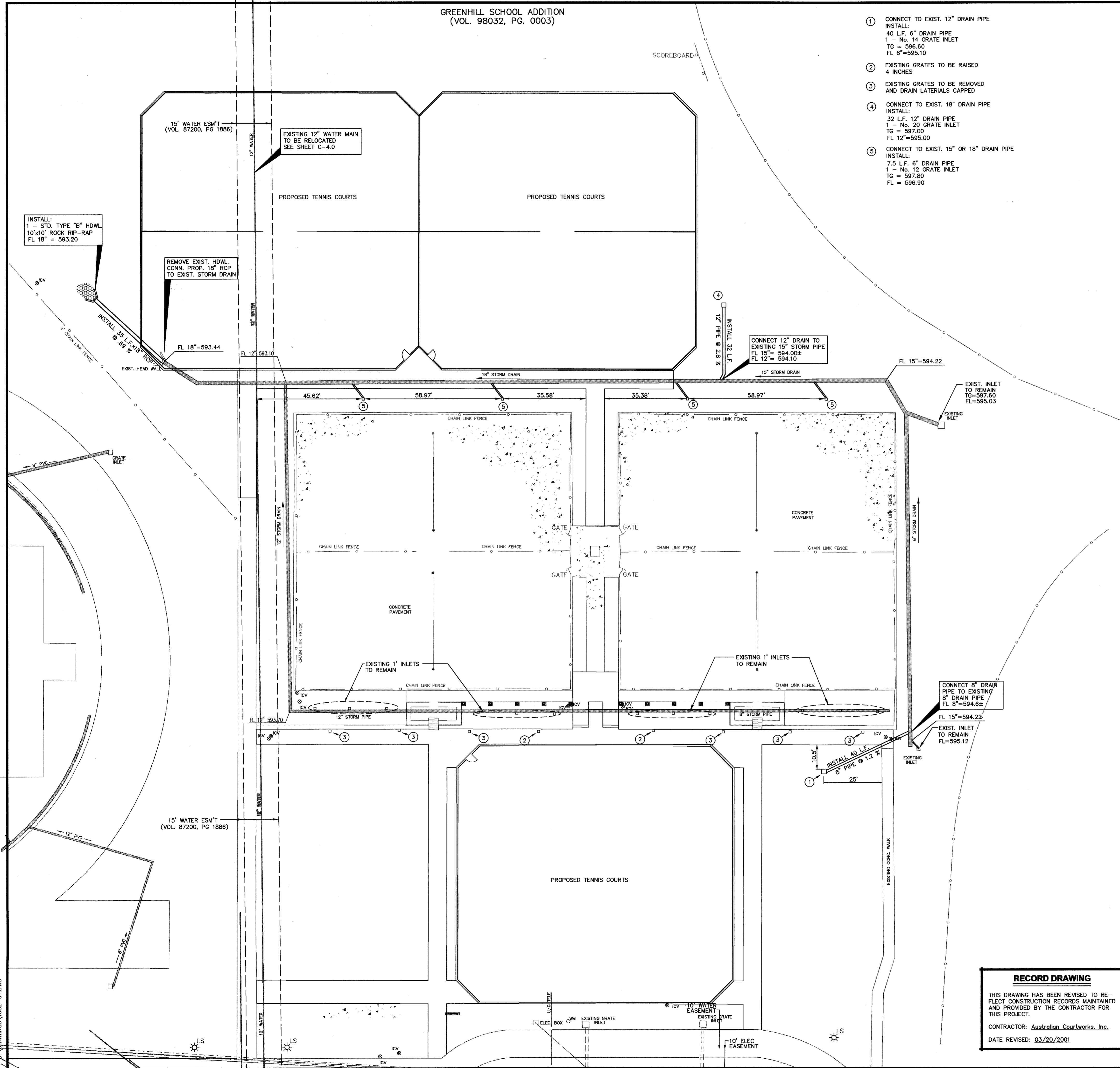

GRADING AND DRAINAGE GENERAL NOTES

1. REFER TO GEOTECHNICAL REPORT FOR REQUIREMENTS REGARDING FILL COMPACTION AND MOISTURE CONTENT.
2. UNLESS NOTED, ALL FILL IS TO BE COMPACTED TO A MINIMUM OF 95% STANDARD PROCTOR DENSITY WITHIN 3% OF OPTIMUM MOISTURE CONTENT. FILL TO BE PLACED IN A MAXIMUM OF 6" LIFTS.
3. ALL WALKS TO HAVE A MAXIMUM CROSS SLOPE OF 2%.
4. UNLESS NOTED, STORM DRAIN LINES MAY BE OF THE FOLLOWING MATERIALS:
A. RCP C-76, CLASS III
B. ADS N-12
C. HANCOR HI-Q
AND INSTALLED IN ACCORDANCE WITH MANUFACTURER'S SPECIFICATIONS.
5. UNLESS NOTED, GRATE INLET TO BE "AMERICAN INDUSTRIAL PRE-CAST PRODUCTS, INC." PRECAST CATCH BASIN, SIZED AS SHOWN, OF APPROVED EQUAL.
6. FINAL PAVING, CURB AND SIDEWALK ELEVATIONS WILL BE PLACED AT PLUS OR MINUS 0.03 FOOT.
7. REFER TO LANDSCAPE SPECIFICATION FOR SEEDING AND SODDING REQUIREMENTS.
8. ANY CONCRETE, ROCK OR MATERIAL DEEMED UNSUITABLE FOR SUBGRADE, BY ENGINEER, SHALL BE DISPOSED OF OFFSITE AT CONTRACTOR'S EXPENSE.
9. TRENCH BACKFILL MATERIAL SHALL CONFORM TO THE REQUIREMENTS OF NCTCOG ITEM 6.2.10, AND SHALL BE MECHANICALLY COMPACTED IN ACCORDANCE WITH NCTCOG ITEM 6.2.9 TO A MINIMUM OF 95% STANDARD PROCTOR DENSITY UNLESS OTHERWISE SHOWN ON THESE PLANS OR STATED IN THE STANDARD CITY SPECIFICATIONS.
10. EMBEDMENT SHALL CONFORM TO THE REQUIREMENTS OF NCTCOG ITEM 6.2.9 UNLESS OTHERWISE SHOWN ON THESE PLANS OR STATED IN THE STANDARD CITY SPECIFICATIONS.
11. ALL CONCRETE FOR INLETS AND DRAINAGE STRUCTURES SHALL CONFORM TO NCTCOG ITEM 7.4.5, CLASS "A" UNLESS OTHERWISE SHOWN ON THESE PLANS OR STATED IN STANDARD CITY SPECIFICATIONS.
12. CRUSHED STONE BEDDING OR APPROVED EQUAL SHALL BE PROVIDED BY THE CONTRACTOR WHEN ROCK IS ENCOUNTERED IN TRENCHES. THERE SHALL BE NO ADDITIONAL PAY ITEM OF THE CRUSHED STONE BEDDING.
13. IF REQUIRED DUE TO CONSTRUCTION, POWER POLES TO BE BRACED OR RELOCATED AT CONTRACTORS EXPENSE.
14. EXCESS DIRT FROM ON-SITE GRADING IS TO REMAIN ONSITE AND BE PLACED ALONG THE WESTERN PROPERTY LINE AS DESIGNATED BY THE PROJECT ARCHITECT.

REVISD 03/22/2001

Pacheco Koch Consulting Engineers
9401 LBJ FREEWAY SUITE 300 DALLAS, TEXAS 75243 972.235.3031

DRAINAGE PLAN
GREENHILL SCHOOL
DEASON FAMILY TENNIS COMPLEX
DALLAS COUNTY
CITY OF ADDISION, TEXAS

DESIGN	DRAWN	DATE	SCALE	NOTES	FILE	NO.
SAM	RRL	JUNE 26 2000	1"=20'			C-3.0



THE SEAL APPEARING ON THIS DOCUMENT WAS AUTHORIZED BY STEVEN A. MARKUSSEN P.E. 70090 ON 05/26/00. ALTERATION OF A SEALED DOCUMENT WITHOUT PROPER NOTIFICATION TO THE RESPONSIBLE ENGINEER IS AN OFFENSE UNDER THE TEXAS ENGINEERING PRACTICE ACT.

RECORD DRAWING
THIS DRAWING HAS BEEN REVISED TO REFLECT CONSTRUCTION RECORDS MAINTAINED AND PROVIDED BY THE CONTRACTOR FOR THIS PROJECT.
CONTRACTOR: *Australian Courtworks, Inc.*
DATE REVISED: 03/20/2001

11/10/2000 - 2:00PM
 C:\DRAWINGS\1082-61.DWG

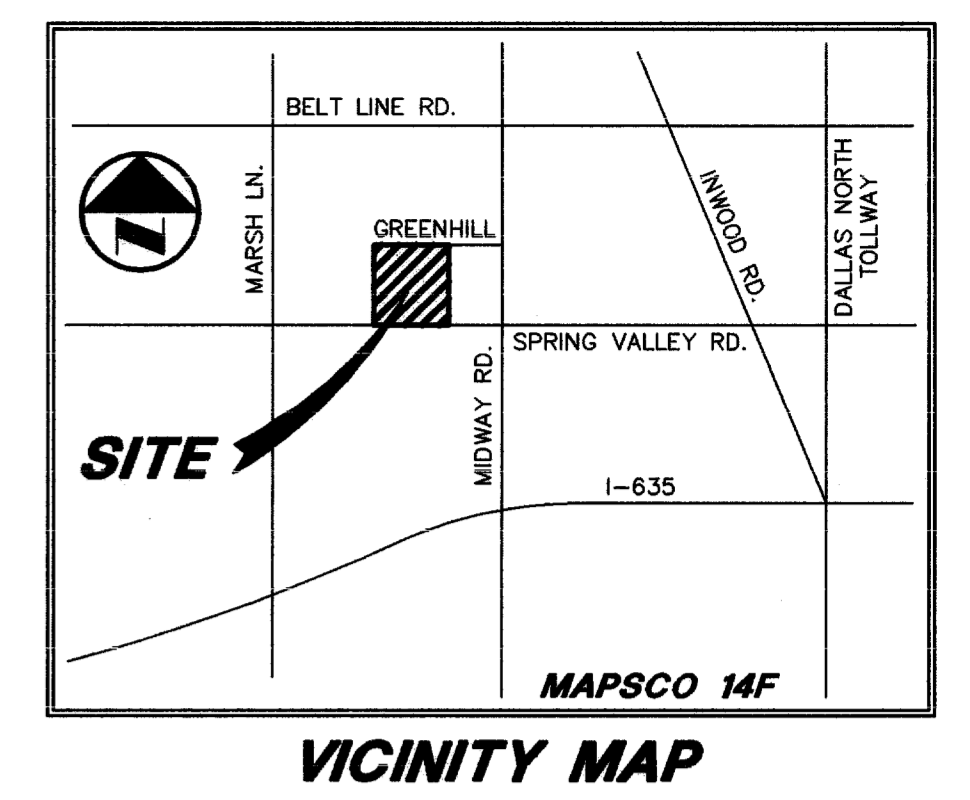
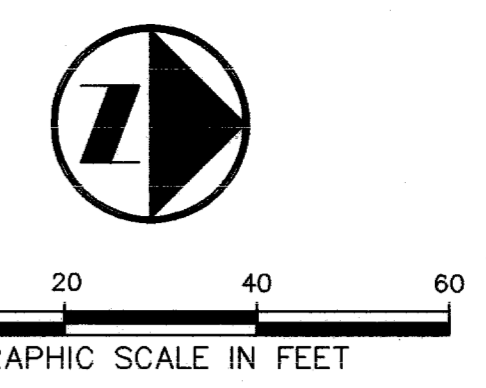
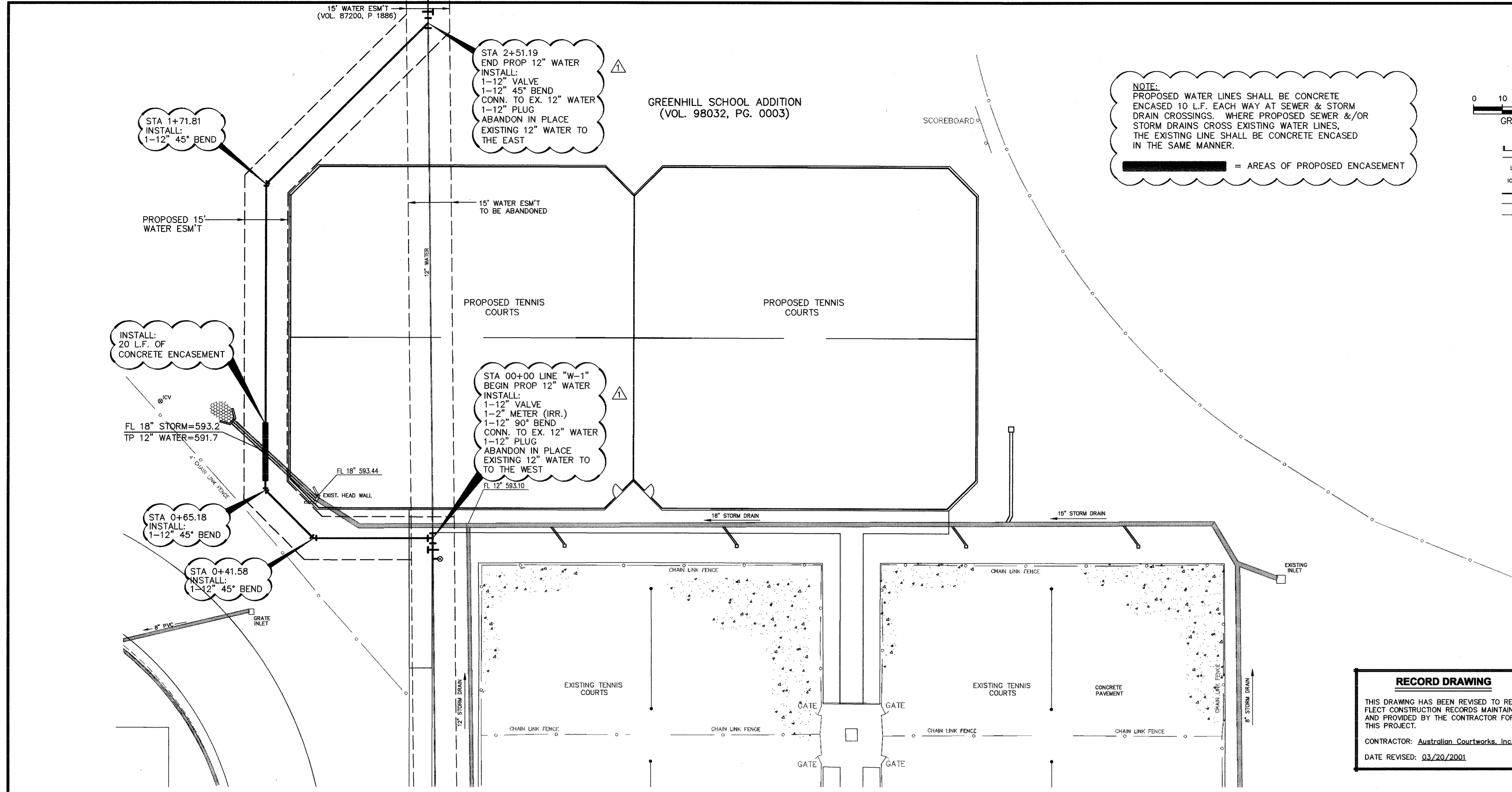

LEGEND

LS	LIGHT STANDARD
ICV	IRRIGATION CONTROL VALVE
---	PROPERTY LINE
---	U/G WATER LINE
---	FENCE

NOTE:
 PROPOSED WATER LINES SHALL BE CONCRETE ENCASED 10 L.F. EACH WAY AT SEWER & STORM DRAIN CROSSINGS. WHERE PROPOSED SEWER &/OR STORM DRAINS CROSS EXISTING WATER LINES, THE EXISTING LINE SHALL BE CONCRETE ENCASED IN THE SAME MANNER.

WATER AND SANITARY SEWER GENERAL NOTES

1. ALL WORK, UNLESS OTHERWISE NOTED, SHALL CONFORM TO THE STANDARD SPECIFICATIONS FOR PUBLIC WORKS CONSTRUCTION, ISSUED BY THE NORTH CENTRAL TEXAS COUNCIL OF GOVERNMENTS, AND TOWN OF ADDISON STANDARD CONSTRUCTION SPECIFICATIONS.
2. UNLESS OTHERWISE NOTED, ALL CONCRETE SHALL BE CLASS "A", (3000 PSI).
3. THE HORIZONTAL AND VERTICAL LOCATIONS OF EXISTING SUBSURFACE UTILITIES HAVE BEEN DETERMINED FROM DATA RECORDED BY OTHERS. CONTRACTOR SHALL VERIFY THAT NECESSARY CROSSING CLEARANCES BETWEEN EXISTING AND PROPOSED UTILITIES EXIST PRIOR TO CONSTRUCTION OF ANY SUCH CROSSING. IT WILL BE THE RESPONSIBILITY OF THE CONTRACTOR TO PROTECT ALL PUBLIC UTILITIES IN THE CONSTRUCTION OF THIS PROJECT.
4. CONTRACTOR SHALL MAINTAIN ONE SET OF "RECORD DRAWINGS" ON SITE WHICH WILL BE SUBMITTED TO OWNER OR ENGINEER UPON COMPLETION OF THE PROJECT. RECORD DRAWINGS SHALL INDICATE THE LOCATION OF ALL SUBTERRANEAN UTILITY IMPROVEMENTS, AND INDICATE TIES TO ALL MANHOLES, CULVERTS, INLETS, JUNCTION BOXES, ETC.
5. ALL WATER MAINS SHALL BE DUCTILE IRON CLASS 51 WITH CATHODIC PROTECTION OR PVC C900, DR 18, CLASS 150.
6. ALL WATER MAINS UNLESS OTHERWISE NOTED SHALL HAVE A MINIMUM COVER OF 48" BELOW FINISHED GRADE.
7. THE CONTRACTOR IS RESPONSIBLE FOR COMPLIANCE WITH ALL FEDERAL, STATE AND LOCAL REGULATIONS REGARDING TRENCH SAFETY.
8. BARRICADING AND PROJECT SIGNS SHALL CONFORM TO "STATE DEPARTMENT OF HIGHWAYS AND PUBLIC TRANSPORTATION BARRICADING AND CONSTRUCTION STANDARDS."
9. PRIOR TO COMMENCEMENT OF CONSTRUCTION, BONDS AND THREE-WAY CONTRACTS SHALL BE SUBMITTED TO THE CITY AS REQUIRED.

RECORD DRAWING
 THIS DRAWING HAS BEEN REVISED TO REFLECT CONSTRUCTION RECORDS MAINTAINED AND PROVIDED BY THE CONTRACTOR FOR THIS PROJECT.
 CONTRACTOR: Australian Courtworks, Inc.
 DATE REVISED: 03/20/2001

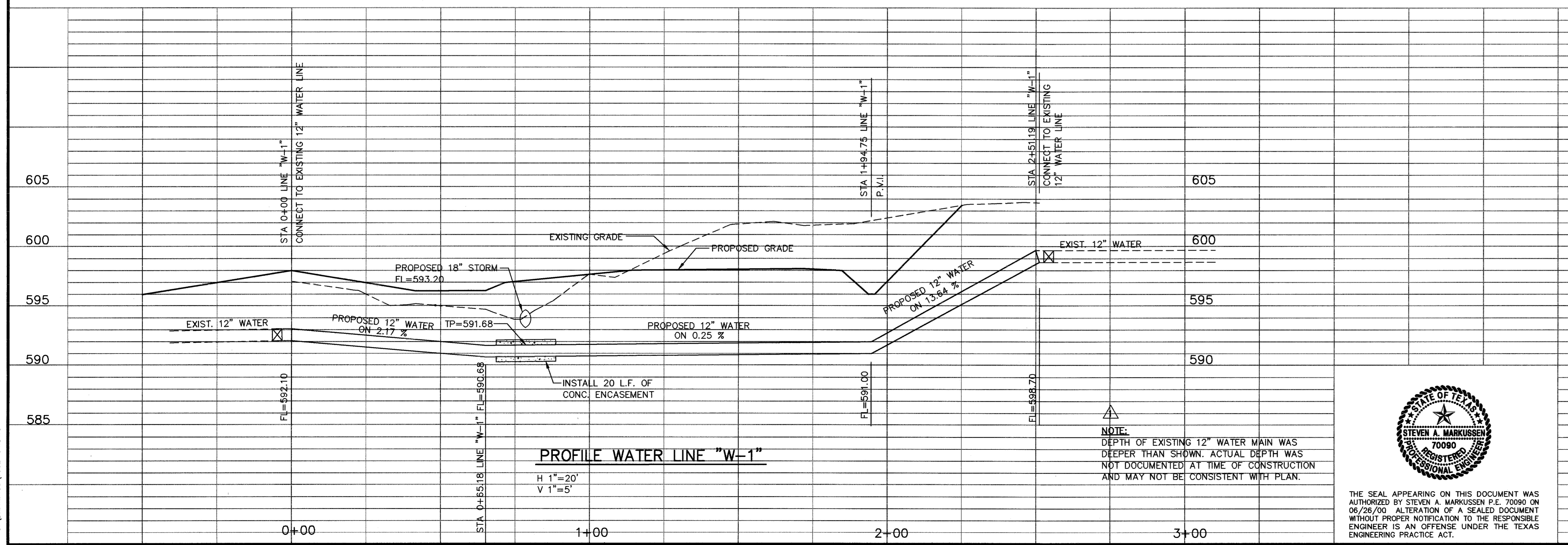

PROFILE WATER LINE "W-1"
 H 1"=20'
 V 1"=5'

NOTE:
 DEPTH OF EXISTING 12" WATER MAIN WAS DEEPER THAN SHOWN. ACTUAL DEPTH WAS NOT DOCUMENTED AT TIME OF CONSTRUCTION AND MAY NOT BE CONSISTENT WITH PLAN.



THE SEAL APPEARING ON THIS DOCUMENT WAS AUTHORIZED BY STEVEN A. MARKUSSEN P.E. 70090 ON 06/26/00. ALTERATION OF A SEALED DOCUMENT WITHOUT PROPER NOTIFICATION TO THE RESPONSIBLE ENGINEER IS AN OFFENSE UNDER THE TEXAS ENGINEERING PRACTICE ACT.

REVISED 03/22/2001

Pacheco Koch Consulting Engineers
 9401 LBJ FREEWAY SUITE 300 DALLAS, TEXAS 75243 972.235.3031

WATER RELOCATION PLAN
GREENHILL SCHOOL
DEASON FAMILY TENNIS COMPLEX
DALLAS COUNTY
 CITY OF ADDISON, TEXAS

DESIGN	DRAWN	DATE	SCALE	NOTES	FILE	NO.
SAM	RRL	JUNE 26 2000	1"=20' 1"=4'			C-4.0

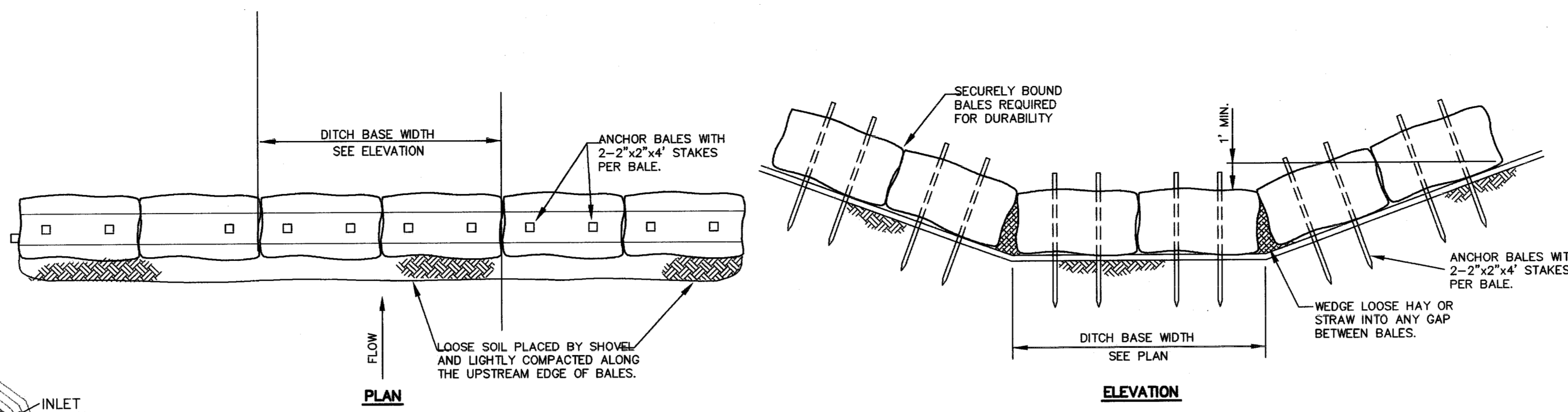
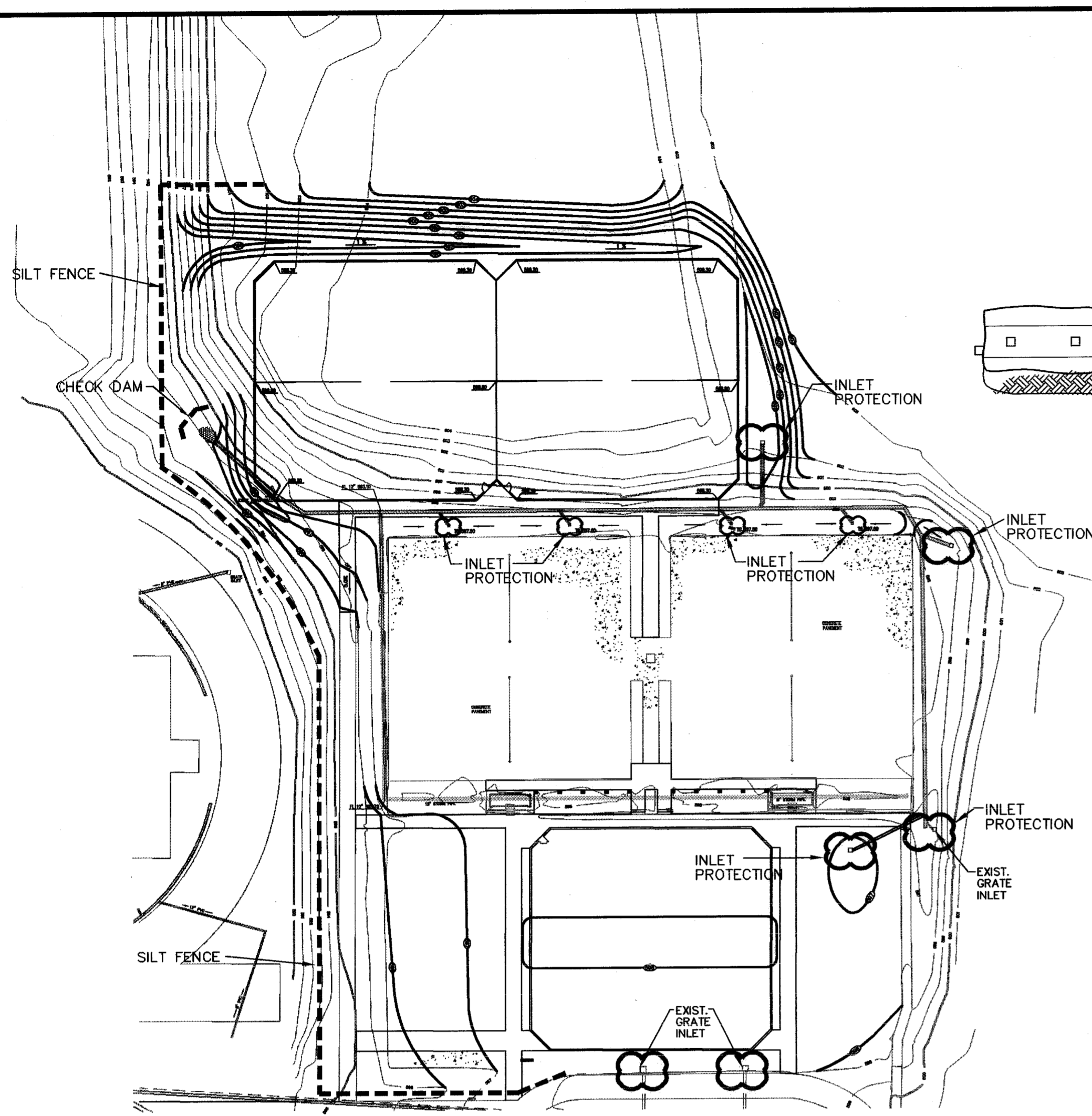

1 Hay or Straw Check Dam
NOT TO SCALE

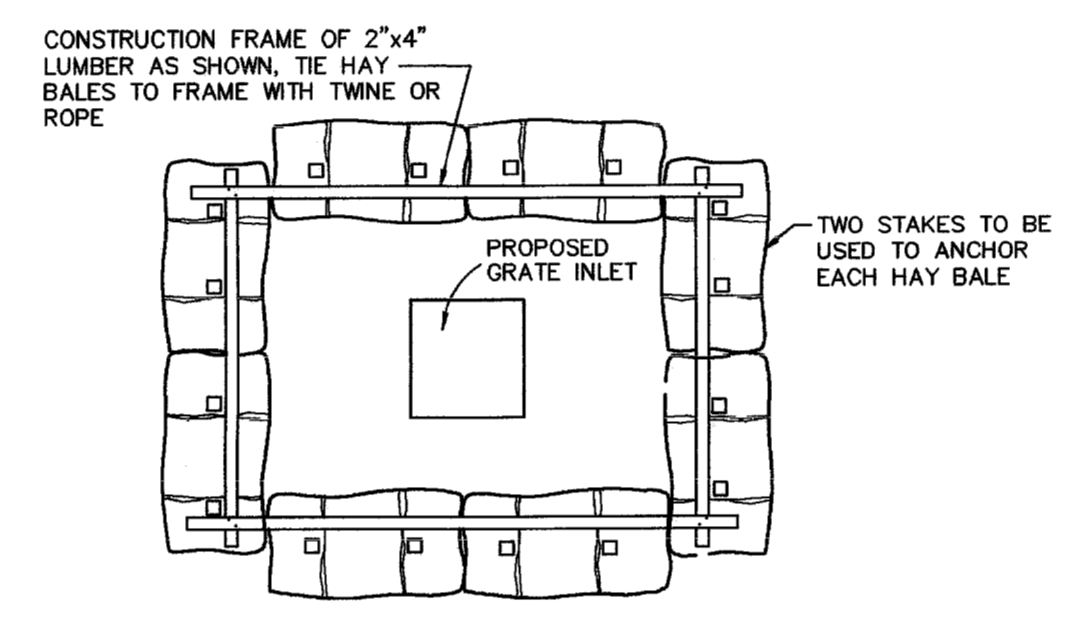

NOTE: HAY BALE OR SILT FENCE SEDIMENT BARRIER TO BE USED AROUND INLETS AND OTHER OPENINGS INTO DRAINAGE SYSTEMS THROUGHOUT CONSTRUCTION

2 Grate Inlet Protection
NOT TO SCALE

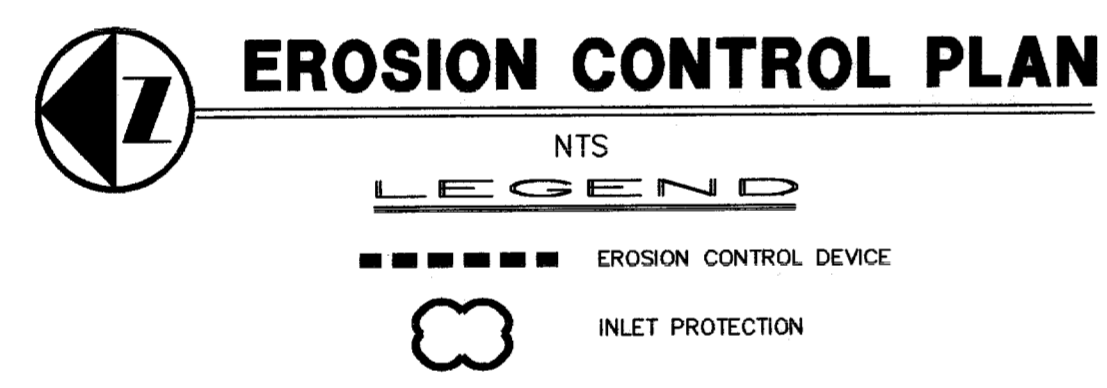

EROSION CONTROL PLAN

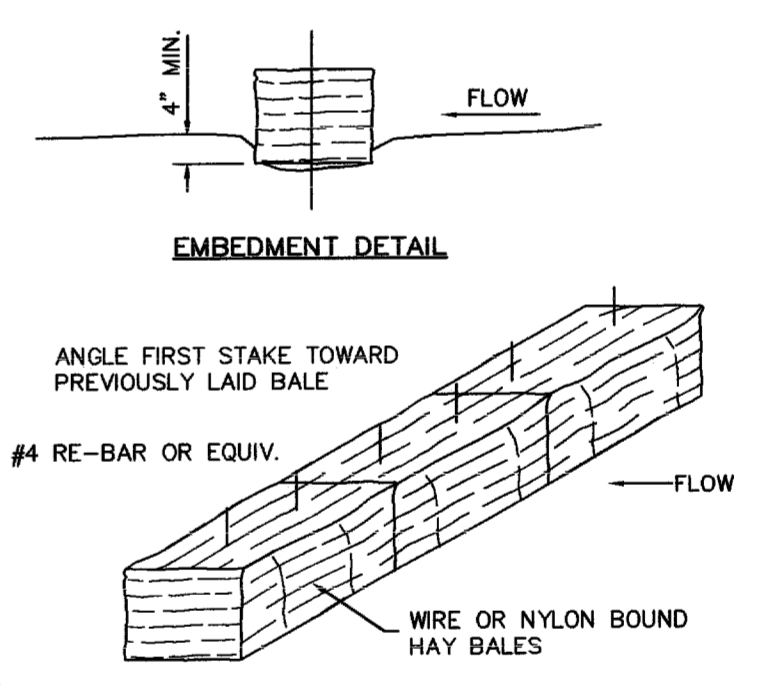

ANCHORING DETAIL
EROSION CONTROL DETAIL:
1. DURING THE CONSTRUCTION PERIOD, THE CONTRACTOR SHALL PROVIDE AND MAINTAIN HAY BALE CHECK DAMS PER THE DETAIL, IN THE AREAS INDICATED ON THE GRADING PLAN AND ANY OTHER AREAS AS DIRECTED BY THE ENGINEER.
2. THE CONTRACTOR SHALL PROVIDE AND MAINTAIN HAY BALES AROUND ANY OPENINGS INTO THE STORM SEWER SYSTEM UNTIL THE PROJECT IS COMPLETED.

6 Anchoring Detail
NOT TO SCALE

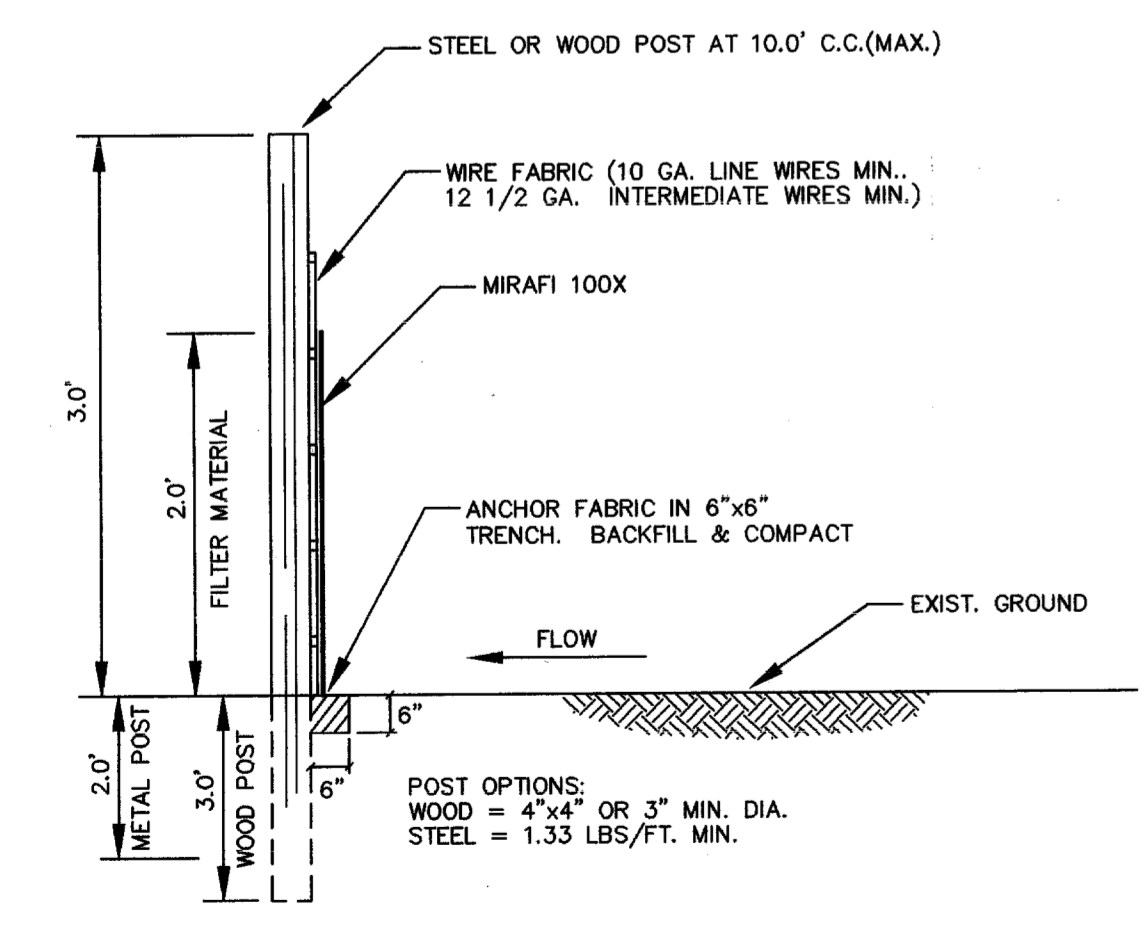

3 HIGH FLOW SILT FENCE DETAIL
NOT TO SCALE

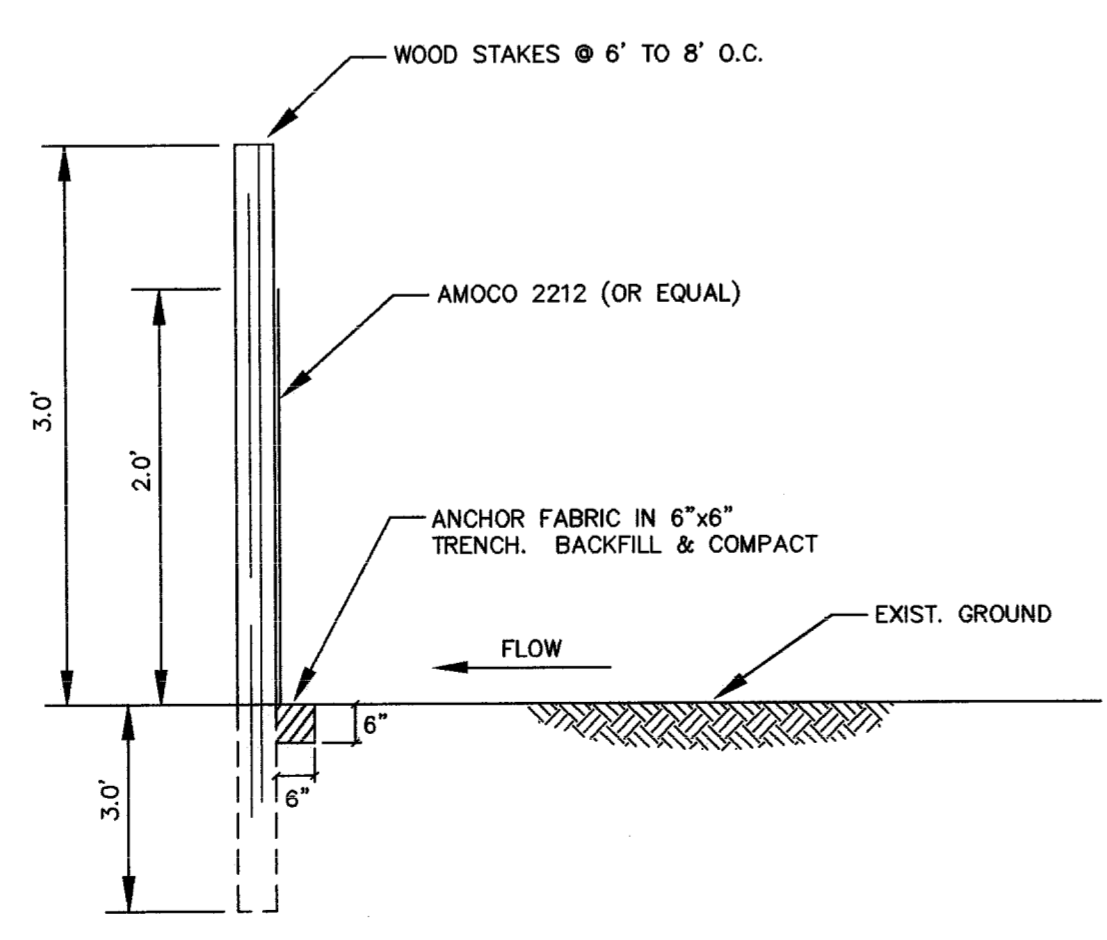

4 Low Flow Silt Fence Detail
NOT TO SCALE

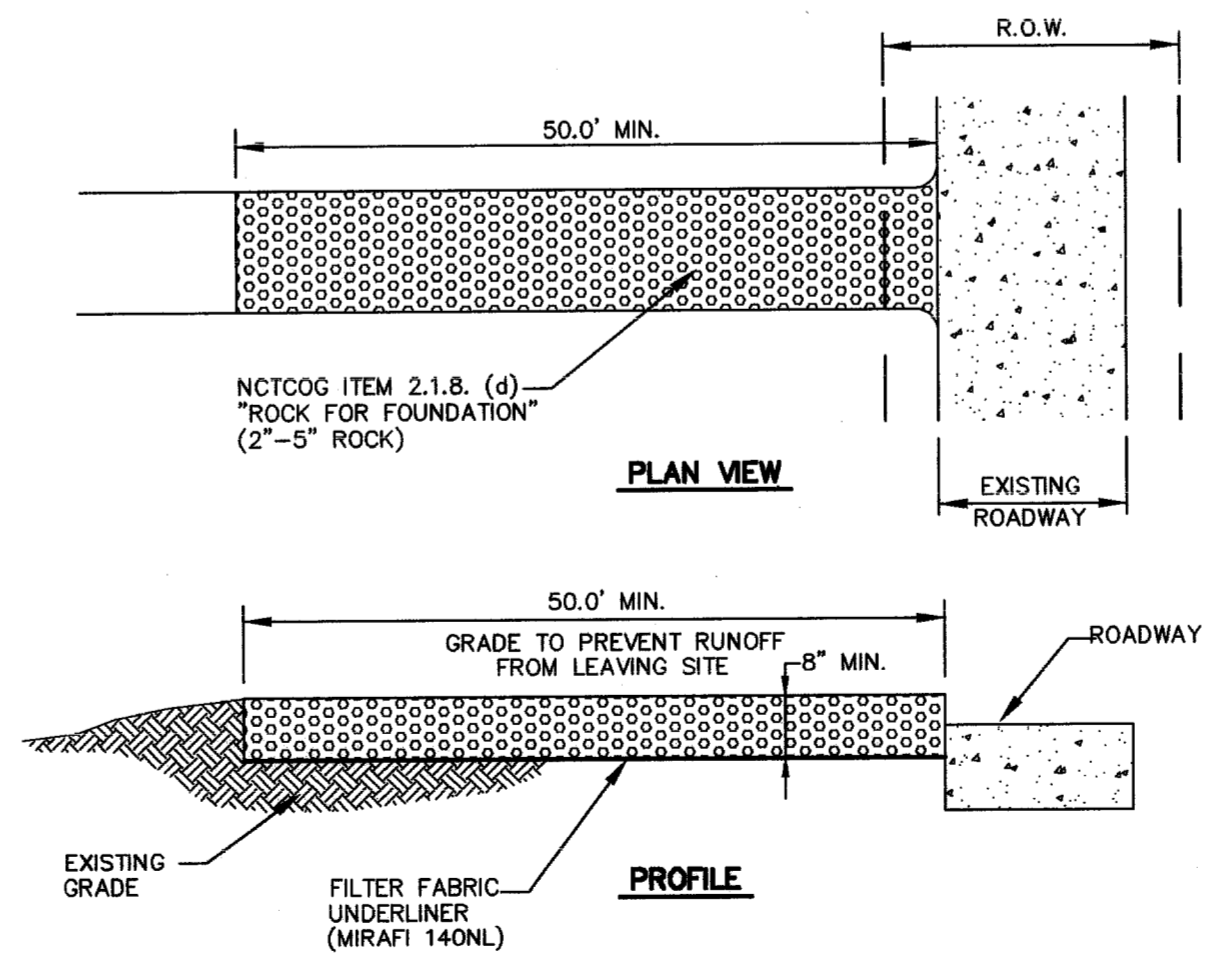

5 Construction Entrance
NOT TO SCALE

RECORD DRAWING
THIS DRAWING HAS BEEN REVISED TO REFLECT CONSTRUCTION RECORDS MAINTAINED AND PROVIDED BY THE CONTRACTOR FOR THIS PROJECT.
CONTRACTOR: *Australian Courtworks, Inc.*
DATE REVISED: 03/20/2001



THE SEAL APPEARING ON THIS DOCUMENT WAS AUTHORIZED BY STEVEN A. MARKUSSEN P.E. 70080 ON 06/26/00. ALTERATION OF A SEALED DOCUMENT WITHOUT PROPER NOTIFICATION TO THE RESPONSIBLE ENGINEER IS AN OFFENSE UNDER THE TEXAS ENGINEERING PRACTICE ACT.

POLLUTION CONTROL GENERAL NOTES

- This plan has been prepared to provide means to prevent or minimize pollution of storm water.
- The construction activity included in this plan will include:
 - Clearing and Grubbing
 - Rough Grading
 - Final Grading
 - Pavement Installation
- The total estimated land area to be disturbed is approx. 2.0 acres.
- The estimated runoff coefficient upon completion of the project is 0.8.
- The storm water exiting the site is collected in an existing drainage system maintained by the City of Addison, Texas.
- The soils on the site are generally expansive clays.
- The contractor shall provide and maintain erosion protection around the work area perimeter and at all inlet mouths prior to commencing work and until the work area has been stabilized.
- The contractor will remove all excess soil from construction vehicles prior to exiting the site.
- All disturbed areas which will not be re-disturbed for a minimum of 21 days must be stabilized by the contractor to control erosion.
- The contractor shall undertake proper methods to reduce dust generation from the site.
- The contractor must comply with Federal, State and Local Regulations regarding sediment and erosion control.
- A copy of this plan must be kept at the construction facility during the entire construction period.
- All finished grades are to be hydromulched, spot sodded or seeded and watered until growth is established on and off-site.
- A pit or wash out basin shall be constructed on-site by the contractor for the "wash out" of concrete trucks.
- A berm or other spill protection measure shall be used for any temporary fuel storage tank on site.
- If "sump" pumps are used to remove water from excavated areas, filter the discharge to remove sediment and other pollutants before the water leaves the site.
- Vehicle parking areas, staging areas, stockpiles, spoils, etc. shall be located such that they will not adversely affect storm water quality. Otherwise, covering or encircling the areas with protective measures shall be necessary.
- Store all trash and building materials waste in an enclosure until proper disposal at off-site facilities.
- Erosion control devices in southwest drainage channel is to remain in effect until construction is complete and a natural vegetation state has occurred.
- All disturbed areas are to have grass established prior to final acceptance by the owner.
- A stabilized construction entrance shall be installed by the contractor at the ingress and egress point for the site.

REVISED 03/22/2001

Pacheco Koch Consulting Engineers
9401 LBJ FREEWAY SUITE 300 DALLAS, TEXAS 75243 972.235.3031

EROSION CONTROL PLAN
GREENHILL SCHOOL
TENNIS COMPLEX
DALLAS COUNTY
CITY OF ADDISON, TEXAS

DESIGN	DRAWN	DATE	SCALE	NOTES	FILE	NO.
SAM	WMH	JUNE 26 2000	1"=50'			C-5.0

MOD. TIME: 06/23/2000 11:22 AM PLOT BY: jmh MAB:at
 PLOT TIME: 06/23/2000 11:21 AM
 DWG NAME: 1082-99.dwg