

GREENHILL SCHOOL ADDITION  
(VOL. 98032, PG. 0003)

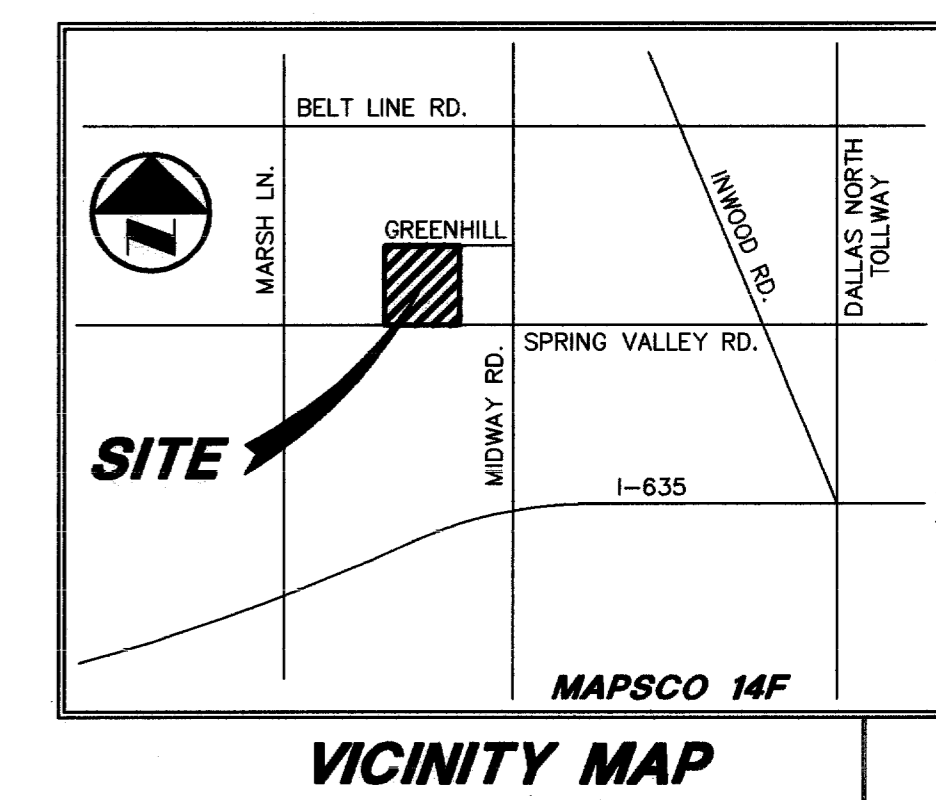

**LEGEND**

B	BOLLARD
EM	ELECTRIC METER
PP	POWER POLE
LS	LIGHT STANDARD
WM	WATER METER
WV	WATER VALVE
ICV	IRRIGATION CONTROL VALVE
FH	FIRE HYDRANT
CO	CLEANOUT
MH	MANHOLE
GM	GAS METER
TSC	TRAFFIC SIGNAL CONTROL
TSP	TRAFFIC SIGNAL POLE
TELE	TELEPHONE BOX
TV	TV BOX
FP	FLAG POLE
---	PROPERTY LINE
---	O.H. POWER LINES
---	U/G TELEPHONE LINES
---	U/G WATER LINE
---	U/G GAS LINE
---	FENCE

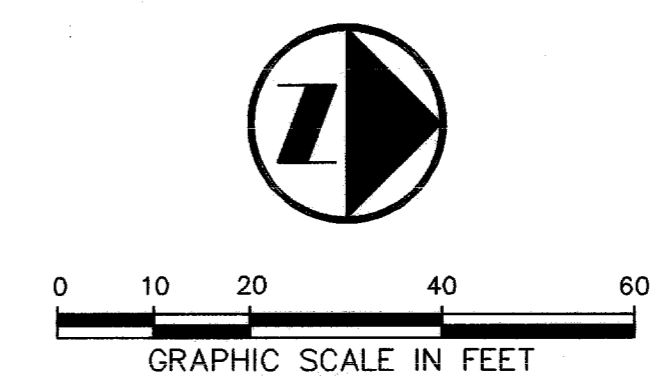
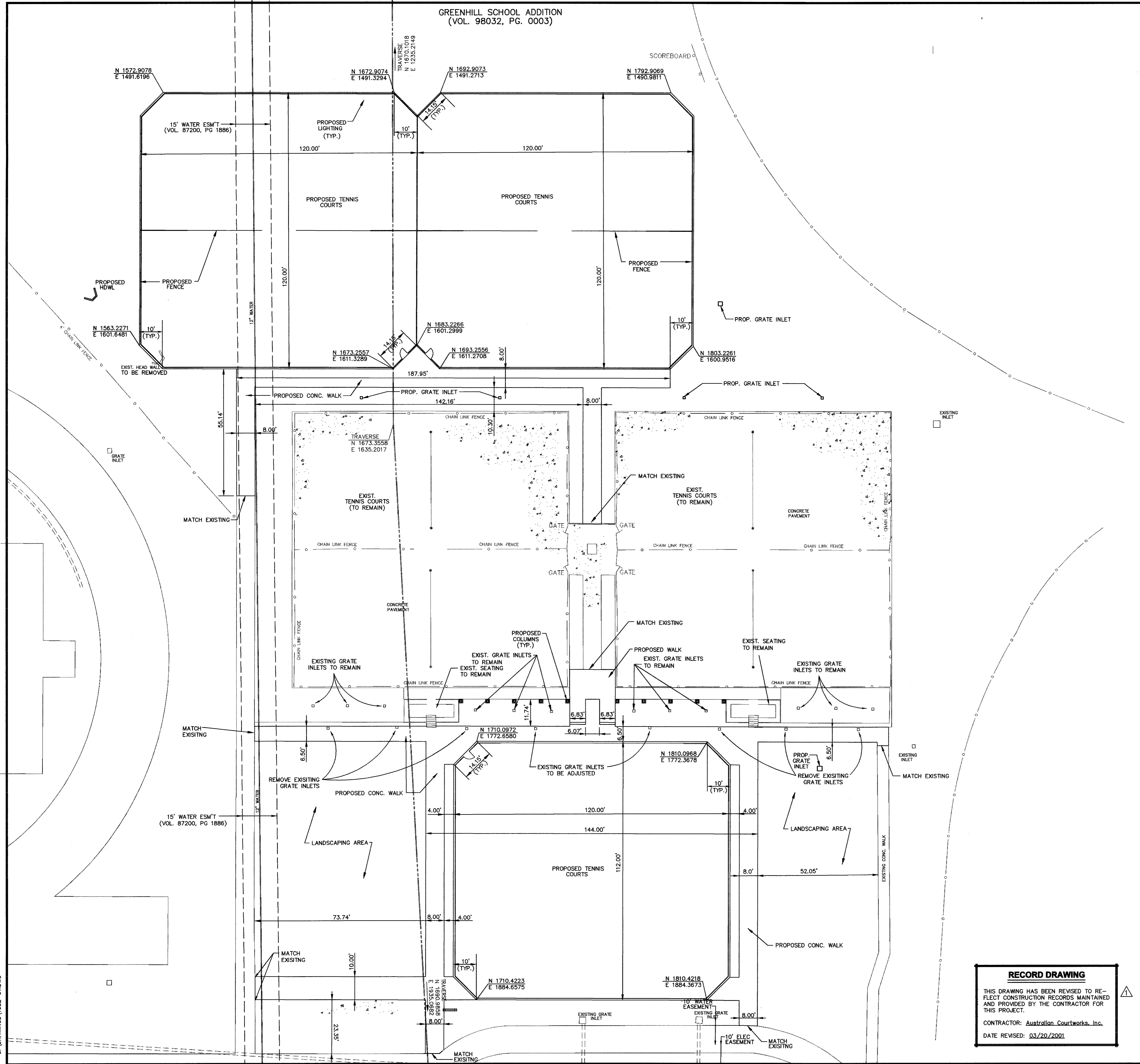

**GENERAL NOTES**

- ALL WORK, UNLESS OTHERWISE NOTED, SHALL CONFORM TO THE STANDARD SPECIFICATIONS FOR PUBLIC WORKS CONSTRUCTION, ISSUED BY THE NORTH CENTRAL TEXAS COUNCIL OF GOVERNMENT, AND CITY OF ADDISON STANDARD CONSTRUCTION SPECIFICATIONS.
- PRIOR TO ANY CONSTRUCTION, THE CONTRACTOR SHALL BE FAMILIAR WITH THE PLANS INCLUDING ALL NOTES, THE STANDARD SPECIFICATIONS FOR PUBLIC WORKS CONSTRUCTION NORTH CENTRAL TEXAS AND THE CITY STANDARDS FOR CONSTRUCTION AND ANY OTHER APPLICABLE STANDARD AND SPECIFICATIONS RELEVANT TO THE PROPER COMPLETION OF THE WORK SPECIFIED. FAILURE ON THE PART OF THE CONTRACTOR TO BE FAMILIAR WITH ALL STANDARDS AND SPECIFICATION PERTAINING TO THIS WORK SHALL IN NO WAY RELIEVE THE CONTRACTOR OF RESPONSIBILITY OF PERFORMING THE WORK IN ACCORDANCE WITH ALL SUCH APPLICABLE STANDARDS AND SPECIFICATIONS.
- THE HORIZONTAL AND VERTICAL LOCATIONS OF EXISTING SUBSURFACE UTILITIES HAVE BEEN DETERMINED FROM DATA RECORDED BY OTHERS. CONTRACTOR SHALL VERIFY THAT NECESSARY CROSSING CLEARANCES BETWEEN EXISTING AND PROPOSED UTILITIES EXIST PRIOR TO CONSTRUCTION OF ANY SUCH CROSSING. IT WILL BE THE RESPONSIBILITY OF THE CONTRACTOR TO PROTECT ALL UTILITIES IN THE CONSTRUCTION OF THIS PROJECT. CONTRACTOR TO VERIFY SIZE AND LOCATION OF ALL UTILITIES PRIOR TO CONSTRUCTION.
- IT WILL BE THE RESPONSIBILITY OF THE CONTRACTOR TO PROTECT ALL MANHOLES, CLEANOUTS, VALVE BOXES, FIRE HYDRANTS, ETC., THEY MUST BE ADJUSTED TO PROPER LINE, AND GRADE BY THE CONTRACTOR PRIOR TO AND AFTER THE PLACING OF PERMANENT PAVING AND GRADING. UTILITIES MUST BE MAINTAINED TO PROPER LINE AND GRADE DURING THE CONSTRUCTION OF THE PAVING FOR THIS DEVELOPMENT.
- 5.1 MAINTAIN NORMAL PROJECT DRAINAGE UNTIL NEW DRAINAGE FACILITIES ARE FUNCTIONAL, INCLUDING, WHERE NECESSARY, INTERIM REPLACEMENT OF EXISTING DRAINAGE STRUCTURES REMOVED FOR CONSTRUCTION OF NEW DRAINAGE FACILITIES.  
5.2 MAINTAIN ALL WORK AND MATERIAL STORAGE AREAS IN ORDERLY CONDITION, FREE OF DEBRIS AND WASTE; ON COMPLETION OF CONSTRUCTION, CLEAN UP THE PROJECT AND ADJACENT AFFECTED AREAS TO ACCEPTABLE CONDITION, ALL AS PROVIDED IN THE GENERAL CONDITIONS.
- PRIOR TO COMMENCEMENT OF CONSTRUCTION, BONDS AND THREE-WAY CONTRACTS SHALL BE SUBMITTED TO THE CITY AS REQUIRED.
- THE CONTRACTOR IS RESPONSIBLE FOR COMPLIANCE WITH ALL FEDERAL, STATE AND LOCAL REGULATIONS REGARDING TRENCH SAFETY.
- REFER TO ARCHITECTURAL PLANS FOR DETAILED DIMENSIONS, LAYOUTS, RAMPS, RETAINING WALLS AND SIDEWALKS. DIMENSIONS SHOWN ON THESE PLANS ARE FOR REFERENCE ONLY.
- BARRICADING AND PROJECT SIGNS SHALL CONFORM TO TEXAS DEPARTMENT OF TRANSPORTATION MANUAL OF UNIFORM TRAFFIC CONTROL DEVICES AND LATEST UPDATES.

REVISED 03/22/2001

**Pacheco Koch Consulting Engineers**  
9401 LBJ FREEWAY SUITE 300 DALLAS, TEXAS 75243 972.235.3031

**DIMENSIONAL CONTROL PLAN  
GREENHILL SCHOOL  
DEASON FAMILY TENNIS COMPLEX  
DALLAS COUNTY**

CITY OF ADDISON, TEXAS

DESIGN	DRAWN	DATE	SCALE	NOTES	FILE	NO.
SAM	RRL	JUNE 26 2000	1"=20'			<b>C-10</b>

**RECORD DRAWING**  
THIS DRAWING HAS BEEN REVISED TO REFLECT CONSTRUCTION RECORDS MAINTAINED AND PROVIDED BY THE CONTRACTOR FOR THIS PROJECT.  
CONTRACTOR: **Australian Courtworks, Inc.**  
DATE REVISED: 03/20/2001



THE SEAL APPEARING ON THIS DOCUMENT WAS AUTHORIZED BY STEVEN A. MARKUSSEN P.E. 70990 ON 03/26/00. ALTERATION OF A SEALED DOCUMENT WITHOUT PROPER NOTIFICATION TO THE RESPONSIBLE ENGINEER IS AN OFFENSE UNDER THE TEXAS ENGINEERING PRACTICE ACT.

03/22/2001 2:28PM  
C:\DRAWINGS\1082-61.DWG