

GENERAL NOTES

1. All materials and construction shall conform to the City of Addison requirements. (CITY OF DALLAS STDS.)
2. All water mains to be cast iron Class 150 pipe with 8 mil. thickness polyethylene tube wrap.
3. All water mains shall have a minimum cover of 48" or as required to clear other utilities.
4. All water services shall be 1" copper as shown.
5. All sewer laterals shall be 6" and located as shown.

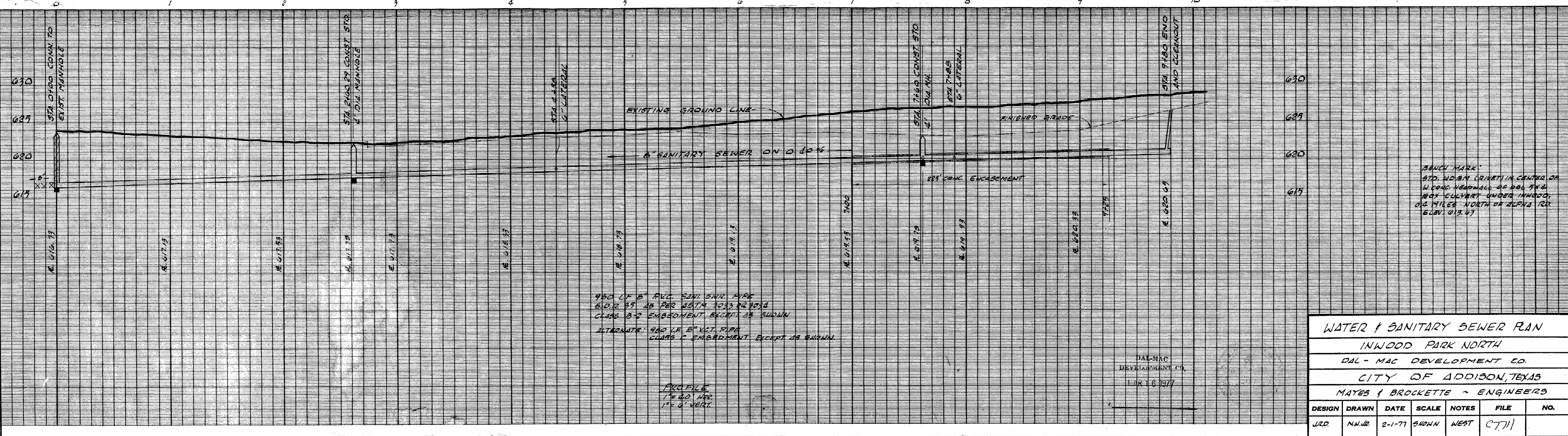
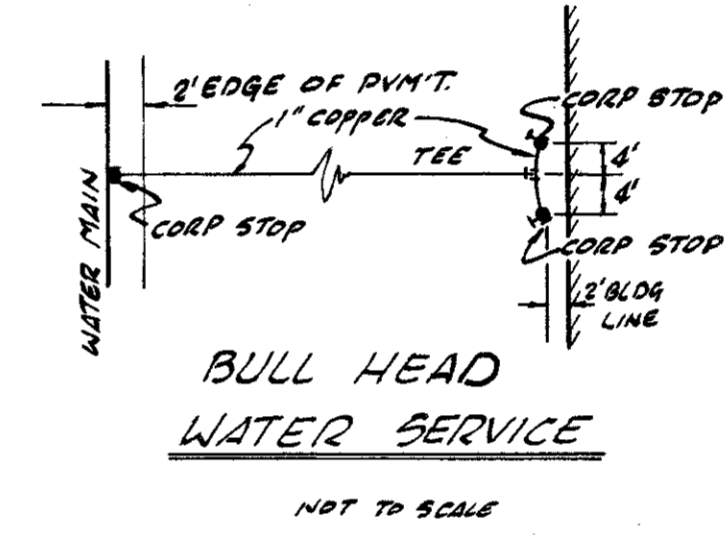

WATER & SANITARY SEWER PLAN						
INWOOD PARK NORTH						
DAL - MAC DEVELOPMENT CO.						
CITY OF ADDISON, TEXAS						
MAYES & BROCKETTE - ENGINEERS						
DESIGN	DRAWN	DATE	SCALE	NOTES	FILE	NO.
JRD	M.N.W.	2-1-77	SHOWN	WEST	C7711	