

NOTE :
SEE SIGNING AND PAVEMENT MARKINGS
SHEET 2 OF 2 FOR PAVEMENT MARKING
DETAILS

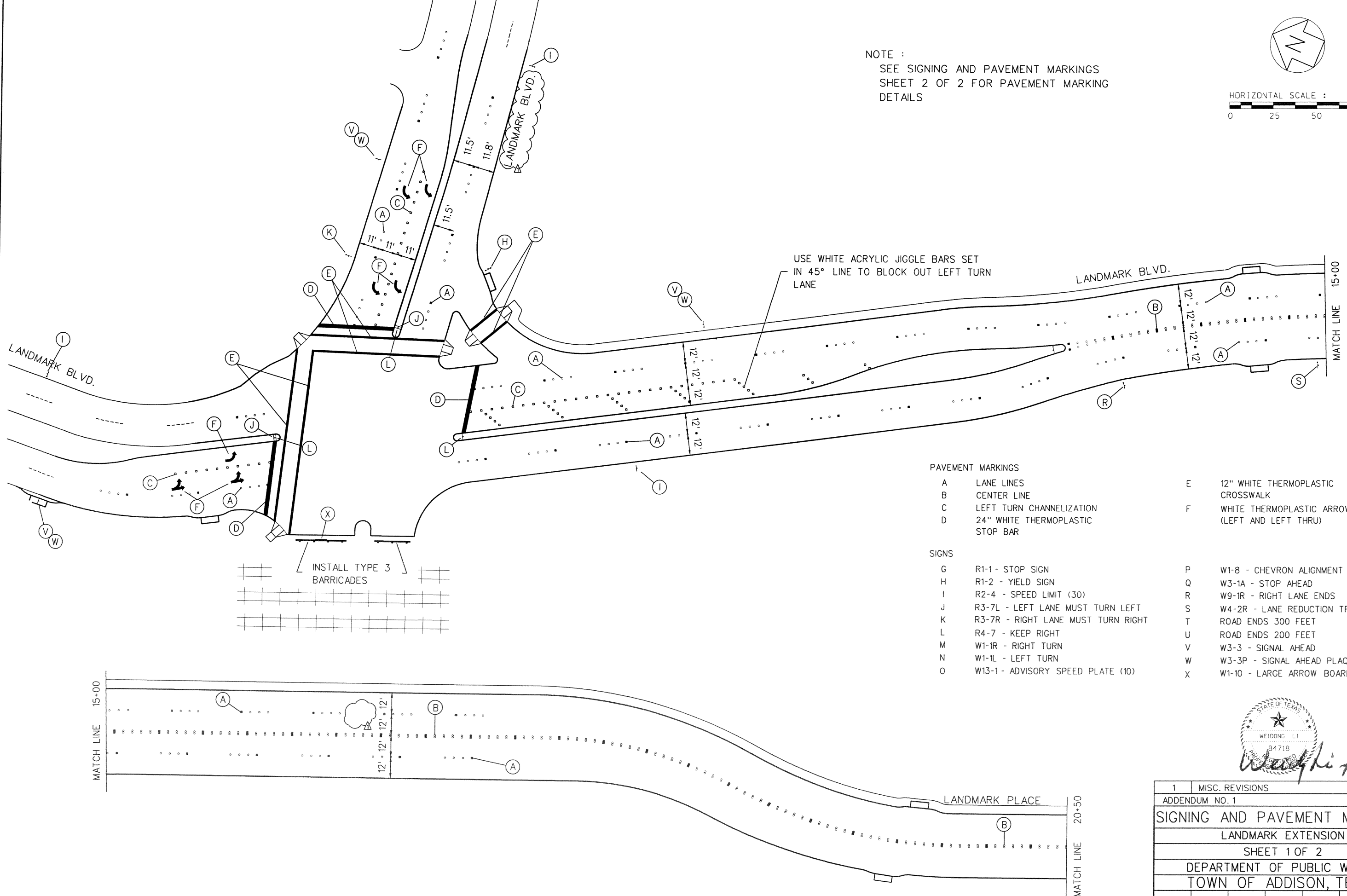
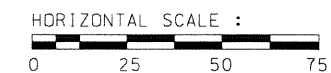

PAVEMENT MARKINGS

- | | | | |
|---|----------------------------------|---|---|
| A | LANE LINES | E | 12" WHITE THERMOPLASTIC CROSSWALK |
| B | CENTER LINE | F | WHITE THERMOPLASTIC ARROWS (LEFT AND LEFT THRU) |
| C | LEFT TURN CHANNELIZATION | | |
| D | 24" WHITE THERMOPLASTIC STOP BAR | | |

SIGNS

- | | | | |
|---|------------------------------------|---|-----------------------------------|
| G | R1-1 - STOP SIGN | P | W1-8 - CHEVRON ALIGNMENT (LEFT) |
| H | R1-2 - YIELD SIGN | Q | W3-1A - STOP AHEAD |
| I | R2-4 - SPEED LIMIT (30) | R | W9-1R - RIGHT LANE ENDS |
| J | R3-7L - LEFT LANE MUST TURN LEFT | S | W4-2R - LANE REDUCTION TRANSITION |
| K | R3-7R - RIGHT LANE MUST TURN RIGHT | T | ROAD ENDS 300 FEET |
| L | R4-7 - KEEP RIGHT | U | ROAD ENDS 200 FEET |
| M | W1-1R - RIGHT TURN | V | W3-3 - SIGNAL AHEAD |
| N | W1-1L - LEFT TURN | W | W3-3P - SIGNAL AHEAD PLAQUE |
| O | W13-1 - ADVISORY SPEED PLATE (10) | X | W1-10 - LARGE ARROW BOARD |

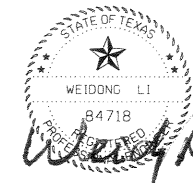
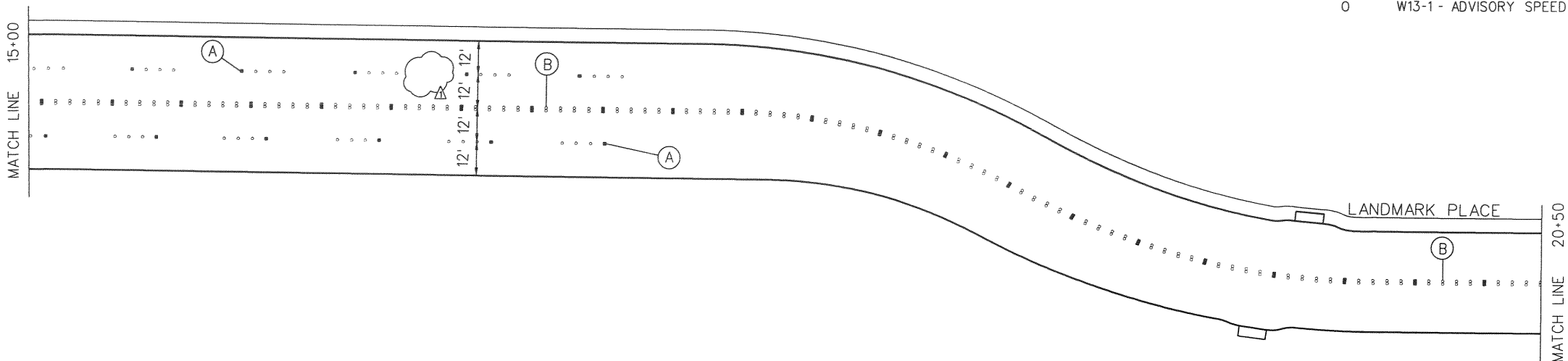
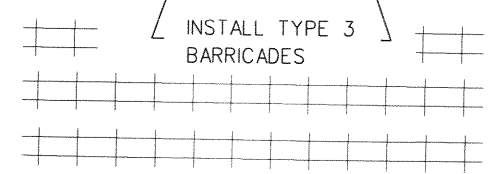

Weidong Li 7-20-01

1	MISC. REVISIONS	5/19/00
	ADDENDUM NO. 1	3/3/00
SIGNING AND PAVEMENT MARKINGS		
LANDMARK EXTENSION		
SHEET 1 OF 2		
DEPARTMENT OF PUBLIC WORKS		
TOWN OF ADDISON, TEXAS		
DESIGN	DRAWN	DATE
P.G.W.	C.W.W. E.C.S.	2/00
SCALE	NOTES	FILE
	AS BUILT	NUMBER
		18