

**DRIVEWAY DETAIL**  
NOT TO SCALE

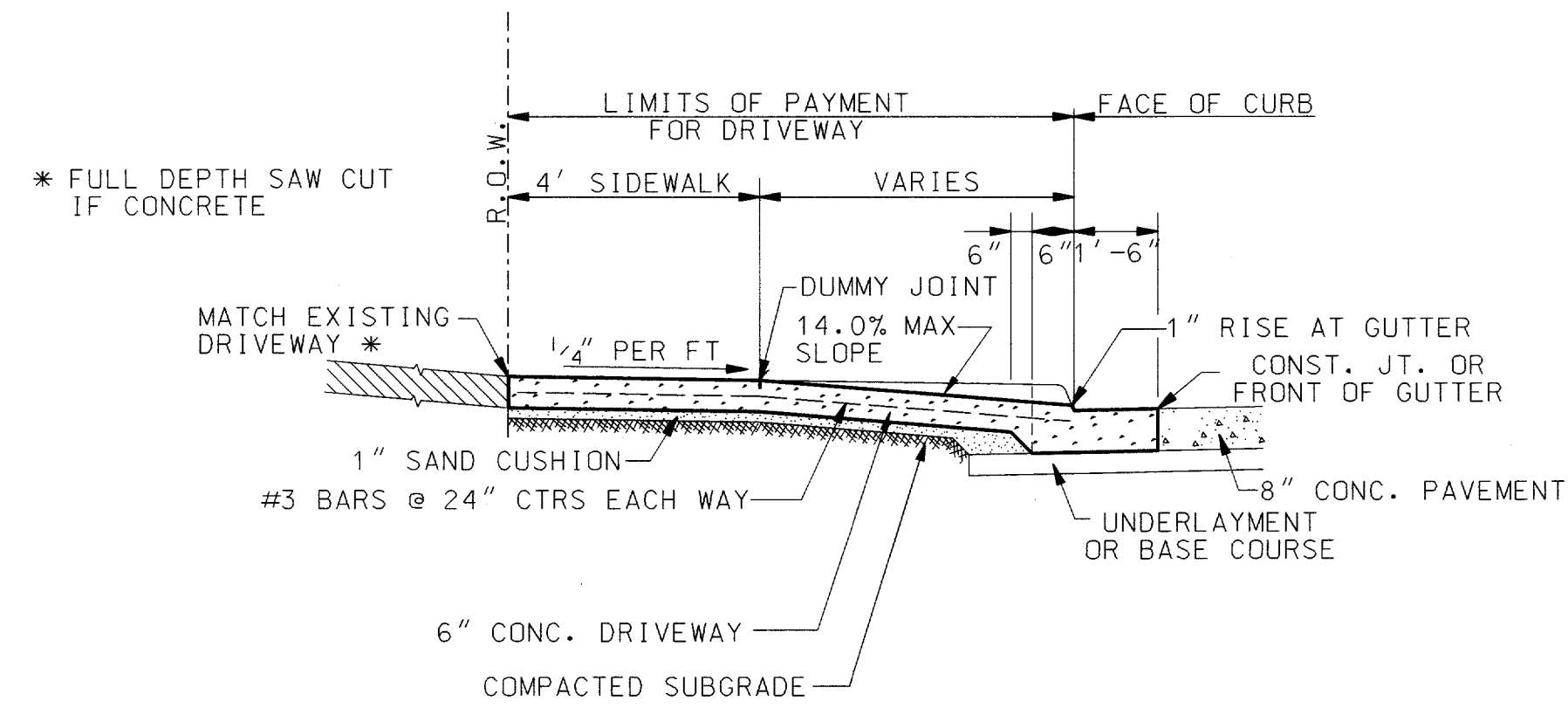

**SECTION A - A**  
NOT TO SCALE

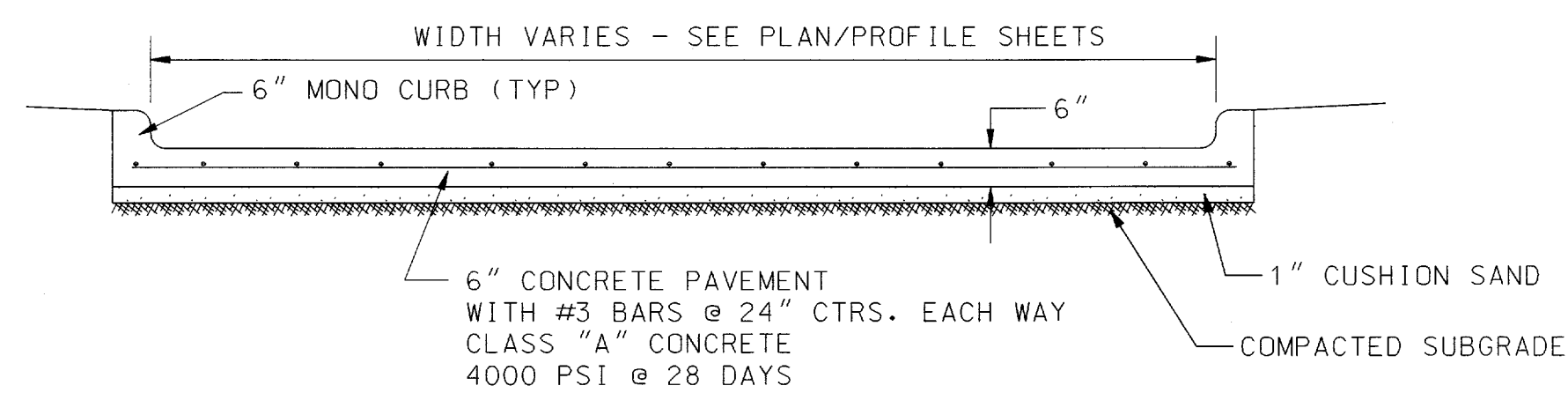

**SECTION B - B**  
NOT TO SCALE

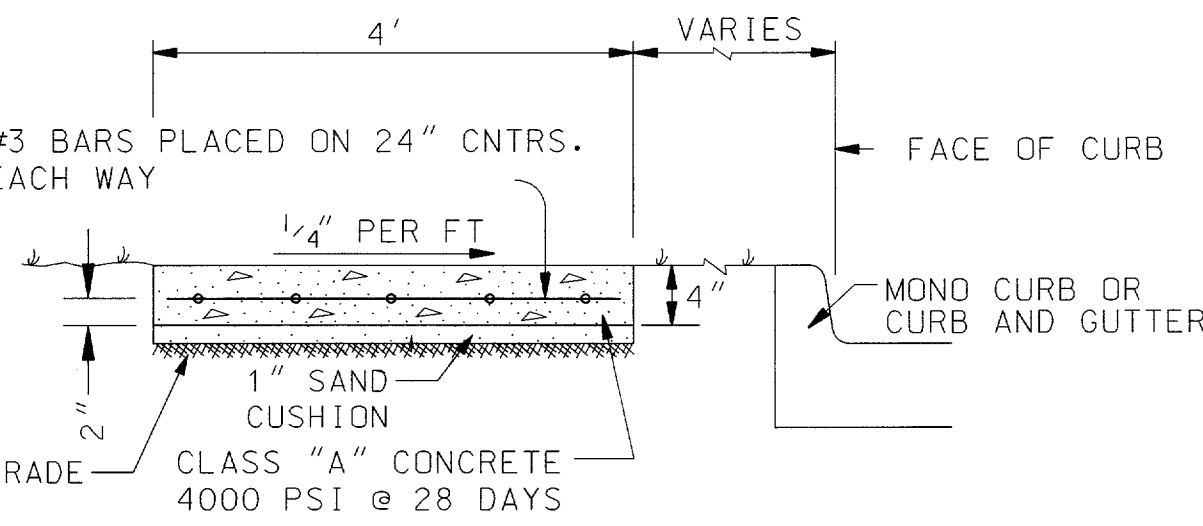
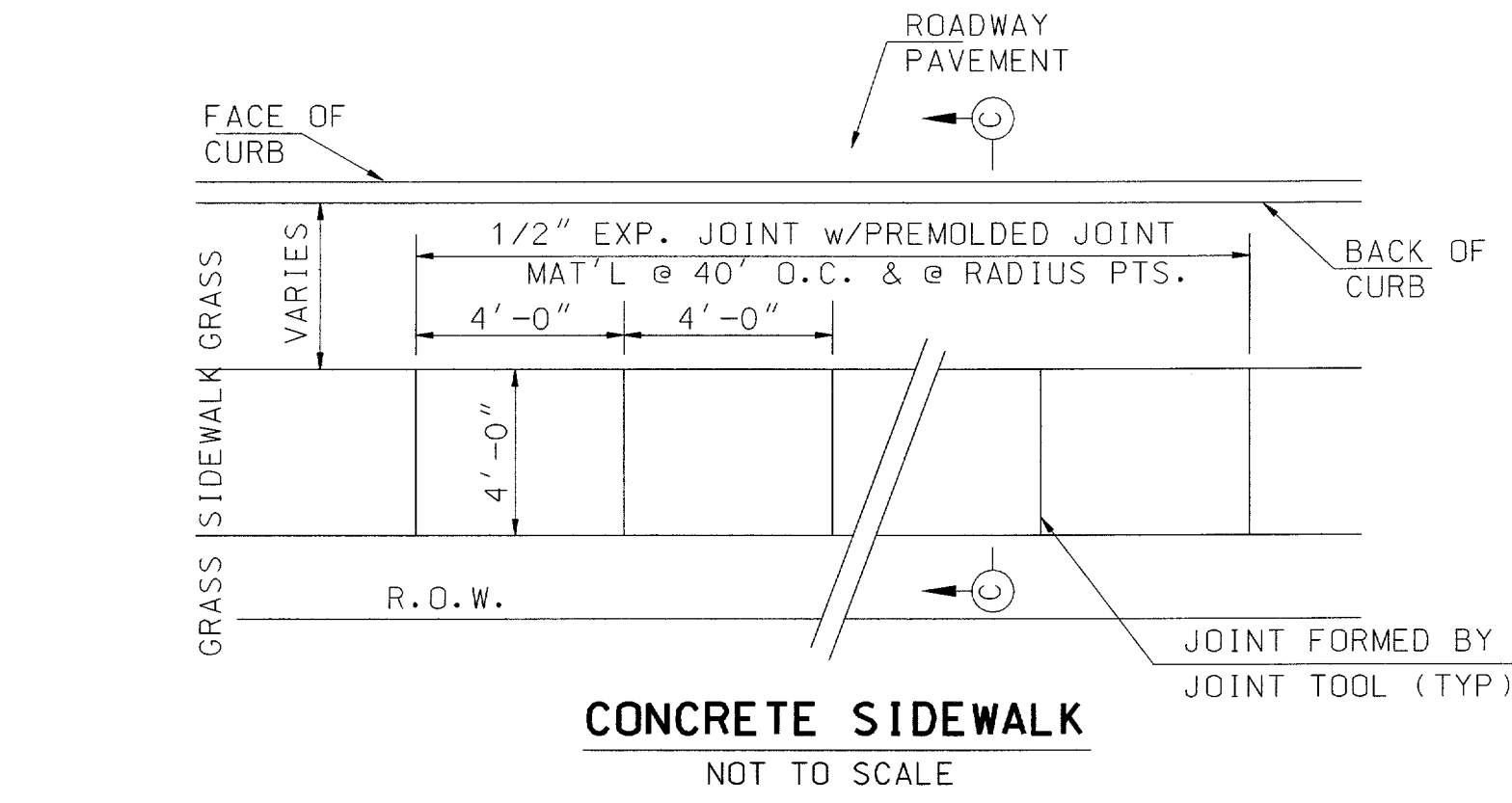

**SECTION C - C (SIDEWALK REMOTE FROM CURB)**  
NOT TO SCALE

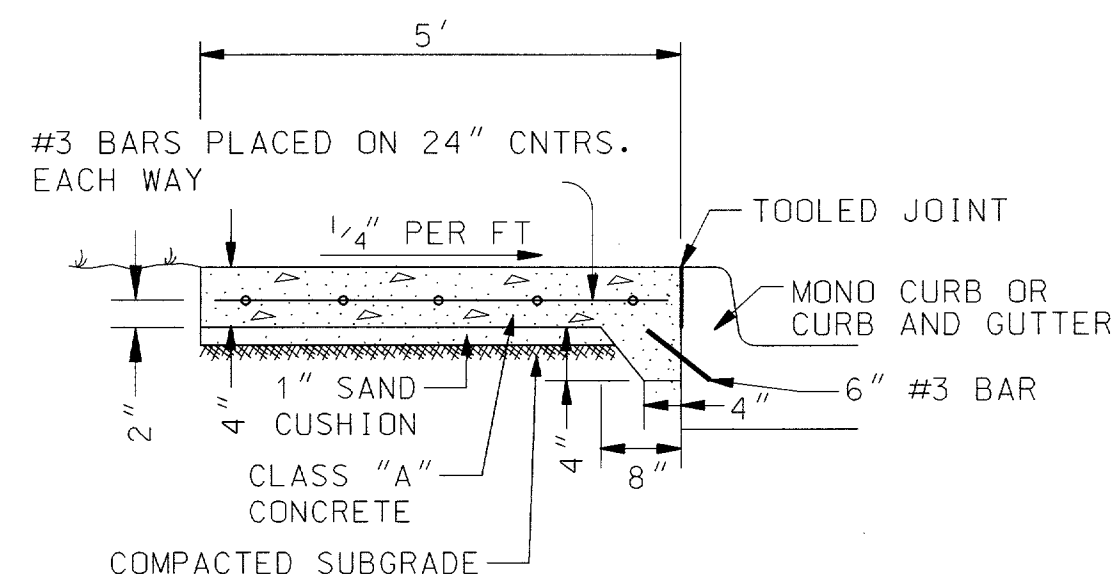

**SECTION C - C (SIDEWALK ADJACENT TO CURB)**  
NOT TO SCALE

**SIDEWALK NOTES:**

1. THE CONTRACTOR SHALL PROVIDE TOOLED JOINTS USING A JOINTING TOOL APPROVED BY THE ENGINEER.
2. CONTRACTOR SHALL PROVIDE 1/2" PREMOLDED EXP. JOINT MATERIAL AT THE INTERFACE BETWEEN THE EDGE OF SIDEWALK AND ANY CURB OR WALL.

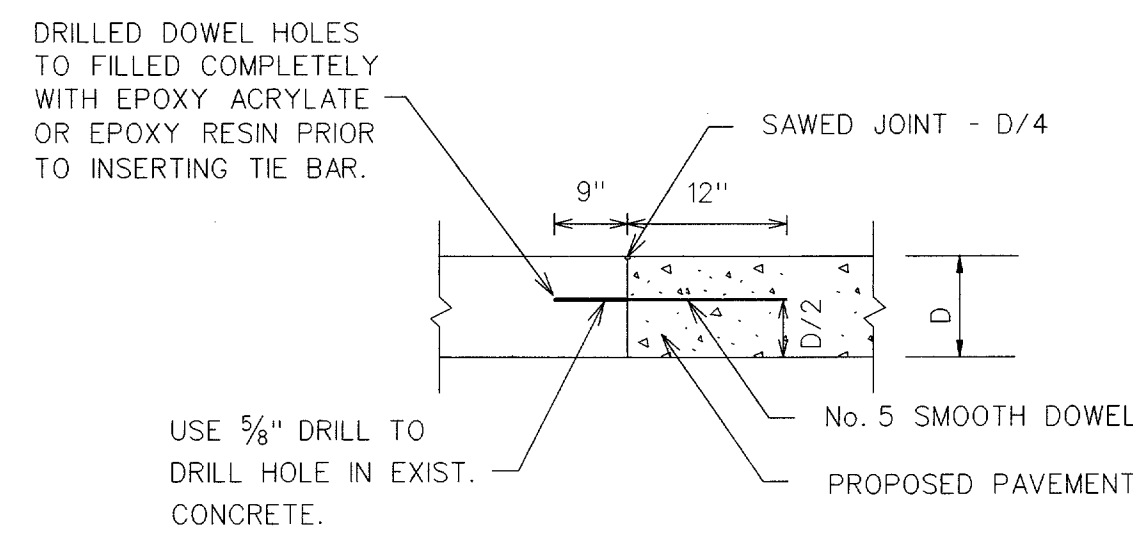

**LONGITUDINAL TIE BAR**  
NOT TO SCALE

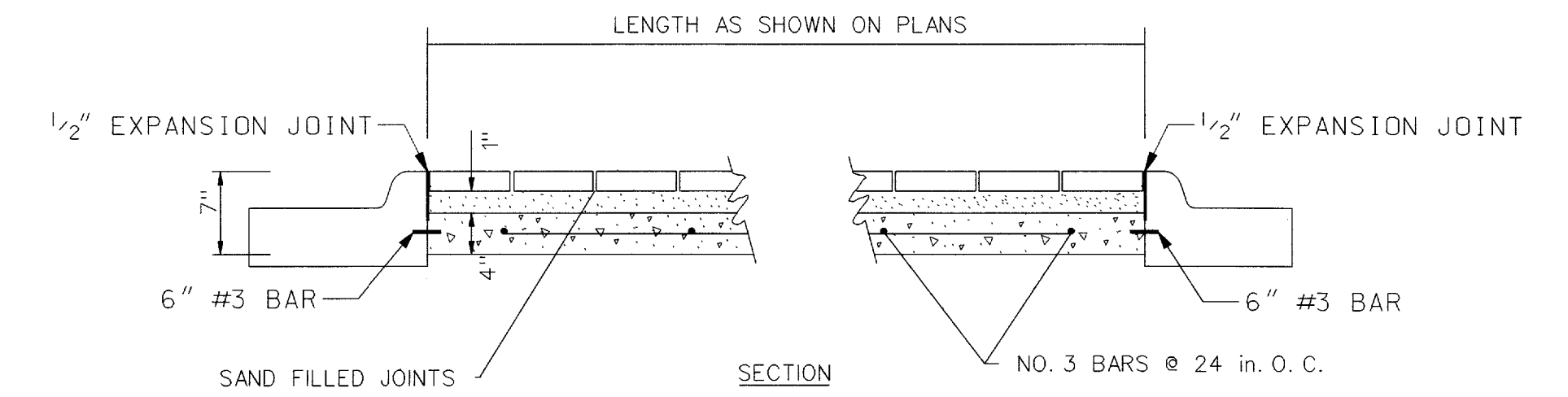
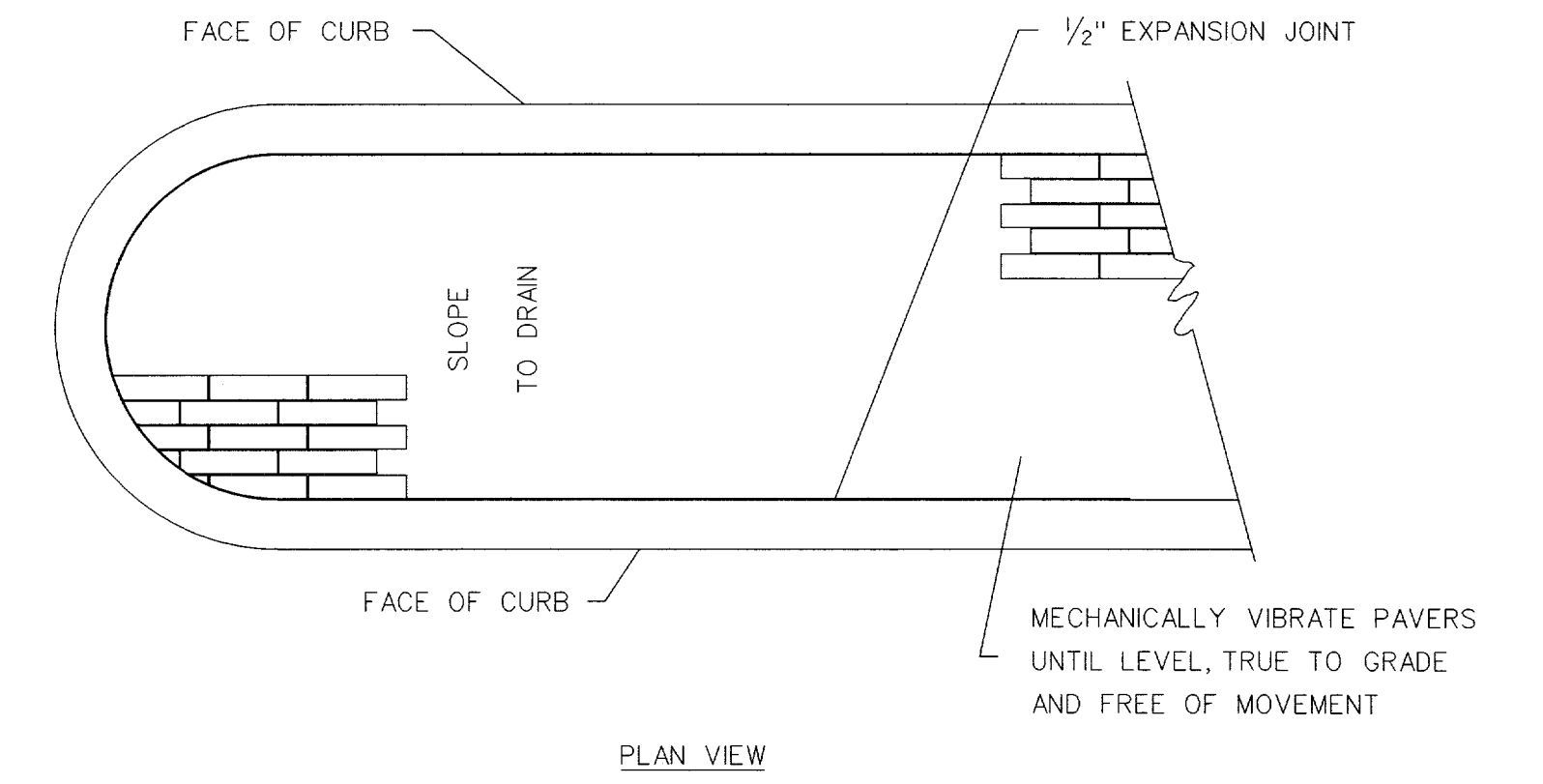

**LANDSCAPE PAVER DETAILS**  
NOT TO SCALE

**LANDSCAPE PAVERS:**

1. LANDSCAPE PAVERS SHALL BE MODULAR CONCRETE PAVERS, AS MANUFACTURED BY PAVESTONE CO., OR EQUAL. PAVERS SHALL HAVE A COMPRESSIVE STRENGTH GREATER THAN 8000 PSI, A WATER ABSORPTION MAXIMUM OF 5% AND MEET OR EXCEED ASTM C-936. PAVERS SHALL BE INSTALLED IN ACCORDANCE WITH DETAILS SHOWN IN THE PLANS AND PLACED IN A RUNNING BOND PATTERN PARALLEL TO THE CENTERLINE OF THE STREET. COLOR AND PATTERN SHALL BE APPROVED BY OWNER. SUPPORT SLAB AND SAND CUSHION SHALL BE SUBSIDIARY TO LANDSCAPE PAVERS.

STATE OF TEXAS  
WEIDONG LI  
84718  
LICENSED PROFESSIONAL ENGINEER  
*Weidong Li*  
5/12/03

<b>PARSONS</b>						
15770 N. DALLAS PARKWAY, SUITE 500, DALLAS, TEXAS 75248 (972) 991-1900						
<b>MISCELLANEOUS DETAILS</b>						
<b>INWOOD CONNECTION</b>						
<b>DEPARTMENT OF PUBLIC WORKS</b>						
<b>TOWN OF ADDISON, TEXAS</b>						
DESIGN	DRAWN	DATE	SCALE	NOTES	FILE	NUMBER
R.A.Y.	S.L.K.	05/12/03				15