

SR3-1
(LED BLANKOUT
SIGN)

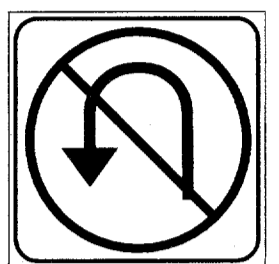

SR3-4

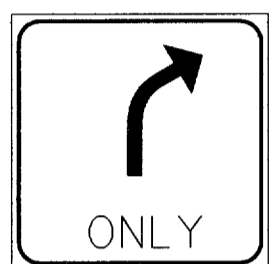

R3-5

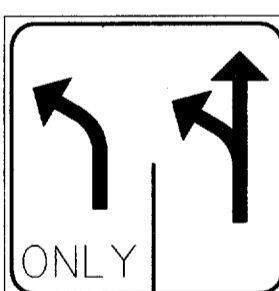

SR3-8

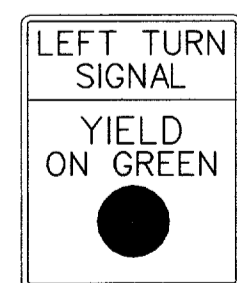

R10-12S

SIGN SUMMARY							
LOCATIONS	SIGN TYPE	DESCRIPTION	SIZE	LOCATIONS	SIGN TYPE	DESCRIPTION	SIZE
T-2	R10-12S	LEFT TURN YIELD	30" x 36"	T-6	SR3-8	LANE ASSIGNMENT	36" x 36"
T-2	SR3-4	NO U-TURN	30" x 30"	T-6	SR3-4	NO U-TURN	EXISTING
T-3	SR3-4	NO U-TURN	30" x 30"	T-7	SR3-4	NO U-TURN	30" x 30"
T-3	R3-5	RIGHT ONLY	30" x 36"	T-8	SR3-1*	NO RIGHT TURN	30" x 30"
T-3	SR3-8	LANE ASSIGN.	36" x 36"	T-8	SR3-4	NO U-TURN	EXISTING
T-4	SR3-4	NO U-TURN	30" x 30"	T-8	SR3-8	LANE ASSIGNMENT	EXISTING
T-4	R10-12S	LEFT TURN YIELD	30" x 36"				
T-4	SR3-1*	NO RIGHT TURN	30" x 30"				
T-5	SR3-4	NO U-TURN	EXISTING				

* LED BLANKOUT SIGN

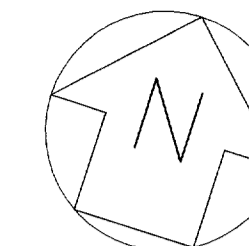

HORIZONTAL SCALE : 1" = 40'
0 10 20 30 40 50 60

LEGEND

- FIRE HYDRANT
- EXISTING TRAFFIC SIGNAL ON ARM W/POLE
- EXISTING PEDESTRIAN SIGNAL WITH BUTTONS, AND R10-4b SIGNS
- EXISTING PULL BOX
- POWER POLE
- LIGHT STANDARD WITH PHOTOCELL
- RIGHT-OF-WAY
- ZONE DETECTOR (VIDEO)
- OPTICOM DETECTOR
- PROPOSED TRAFFIC SIGNAL ON ARM W/POLE
- VIDEO DETECTION CAMERA
- SIGNAL HEAD IDENTIFIER
- SIGNAL CONDUIT
- CONDUIT IDENTIFIER
- INSTALL PULL BOX TYPE A
- INSTALL PULL BOX TYPE C
- PROPOSED PEDESTRIAN SIGNAL WITH BUTTONS, AND R10-4b SIGNS
- PROPOSED PEDESTAL POLE W/SIGNALS WITH BUTTONS, AND R10-4b SIGNS
- EXISTING CONTROLLER FOUNDATION/CABINET
- SIGN PLATE
- SIGNAL POLE IDENTIFIER
- SIGN PLATE AND POLE TO BE INSTALLED

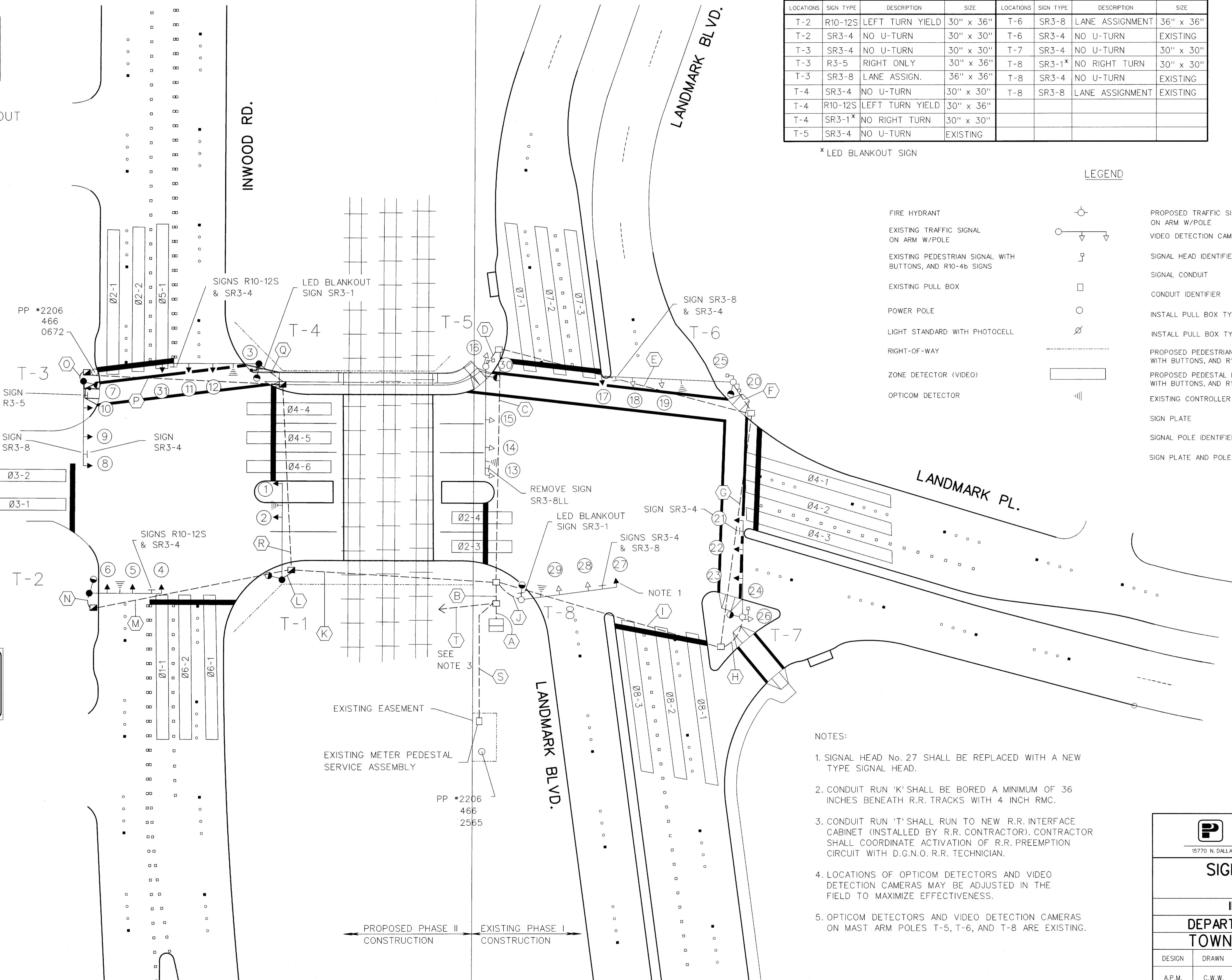

NOTES:

- SIGNAL HEAD No. 27 SHALL BE REPLACED WITH A NEW TYPE SIGNAL HEAD.
- CONDUIT RUN 'K' SHALL BE BORED A MINIMUM OF 36 INCHES BENEATH R.R. TRACKS WITH 4 INCH RMC.
- CONDUIT RUN 'T' SHALL RUN TO NEW R.R. INTERFACE CABINET (INSTALLED BY R.R. CONTRACTOR). CONTRACTOR SHALL COORDINATE ACTIVATION OF R.R. PREEMPTION CIRCUIT WITH D.G.N.O. R.R. TECHNICIAN.
- LOCATIONS OF OPTICOM DETECTORS AND VIDEO DETECTION CAMERAS MAY BE ADJUSTED IN THE FIELD TO MAXIMIZE EFFECTIVENESS.
- OPTICOM DETECTORS AND VIDEO DETECTION CAMERAS ON MAST ARM POLES T-5, T-6, AND T-8 ARE EXISTING.



Alan P. McNeil
5/12/03



15770 N. DALLAS PARKWAY, SUITE 500, DALLAS, TEXAS 75248 (972)991-1900

SIGNAL LAYOUT PLAN

INWOOD CONNECTION

DEPARTMENT OF PUBLIC WORKS

TOWN OF ADDISON, TEXAS

DESIGN	DRAWN	DATE	SCALE	NOTES	FILE	NUMBER
A.P.M.	C.W.W.	05/12/03				26