

THE CONTRACTOR SHALL CONTACT DIG-TESS AT 1-800-344-8377 A MINIMUM OF 48 HOURS PRIOR TO THE COMMENCEMENT OF ANY CONSTRUCTION ACTIVITIES

THE BOUNDARY AND TOPOGRAPHIC SURVEY WAS PREPARED BY SPARR SURVEYS DATED DECEMBER 17, 2008.

**BENCHMARK INFORMATION:**  
 BM - SET SQUARE CUT ON THE NORTHEAST CORNER OF THE EXISTING GRATE INLET. ELEVATION = 640.00  
 CONTRACTOR SHALL SET NEW BENCHMARK ON-SITE PRIOR TO WORK IN THIS AREA.

GRADING LEGEND			
I.R.F.	IRON ROD FOUND	☐	POWER POLE
I.R.S.	IRON ROD SET	☼	LIGHT POLE
"x"	CUT X IN CONCRETE	⊗	WATER VALVE
F.C.P.	FENCE CORNER POST	⊙ <sup>SSMH</sup>	SANITARY SEWER MANHOLE
///	ASPHALT	⊙	FIRE HYDRANT
⊙	TELEPHONE MANHOLE	⊙ <sup>WM</sup>	WATER METER
T.C.	TOP OF CURB	---	EXISTING CONTOURS
G	GUTTER	---	PROPOSED CONTOURS
T.P.	TOP OF PAVEMENT		
N.G.	NATURAL GROUND		

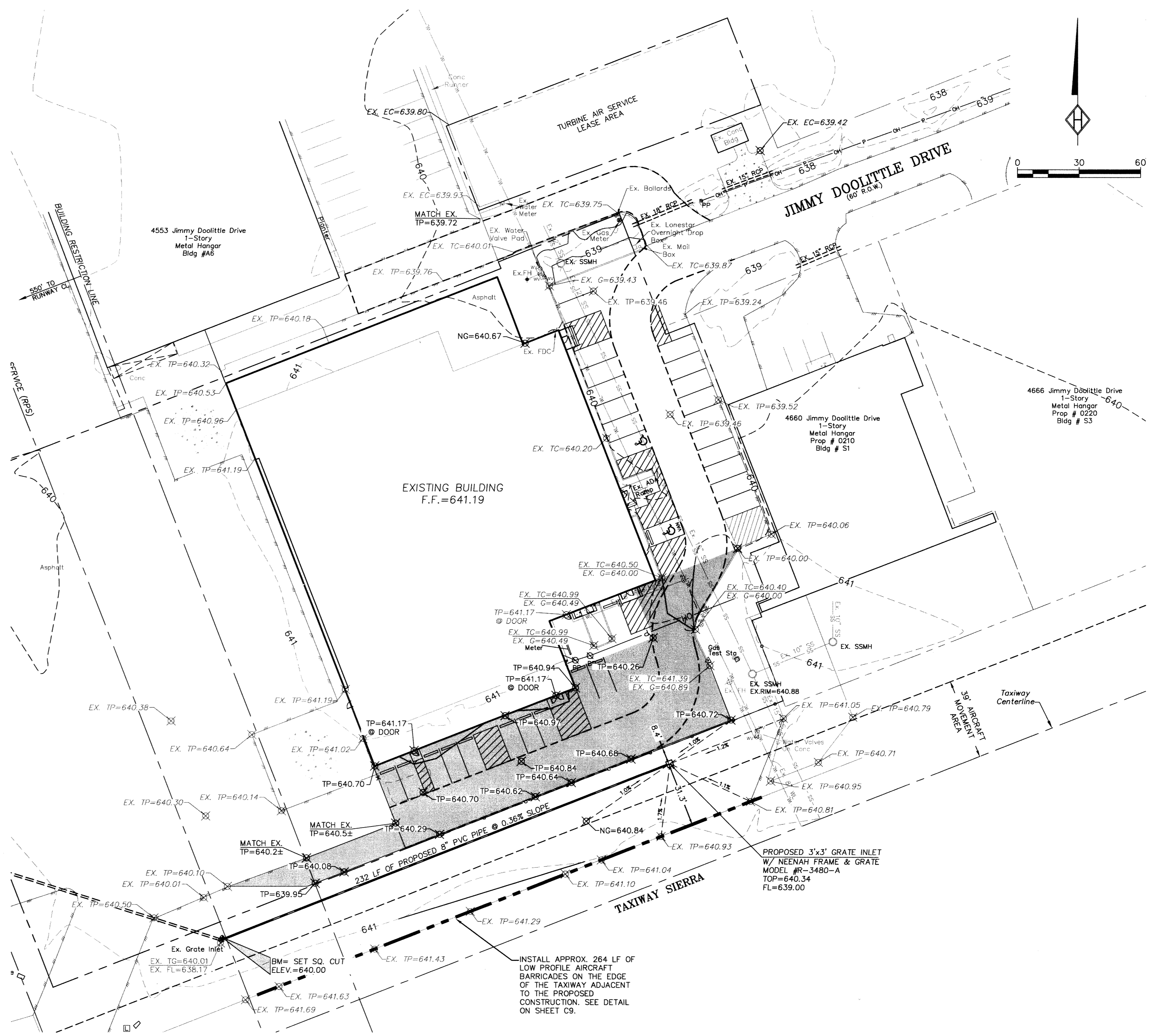

**RECORD DRAWING**  
 The record drawing herein reflects to the best of the design engineer's knowledge, the approximate location of the constructed improvements using information provided by the contractor.  
 Steven R. Homeyer, P.E. #86942  
 Date: 4-15-11



REVISIONS:  
 01/14/2011  
 1. REVISED SPOT ELEVATIONS TO REFLECT SITE MODIFICATIONS MADE DURING CONSTRUCTION.

DRAWN: HEI  
 DATE: 12/18/08  
 HEI #: 08-152  
 SHEET NO: C4

**HOMEYER ENGINEERING, INC.**  
 CIVIL ENGINEERING, PLANNING, SITE & LAND PLANNING  
 P.O. BOX 294527 • LEWISVILLE, TEXAS 75029  
 972-906-9988 • PHONE #972-906-9987 FAX #972-906-9989 • WWW.HOMEYERENGINEERING.COM

TURBINE AIR EXPANSION  
 ADDISON AIRPORT, BLDG. A-5  
 2.404 ACRES, ZONED I-3  
 4560 JIMMY DOOLITTLE DRIVE  
 TOWN OF ADDISON  
 DALLAS COUNTY, TEXAS