

File: L:\2012\12081100 - ADS S-1 Parking Lot\Drawings\RECORDS\ADS_S1P_C102_PP.dwg Last Saved by: Mmconolly
 Last Plotted by: McAnally, Mitchell, R Plot Date: 10/30/2012 10:54 AM Plotter Used: DWG To PDF.pc3

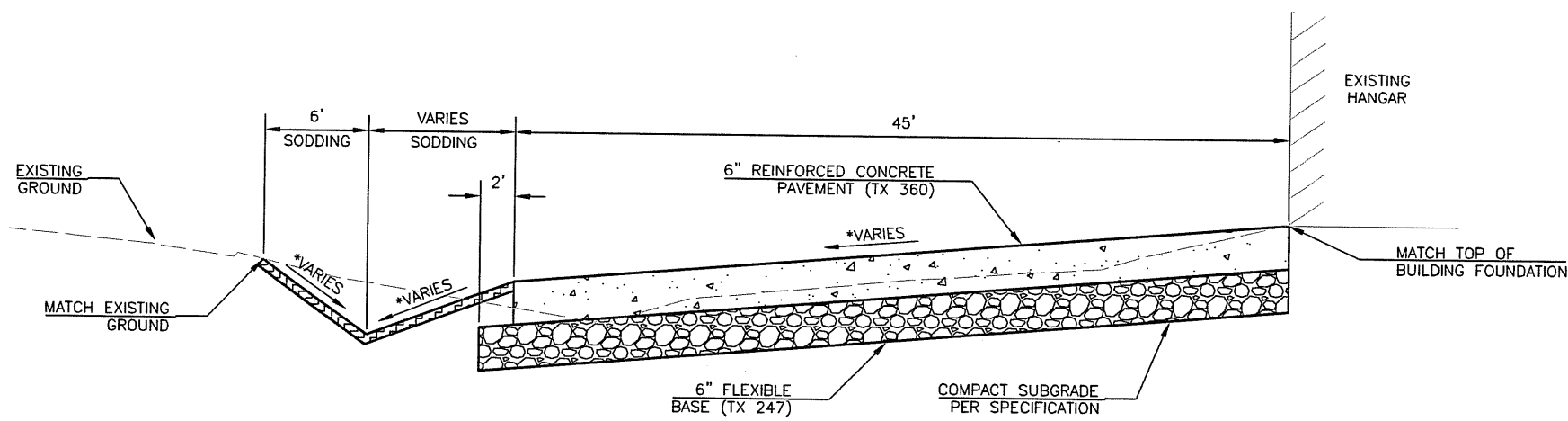
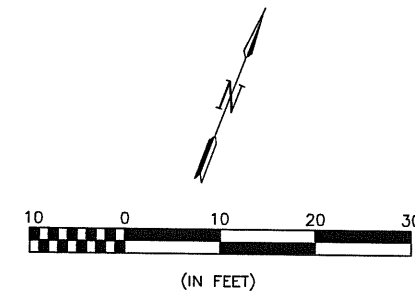
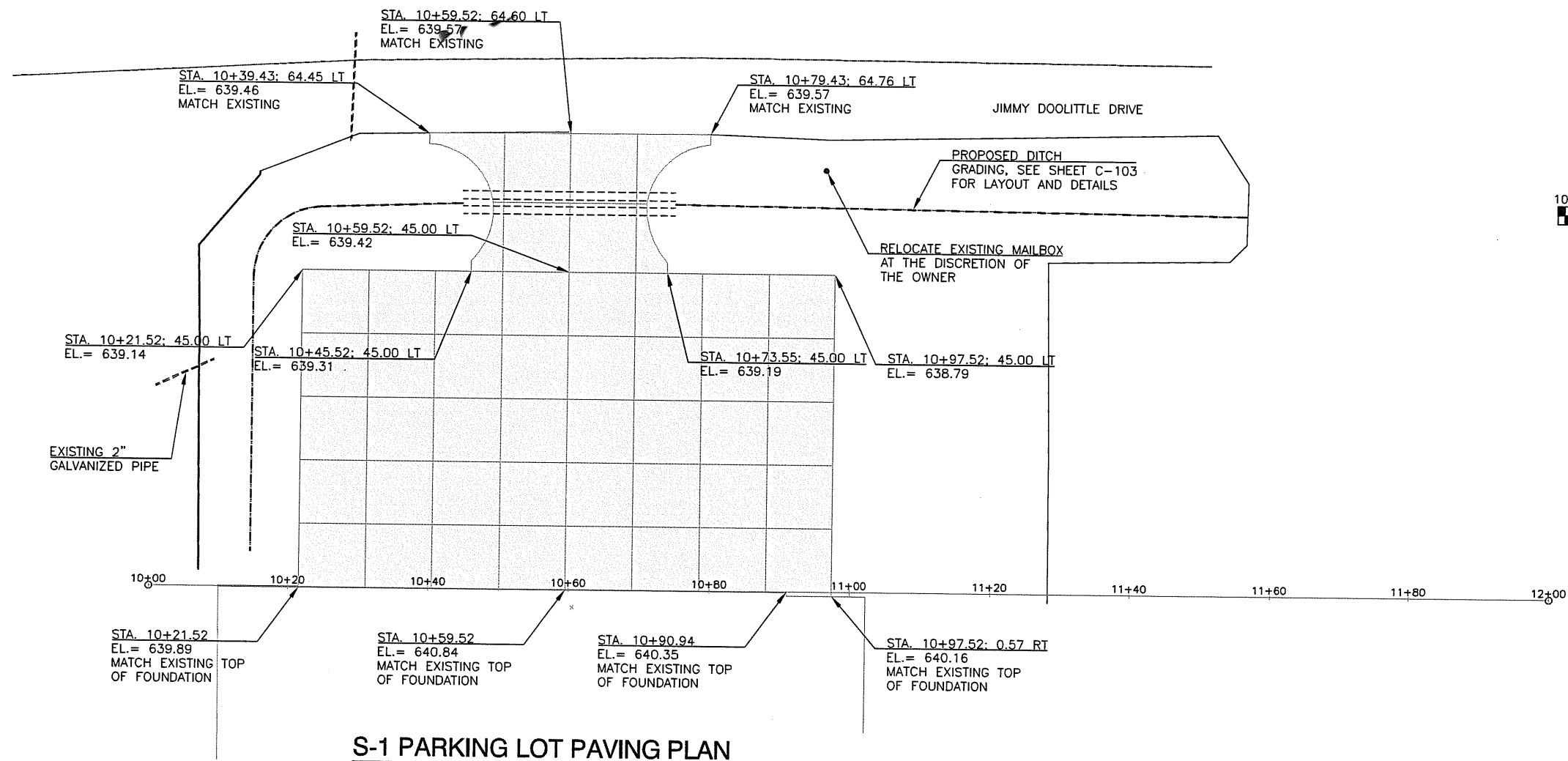

CAUTION: UNDERGROUND UTILITIES EXIST WITHIN AND ADJACENT TO THE LIMITS OF CONSTRUCTION. AN ATTEMPT HAS BEEN MADE TO LOCATE THESE UTILITIES ON THE PLANS. HOWEVER, ALL EXISTING UTILITIES MAY NOT BE SHOWN AND THE ACTUAL LOCATIONS OF THE UTILITIES MAY VARY FROM THE LOCATIONS SHOWN. PRIOR TO BEGINNING ANY TYPE OF EXCAVATION, THE CONTRACTOR SHALL CONTACT THE UTILITIES INVOLVED AND MAKE ARRANGEMENTS FOR THE LOCATION OF THE UTILITIES ON THE GROUND. THE CONTRACTOR SHALL MAINTAIN THE UTILITY LOCATION MARKINGS UNTIL THEY ARE NO LONGER NECESSARY.

TEXAS STATE LAW, THE UNDERGROUND FACILITIES DAMAGE PREVENTION ACT, REQUIRES TWO WORKING DAYS ADVANCE NOTIFICATION THROUGH THE TEXAS ONE-CALL SYSTEM CENTER BEFORE EXCAVATING USING MECHANIZED EQUIPMENT OR EXPLOSIVES (EXCEPT IN THE CASE OF AN EMERGENCY). THE ONE-CALL SYSTEM PHONE NUMBER IS 1-800-245-4545. THE CONTRACTOR IS ADVISED THAT THERE IS A SEVERE PENALTY FOR NOT MAKING THIS CALL. NOT ALL UTILITY COMPANIES ARE MEMBERS OF THE TEXAS ONE-CALL SYSTEM; THEREFORE, THE CONTRACTOR IS ADVISED TO CONTACT ALL NON-MEMBER UTILITIES AS WELL AS THE ONE-CALL SYSTEM.

PARKING LOT TYPICAL SECTION

SCALE: NONE

* SEE CROSS SECTIONS



REGISTRATION NO. F-5713

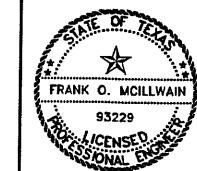

REV.	DATE	DESCRIPTION	BY

ADDISON AIRPORT
ADDISON, TX

S-1 PARKING LOT IMPROVEMENTS

S-1 PARKING LOT PAVING PLAN AND TYPICAL SECTION

JOB NO.: 12081100
DATE: JULY, 2012
DESIGNED BY: MRM
DRAWN BY: EGC

BAR IS ONE INCH ON ORIGINAL DRAWING
IF NOT ONE INCH ON THIS SHEET, ADJUST SCALES ACCORDINGLY.

SHEET NUMBER

C-102

RECORD DRAWINGS

10-30-2012