

MATCH MARK A SEE SHEET 5710-01B

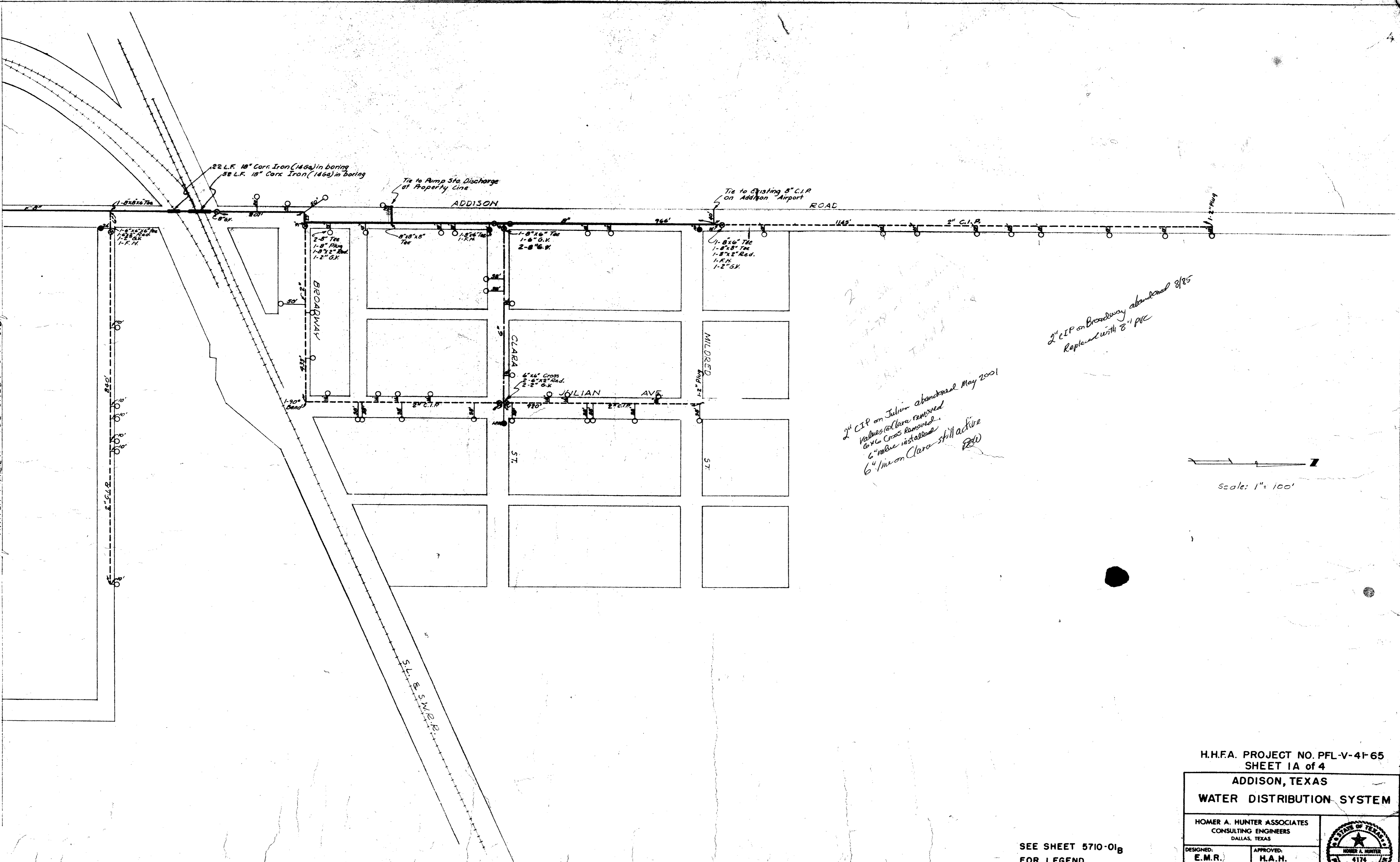

22 L.F. 18" Corc Iron (146a) in boring
38 L.F. 18" Corc Iron (146a) in boring

Tie to Pump Sta. Discharge
of Property Line

Tie to Existing 8" C.I.P.
on Addison Airport
ROAD

2nd CIP on Julian abandoned May 2001
Valves on Clara removed
6" valve installed
6" main on Clara still active
RHW

2" CIP on Broadway abandoned 8/85
Replaced with 8" PVC

Scale: 1" = 100'

H.H.F.A. PROJECT NO. PFL-V-4F-65
SHEET 1A of 4

ADDISON, TEXAS
WATER DISTRIBUTION SYSTEM

HOMER A. HUNTER ASSOCIATES
CONSULTING ENGINEERS
DALLAS, TEXAS

DESIGNED: E.M.R. APPROVED: H.A.H.



5710-01A REV. JAN. 1959

AS BUILT

SEE SHEET 5710-01B
FOR LEGEND