

ADDISON ROAD

ADDISON ROAD

L=280.21
R=686.30

STA 6+07-END
6" PVC 5' CONST.
CO. - FL 630.21

6+00-4' SERVICE
LATERAL FL #6" 630.14
#4" 630.24

REMOVE & SALVAGE
EXIST 8" 90° BEND
AND 8" VALVE.

CUT EXIST 8" WATER
INSTALL
1-8" 90° BEND (SALVAGED)
1-8" VALVE (SALVAGED)
CONNECT TO EXIST 8"
PVC WATER

RECONNECT
2" WATER SERVICES

CUT EXIST 8" WATER
INSTALL
2-8" 45° BENDS
CONNECT TO EXIST 8"
PVC WATER

Install 1-8" 90° Bend
1-8" VALVE

Install 1-8" x 6" FH Tee
1-5" Valve
1-FH

Conn to Exist 8" DI
Remove Plug
Install 1-8" Valve
2-8" 90° Bends

By 0+00 - CONST. AND 4.0'
M.H. OVER EXIST 10" PVC.
FL. THRU 623.85 FL. IN 624.14

EXIST 4.0" M.H. FL. 626.00

BLDG. 1
MIN. FF. 637.60

BLDG. 2
MIN. FF. 637.60

KELLER

SPRINGS

ROAD

LEDGE MOUNT LANE

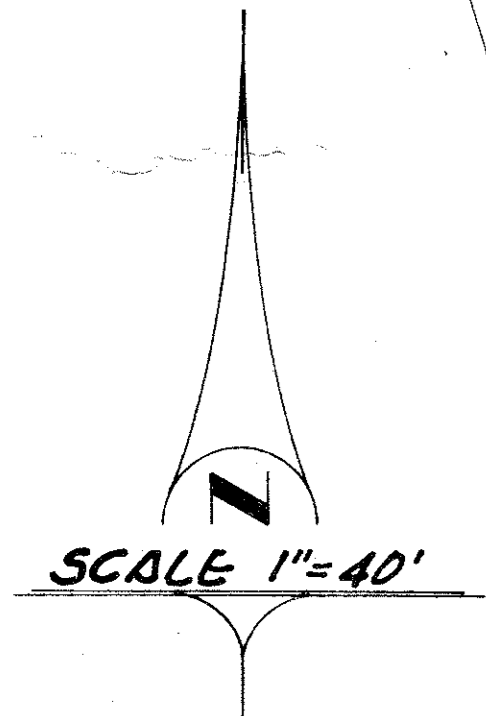

SCALE 1"=40'

GENERAL NOTES

- All 8" water mains to be 100-10 PVC with #12 tracer wire.
- All 8" water mains to have a minimum of 4' cover below street grades or as required to clear other utilities.
- Final top and valve grade adjustments (after paving) shall be the responsibility of the utility contractor.
- Water and sanitary sewer easement shall also include additional area of working space for construction and maintenance of the system. Additional easement area is also provided for installation and clearance of manholes, cleanouts, fire hydrants, sewers, laterals, meters, and other appurtenances necessary for proper operation of the system.
- Sanitary sewer pipe joints shall conform to current A.S.I.M. designation C-245, 100-35 PVC.
- Unless otherwise noted, all material and construction shall conform to the standard specifications of the City of Addison, Texas. In the event an item is not covered in the City of Addison specifications, the City Engineer's decision shall apply.
- The location of all existing utilities to be verified by contractor prior to start of construction.
- Contractor to notify utility companies at least 48 hours (2 working days) prior to start of construction.
- All fire hydrants shall be 10" Nipple Centurion model.
- Tapping sleeves to be Mueller or Clow.

CITY OF ADDISON
APPROVED

FOR CONSTRUCTION

BUILDING DEPARTMENT
4-10-80

NOTE: CONTRACTOR IS HEREBY INSTRUCTED TO EXERCISE CARE IN INSURING OR EXCEEDING ALL REQUIREMENTS OF BOTH NATIONAL AND LOCAL CODES AND/OR ORDINANCES APPLICABLE TO HIS WORK. APPROVAL OF THESE DRAWINGS SHALL NOT BE CONSTRUED TO RELIEVE RESPONSIBILITY OR IMPLY VARIANCE TO SUCH CODES.

WATER & SEWER
OF
GATEWAY CENTRE
OUT OF THE
WILLIAM LOMAX SURVEY, ABST. 792
ADDISON, T.X.

FOR
LAKEVIEW PROPERTIES INC.
BY:

SPAIN-AYRES & ASSOCIATES, INC.
CONSULTING ENGINEERS
2448 CABERNET RD. DALLAS, TEXAS
214 243-7881 75225

BY: WFO 2/11/79
BY: SPAIN-AYRES SPRINGS
44' 100' E OF ADDISON RD
ELEV. 636.57

REVISED SEPT 11-79
REVISED OCT 15-77 (A. BULLT)