

DEVELOPMENT PLANS  
FOR  
**PARKWAY BUSINESS CENTER**  
CITY OF ADDISON, TEXAS

**GENERAL NOTES**

1. All street and alley intersections and connections shall be built by the developer.
2. Excavation from streets to be deposited in low areas to allow proper drainage.
3. All existing ditches, except as noted on drainage plans, are to be filled to conform to surrounding terrain.
4. It will be the responsibility of the developer and/or the contractor to protect and maintain to proper line and grade all public utilities, manholes, cleanouts, valve boxes, fire hydrants, etc. during the construction of this project, prior to and after placing permanent pavement.
5. All materials and workmanship shall conform to the City Standards and Specifications.

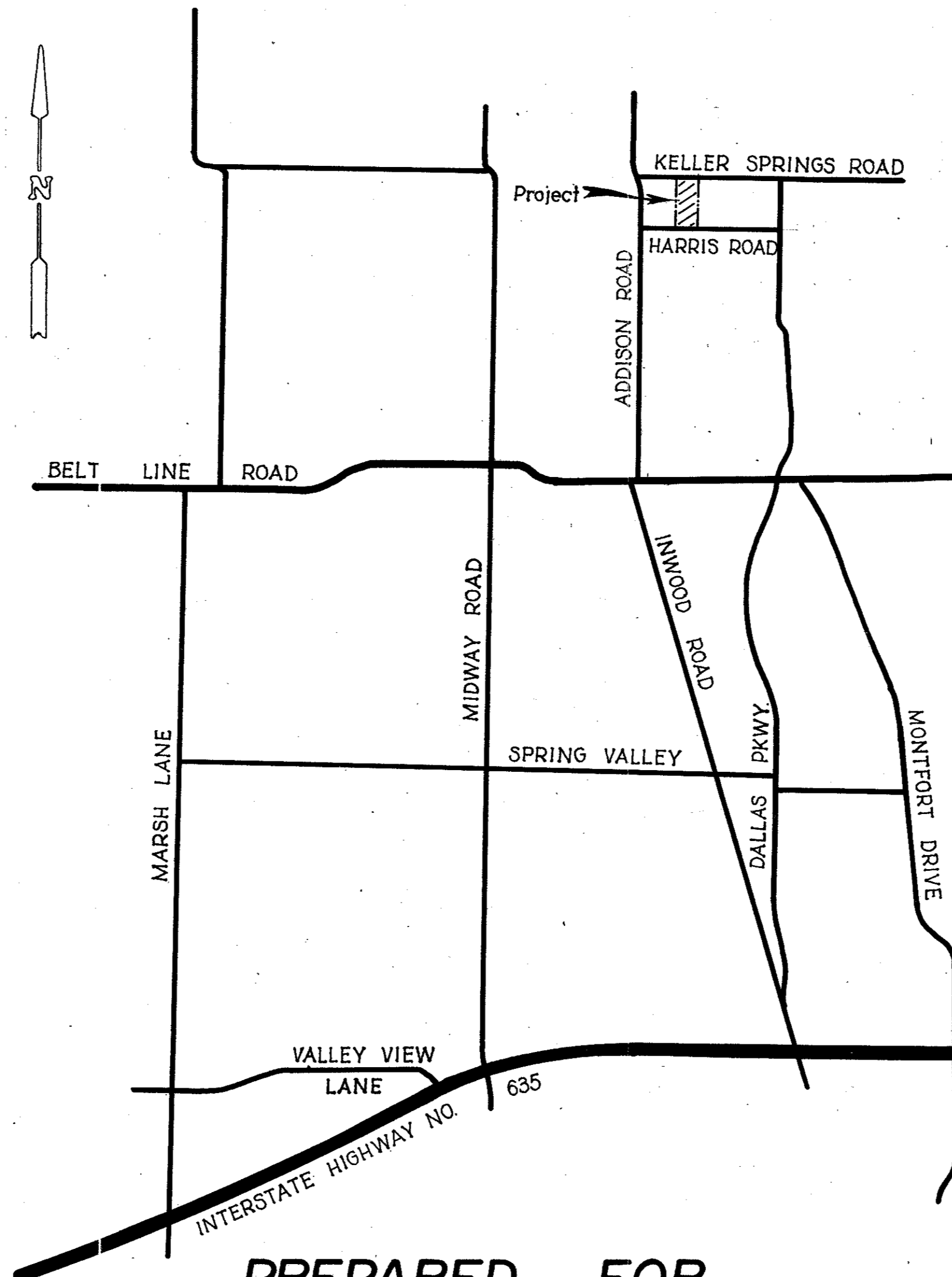

CITY OF ADDISON  
**APPROVED**  
FOR CONSTRUCTION

BUILDING DEPARTMENT

DATE: \_\_\_\_\_  
NOTE: CONTRACTOR IS HEREBY INSTRUCTED TO EXERCISE CARE IN MEETING OR EXCEEDING ALL REQUIREMENTS OF BOTH NATIONAL AND LOCAL CODES AND/OR ORDINANCES APPLICABLE TO HIS WORK. APPROVAL OF THESE DRAWINGS SHALL NOT BE CONSTRUED TO RELIEVE RESPONSIBILITY OR IMPLY VARIANCE TO SUCH CODES.

PREPARED FOR

**MURRAY PROPERTIES COMPANY**

**DON A. TIPTON, INC.**

**CONSULTING ENGINEERS**

13600 L.B.J. FREEWAY

GARLAND, TEXAS 75041