

RFI

To: Erik Earmshaw  
 BGO Architects  
 4144 N. Central Expressway  
 Suite 855  
 Dallas, TX 75205  
 Ph: (214) 520-8878

RFI #: 61  
 Date: 2/22/2012  
 Job: EB-02 Keller Springs Lofts  
 Phone: 877-777-5115

CC: David Gallagher (Embrey Builders LLC)  
 Subject: Fire Extinguisher Cabinets Locations

Drawing: 3.1A, 3.2A, 3.3A, 3.4A, 3.4F  
 Cost Impact: None  
 Spec Section:  
 Schedule Impact: None

**Request:** Date Required: 2/29/2012  
 1) There are some inconsistencies with plans for FEC locations in corridors.  
 3.1A shows 2 FEC  
 3.2A shows 1 FEC  
 3.3A shows 1 FEC  
 3.4A shows 2 FEC  
 Do you want 2nd FEC added for 2nd & 3rd floors?  
 2) On sheet 3.4F - FEC mark is missing on A4 All G wall.  
 The FEC is shown on 1st, 2nd and 3rd floors, does the FEC need to be included at 4th floor?  
 Please verify all sections for coordination and consistency.  
 3) Do we need fire extinguishers in club/leasing? We have assumed 1 for club and 1 for leasing.  
 4) Do we need FE in parking garage and if so what type of mounting?

Requested by: Bryan Pickler  
 Embrey Partners, Ltd.

**Response:**  
 1- Yes.  
 2- Yes. I've checked all locations and the one's you mentioned are the only problem locations. I adjusted 2 other FEC locations by moving them a foot or so now all FECs line up in the same spot from floor to floor (except for the Club and Garage areas).  
 3- I've placed the 2 FECs you mentioned in sheet 9.1  
 4- Yes, we need them in the parking garage. I've updated the sheets to reflect this. Double check with your local Fire Marshall, but I'm confident that a surface mounting will be fine.

Ryan Faulds  
 Answered by  
 BGO architects  
 Company  
 Feb 28, 2012  
 Date

RFI 176

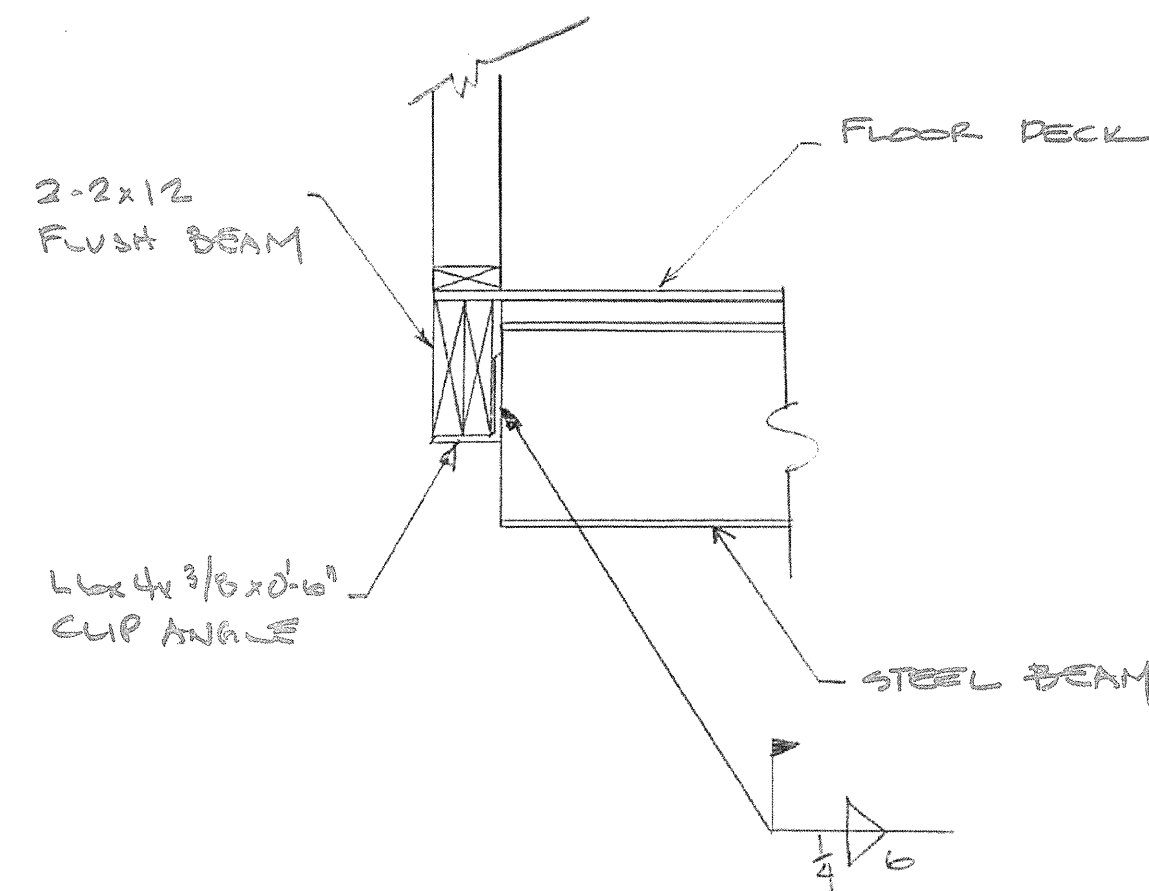

RFI

To: Trent Perkins  
 Parkin Perkins Olsen  
 9330 LBJ Freeway, Suite 1055  
 Dallas, TX 75243  
 Ph: (214) 221-2220 Fax: (214) 221-2252

RFI #: 176  
 Date: 8/2/2012  
 Job: EB-02 Keller Springs Lofts  
 Phone: 877-777-5115

CC: Ryan Faulds (B.G.O. Architects, Inc.)

Subject: Support angle iron needed and gusset detail needed

Drawing: 3.2A  
 Cost Impact: None  
 Spec Section:  
 Schedule Impact: None

**Request:** Date Required: 8/2/2012  
 On sheet 3.2A the highlighted wall between the B2 unit and the stair tower is 5'-12" past the steel. Our conversation on site please specify what size angle to weld to beam and install 2x10 or 2x12 to support the wall. Please provide gusset detail to support the areas highlighted on the A2-SP unit per our conversation onsite, and per the attached sketches.

Requested by: Bryan Pickler  
 Embrey Partners, Ltd.

**Response:**  
 See attached details.

R. Trent Perkins, P.E.  
 Parkin-Perkins-Olsen Consulting Engineering, Inc.  
 August 10, 2012

Answered by  
 Company  
 Date

RFI 176

