

NOTE: ROOF TRUSS LAYOUT, PROFILES AND DESIGN ARE TO BE PROVIDED BY THE TRUSS MANUFACTURER BY WAY OF SHOP DRAWINGS, AND ARE TO BE SIGNED AND SEALED BY A REGISTERED ENGINEER. SEE LEGEND SHEET FOR BALANCE OF TRUSS NOTES.

DOWNSPOUT LOCATIONS ARE CONCEPTUAL IN NATURE AND MUST BE COORDINATED BY THE CONTRACTOR ON SITE WITH THE LANDSCAPING, RETAINING WALLS, SIDEWALKS AND INDIVIDUAL BUILDING ORIENTATION AND DRAINAGE TO INSURE PROPER DRAINAGE. IT IS THE INTENT OF THE ARCHITECT THAT GUTTER DOWNSPOUTS BE LOCATED UNDERGROUND DRAINAGE PIPING AND CARRIED AWAY FROM THE BUILDING AND OTHER FINISHED SURFACES WHERE POSSIBLE.

1 DIVISION 'B' ROOF PLAN
1/8"=1'-0"

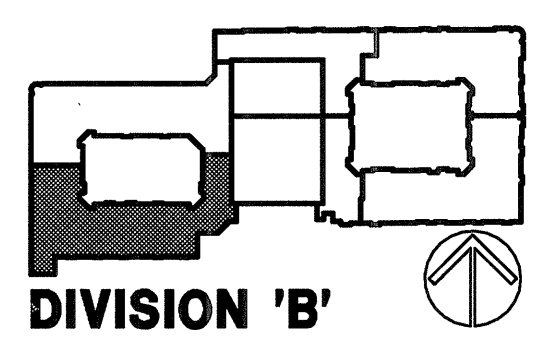

BGO
architects

4144 N. Central Expy.
Suite 855
Dallas, TX 75204
214.520.8878
bgoarchitects.com

CONSTRUCTION ISSUE
10-17-2011

REVISIONS

KELLER SPRINGS LOFTS

LOFT APARTMENTS IN ADDISON, TEXAS



DATE
08-05-2011

PROJECT
11129

SHEET NUMBER
3.5B
BLDG PLAN 'B'