

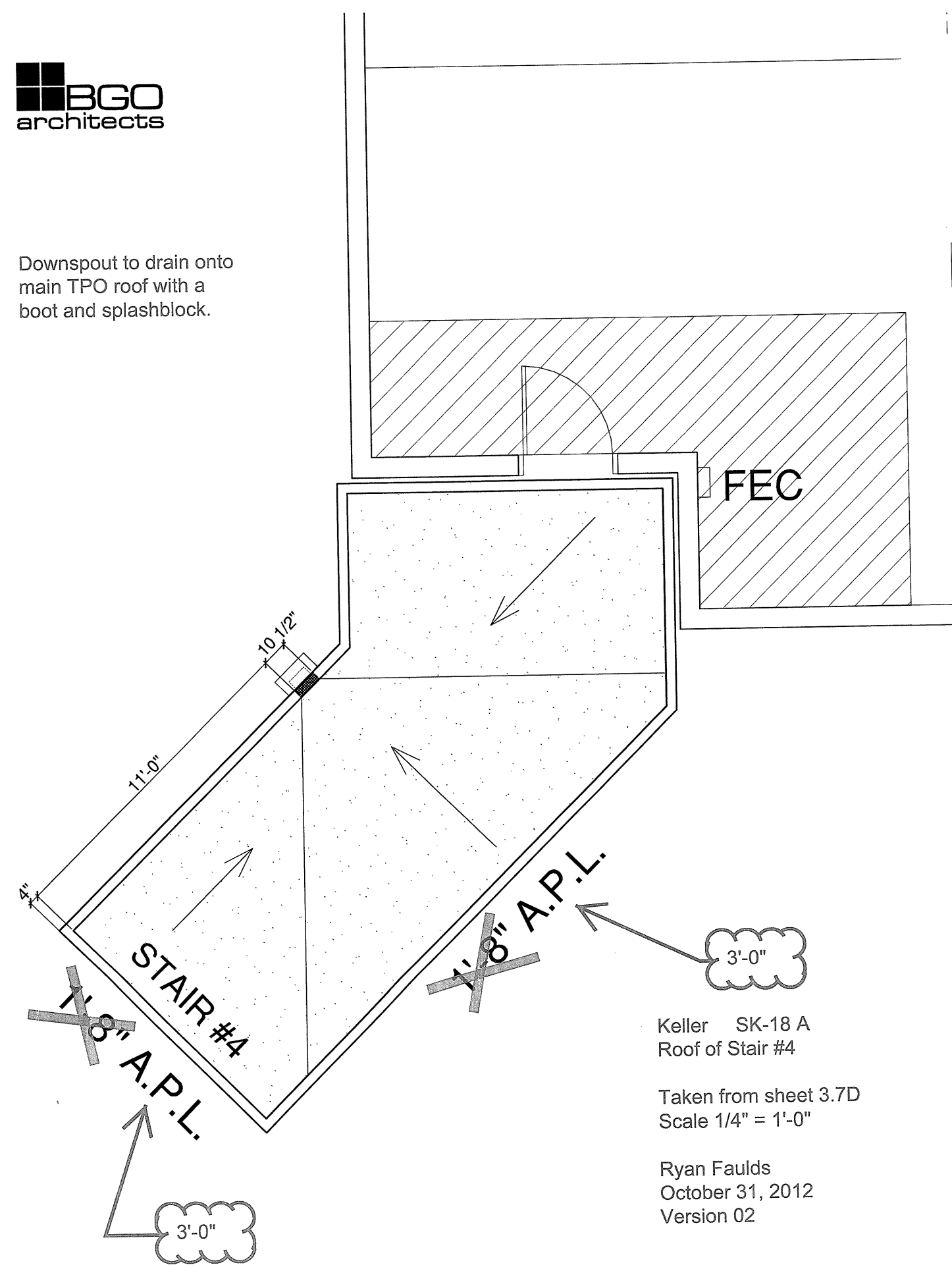

Downspout to drain onto main TPO roof with a boot and splashblock.



Keller SK-18 A
Roof of Stair #4
Taken from sheet 3.7D
Scale 1/4" = 1'-0"
Ryan Faulds
October 31, 2012
Version 02

Embrey Builders, LLC
1020 N. E. Loop 410, Suite 700
San Antonio, TX 78209
Ph: (210) 824-6044 Fax: (210) 824-7656

RFI

To: Ryan Faulds
B.G.O. Architects, Inc.
4245 N. Central Expressway
Dallas, TX 75205
Ph: (210)829-1898 Fax: (210)829-1899

RFI #: 179
Date: 8/7/2012
Job: EB-02 Keller Springs Lofts
Phone: 877-777-5115

CC: Erik Earnshaw (Beeler Guest Owens Architects)

Subject: Hollow metal door at 7th level of stair tower #4

Drawing: 1/6.4, 1/3.7D
Cost Impact: None

Spec Section:
Schedule Impact: None

Request: The hollow metal door on the 7th level of stair tower #4 shows being mounted into the garage pre-cast wall, on the 7th level of the garage the pre-cast wall stops 42" above finish floor of the garage. Therefore, the door will have to be moved into the stair tower CMU wall. Since the door is a left hand swing I purpose we use the same door and swing it into the stair tower similar to stair tower #5 and solve this issue. Please advised and respond ASAP as we are up to the 4th level now with the CMU. **Date Required: 8/8/2012**

Requested by:

Response:
what you propose for the 7th floor door in stair tower #4 is acceptable.

Answered by: Ryan Faulds
B.G.O. Architects, Inc. **Answered date:** September 06, 2012



Downspout to drain onto main TPO roof with a boot and splashblock.

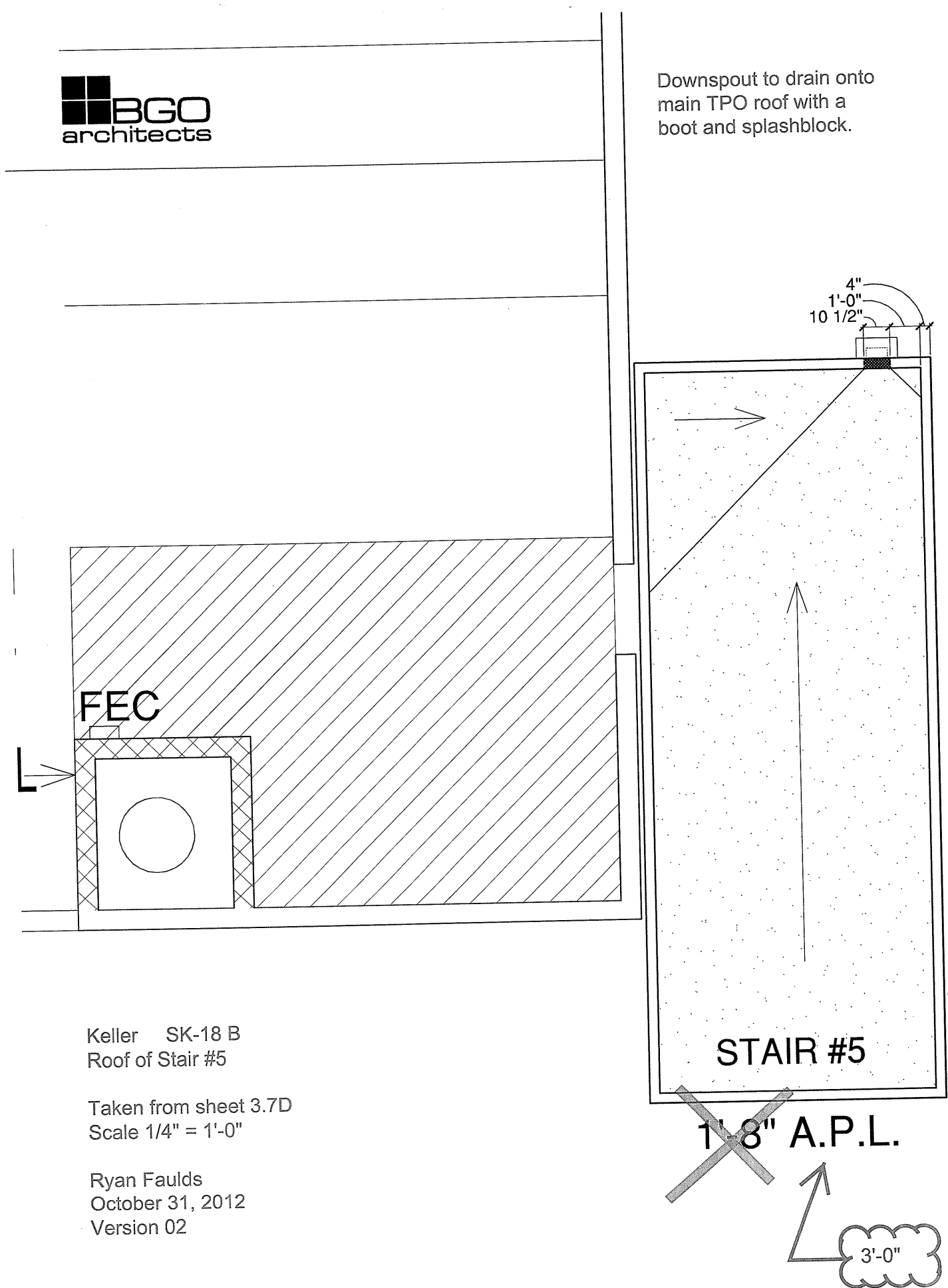

Keller SK-18 B
Roof of Stair #5
Taken from sheet 3.7D
Scale 1/4" = 1'-0"
Ryan Faulds
October 31, 2012
Version 02