

**CAUTION!!**  
 EXIST. GAS MAIN IN AREA  
 CONTACT TEXAS ONE CALL  
 1-800-245-4545  
 48 HOURS PRIOR TO  
 CONSTRUCTION

REMOVE & DISPOSE EXIST. INLET  
 CONST. STD. 4' DIA. MH. AT THE END  
 OF EXIST. 18" RCP.  
 STA 0+00 BEGIN 18" RCP  
 TOP= 637.05, FL= 633.03

STA 0+00 LINE 'E'  
 REMOVE & DISPOSE EXIST. HDWL.  
 CONST. JUNCTION-STRUCTURE  
 CONN. TO EXIST. 3-36" RCP  
 (SEE SHT. C19 FOR DETAILS)

STA 0+06.64  
 END 18" RCP AT FACE INLET  
 CONST. STD. 10' RECESS INLET  
 TOP=636.60, FL= 632.60  
 HG=634.56

STA 0+18 LAT 'E-1'  
 CONST. STD 10' INLET  
 TOP=638.10, FL=634.10  
 HG=635.02

**KELLER SPRINGS ROAD**

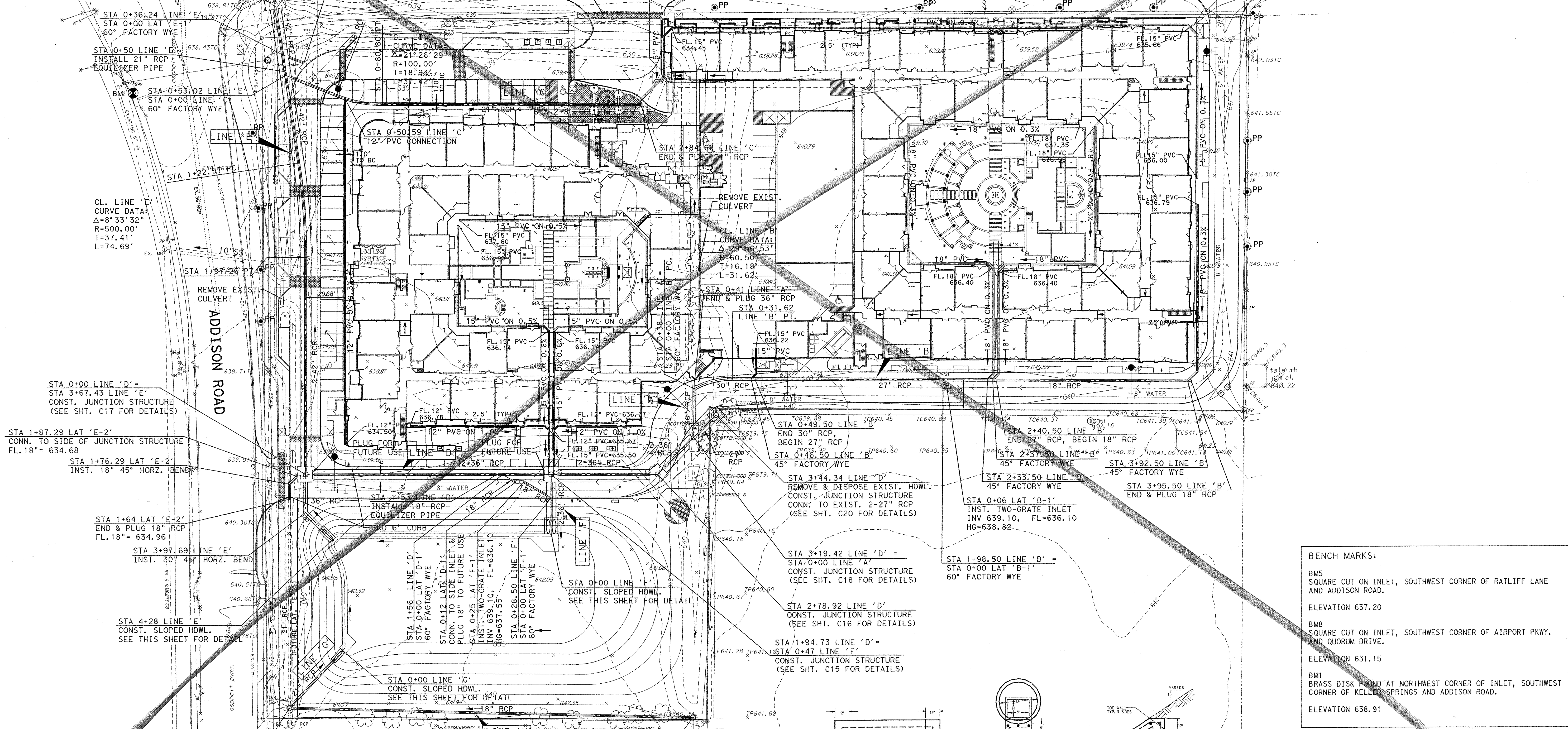
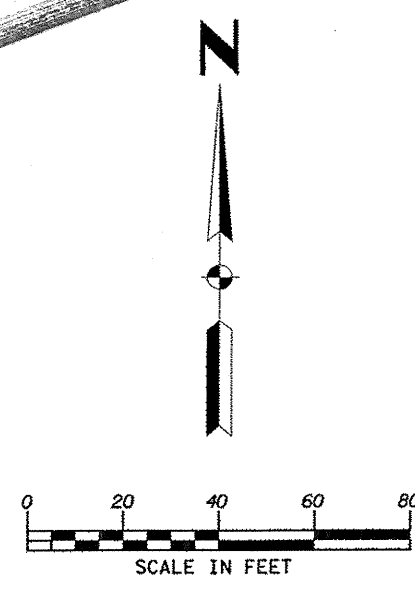

STA 0+00 LINE 'D' =  
 STA 3+67.43 LINE 'E'  
 CONST. JUNCTION STRUCTURE  
 (SEE SHT. C17 FOR DETAILS)

**ADDISON ROAD**

STA 0+49.50 LINE 'C'  
 END 30" RCP  
 BEGIN 27" RCP

STA 2+40.50 LINE 'B'  
 END 27" RCP, BEGIN 18" RCP

STA 3+92.50 LINE 'B'  
 45" FACTORY WYE

**BENCH MARKS:**

BMS  
 SQUARE CUT ON INLET, SOUTHWEST CORNER OF RATLIFF LANE  
 AND ADDISON ROAD.  
 ELEVATION 637.20

BMB  
 SQUARE CUT ON INLET, SOUTHWEST CORNER OF AIRPORT PKWY.  
 AND QUORUM DRIVE.  
 ELEVATION 631.15

BMI  
 BRASS DISK FOUND AT NORTHWEST CORNER OF INLET, SOUTHWEST  
 CORNER OF KELLER SPRINGS AND ADDISON ROAD.  
 ELEVATION 638.91

**NOTES:**

- REFER TO ARCHITECTS PLANS FOR ROOF DRAIN LOCATIONS FOR ALL BUILDINGS. PLUMBING ENGINEER TO DESIGN ROOF DRAINS.
- SEE LANDSCAPE ARCHITECT PLANS FOR AREA DRAIN LOCATIONS, PIPING AND SIZES IN OPEN SPACE AREAS AND COURTYARDS.
- PIPES UNDER BUILDING SLABS SHALL CONFORM TO PLUMBING CODE REQUIREMENTS.

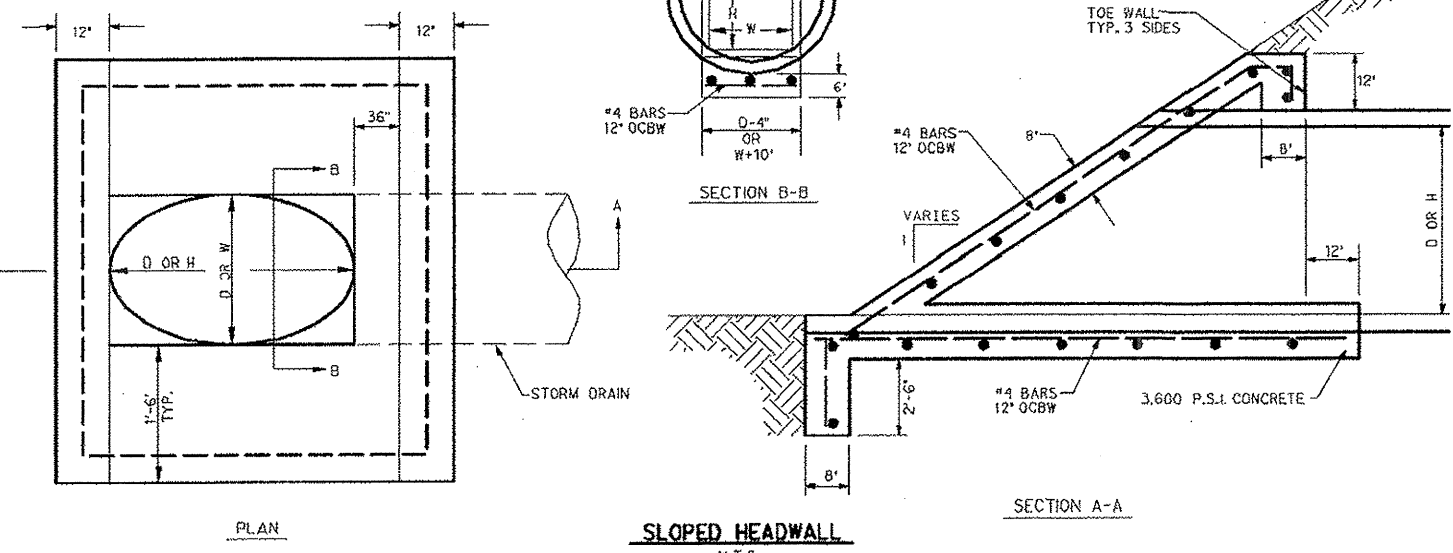

**Kimley-Horn and Associates, Inc.**  
 2005 W. Loop West, Suite 200  
 Dallas, TX 75241-1818  
 Phone: 972-770-3800  
 Fax: 972-770-3800

No.	Revision	Date

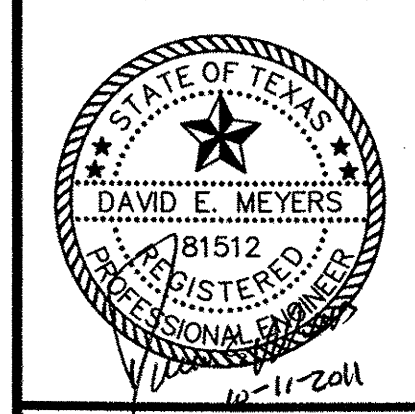

**Keller Springs Lofts  
 Loft Apartments in Addison**  
 Town of Addison, Texas

**STORM SEWER PLAN**

DATE: OCTOBER 11, 2011  
 DESIGN: KHA  
 DRAWN: KHA  
 CHECKED: KHA  
 KHA NO.: 064362003  
 CITY NO.:  
 SHEET  
**C8**